

CITY OF ROCKWALL, TEXAS

CONSTRUCTION PLANS

FOR

PAVING, DRAINAGE & WATER IMPROVEMENTS

TO SERVE

PHASE II

S.H. 205 BYPASS

ROCKWALL COUNTY, TEXAS

NOTES:

1. STANDARD DRAWINGS OF THE STANDARD SPECIFICATIONS FOR PUBLIC WORKS CONSTRUCTION, NORTH CENTRAL TEXAS, THIRD EDITION, DATED 1998 AND AS MODIFIED BY CITY OF ROCKWALL SPECIAL PROVISIONS SECTION 11 ARE HEREIN INCORPORATED BY REFERENCE.
2. THE STANDARD SHEETS P301 THROUGH P303, M203, M204 AND T201 THROUGH T221, SPECIFICALLY IDENTIFIED IN THIS INDEX OF SHEETS, HAVE BEEN SELECTED BY ME OR UNDER MY RESPONSIBLE SUPERVISION AS BEING APPLICABLE TO THIS PROJECT.
3. SPECIFICATIONS ADOPTED BY THE TEXAS DEPARTMENT OF TRANSPORTATION, JUNE 1, 2004 AND SPECIFICATION ITEMS LISTED AND DATED AS FOLLOWS SHALL GOVERN FOR CONSTRUCTION SHOWN ON SHEETS P107, P201, AND M102 OF THESE PLANS.

SHEET INDEX

GENERAL

S001 COVER SHEET
S002 GENERAL NOTES & TOPOGRAPHIC LEGEND
SHEET QUANTITIES

PAVING PLANS

P001-P002 TYPICAL SECTIONS
P101-P107 S.H. 205 BYPASS PAVING PLAN & PROFILES
P201 S.H. 205 & I-30 EB FRONTAGE ROAD ASPHALT
TRANSITION PAVING PLAN
P301-P303 MBGF DETAILS

PAVEMENT MARKING PLANS

M101-M102 STRIPING PLANS
M201-M204 STRIPING DETAILS

DRAINAGE PLANS

D101 OVERALL DRAINAGE AREA MAP
D102 DRAINAGE AREA & INLET DESIGN CALCULATIONS
D103 STORM DRAIN DESIGN CALCULATIONS
D104-D105 STORM DRAIN PLAN & PROFILES

ILLUMINATION PLANS

I101-I102 ILLUMINATION PLANS

STORMWATER POLLUTION PREVENTION PLANS

E001-E004 SWP3 NOTES
E101-E103 SWP3 PLANS
E201-E202 SWP3 DETAILS

TRAFFIC CONTROL PLANS

T101-T103 TRAFFIC CONTROL PLAN
T201-T221 TRAFFIC CONTROL DETAILS

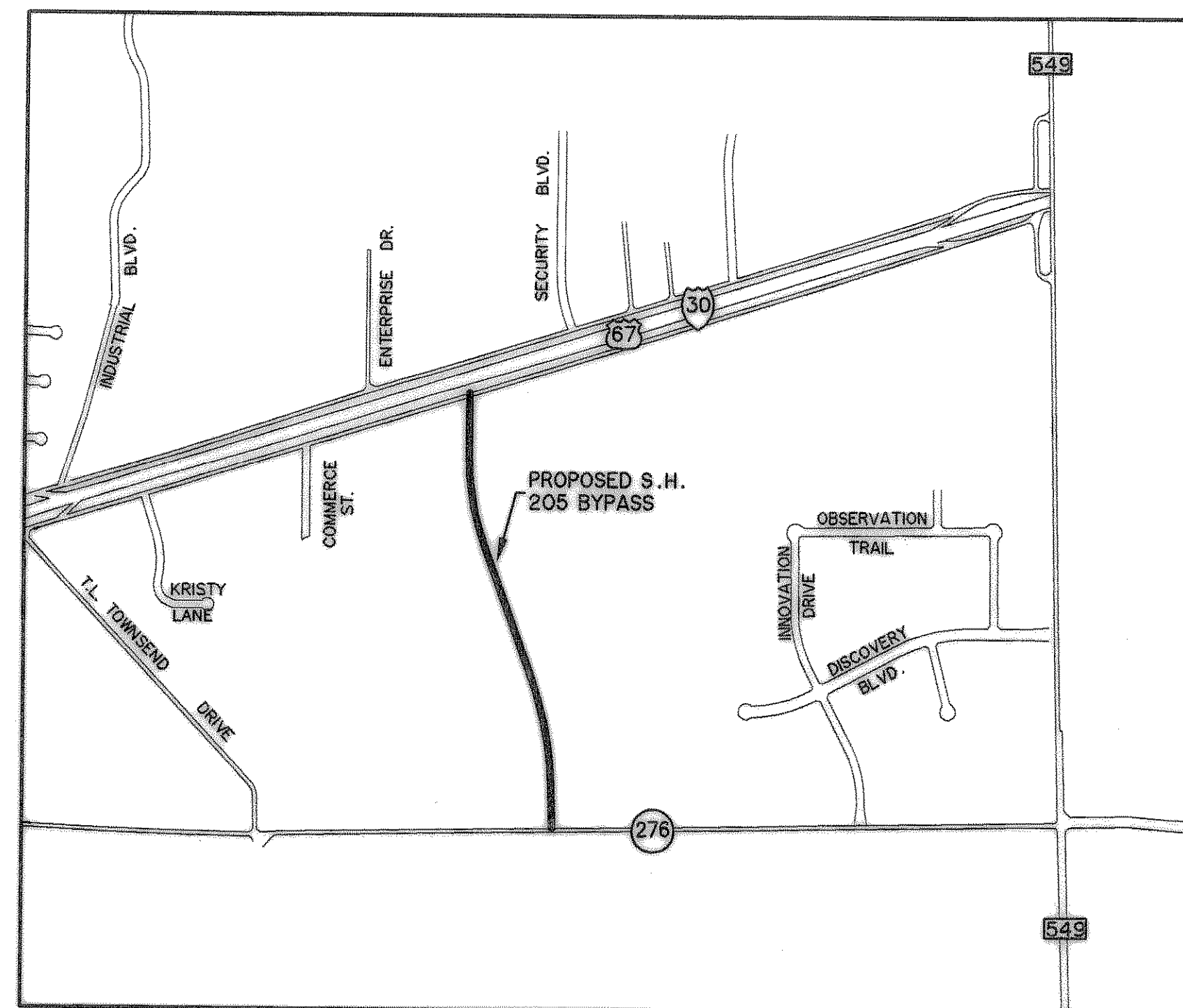

VICINITY MAP

N.T.S.

BILL CECIL - MAYOR

COUNCILMEMBERS

STEPHEN STRAUGHAN - MAYOR PRO-TEM

DAVID SWEET

MATT SCOTT

GLEN FARRIS

MARGO NIELSEN

CLIFF SEVIER

JULIE COUCH - City Manager

CHUCK TODD, P.E. - City Engineer

PREPARED BY:
WIA WIER & ASSOCIATES, INC.
ENGINEERS SURVEYORS LAND PLANNERS
4300 BELTWAY PLACE SUITE 130 ARLINGTON, TEXAS 76018 METRO (817)467-7700
1380 U.S. HIGHWAY 287 N, SUITE 101 MANSFIELD, TEXAS 76063 METRO (817)477-8700
6849 ELM STREET FRISCO, TEXAS 75034 METRO (214)387-8000
www.WierAssociates.com

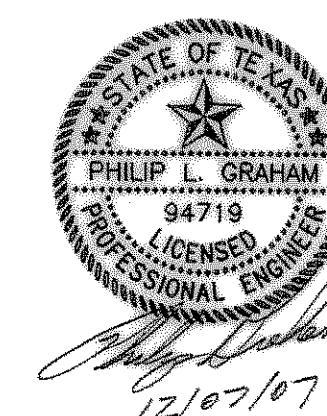

RECORD PLANS
AUGUST 29, 2008