

BENCHMARK
 1. BOX CUT WITH 'X' CUT IN CENTER OF EXISTING SIDEWALK 2' SOUTH OF NORTH EDGE AT SOUTHEAST CORNER OF S.H. No. 205 BYPASS AND S.H. No. 276
 ELEV. 580.40
 2. BOX CUT ON SOUTHEAST TOP OF HEADWALL ON SOUTH SIDE OF I.H. No. 30 ACCESS ROAD APPROX. 325' EAST OF FUTURE S.H. No. 205 BYPASS AND ON WEST SIDE OF NESBIT METAL CO. ORANGE METAL BLDG.
 ELEV. 573.70

THE CAMBRIDGE COMPANIES, INC. TRUSTEE
 VOL. 101, PG. 795
 D.R.R.C.T.

THE CAMBRIDGE COMPANIES, INC. TRUSTEE
 VOL. 99, PG. 1022
 D.R.R.C.T.

STA 45+75.00 S.H. 205 BYPASS
 OFF 50.50' LT.
 CONST. 10' REC. CURB INLET
 TOP = 568.75
 FL = 563.75

STA 43+71.42 S.H. No. 205 BYPASS
 CENTER OF FUTURE 60' WIDE MEDIAN OPENING

MATCH LINE STA 43+00

MATCH LINE STA 48+00

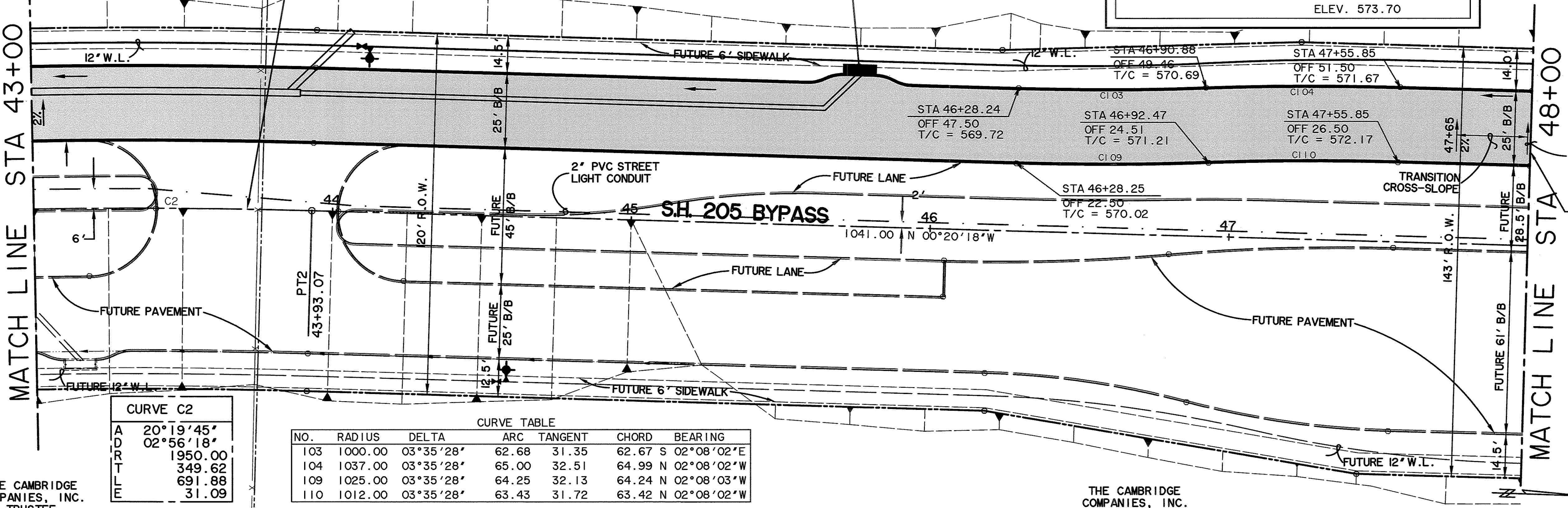

CURVE C2

A	20°19'45"
D	02°56'18"
R	1950.00
T	349.62
L	691.88
E	31.09

CURVE TABLE

NO.	RADIUS	DELTA	ARC TANGENT	CHORD BEARING
103	1000.00	03°35'28"	62.68 31.35	62.67 S 02°08'02"E
104	1037.00	03°35'28"	65.00 32.51	64.99 N 02°08'02"W
109	1025.00	03°35'28"	64.25 32.13	64.24 N 02°08'03"W
110	1012.00	03°35'28"	63.43 31.72	63.42 N 02°08'02"W

THE CAMBRIDGE COMPANIES, INC. TRUSTEE
 VOL. 99, PG. 1022
 D.R.R.C.T.

THE CAMBRIDGE COMPANIES, INC. TRUSTEE
 VOL. 101, PG. 795
 D.R.R.C.T.

S . H . 2 0 5 B Y P A S S

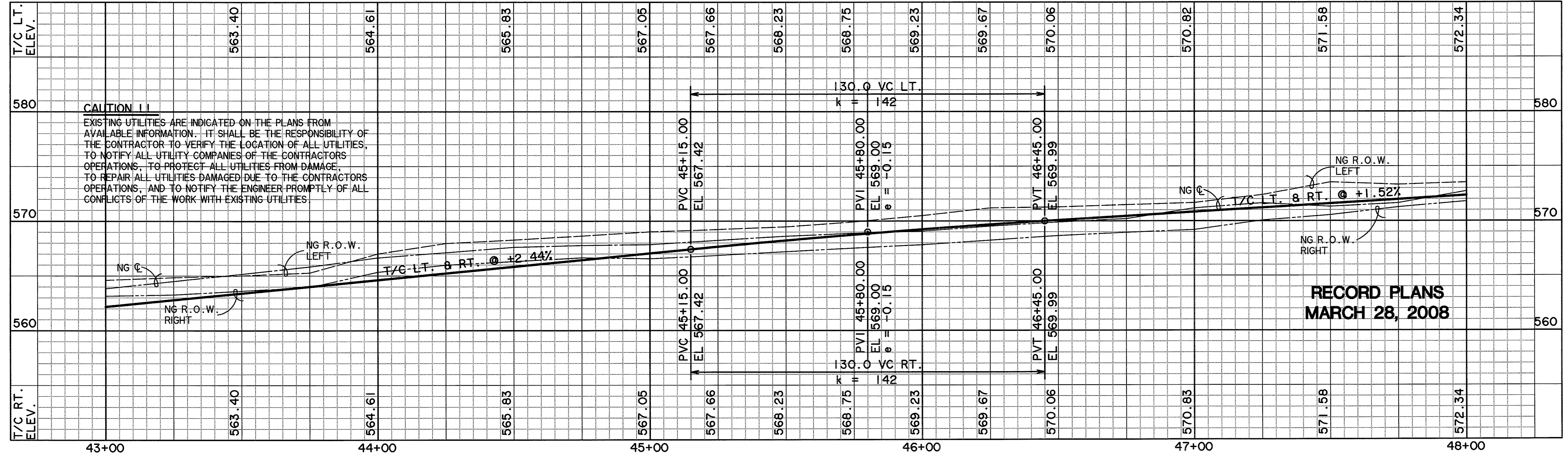
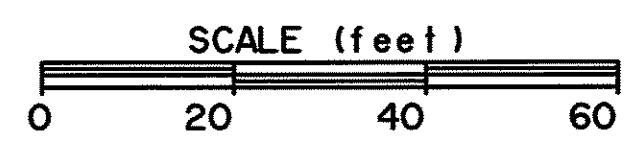

CAUTION !!
 EXISTING UTILITIES ARE INDICATED ON THE PLANS FROM AVAILABLE INFORMATION. IT SHALL BE THE RESPONSIBILITY OF THE CONTRACTOR TO VERIFY THE LOCATION OF ALL UTILITIES, TO NOTIFY ALL UTILITY COMPANIES OF THE CONTRACTORS OPERATIONS, TO PROTECT ALL UTILITIES FROM DAMAGE, TO REPAIR ALL UTILITIES DAMAGED DUE TO THE CONTRACTORS OPERATIONS, AND TO NOTIFY THE ENGINEER PROMPTLY OF ALL CONFLICTS OF THE WORK WITH EXISTING UTILITIES.

RECORD PLANS
MARCH 28, 2008