

CAUTION !!

EXISTING UTILITIES ARE INDICATED ON THE PLANS FROM AVAILABLE INFORMATION. IT SHALL BE THE RESPONSIBILITY OF THE CONTRACTOR TO VERIFY THE LOCATION OF ALL UTILITIES, TO NOTIFY ALL UTILITY COMPANIES OF THE CONTRACTORS OPERATIONS, TO PROTECT ALL UTILITIES FROM DAMAGE, TO REPAIR ALL UTILITIES DAMAGED DUE TO THE CONTRACTORS OPERATIONS, AND TO NOTIFY THE ENGINEER PROMPTLY OF ALL CONFLICTS OF THE WORK WITH EXISTING UTILITIES.

BENCHMARK

- BOX CUT WITH 'X' CUT IN CENTER OF EXISTING SIDEWALK 2' SOUTH OF NORTH EDGE AT SOUTHEAST CORNER OF S.H. No. 205 BYPASS AND S.H. No. 276
ELEV. 580.40
- BOX CUT ON SOUTHEAST TOP OF HEADWALL ON SOUTH SIDE OF I.H. No. 30 ACCESS ROAD APPROX. 325' EAST OF FUTURE S.H. No. 205 BYPASS AND ON WEST SIDE OF NESBIT METAL CO. ORANGE METAL BLDG.
ELEV. 573.70

THE CAMBRIDGE COMPANIES, INC.
TRUSTEE
VOL. 99, PG. 1022
D.R.R.C.T.

| CURVE C30 | |
|-----------|-----------|
| A | 44°42'06" |
| B | 04°24'27" |
| C | 1300.00 |
| D | 534.52 |
| E | 1014.25 |
| F | 105.60 |

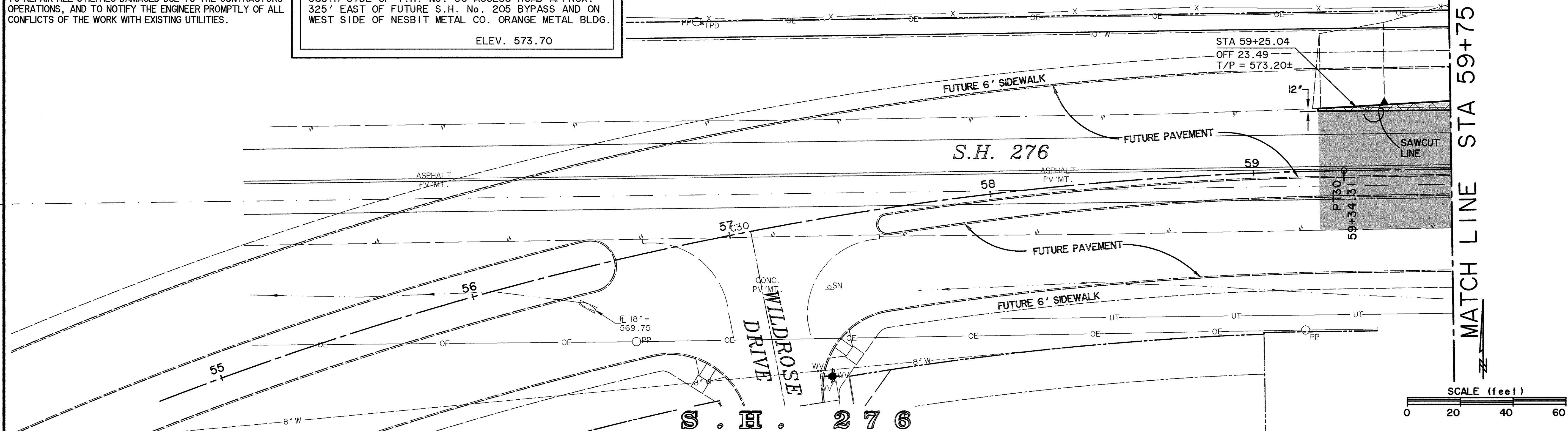

| CURVE TABLE | | | | | | |
|-------------|--------|-----------|-------------|-------|---------|--------------|
| NO. | RADIUS | DELTA | ARC TANGENT | CHORD | BEARING | |
| 131 | 50.00 | 67°10'49" | 58.63 | 33.21 | 55.32 | S 32°31'06"W |

THE CAMBRIDGE COMPANIES, INC.
TRUSTEE
VOL. 99, PG. 1022
D.R.R.C.T.

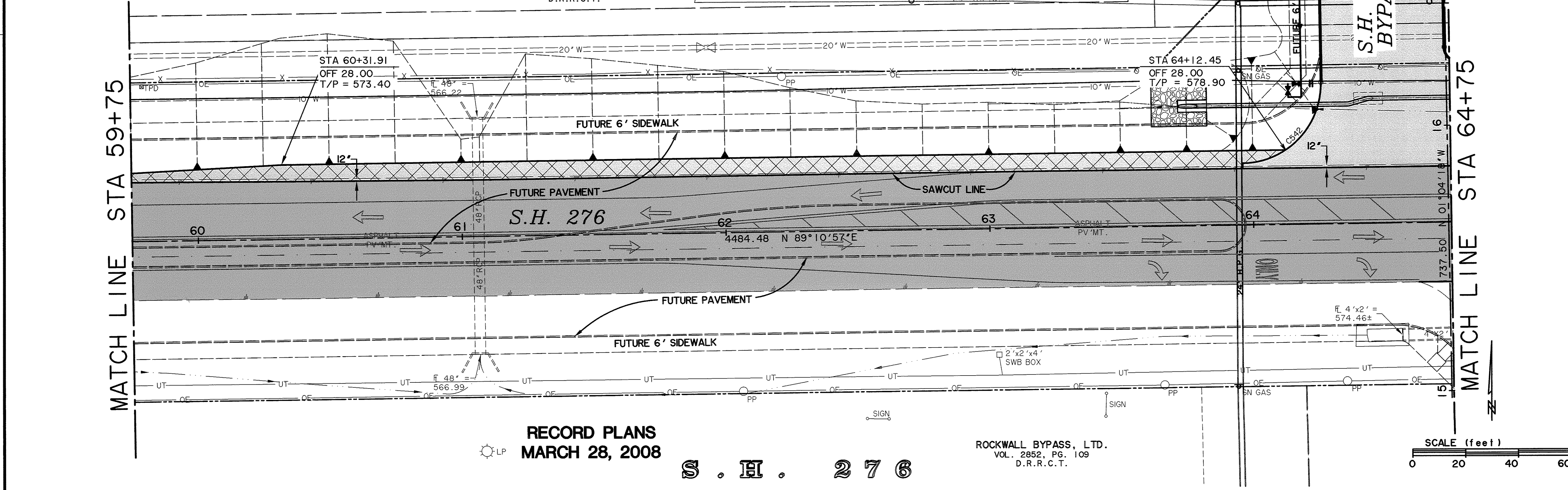

RECORD PLANS
MARCH 28, 2008

ROCKWALL BYPASS, LTD.
VOL. 2852, PG. 109
D.R.R.C.T.

PREPARED BY:
WIER & ASSOCIATES, INC.
ENGINEERS SURVEYORS LAND PLANNERS
4300 BELWAY PLACE SUITE 130 ARLINGTON, TEXAS 76018 METRO (817)467-7700
1380 U.S. HIGHWAY 287 N. SUITE 101 WANSFELD, TEXAS 76783 METRO (817)477-8700
6848 ELM STREET PERCO, TEXAS 75084 METRO (214)387-8800
www.wierassociates.com

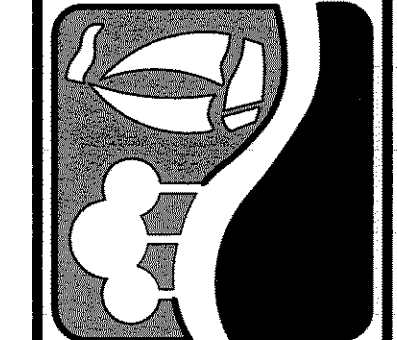

PHASE I S.H. 205 BYPASS
FROM S.H. 276 TO INTERSTATE 30
S.H. 276 WIDENING
PAVING PLAN

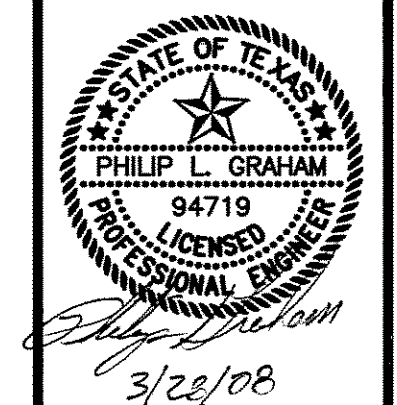

COPYRIGHT ©
WIER & ASSOCIATES, INC.
LAST SHEET EDIT
DATE 11-02-2007
WA# 04141
SHEET NO.
P109

FILE: 04141-PAVE17.dwg
TIME: 17.39