

NOTE: CONCRETE SHALL BE REINFORCED W/#3 BARS @ 24" C/C EW.

1
TYPICAL PAVEMENT SECTION
ROSS 29' B-B
NOT TO SCALE

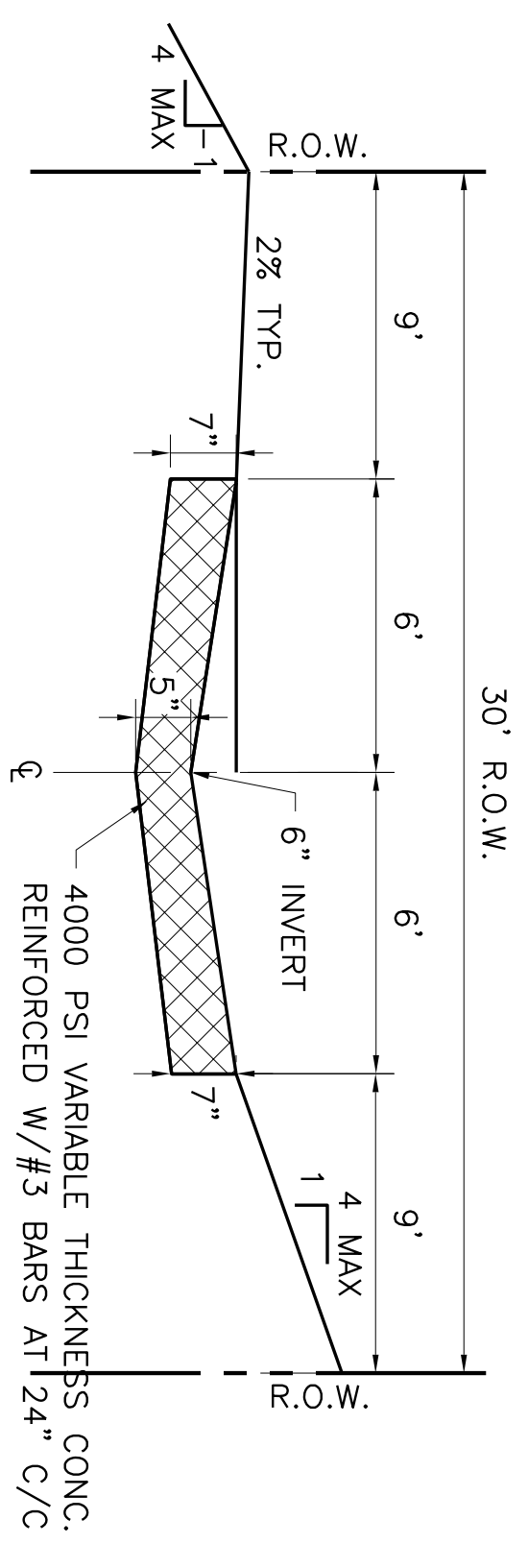

2
TYPICAL PAVEMENT SECTION
LAMAR 12' WIDE
NOT TO SCALE

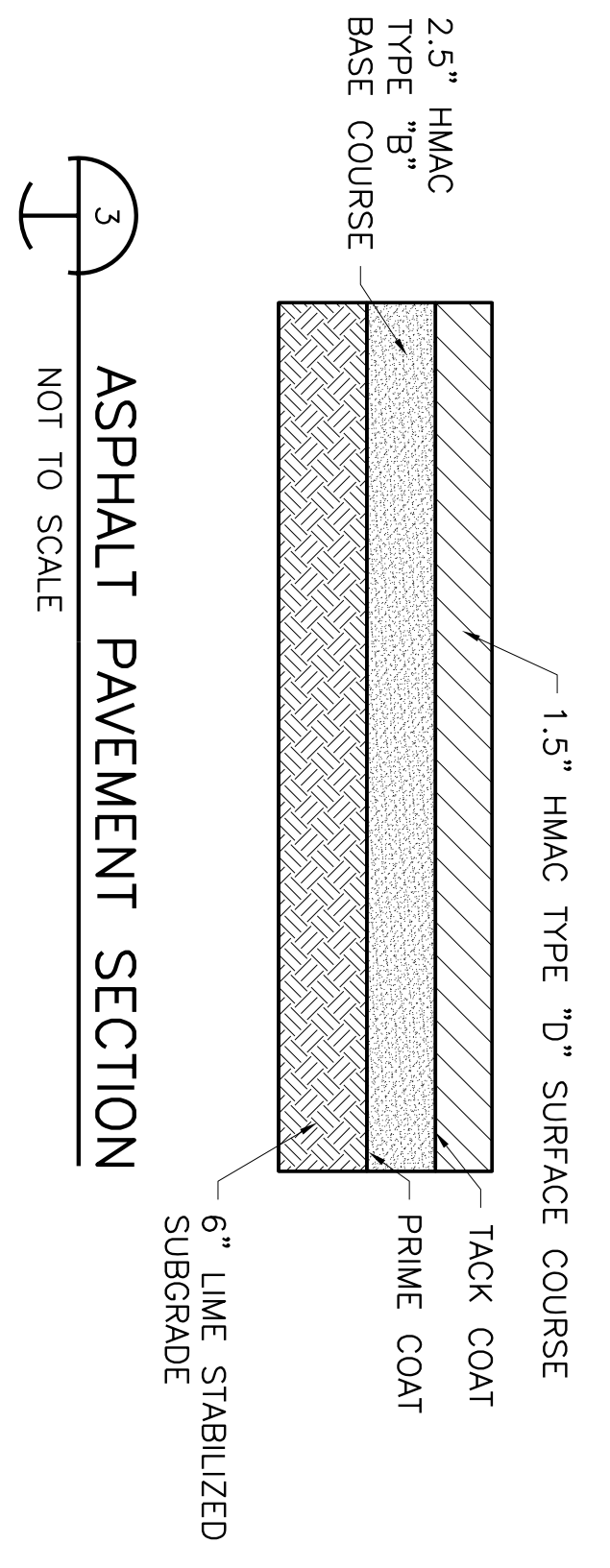

3
ASPHALT PAVEMENT SECTION
NOT TO SCALE

PLAN LEGEND

EXISTING

PROPOSED

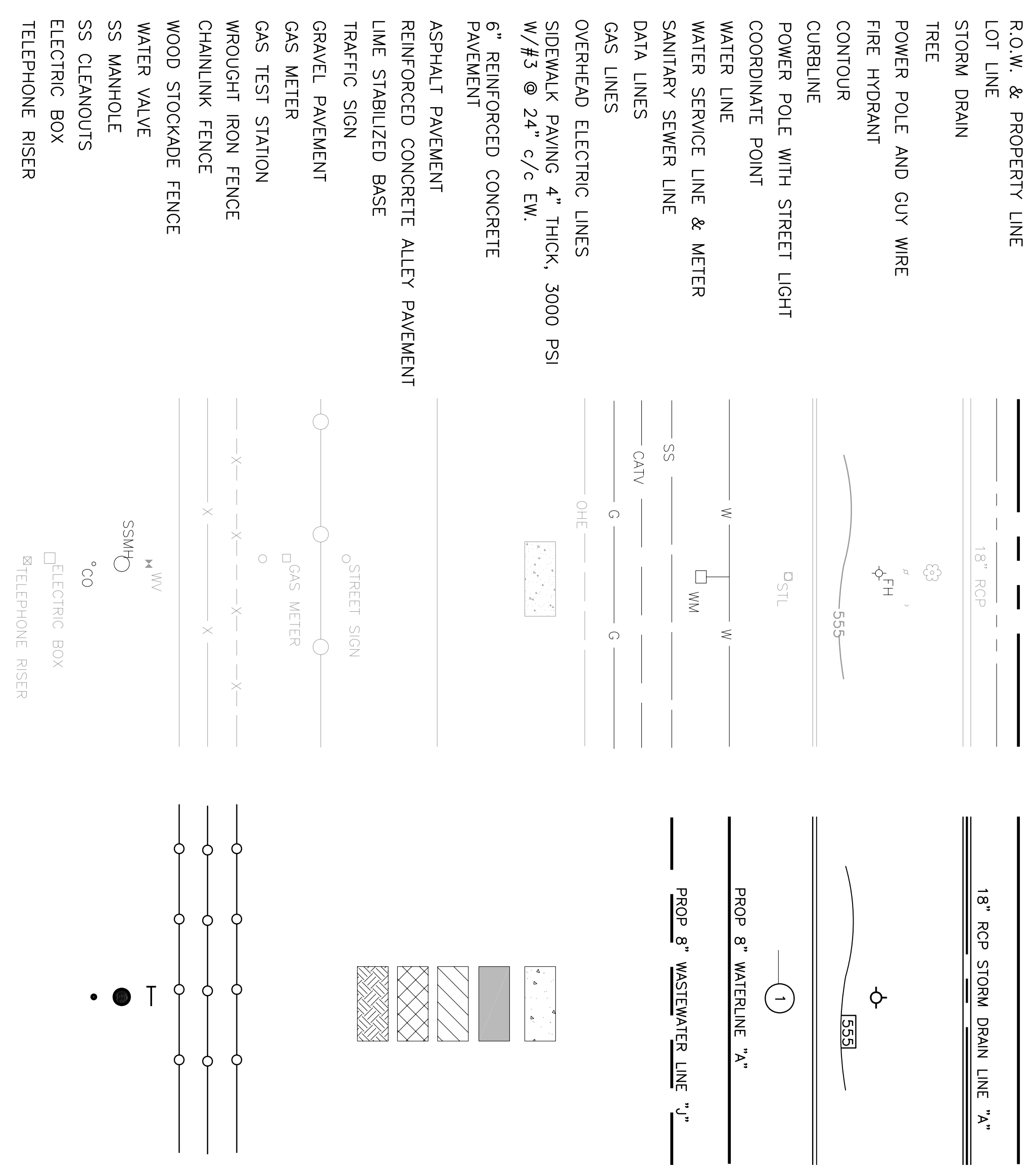

This Record Drawing is a combination of the selected engineering contract drawings for this project, modified by information furnished by the contractor during construction. The Project, made during construction, the original drawings are on file in the office of FREESE AND NICHOLS, INC. 4055 INTERNATIONAL PARK, SUITE 200 FORT WORTH, TEXAS 76109-4895 RECORD DRAWINGS PREPARED ON: 7/13/2007

THE SEAL THAT ORIGINALLY APPEARED ON THIS DOCUMENT WAS AUTHORIZED BY TED B. SUGGS, P.E. TEXAS NO. 82725 ON 7/13/2007. ALTERATION OF A SEALED DOCUMENT WITHOUT PROPER NOTIFICATION OF THE RESPONSIBLE ENGINEER IS AN OFFENSE UNDER THE TEXAS ENGINEERING PRACTICE ACT.

Freese and Nichols
 1701 N. Market Street, Suite 500, LB 51
 Dallas, Texas 75202-2001
 Phone - (214) 920-2500
 Fax - (214) 920-2565

CITY OF ROCKWALL, TEXAS
ROSS STREET REHABILITATION AND DRAINAGE IMPROVEMENTS
 CIVIL
TYPICAL SECTIONS & LEGEND

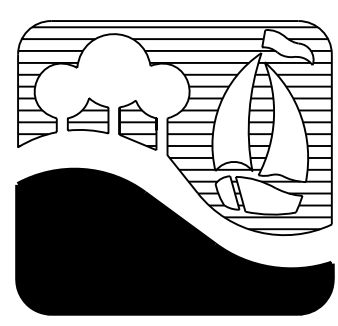

| | |
|-------------|----------------------|
| F&N JOB NO. | ROK05274 |
| DATE | 3/01/2006 |
| DESIGNED | |
| DRAWN | |
| REVISED | |
| CHECKED | CIVIL |
| FILE NAME | CV-ROK-XS-TYPL01.dwg |

| | |
|--------------|---|
| NO. | ISSUE |
| 0 | |
| VERIFY SCALE | |
| 1 | Bar is one inch on original drawing. If not one inch on this sheet, adjust scale. |

SHEET GN-2
 SFO.