

12+25 DRIVE LEFT

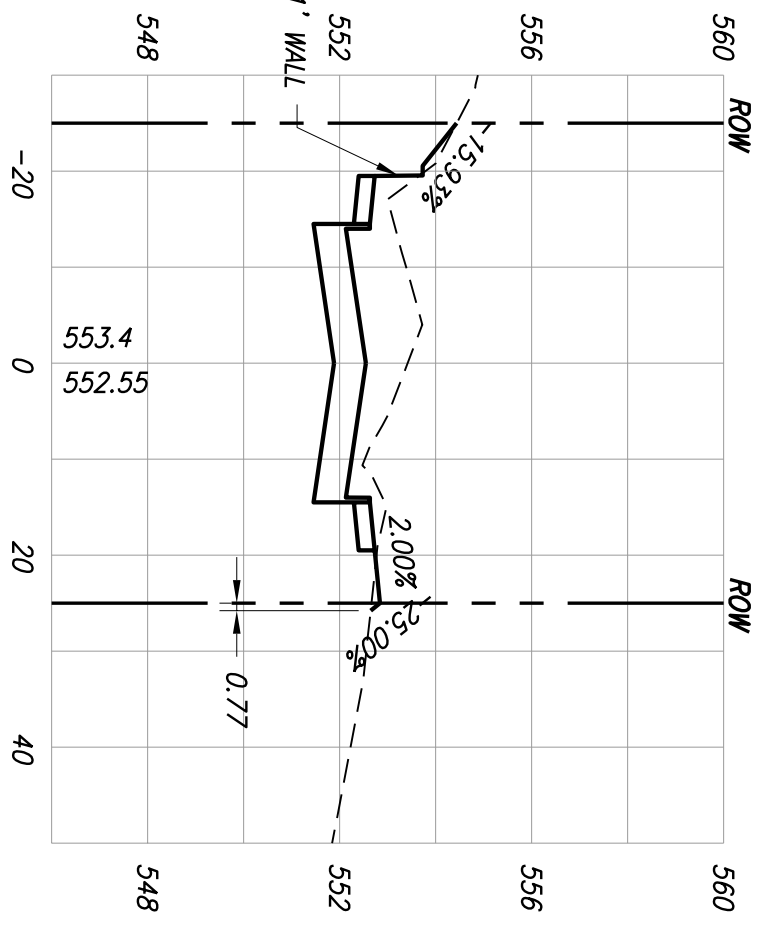

12+00

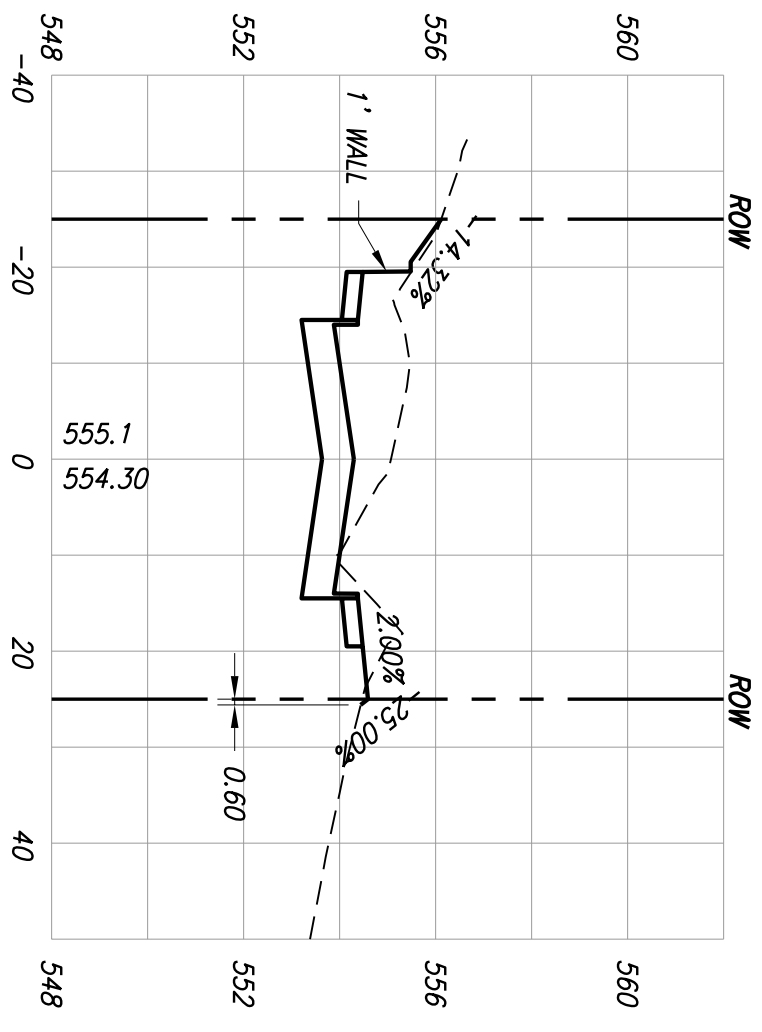

11+50

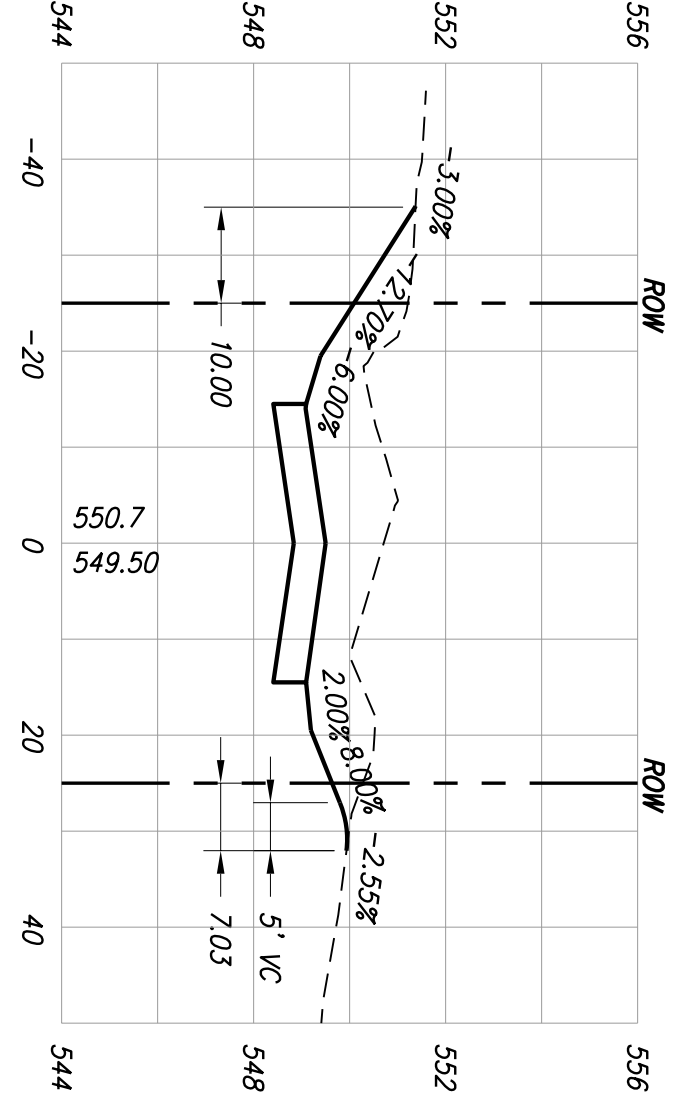

12+87 DRIVE LEFT

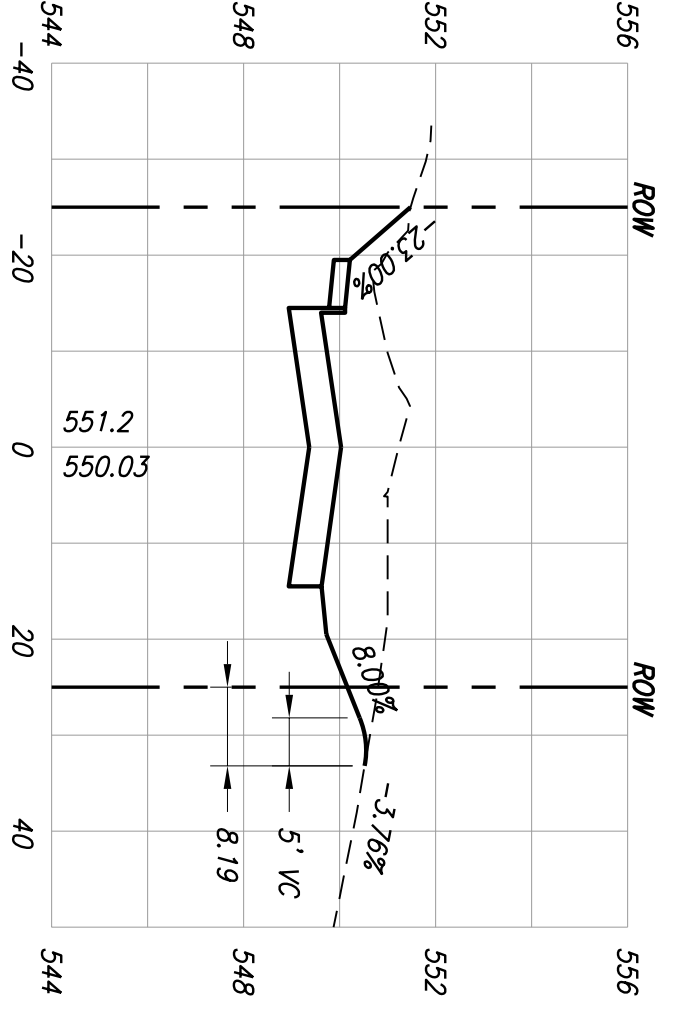

12+71.91 DRIVE RIGHT

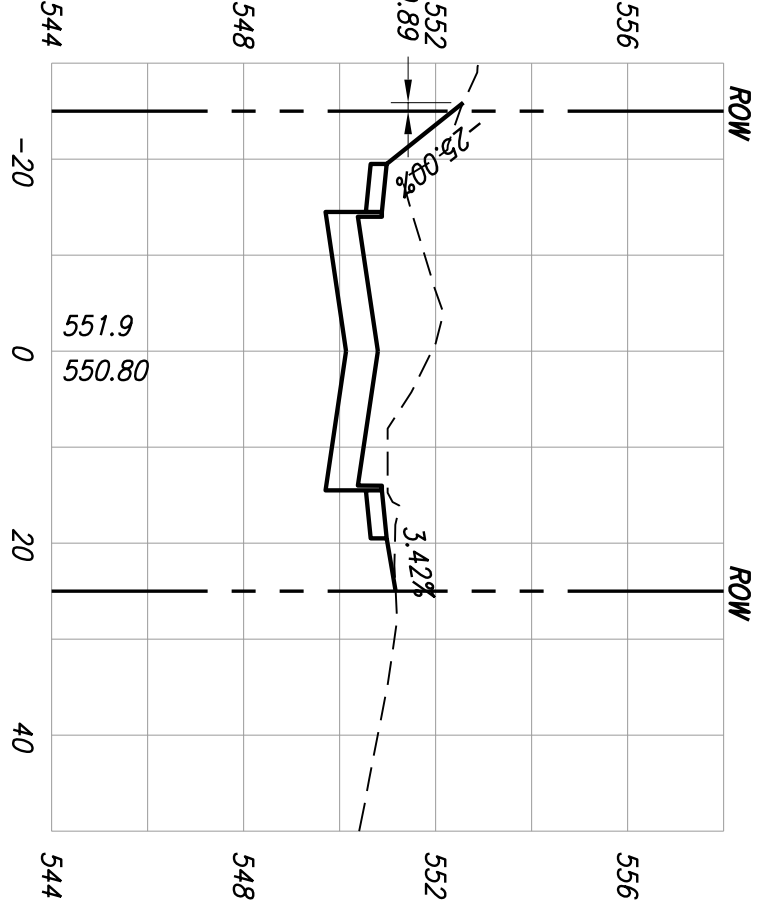

12+50

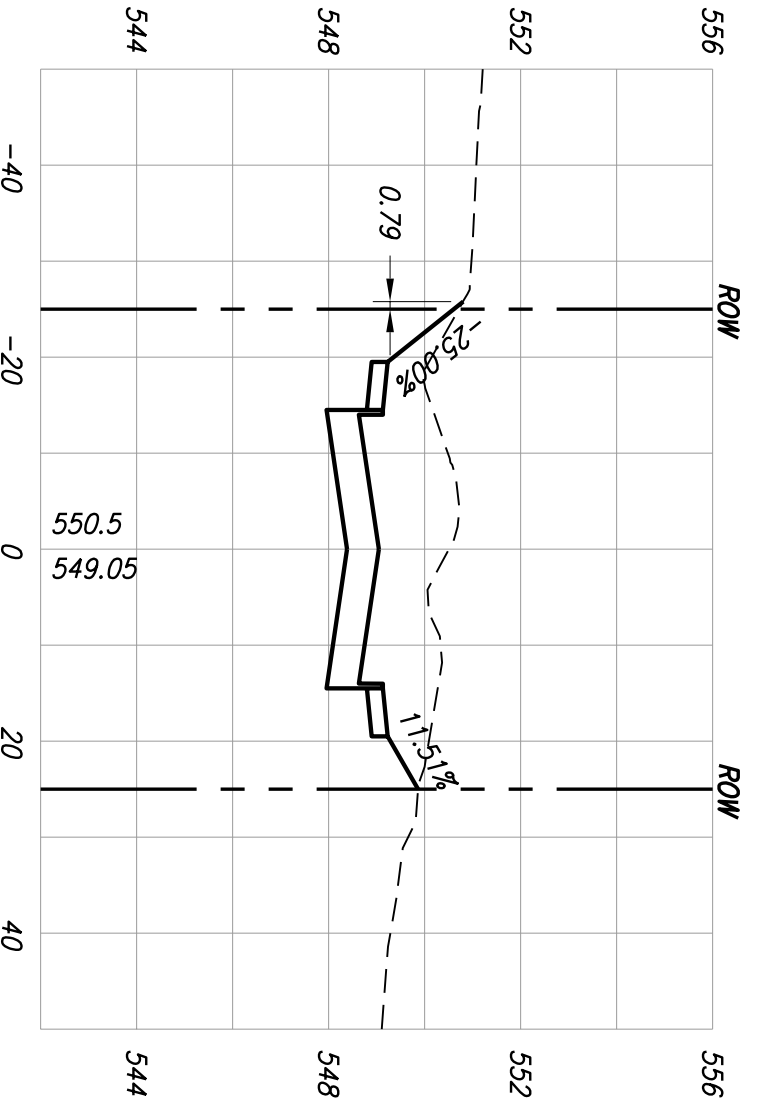

13+00

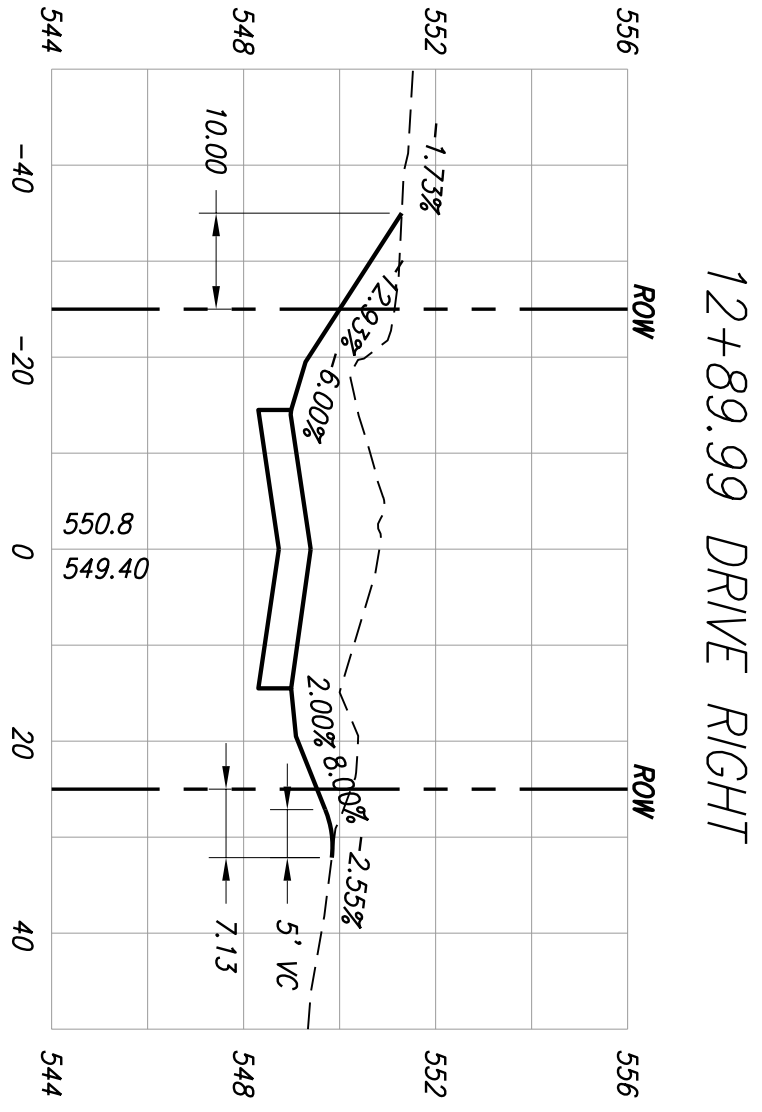

12+89.99 DRIVE RIGHT

This Record Drawing is a combination of the sealed engineering contract drawings for this project, as prepared by the contractor, and the alterations made by the contractor during construction. The original sealed drawings are on file at the offices of
FRESE AND NICHOLS, INC.
 4055 INTERNATIONAL PARK, SUITE 200
 FORT WORTH, TEXAS 76117
 (817) 735-7300
 RECORD DRAWINGS PREPARED ON: 7/13/2007

THE SEAL THAT ORIGINALLY APPEARED ON THIS DOCUMENT WAS AUTHORIZED BY TED B. SISK, P.E. TEXAS NO. 82275 ON 7/13/2007. ALTERATION OF A SEALED DOCUMENT WITHOUT PROPER NOTIFICATION OF THE RESPONSIBLE ENGINEER IS AN OFFENSE UNDER THE TEXAS ENGINEERING PRACTICE ACT.



CITY OF ROCKWALL, TEXAS
 ROSS STREET REHABILITATION
 AND DRAINAGE IMPROVEMENTS

CROSS SECTIONS

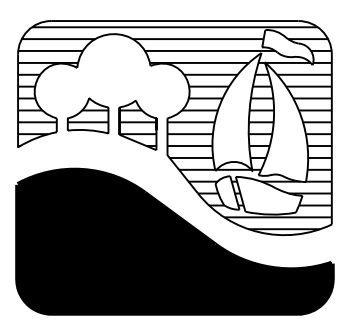

F&N JOB NO.	ROK05274
DATE	3/01/2006
DESIGNED	RAW
DRAWN	NO/EAM
REVISED	NO
CHECKED	RAW
FILE NAME	CV-ROK-XS-SECT03.dwg

NO.	ISSUE	BY	DATE

VERIFY SCALE 1 Bar is one inch on original drawing. If not one inch on this sheet, adjust scale.

SCALE: HORIZ: 1"=20' VERT: 1"=4'
 SHEET XS-3