

BENCHMARKS:
 CITY MON. NO. 2
 LOCATED ON THE NORTHWEST CORNER
 OF THE BRIDGE AT I-30 AND F.M. 549
 ELEVATION 609.56
 *□ CUT IN THE CENTER OF A 4 FOOT
 HEADWALL LOCATED AT THE NORTHEAST
 CORNER OF F.M. 549 AND STATE
 HIGHWAY 276
 ELEVATION 592.75

PREPARED BY:
WIER & ASSOCIATES, INC.
ENGINEERS SURVEYORS LAND PLANNERS
 4300 BELTWAY PLACE SUITE 130 ARLINGTON, TEXAS 76018 METRO (817)467-7700
 1300 U. HIGHWAY 287 N. SUITE 101 WAKESFIELD, TEXAS 76063 METRO (817)477-8700
 6849 ELM STREET FRISCO, TEXAS 75034 METRO (214)387-8000
 www.wierassociates.com

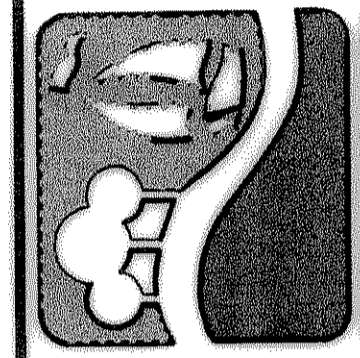

**ROCKWALL TECHNOLOGY
 PARK**

**STORM DRAIN
 PLAN & PROFILE
 LINE 'D'**

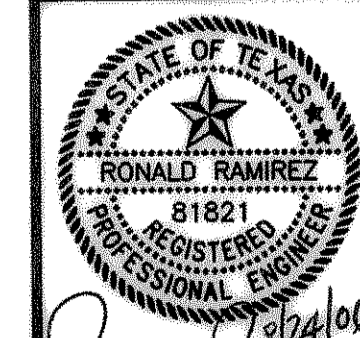

Copyright ©
 WIER & ASSOCIATES, INC.
 LAST SHEET EDIT
 DATE 08-23-2006
 WA# 98041
**SHEET NO.
 D302.1**

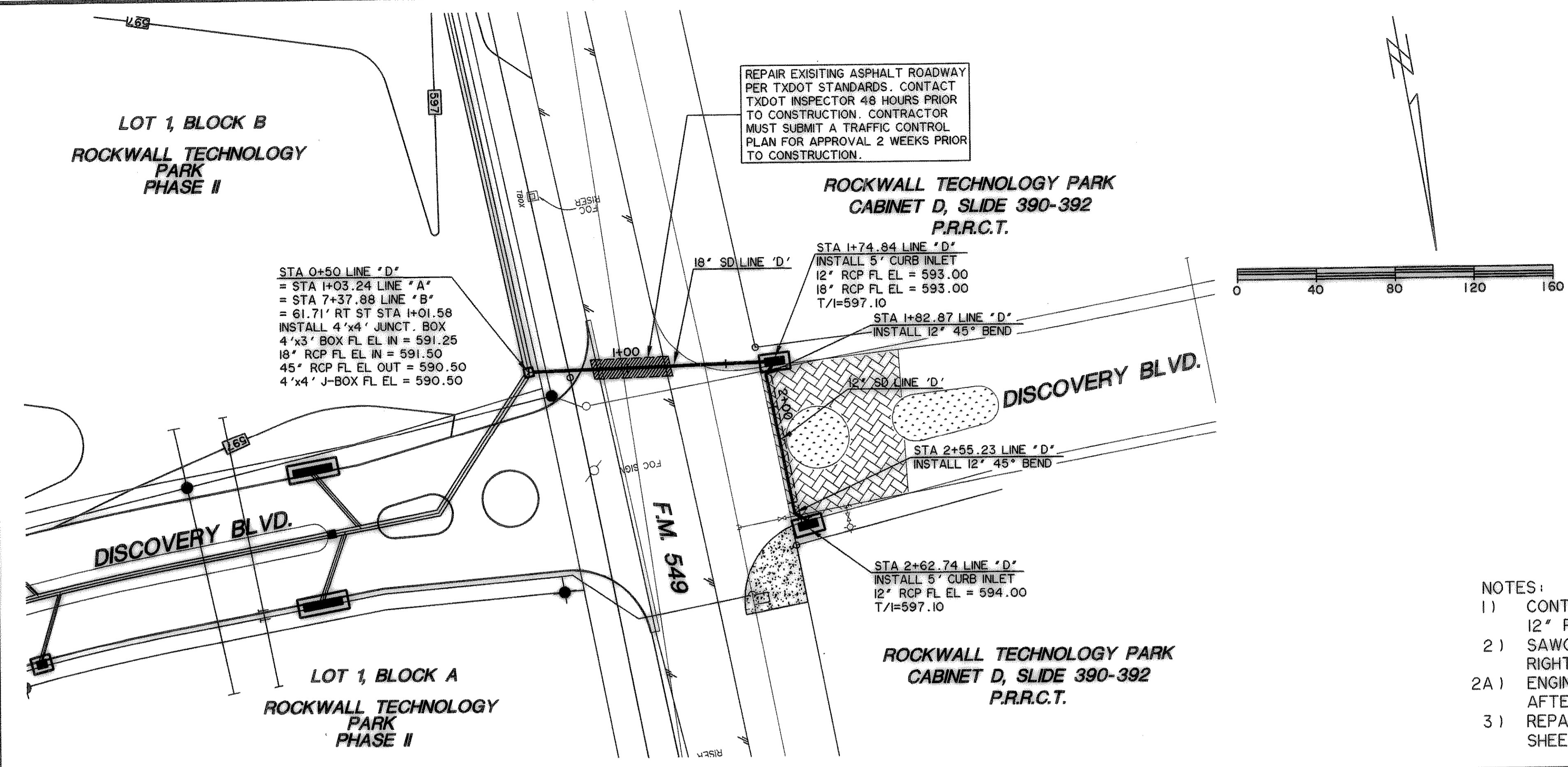

**RECORD
 DRAWING
 08/04/06**

- NOTES:**
- 1) CONTRACTOR SHALL REMOVE AND SALVAGE PAVERS NECESSARY TO INSTALL NEW 12" RCP.
 - 2) SAWCUT FULL DEPTH THE EXISTING CONCRETE PAVER BASE AND REMOVE TO TXDOT RIGHT-OF-WAY.
 - 2A) ENGINEER AND CONTRACTOR AND CITY INSPECTOR SHALL REVIEW EXISTING SUB-BASE AFTER PAVERS ARE REMOVED AND DETERMINE LIMITS OF CONCRETE SUB-BASE REPAIR.
 - 3) REPAIR CONCRETE PAVER BASE USING DOWELS WITH EPOXY PER DETAILS SHEET P002.

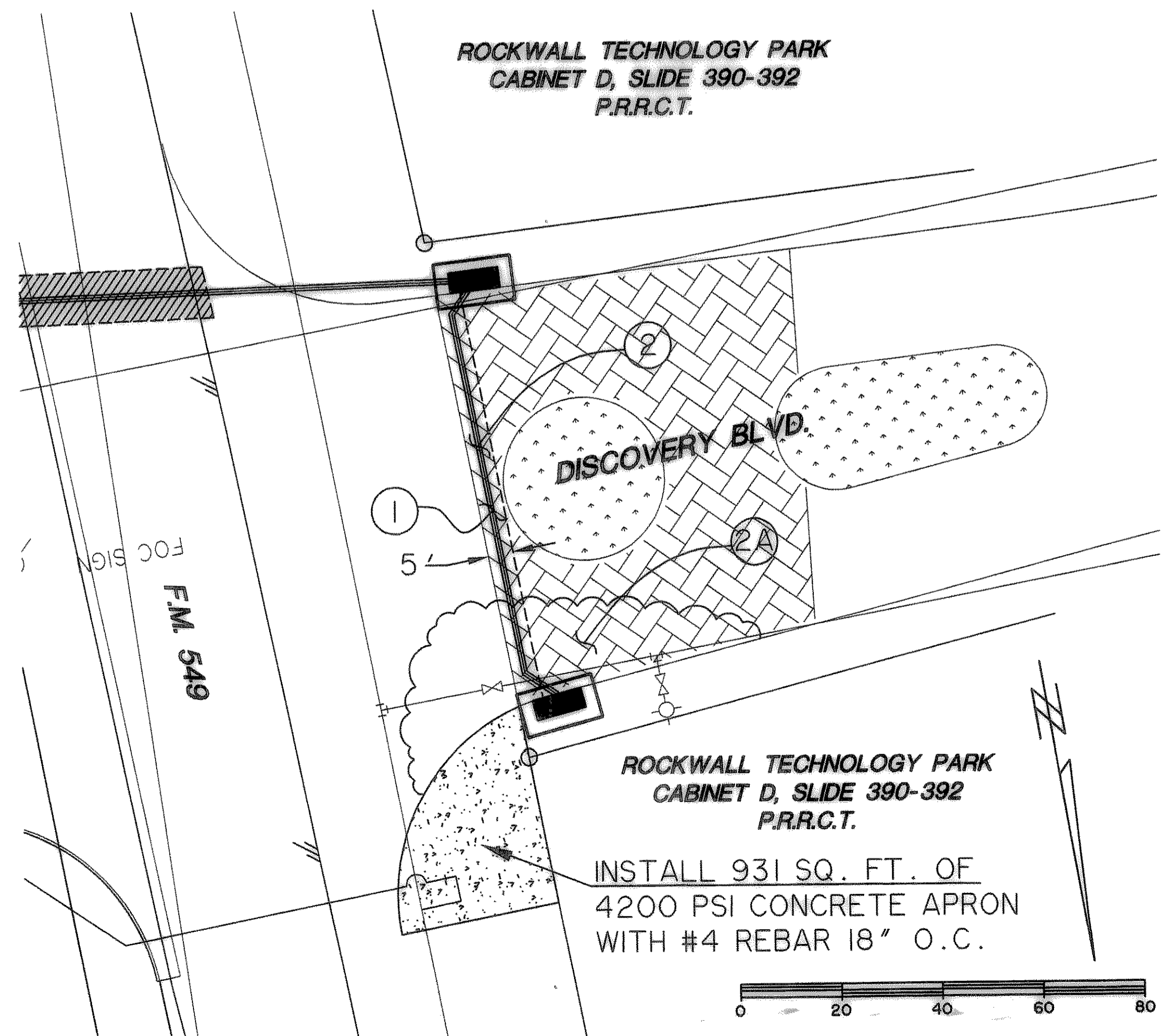
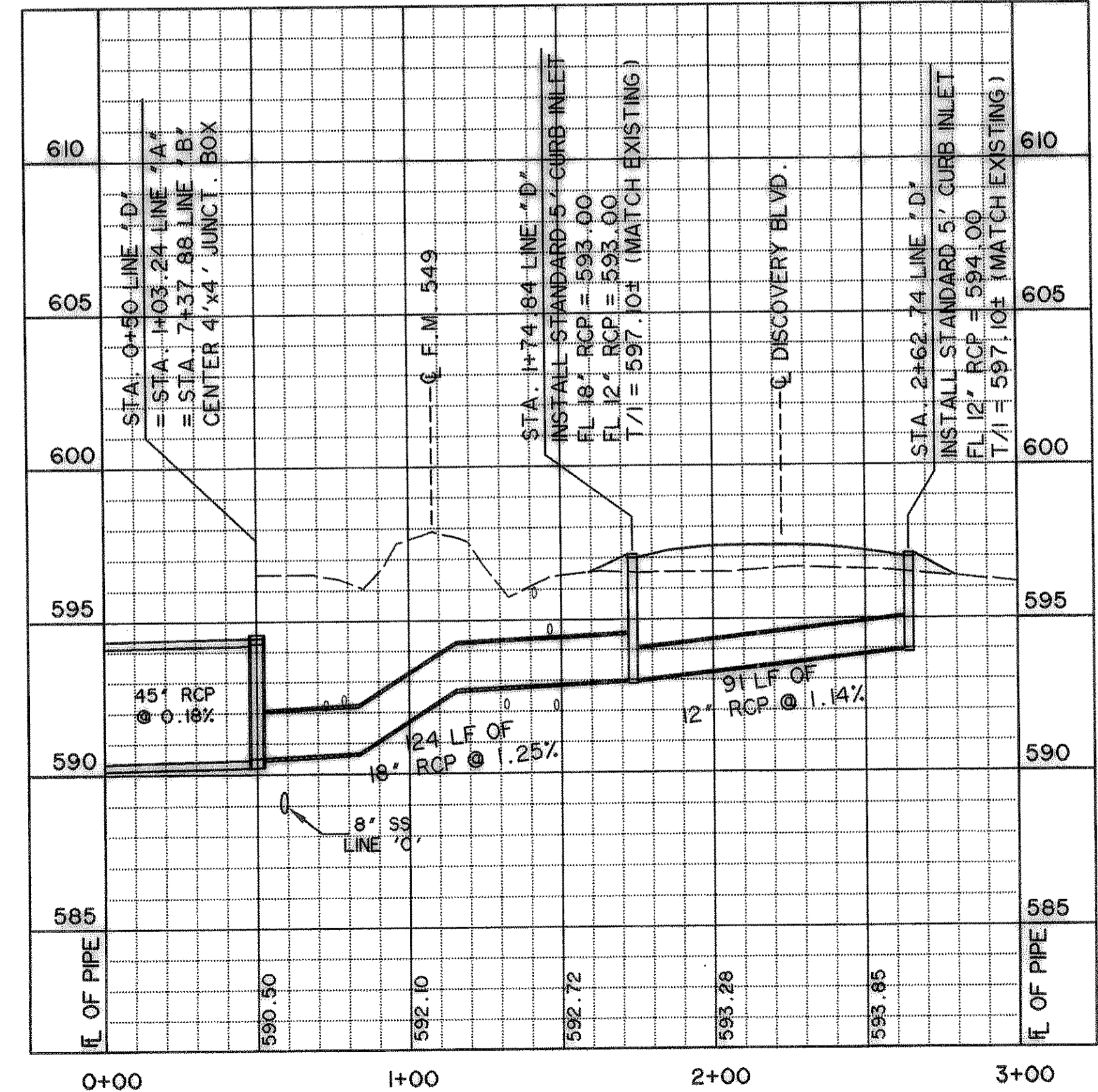

TIME:10:47 FILE:STORMS.dwg