

NOTES

- EXISTING POWER POLES TO BE REMOVED AND RELOCATED BY OTHERS PRIOR TO CONSTRUCTION.

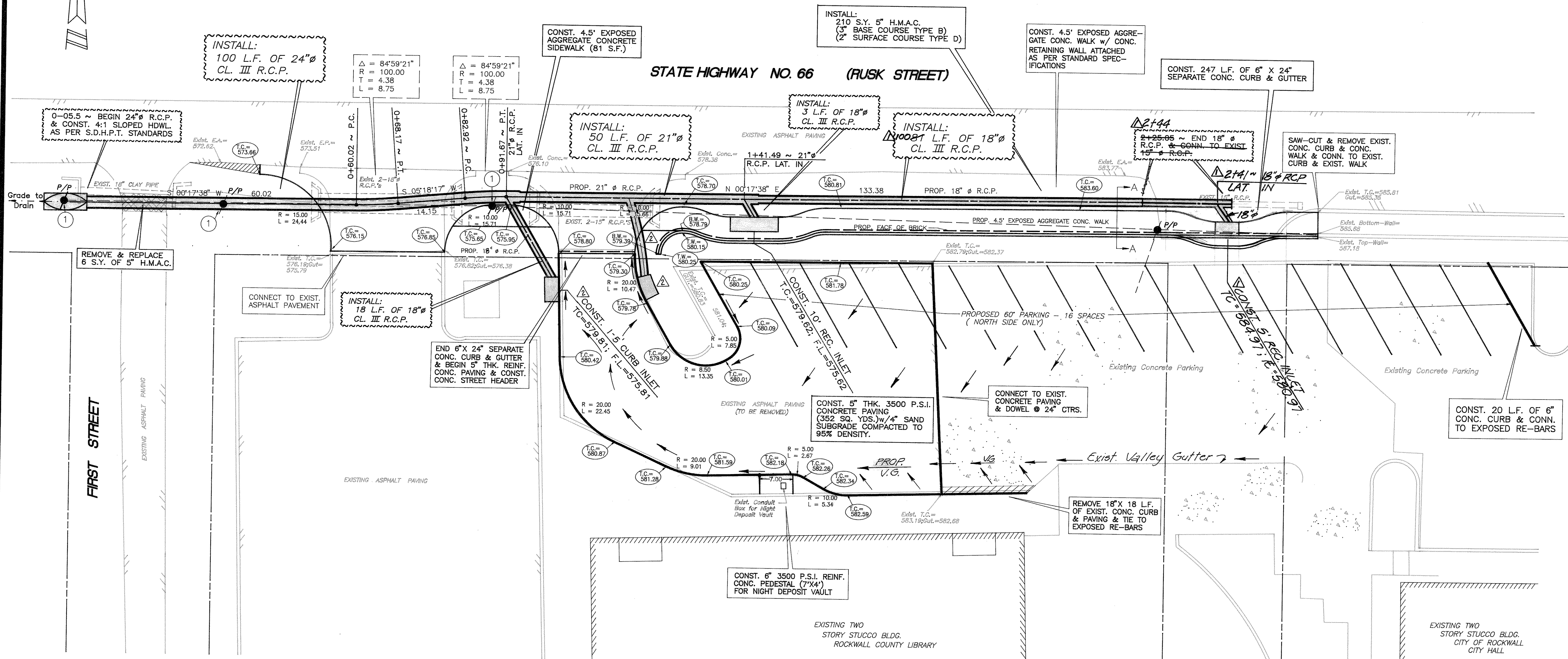

RETAINING WALL NOTES

- All barlaps to be 40 diameter.
- Concrete shall be minimum compressive strength 5 sack 3500 p.s.i. @ 28 days.
- Expansion joint spacing not to exceed 50 feet.
- Sidewalk shall have an exposed aggregate surface similar to existing sidewalk.
- Adjacent curb & gutter shall be poured separately from proposed sidewalk/retaining wall.
- All reinforcing steel shall be Grade 60.

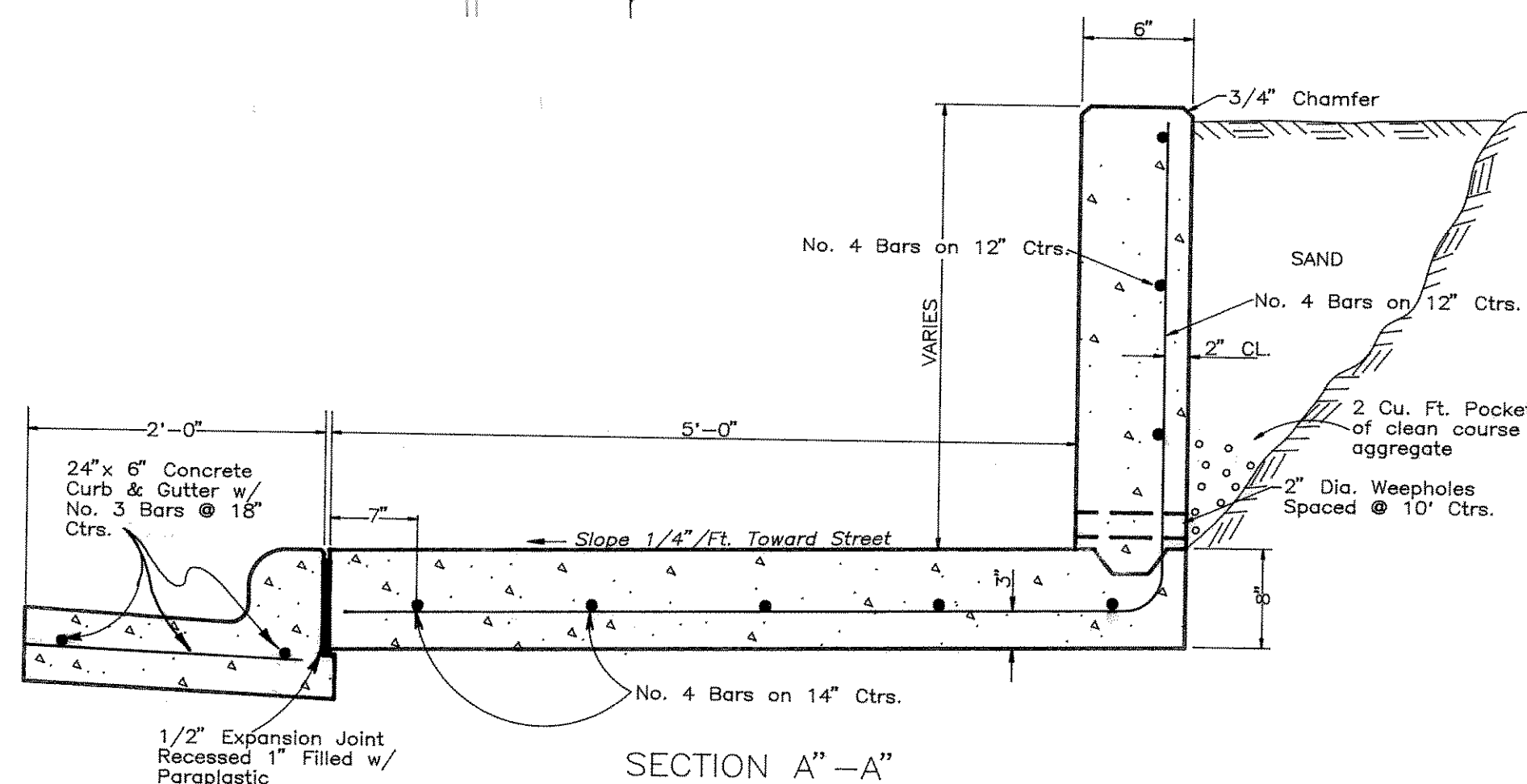

SECTION A-A  
Type 6 Retaining Wall/Sidewalk  
No Scale

LEGEND

- $\Delta$  (T.C. = 581.59) PROPOSED TOP OF CURB & ELEVATION
- $\nabla$  (T.W. = 580.15) PROPOSED TOP OF RETAINING WALL & ELEVATION
- $\square$  (B.W. = 578.81) PROPOSED BOTTOM OF RETAINING WALL & ELEVATION

B.M. ~ R.R. SPIKE IN POWER POLE @ THE S.W. CORNER OF RUSK STREET & WEST STREET.  
ELEV. = 585.03

**PAVING & DRAINAGE IMPROVEMENTS**  
**ROCKWALL COUNTY LIBRARY**  
**ROCKWALL, TEXAS**

CITY OF ROCKWALL  
 "THE NEW HORIZON"

DESIGNED:	B.W.H.	THE SEAL APPEARING ON THIS DOCUMENT WAS AUTHORIZED BY V.L. DOUPHRE II TEXAS P.E. No. 60102 ON 10/24/91
DRAWN:	B.W.H.	
JOB NO.	91005	
DATE:	9/91	SHEET NO. 3 OF 4

REVISION NO.	REMARKS	DATE
1	Revised 18" RCP & Added 5' REC. INLET	12/6/91
2	Change 10' Inlet on W. side to 5' Inlet & Added 5' Inlet on E. side w/ 18" RCP.	12/6/91