

SCALE: 1" = 10'

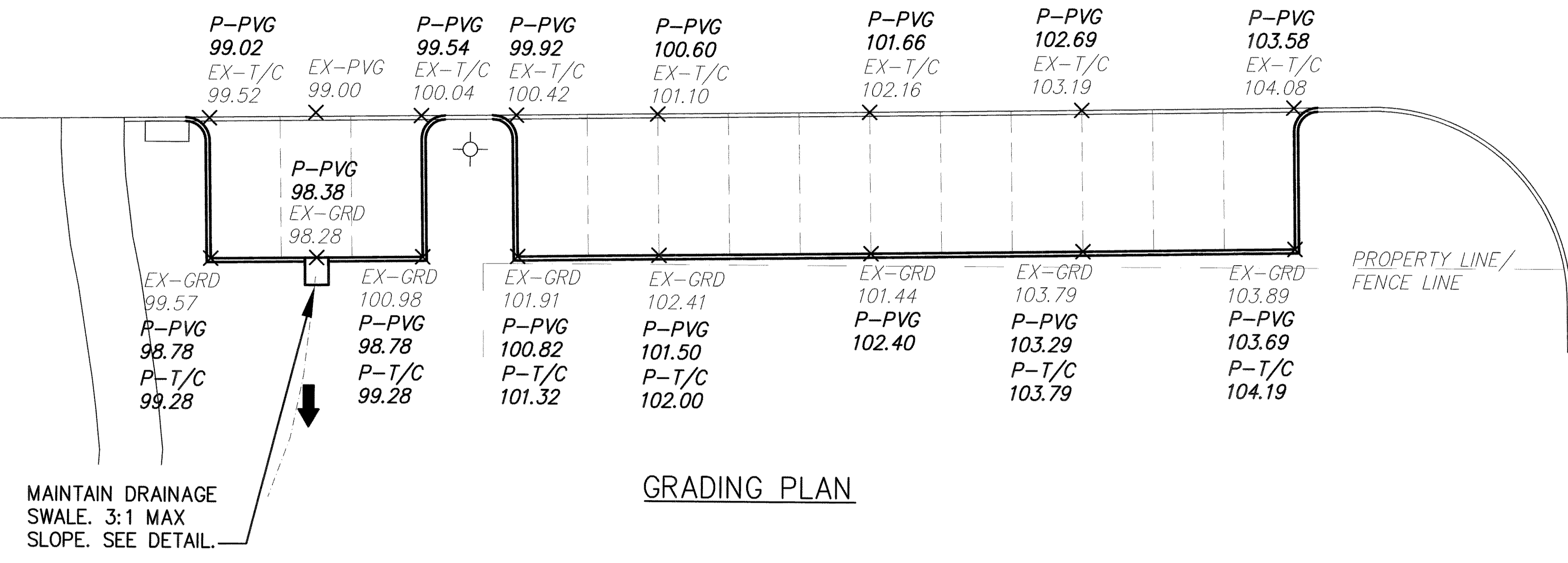

GRADING PLAN

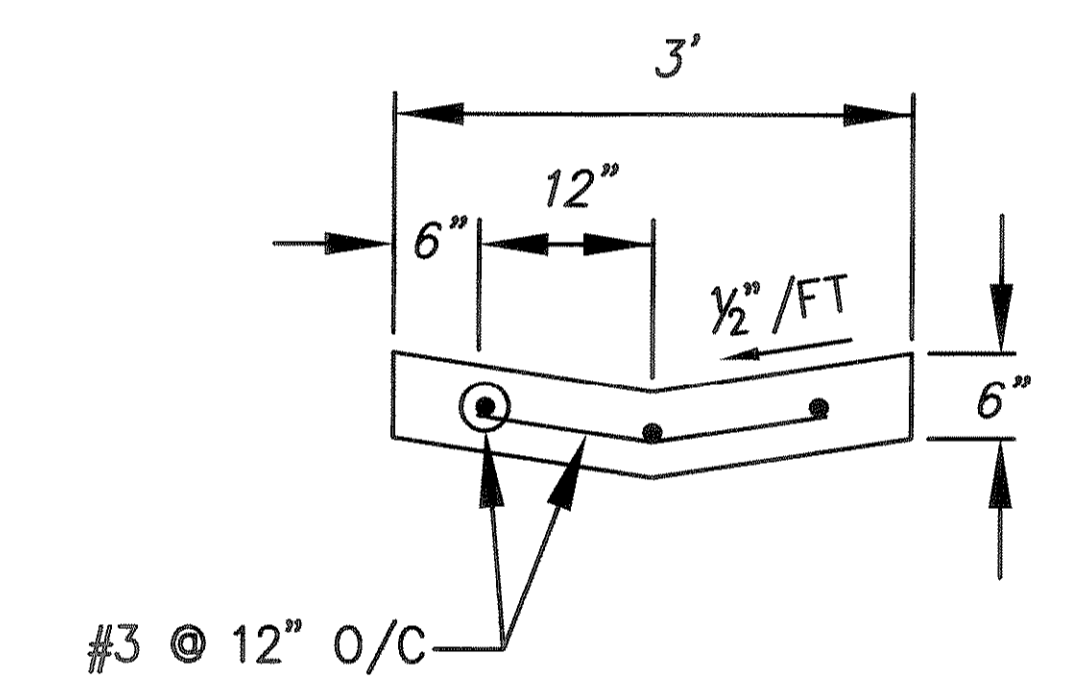
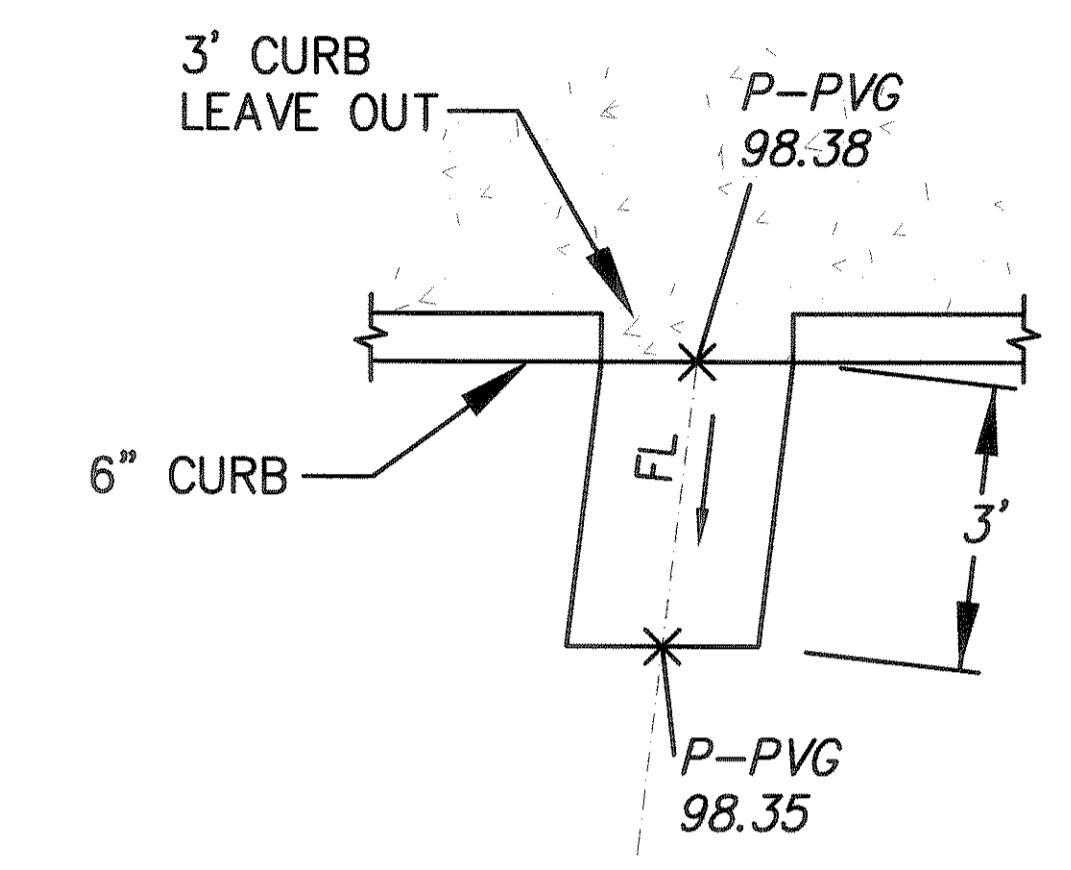

FLUME DETAIL
NTS

NOTES:

1. USE CITY OF ROCKWALL STANDARD DETAILS AND NCTCOG 3RD EDITION DETAILS, AS MODIFIED BY CITY.
2. PARKING SPACES SHALL BE 6" 3600 PSI CONCRETE, 6 1/2 SACK MIN. (HAND FINISH), WITH NO. 3 BARS AT 18" C-C AND BOTH WAYS.
3. ALL TREES TO REMAIN IN PLACE, UNLESS CITY APPROVES REMOVAL.
4. ELEVATIONS ARE BASED ON AN ASSUMED BENCHMARK.

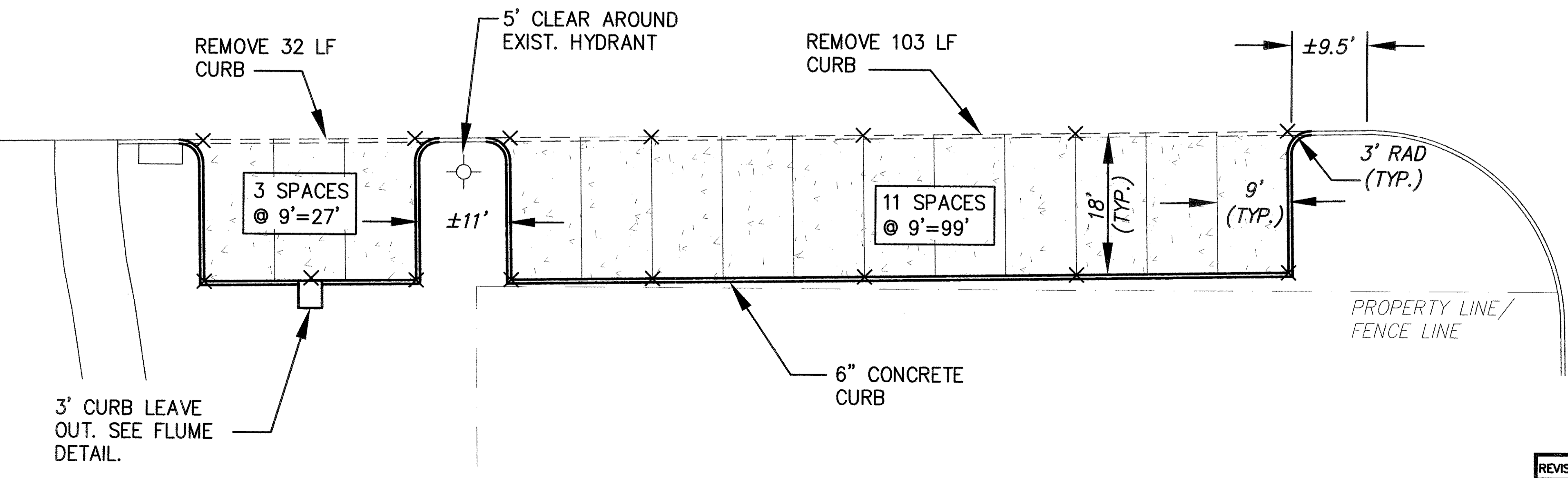

PAVING LAYOUT

REVISION NO.	REMARKS	DATE

SOUTH PARKING
CITY HALL PARKING LOT
ROCKWALL, TEXAS

CITY OF ROCKWALL
"THE NEW HORIZON"

DESIGNED: KRL
DRAWN: ACAD
JOB NO. CITY HALL

THE SEAL APPEARING ON THIS DOCUMENT WAS AUTHORIZED BY KATHLEEN R. LAPPEN, TEXAS P.E. NO. 94603 ON 04-30-08.

DATE: APRIL 2008
SHEET NO. 2 OF 4

KATHLEEN R. LAPPEN
94603
LICENSED PROFESSIONAL ENGINEER