

NOTE:
 CONTRACTOR SHALL FIELD VERIFY THE LOCATION AND DEPTH OF ALL EXISTING UTILITIES (SHOWN ON PLANS OR NOT) PRIOR TO CONSTRUCTION. IF FIELD CONDITIONS DIFFER SIGNIFICANTLY FROM LOCATIONS SHOWN ON PLANS, THE CONTRACTOR SHALL CONTACT THE ENGINEER PRIOR TO PROCEEDING WITH CONSTRUCTION. R-DELTA ENGINEERS, INC. WILL NOT BE RESPONSIBLE FOR ANY WORK BY THE CONTRACTOR NEGLECTING TO LOCATE THESE UTILITIES.

HORIZONTAL ALIGNMENT DATA			
STA.	NORTHING	EASTING	DESCRIPTION
LINE B-1			
0+00	5418.91	4732.02	POB
0+53.74	5458.12	4768.76	P.I.
1+00.00	5504.36	4767.26	POE
LATERAL B-1a			
0+00	5484.84	4767.90	POB
0+06.77	5488.41	4773.65	POE
LATERAL B1b			
0+00	5461.93	4768.62	POB
0+10.62	5467.53	4777.64	POE
LINE B1c			
0+00	5469.92	4768.38	POB
0+04.00	5471.81	4764.85	P.I.
1+81.88	5466.03	4587.06	POE
LATERAL B1c1			
0+00	5466.52	4602.04	POB
0+22.73	5485.82	4590.04	P.I.
0+26.73	5489.72	4590.95	POE
LATERAL B1c2			
0+00	5466.18	4591.57	POB
0+08.73	5458.48	4587.45	POE

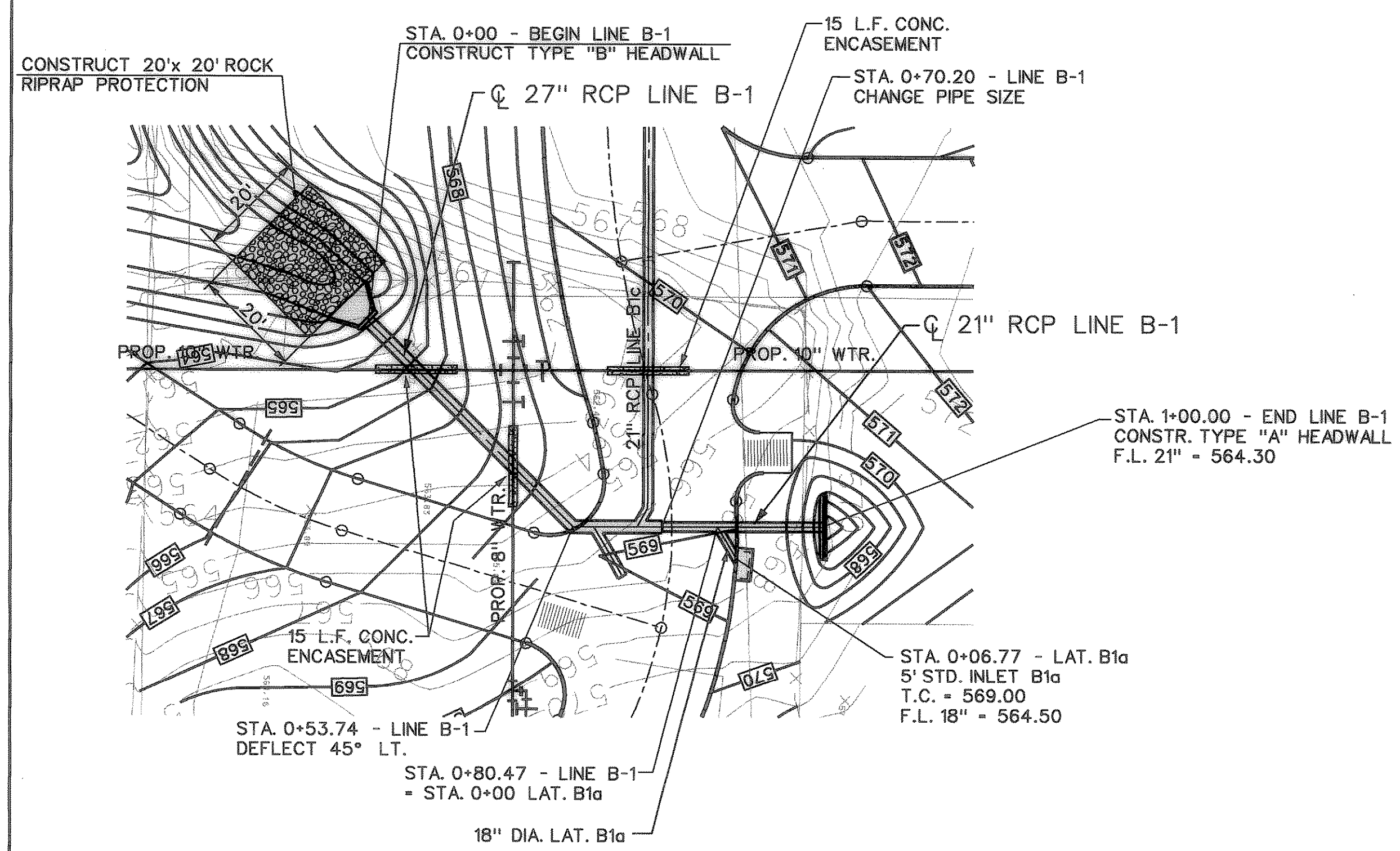

STA. 1+81.88 - END LINE B1c
 CONSTR. CONC. PLUG

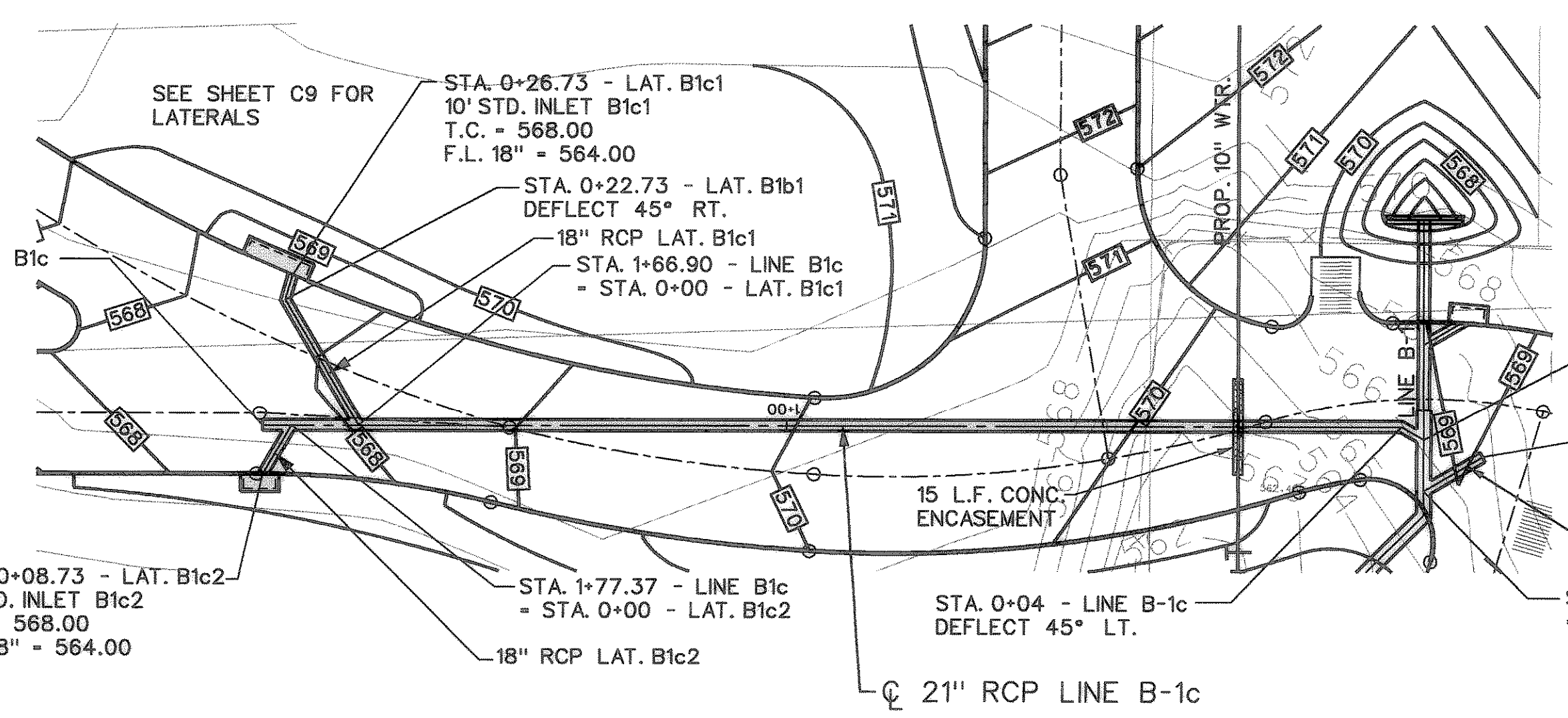

AS-BUILT PLANS
 NOTE: THE INTENT OF THE OWNER AND ENGINEER WAS TO CONSTRUCT THESE IMPROVEMENTS IN ACCORDANCE WITH THESE PLANS AS APPROVED BY THE CITY OF ROCKWALL. THE UTILITIES AND GRADES WERE SET ON THE GROUND FOR CONSTRUCTION ACCORDING TO SAID PLANS AND THE CITY OF ROCKWALL INSPECTED THE CONSTRUCTION. THE OWNER OR ENGINEER DID NOT VERIFY LINES OR GRADES AFTER CONSTRUCTION.

STA. 0+65.55 - LINE B-1
 = STA. 0+00 - LINE B1c

STA. 0+10.62 - END LINE B1b
 CONSTR. CONC. PLUG
 F.L. 21" = 562.49

BENCHMARK:
 FOUND GENERALLY AT THE NORTHWEST CORNER OF S. ALAMO ST. AND WEST WASHINGTON ST. AND LOCATED 4.60' EAST OF THE BACK OF THE CURB ALONG WEST SIDE OF S. ALAMO ST. CITY OF ROCKWALL SURVEY MONUMENT R012 ELEV. = 594.25

PLAN
 SCALE: 1" = 20'

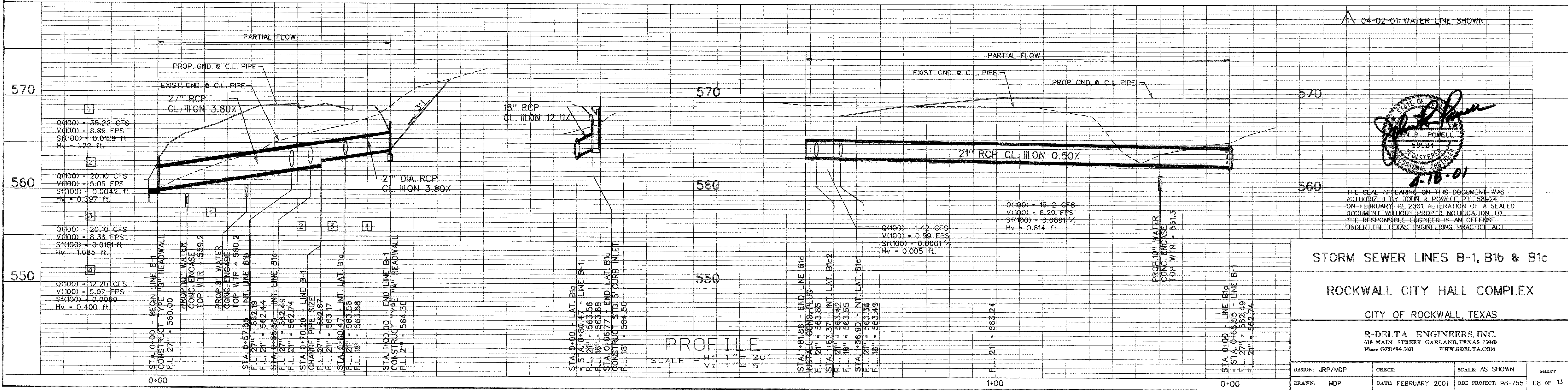

04-02-01: WATER LINE SHOWN

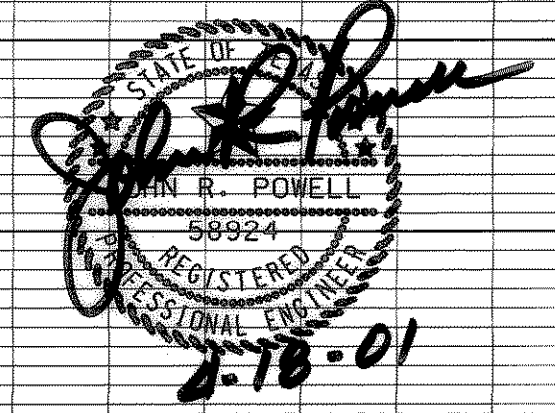

THE SEAL APPEARING ON THIS DOCUMENT WAS AUTHORIZED BY JOHN R. POWELL, P.E. 58924 ON FEBRUARY 12, 2001. ALTERATION OF A SEALED DOCUMENT WITHOUT PROPER NOTIFICATION TO THE RESPONSIBLE ENGINEER IS AN OFFENSE UNDER THE TEXAS ENGINEERING PRACTICE ACT.

STORM SEWER LINES B-1, B1b & B1c
ROCKWALL CITY HALL COMPLEX
 CITY OF ROCKWALL, TEXAS
 R-DELTA ENGINEERS, INC.
 618 MAIN STREET GARLAND, TEXAS 75040
 Phone (972) 934-5051 WWW.RDELTA.COM

DRAWN: MDP	CHECK:	SCALE: AS SHOWN	SHEET
DATE: FEBRUARY 2001	RDE PROJECT: 98-755		CB OF 13