

ROCKWALL CITY HALL COMPLEX

REVISIONS:

- 1 04-02-01: MISC. REVISIONS PER PRE-CONSTRUCTION MEETING
 - COVER SHEET - ADDRESS CHANGE
 - SITE PLAN - REVISE REQ'D. PARKING, MONITORING WELL NOTE, ADD COORDINATES
 - GRADING 2 - MONITORING WELL NOTE
 - STORM LINE A & C - WATER LINE RELOCATION (SEE WATER LAYOUT)
 - STORM LINE B1 & B1b - TURN ON WTR LEVEL
 - STORM LINE B2 & LATS. - REVISE STORM LINE ADD STORM MANHOLE
 - WATER MAIN LAYOUT - REVISE WTR LINE @ S.H. 205 AND SAN JANCINTO ST.
 - TREE SURVEY
- 2 05-08-01:
 - SITE PLAN - REALIGN ENTRANCE DRIVE AT SH205 PER TxU. WIDEN FIRE LANE TO 20' AS DIRECTED BY CITY. REVISE BOUNDARY CALLS TO MATCH PLAT.
 - DIMENSIONAL CONTROL PLAN - ADD DIMENSIONAL CONTROL PLAN TO PROJECT CONSTRUCTION DOCUMENTS.

385 S. GOLIAD STREET
ROCKWALL, TEXAS

CIVIL SITE IMPROVEMENT PLANS

SHEET INDEX

- 1 FINAL PLAT
- 2 SITE PLAN
- 2A DIMENSIONAL CONTROL PLAN
- 3 GRADING PLAN - SHEET 1 of 3 (NORTH)
- 4 GRADING PLAN - SHEET 2 of 3 (SOUTH)
- 5 GRADING PLAN - SHEET 3 of 3 (ADA ACCESSIBLE ENTRANCE)
- 6 DRAINAGE AREA MAP
- 7 STORM SEWER - LINE A & LINE C
- 8 STORM SEWER - LINES B-1, B-1b, & B-1c
- 9 STORM SEWER - LINE B-2 & LATERALS B-1c1 & B-1c2
- 10 WATER MAIN LAYOUT
- 11 SANITARY SEWER PLAN & PROFILES LINES A & B
- 12 EROSION CONTROL LAYOUT
- 13 TREE SURVEY

ATTENTION !

- The Contractor shall notify the Engineering Department at (972) 771-7790, a minimum of three (3) working days prior to start of construction so a preconstruction meeting can be scheduled and an inspector assigned. The following items shall be completed prior to start of construction.
- Plans must be stamped "Released for Construction" by the City of Rockwall Engineering Department.
 - The Final Plat, if required, must be approved by the Plan Commission.
 - Pro-rata must be paid.
 - All easements shall be filed with Rockwall County and copies provided to the Engineering Department (unless the easement will be on the plat).
 - A General Repair Bond shall be posted by the contractor responsible for the public works improvements prior to the start of construction.
 - A right-to-work permit is required from the Engineering Department prior to any work in the City right-of-way or easements. A sidewalk bond and permit is required for all sidewalk and approaches.
 - The Developer is responsible for obtaining all state and federal permits.
 - For floodplain properties a Conditional Letter of Map Revision (CLOMR) shall be submitted to the City for review and then to FEMA (if applicable). After the project is complete and prior to acceptance a Letter of Map Revision (LOMR) shall be submitted to FEMA.
 - A development permit is required for any project in a floodplain.
 - All construction projects shall have a complete Erosion Control Plan on the site at all times. A contractor certification must be submitted for each contractor on the job. For all projects over 5 acres and common plans of development, two Notices of Intent (NOI) shall be sent to the EPA (owner and general contractor), with copies of each NOI provided to the City.

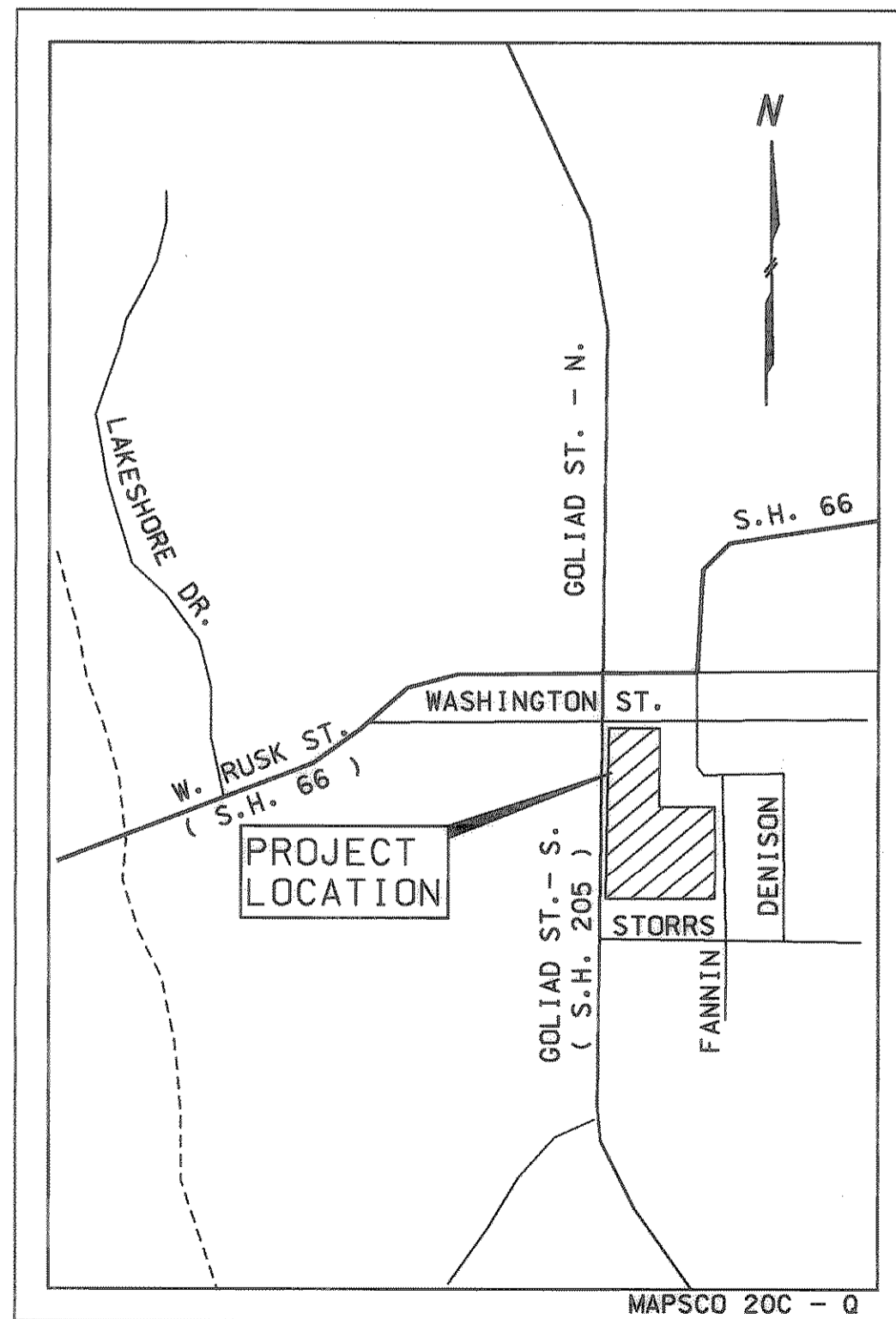

VICINITY MAP

AS-BUILT PLANS

NOTE: THE INTENT OF THE OWNER AND ENGINEER WAS TO CONSTRUCT THESE IMPROVEMENTS IN ACCORDANCE WITH THESE PLANS AS APPROVED BY THE CITY OF ROCKWALL. THE UTILITIES AND GRADES WERE SET ON THE GROUND FOR CONSTRUCTION ACCORDING TO SAID PLANS AND THE CITY OF ROCKWALL INSPECTED THE CONSTRUCTION. THE OWNER OR ENGINEER DID NOT VERIFY LINES OR GRADES AFTER CONSTRUCTION.

PREPARED BY :

R-DELTA ENGINEERS, INC.
618 MAIN STREET GARLAND, TEXAS 75040
PHONE: (972)-494-5031 WWW.R-DELTA.COM

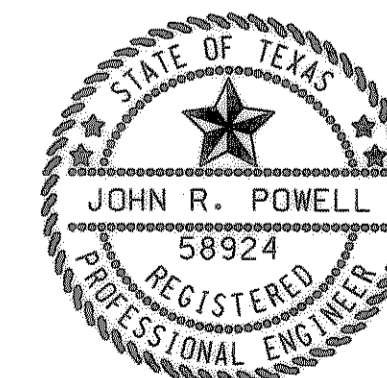

THE SEAL APPEARING ON THIS DOCUMENT WAS AUTHORIZED BY JOHN R. POWELL, P.E. 58924 ON FEBRUARY 12, 2001. ALTERATION OF A SEALED DOCUMENT WITHOUT PROPER NOTIFICATION TO THE RESPONSIBLE ENGINEER IS AN OFFENSE UNDER THE TEXAS ENGINEERING PRACTICE ACT.

OWNER:

CITY OF ROCKWALL
205 W. RUSK STREET
ROCKWALL, TEXAS 75087
(972) 771-7700

15 SHEETS PER SET
INCLUDING COVER SHEET.