

• BENCHMARKS •

| | |
|--|--------------|
| GPS CONTROL MONUMENT #7 AT SOUTHEAST CORNER OF 1-30 AND MIMS STREET. | ELEV. 566.25 |
| BOX CUT IN NW CURB RETURN AT THE INTERSECTION OF WESTWOOD AND ROCKWALL PARKWAY. | ELEV. 537.86 |
| BOX CUT IN NW CURB RETURN AT THE INTERSECTION OF WOODCREEK AND ROCKWALL PARKWAY. | ELEV. 528.53 |

CAUTION !!!
UNDERGROUND UTILITIES

EXISTING UTILITIES AND UNDERGROUND FACILITIES INDICATED ON THESE PLANS HAVE BEEN LOCATED FROM REFERENCE INFORMATION SUPPLIED BY VARIOUS OWNERS OF THE FACILITIES. THE ENGINEER DOES NOT ACCEPT THE RESPONSIBILITY FOR THE UTILITY LOCATIONS SHOWN, IT SHALL BE THE RESPONSIBILITY OF THE CONTRACTOR TO VERIFY BOTH HORIZONTALLY AND VERTICALLY THE LOCATION OF ALL EXISTING UTILITIES AND UNDERGROUND FACILITIES PRIOR TO CONSTRUCTION, TO TAKE NECESSARY PRECAUTIONS IN ORDER TO PROTECT ALL FACILITIES ENCOUNTERED, AND TO NOTIFY THE ENGINEER PROMPTLY OF ALL CONFLICTS OF THE WORK WITH EXISTING FACILITIES. THE CONTRACTOR SHALL PRESERVE AND PROTECT ALL EXISTING UTILITIES FROM DAMAGE DURING CONSTRUCTION. ANY DAMAGE BY THE CONTRACTOR TO EXISTING UTILITIES SHALL BE REPAIRED BY THE CONTRACTOR AT HIS EXPENSE.

| CURVE C1501 | | CURVE C1505 | |
|-------------|-----------|-------------|-----------|
| A | 40°15'53" | A | 06°47'00" |
| D | 10°06'52" | D | 22°55'06" |
| R | 566.48 | R | 250.00 |
| T | 207.67 | T | 14.82 |
| L | 398.10 | L | 29.60 |
| E | 36.86 | E | 0.44 |

TRUSTEES OF THE ROCKWALL INDEPENDANT SCHOOL DISTRICT
VOL. 137, PG. 214
D.R.R.C.T.

STA 9+90.52 WATER LINE "A"
= 36' LT. ST. STA 45+85.94
PC1505

RW MARKETCENTER ASSOCIATES, LTD.
VOL. 1395, PG. 71
D.R.R.C.T.

STA 8+29.45 WATER LINE "A"
= 36' LT. ST. STA 44+24.84
PT1501

STA 9+24.61 W.L. "A"
= 36.00' RT. ST. STA 45+20.00
INSTALL: 1-12" G.V.
1-12" X 6" ANCHORING HYDRANT TEE
1-6" G.V.
1-FIRE HYDRANT

CHAIN LINK FENCE

STA 9+33.77 W.L. "A"
P.I.

TEMPORARY CONST. EASEMENT

TEMPORARY CONST. EASEMENT

SHEPHERD PLACE HOMES, INC.
VOL. 1289, PG. 150
D.R.R.C.T.

MATCH LINE STA 5+00

MATCH LINE STA 10+00

BLOCK "A" LYNDEN PARK ESTATES PHASE 1A
CAB. "D", SLIDE 125
P.R.R.C.T.

BLOCK "A" LYNDEN PARK ESTATES PHASE 1A
CAB. "D", SLIDE 125
P.R.R.C.T.



WATER LINE "A"

*NOTE: ALL PVC WATER LINE SHALL BE C-900 CLASS 200 PIPE ALL CHANGES IN WATER LINE DIRECTION (BENDS) SHALL BE RESTRAINED (MEGA LUG OR EQUAL) AND CONCRETE BLOCKED. THE NEXT JOINT EITHER SIDE OF THE CHANGE OF DIRECTION SHALL ALSO BE RESTRAINED.

SCALE: HORIZ. 1" = 20'
VERT. 1" = 5'

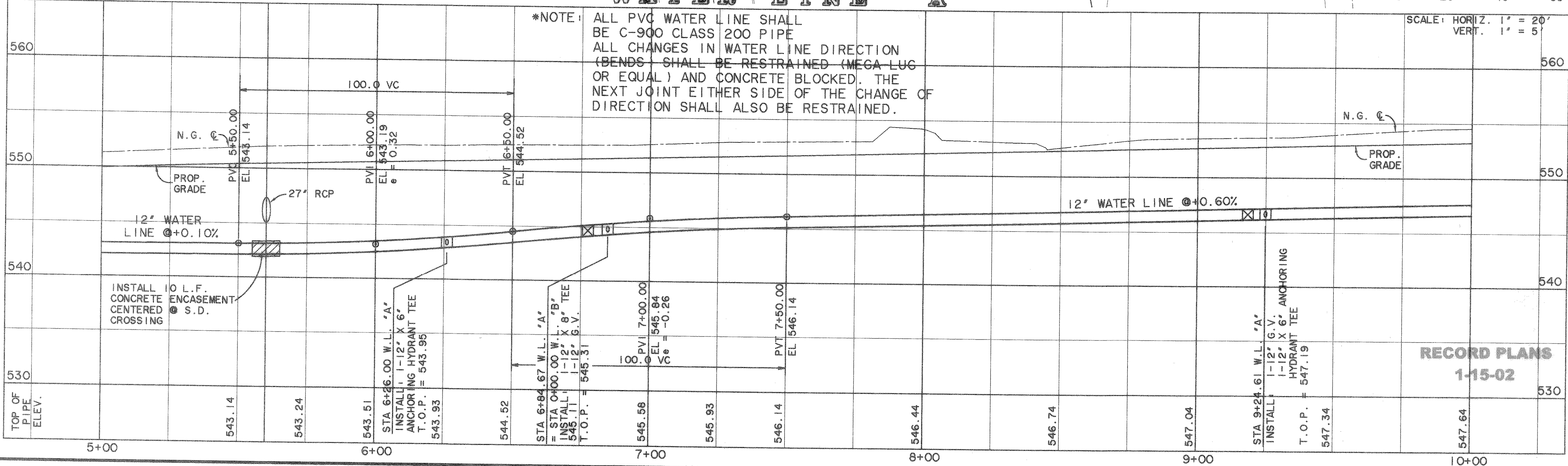

PREPARED BY:
VIA WIER & ASSOCIATES, INC.
ENGINEERS SURVEYORS LAND PLANNERS
4300 BELTWAY PLACE SUITE 130 ARLINGTON, TEXAS 76018 METRO (817)467-7700
4108 AMON CANTER BLVD. SUITE 200 FORT WORTH, TEXAS 76155 METRO (817)355-9437

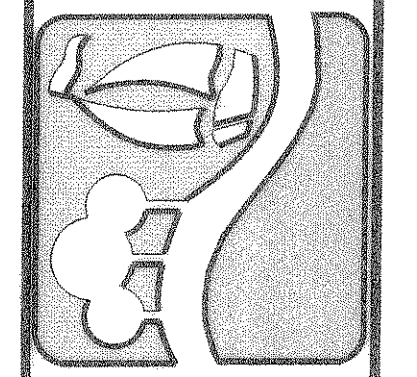

WATER LINE
PLAN & PROFILE
STA 5+00 TO 10+00

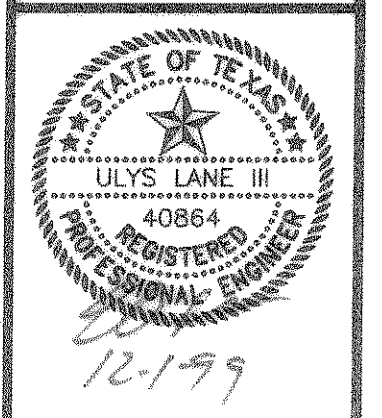

COPYRIGHT ©
WIER & ASSOCIATES, INC.
LAST SHEET EDIT
DATE 11-29-99
WA# 97057
SHEET NO.
36