

**CAUTION !!!  
UNDERGROUND UTILITIES**

EXISTING UTILITIES AND UNDERGROUND FACILITIES INDICATED ON THESE PLANS HAVE BEEN LOCATED FROM REFERENCE INFORMATION SUPPLIED BY VARIOUS OWNERS OF THE FACILITIES. THE ENGINEER DOES NOT ACCEPT THE RESPONSIBILITY FOR THE UTILITY LOCATIONS SHOWN. IT SHALL BE THE RESPONSIBILITY OF THE CONTRACTOR TO VERIFY BOTH HORIZONTALLY AND VERTICALLY THE LOCATION OF ALL EXISTING UTILITIES AND UNDERGROUND FACILITIES PRIOR TO CONSTRUCTION, TO TAKE NECESSARY PRECAUTIONS IN ORDER TO PROTECT ALL FACILITIES ENCOUNTERED, AND TO NOTIFY THE ENGINEER PROMPTLY OF ALL CONFLICTS OF THE WORK WITH EXISTING FACILITIES. THE CONTRACTOR SHALL PRESERVE AND PROTECT ALL EXISTING UTILITIES FROM DAMAGE DURING CONSTRUCTION. ANY DAMAGE BY THE CONTRACTOR TO EXISTING UTILITIES SHALL BE REPAIRED BY THE CONTRACTOR AT HIS EXPENSE.

CURVE C1517		CURVE C1518		CURVE C1519	
A	35°26'56"	A	05°25'58"	A	44°36'28"
D	09°11'23"	D	09°51'12"	D	38°11'50"
R	623.48	R	581.48	R	150.00
T	199.27	T	27.59	T	61.53
L	385.75	L	55.13	L	116.78
E	31.07	E	0.65	E	12.13

R W MARKETCENTER ASSOCIATES, LTD.  
VOL. 1395, PG. 71  
D.R.R.C.T.

• BENCHMARKS •

GPS CONTROL MONUMENT #7 AT SOUTHEAST CORNER OF I-30 AND 8115 STREET.	ELEV. 566.25
BOX CUT IN NW CURB RETURN AT THE INTERSECTION OF WESTWOOD AND ROCKWALL PARKWAY.	ELEV. 537.86
BOX CUT IN NW CURB RETURN AT THE INTERSECTION OF WOODCREEK AND ROCKWALL PARKWAY.	ELEV. 526.53

PREPARED BY:  
**VIA WIER & ASSOCIATES, INC.**  
ENGINEERS SURVEYORS LAND PLANNERS  
4330 BELTWAY PLACE SUITE 130 ARLINGTON, TEXAS 76016 METRO (817)467-7700  
4108 AMON CENTER BLD. SUITE 200 FORT WORTH, TEXAS 76116 METRO (817)505-3437

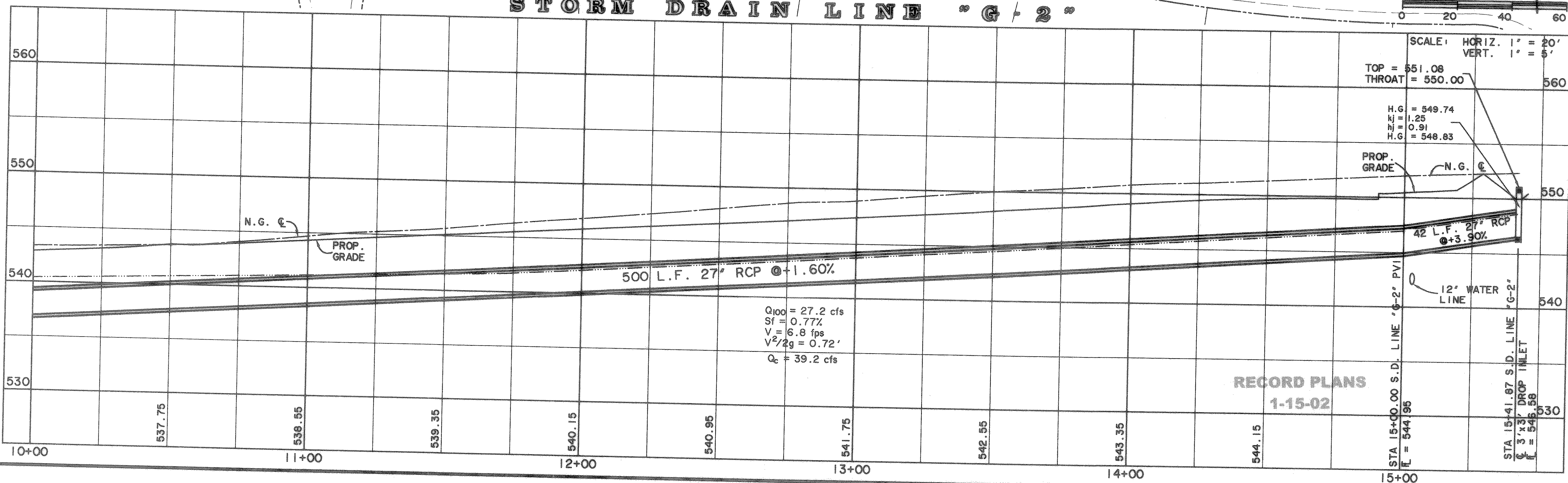
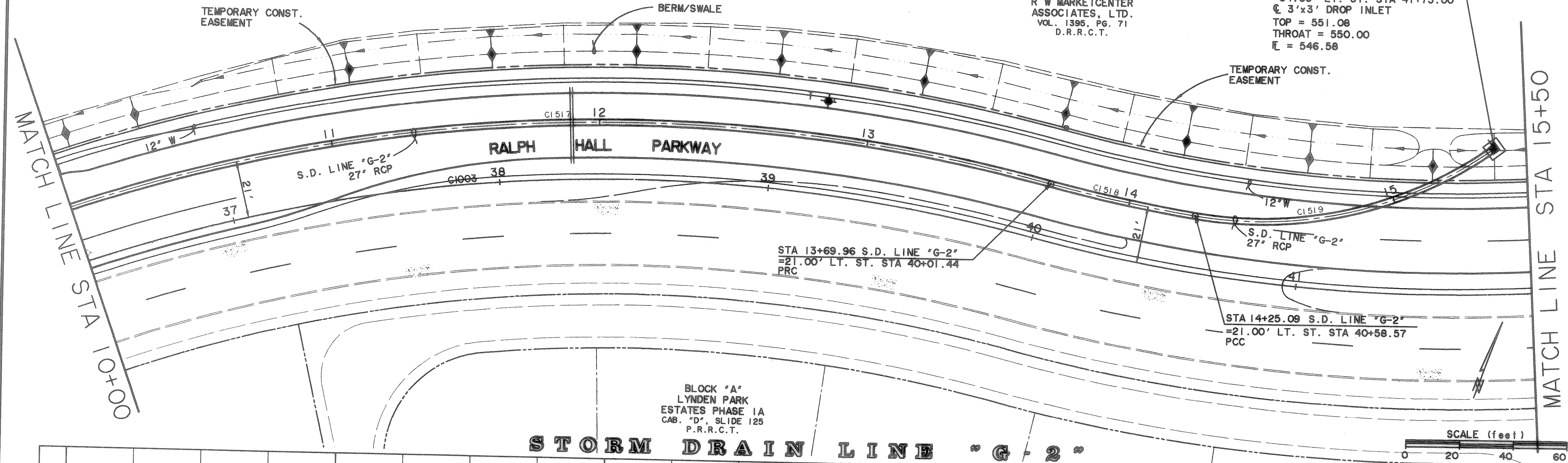

$$Q_{100} = 27.2 \text{ cfs}$$

$$S_f = 0.77\%$$

$$V = 6.8 \text{ fps}$$

$$V^2/2g = 0.72'$$

$$Q_c = 39.2 \text{ cfs}$$

RECORD PLANS  
1-15-02

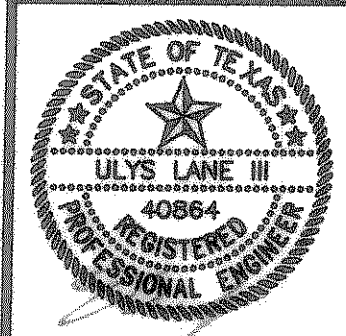

10-14-99  
COPYRIGHT ©  
WIER & ASSOCIATES, INC.  
LAST SHEET EDIT  
DATE 10-14-99  
WAA# 97057  
SHEET NO.  
28

TIME: 7/1/21  
FILE: SPPP12.dwg