

TIME: 6:29 FILE: PAVE23.dwg

NO.	RADIUS	DELTA	ARC TANGENT	CHORD	BEARING
1164	250.00	09°29'00"	41.38	20.74	41.33 S 34°03'34"E
1167	427.50	07°03'31"	52.67	26.37	52.63 S 42°19'49"E

STATE OF TEXAS
VOL. 65, PG. 591
D.R.R.C.T.

REFER TO SHEET 18A FOR MIMS ROAD
STA 0+00 TO STA 5+45

* BENCHMARKS *	
GPS CONTROL MONUMENT #7 AT SOUTHEAST CORNER OF 1-30 AND MIMS STREET.	ELEV. 566.25
BOX CUT IN NW CURB RETURN AT THE INTERSECTION OF WESTWOOD AND ROCKWALL PARKWAY.	ELEV. 537.86
BOX CUT IN NW CURB RETURN AT THE INTERSECTION OF WOODCREEK AND ROCKWALL PARKWAY.	ELEV. 528.53

36.00' LT. ST. STA 2+50.00
CONST. 4'x4' "Y" INLET
W/ CONC. APRON
TOP = 564.58
THROAT = 563.50
R = 560.08

CURVE C1019	
ANGLE	13°18'23"
DELTA	19°05'55"
CHORD	300.00
TANGENT	34.99
ARC	69.67
OFFSET	2.03

35.00' RT. ST. STA 4+35.00
CONST. 3'x3' "Y" INLET
W/ CONC. APRON
TOP = 563.33
THROAT = 562.25
R = 558.33

LOT 4, BLOCK "A"
ROCKWALL MARKET
CENTER EAST

CAUTION !!!
UNDERGROUND UTILITIES

ROCKWALL INDEPENDENT
SCHOOL DISTRICT
VOL. 1074, PG. 214
D.R.R.C.T.

EXISTING UTILITIES AND UNDERGROUND FACILITIES INDICATED ON THESE PLANS HAVE BEEN LOCATED FROM REFERENCE INFORMATION SUPPLIED BY VARIOUS OWNERS OF THE FACILITIES. THE ENGINEER DOES NOT ACCEPT THE RESPONSIBILITY FOR THE UTILITY LOCATIONS SHOWN, IT SHALL BE THE RESPONSIBILITY OF THE CONTRACTOR TO VERIFY BOTH HORIZONTALLY AND VERTICALLY THE LOCATION OF ALL EXISTING UTILITIES AND UNDERGROUND FACILITIES PRIOR TO CONSTRUCTION, TO TAKE NECESSARY PRECAUTIONS IN ORDER TO PROTECT ALL FACILITIES ENCOUNTERED, AND TO NOTIFY THE ENGINEER PROMPTLY OF ALL CONFLICTS OF THE WORK WITH EXISTING FACILITIES. THE CONTRACTOR SHALL PRESERVE AND PROTECT ALL EXISTING UTILITIES FROM DAMAGE DURING CONSTRUCTION. ANY DAMAGE BY THE CONTRACTOR TO EXISTING UTILITIES SHALL BE REPAIRED BY THE CONTRACTOR AT HIS EXPENSE.

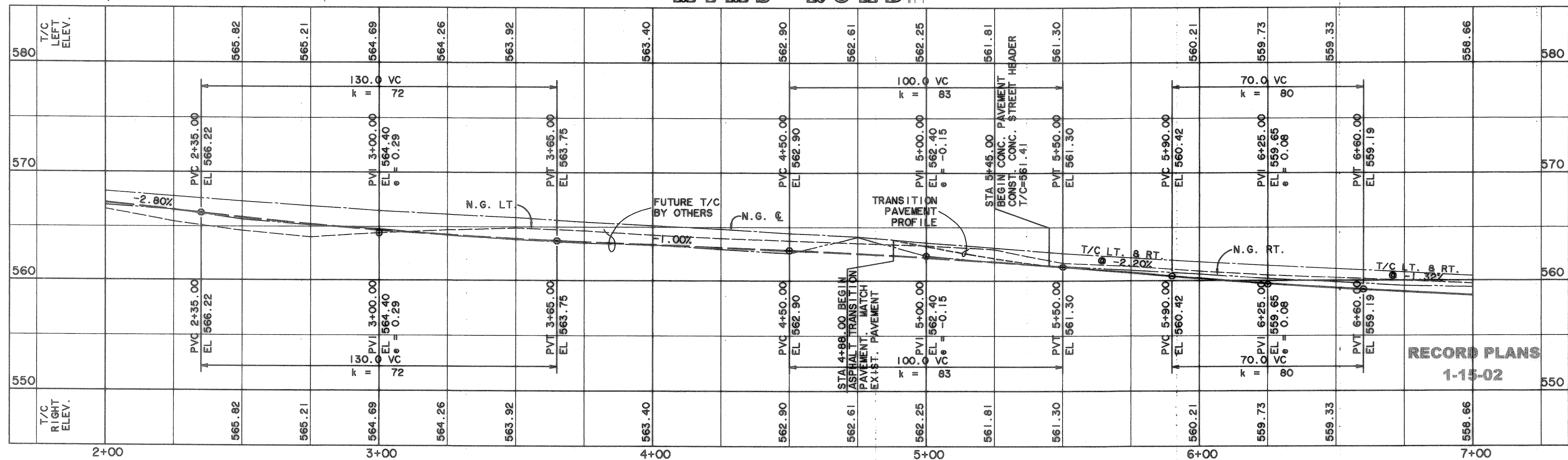
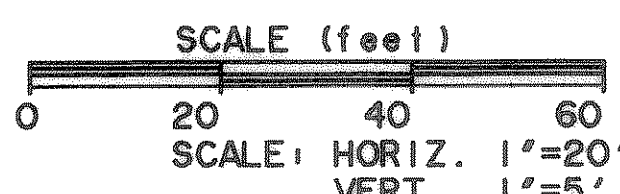

MATCH LINE STA 7+00

REFER TO SHEET 54
STRIPING LAYOUT

TEMPORARY CONST.
EASEMENT

15:1 PARKWAY CROSS-SLOPE

TEMPORARY CONST.
EASEMENT

MIMS ROAD

PREPARED BY:
VIA WIER & ASSOCIATES, INC.
ENGINEERS SURVEYORS LAND PLANNERS
4300 BELLEVUE PLACE, SUITE 130 ARLINGTON, TEXAS 76018 METRO (817)467-7700
4108 AMON CANTREY BLVD. SUITE 200 FORT WORTH, TEXAS 76155 METRO (817)325-9457

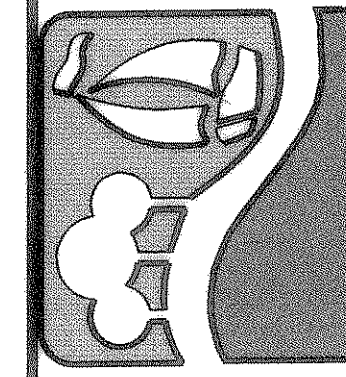

MIMS ROAD
PAVING PLAN & PROFILE
STA 5+45 TO 7+00

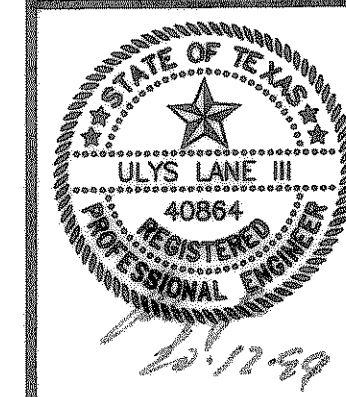

COPYRIGHT ©
WIER & ASSOCIATES, INC.
LAST SHEET EDIT
DATE: 06-11-99
WA# 97057
SHEET NO. 18B