

DIVISION ISLAND

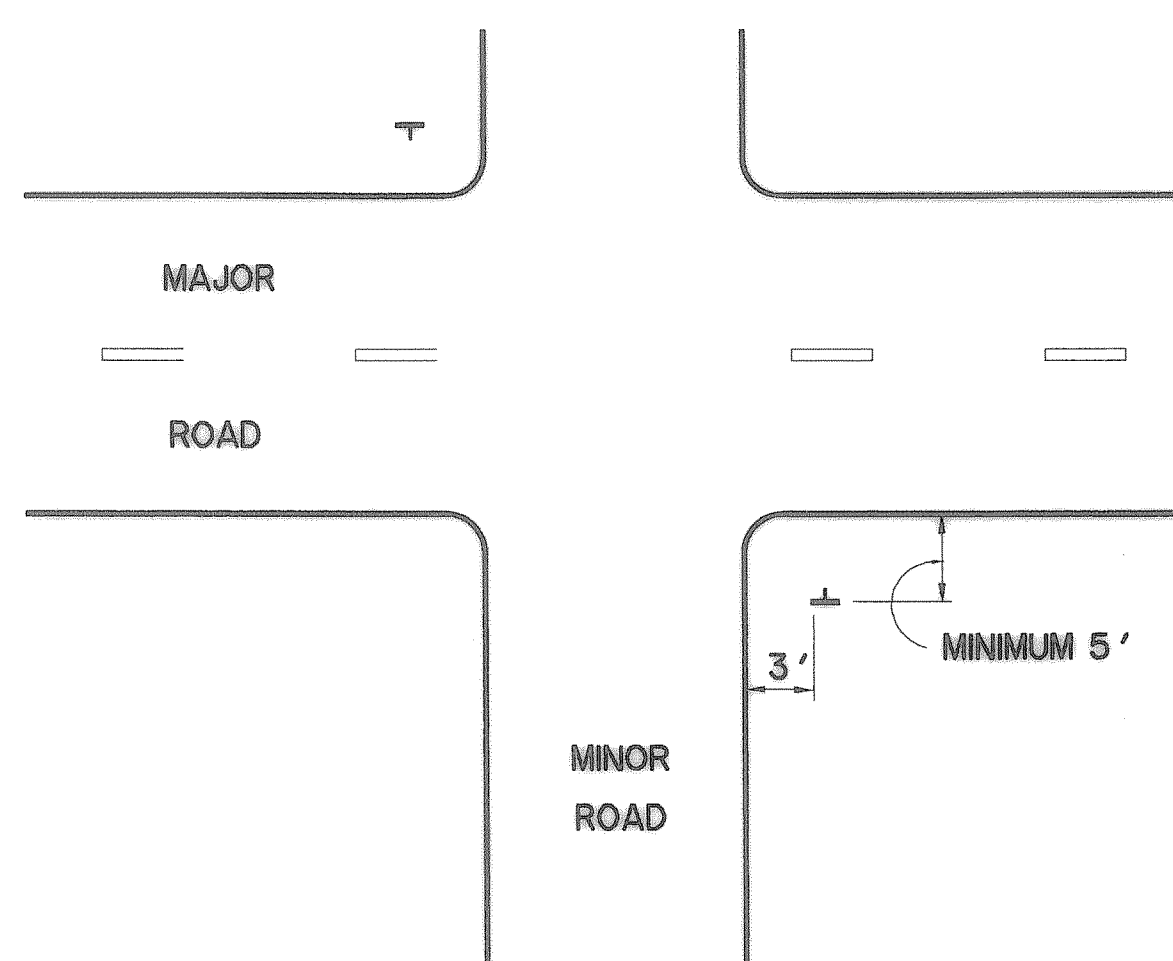

URBAN CROSS ROAD
N.T.S.

STREET SIGN PLACEMENT

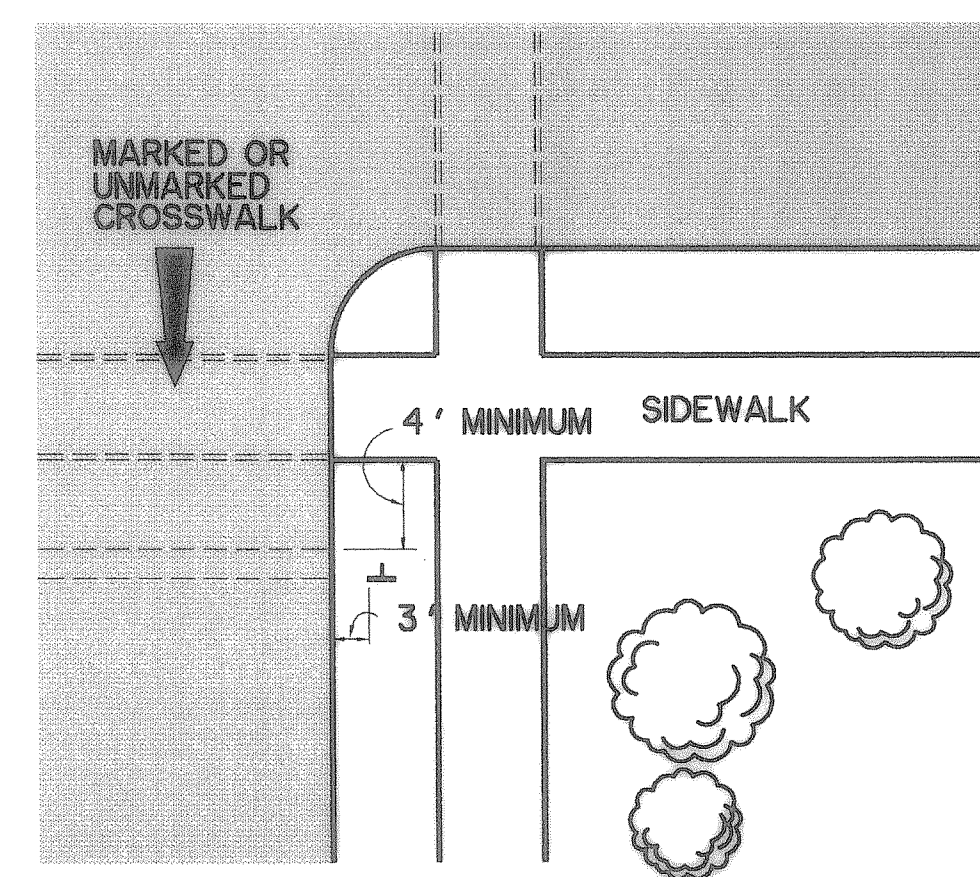

URBAN INTERSECTION
N.T.S.

STREET SIGN PLACEMENT

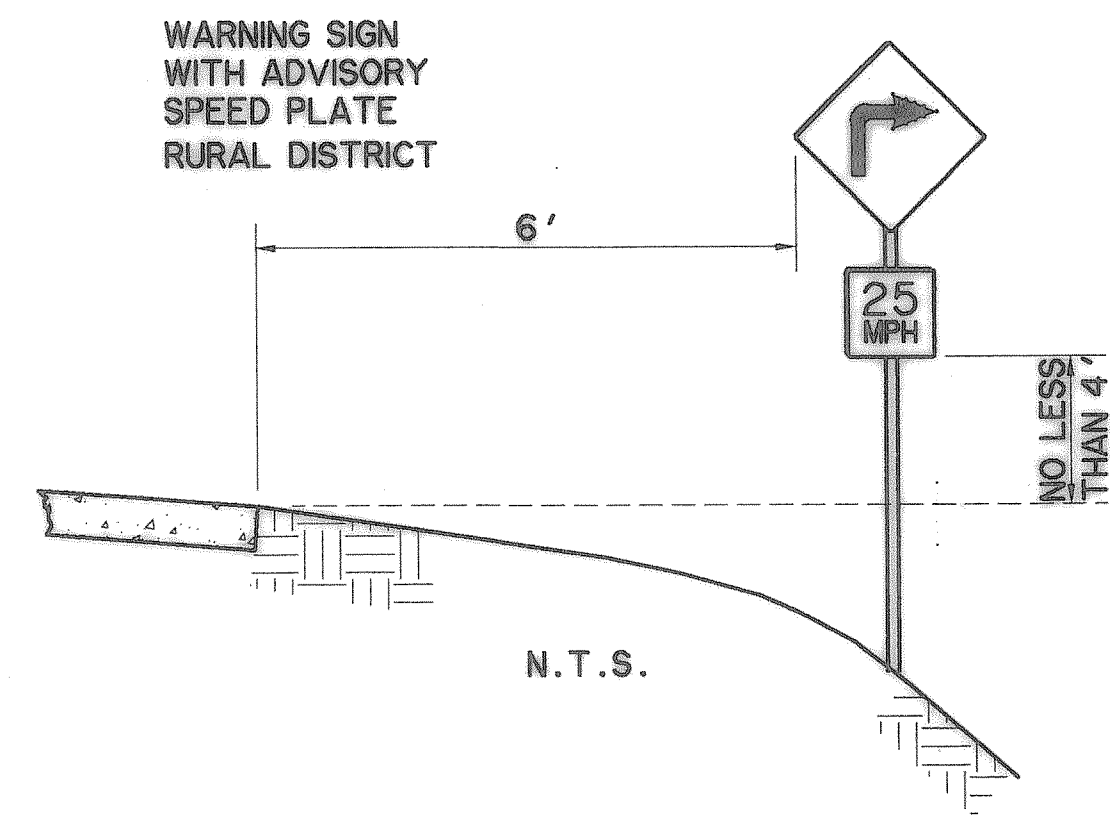

WARNING SIGN WITH ADVISORY SPEED PLATE RURAL DISTRICT

N.T.S.

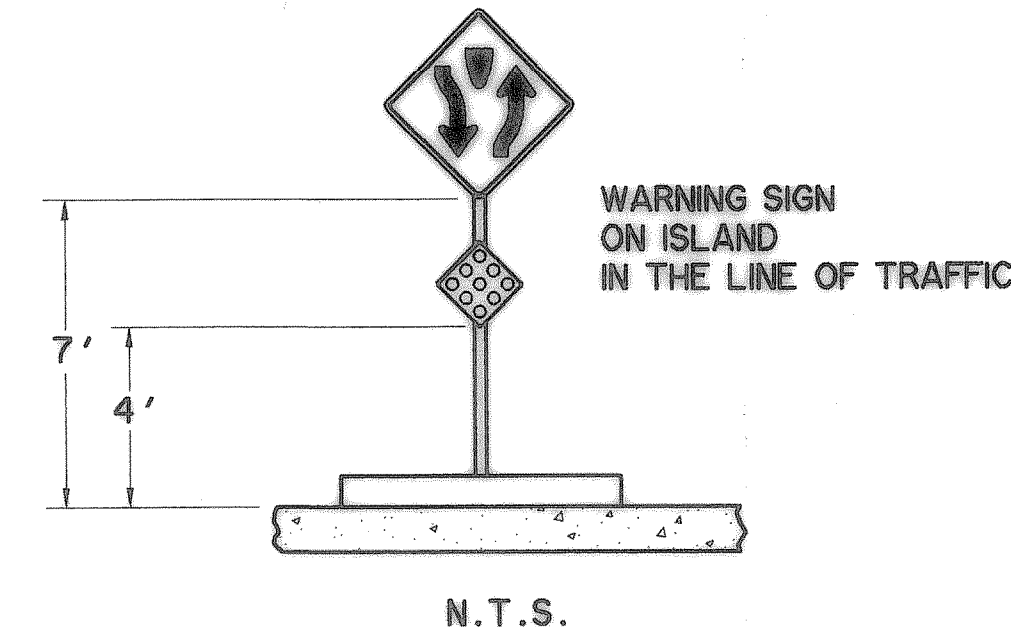

WARNING SIGN ON ISLAND IN THE LINE OF TRAFFIC

N.T.S.

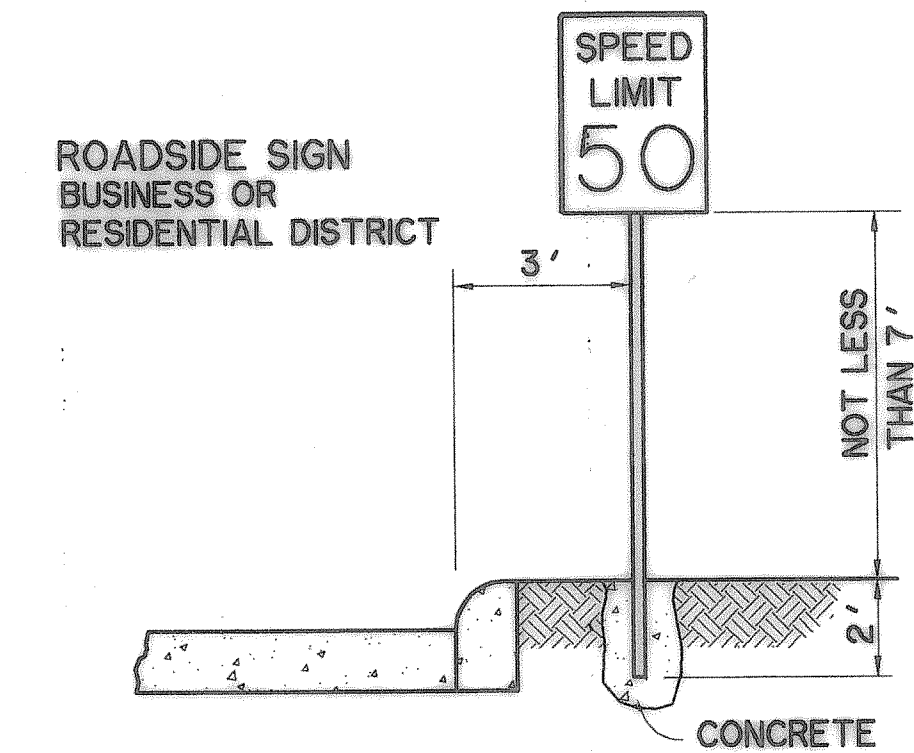

ROADSIDE SIGN BUSINESS OR RESIDENTIAL DISTRICT

SPEED LIMIT 50

NOT LESS THAN 7'

CONCRETE

MINIMUM DIAMETER OF CONCRETE BASE 6', MAXIMUM 12'

N.T.S.

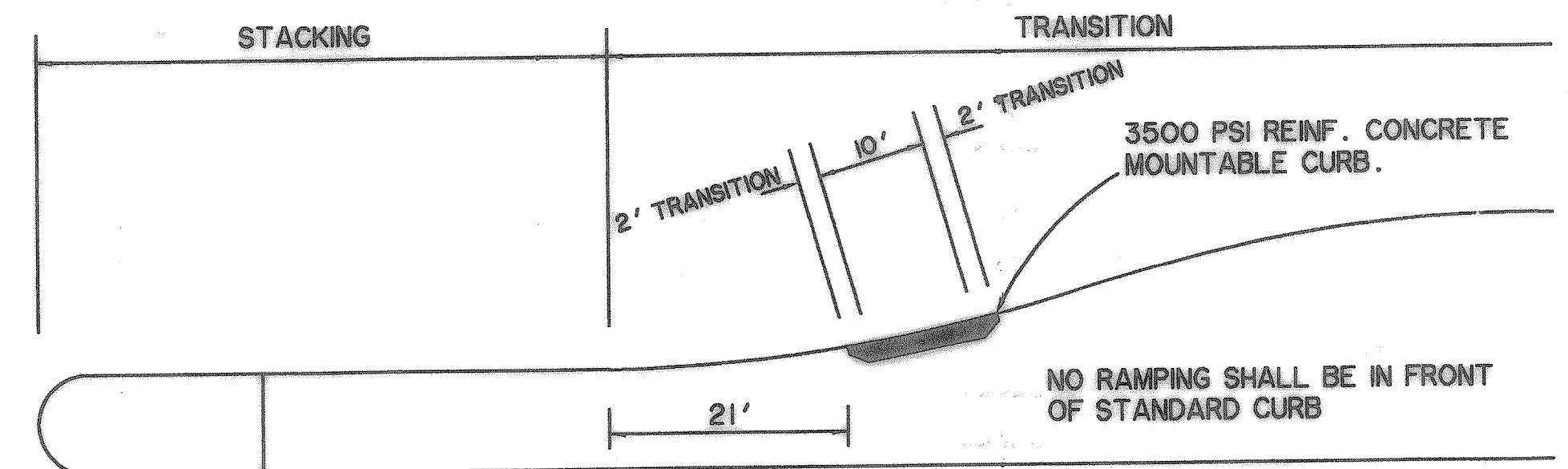

MOUNTABLE CURB DETAIL - PLAN VIEW
N.T.S.

LANDSCAPE MAINTENANCE RAMP

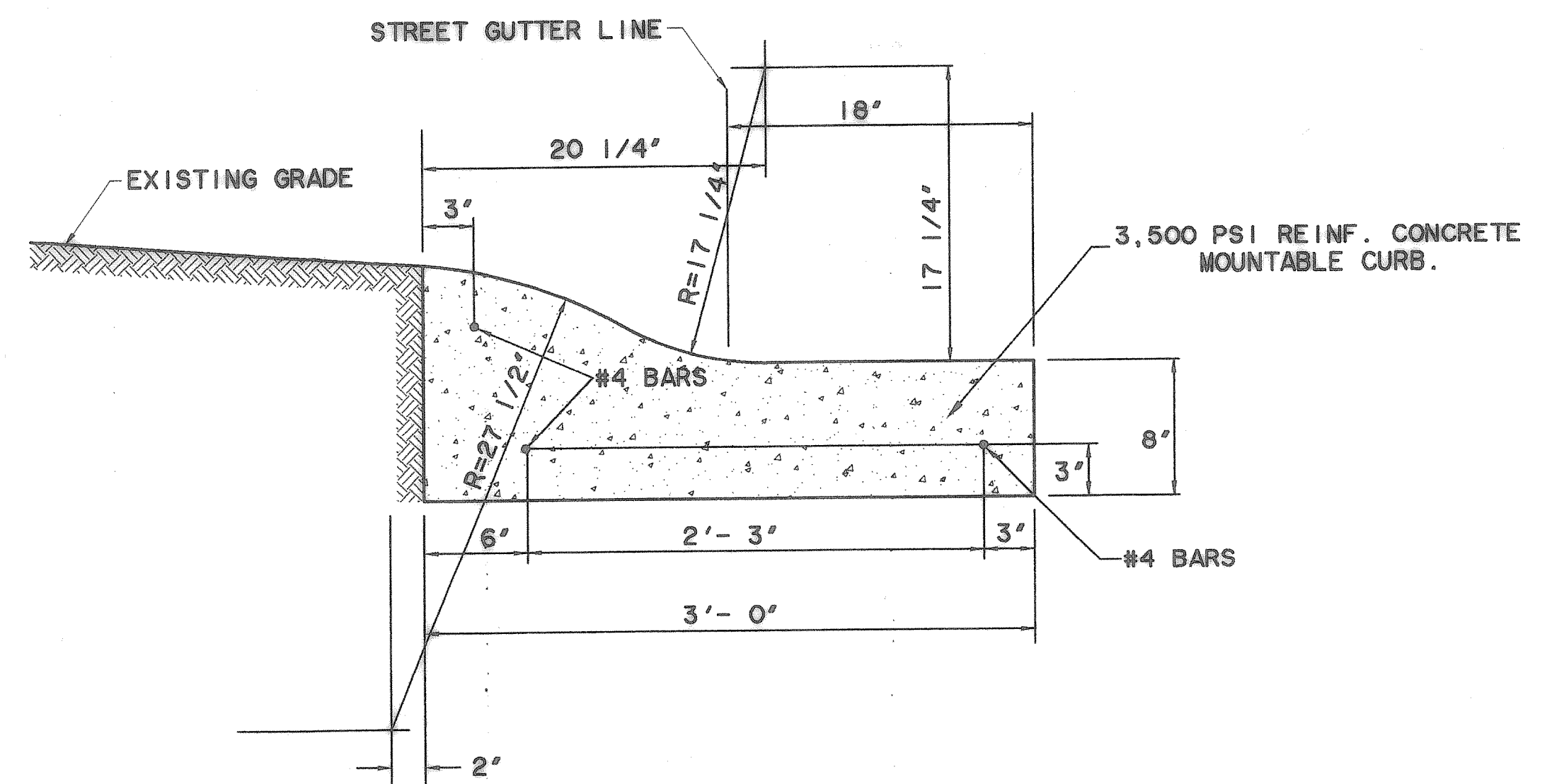

MOUNTABLE CURB SECTION
N.T.S.

GENERAL STREET SIGN REQUIREMENTS: (INSTALLATION BY CITY)

- THE STOCK NUMBERS LISTED FOR SIGNS ARE AVAILABLE FROM SARGENT-SOWEL INC. (SASO) IN GRAND PRAIRIE, TEXAS AND UNLESS OTHERWISE SPECIFIED, ANY SUBSTITUTIONS SHALL BE APPROVED BY THE ENGINEERING DEPARTMENT PRIOR TO INSTALLATION.
- ALL SIGNS SHALL BE OF ALUMINUM SHEET WITH REFLECTORIZED SHEETING AND REFLECTORIZED LETTERS.
 - STOP SIGNS: SASO #09-398 30"x30" STANDARD SIZE
 - OTHER SIGNS: 'YIELD', SASO #09-512, 30"x30"x30"
SPEED LIMIT 30, SASO #01-312, 24"x30"
4 WAY STOP, SASO #09E418, 12"x6"
3 WAY STOP, SASO #09E419, 12"x6"
NO PARKING, SASO #01E539, 18"x24"
DEAD END/NO OUTLET, SASO #01E070/09E121, 30' x 30"
- THE STREET SIGN SHALL BE A GREEN BACKGROUND WITH WHITE REFLECTORIZED LETTERS. THE LETTERS SHALL BE 4" HIGH FOR THE STREET NAME, AND 2" HIGH FOR ALL OTHER LETTERS. THE LENGTH OF THE SIGN SHALL BE APPROPRIATE FOR THE STREET NAME. EACH STREET SIGN SHALL HAVE THE APPROPRIATE HUNDRED BLOCK FOR ITS LOCATION. ALL LETTERS SHALL BE CAPITAL LETTERS.
 - POSTS: ALL POSTS SHALL BE OF GALVANIZED STEEL TUBING 12' LONG x 2-3/8" DIA. WITH A WALL THICKNESS OF .080 INCHES SASO #03-099, ALSO AVAILABLE AT ANY LOCAL FENCE SUPPLY COMPANY.
 - TEE'S: 90 DEGREE BRACKETS, SASO #45E603
45 DEGREE BRACKETS, SASO #45E604
 - POST CAP: SASO #45E602
 - ALUMINUM SIGN CLAMPS: SASO #03E154
- LOCATIONS FOR SIGNS SHALL BE ASSIGNED BY THE CITY OF ROCKWALL ENGINEERING DEPARTMENT AND SHALL BE PLACED IN THE FIELD AS DIAGRAMMED AND/OR SHALL MEET OR EXCEED THE REQUIREMENTS GIVEN IN THE TEXAS MANUAL ON UNIFORM TRAFFIC CONTROL DEVICES, 1980 ED. WITH ADDENDUMS.

PREPARED BY:
WIA WIER & ASSOCIATES, INC.
ENGINEERS SURVEYORS LAND PLANNERS
4300 BELTWAY PLACE SUITE 130 ARLINGTON, TEXAS 76010 METRO (817)467-7700
4100 AVALON CENTER BLVD. SUITE 200 FORT WORTH, TEXAS 76105 METRO (817)350-4457

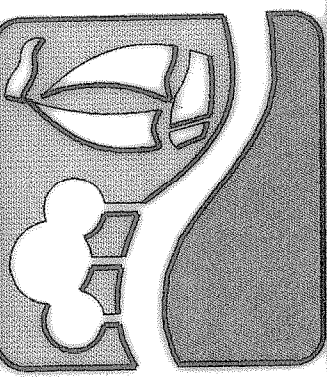

STREET SIGN
& LANDSCAPE MAINTENANCE
RAMP DETAILS



COPYRIGHT ©
WIER & ASSOCIATES, INC.
LAST SHEET EDIT
DATE 11-23-99
WA# 97057
SHEET NO.
49

TIME 16:06 FILE: DETSIGN.dwg

RECORD PLANS
1-15-02