

FM 3097

# RALPH HALL PARKWAY

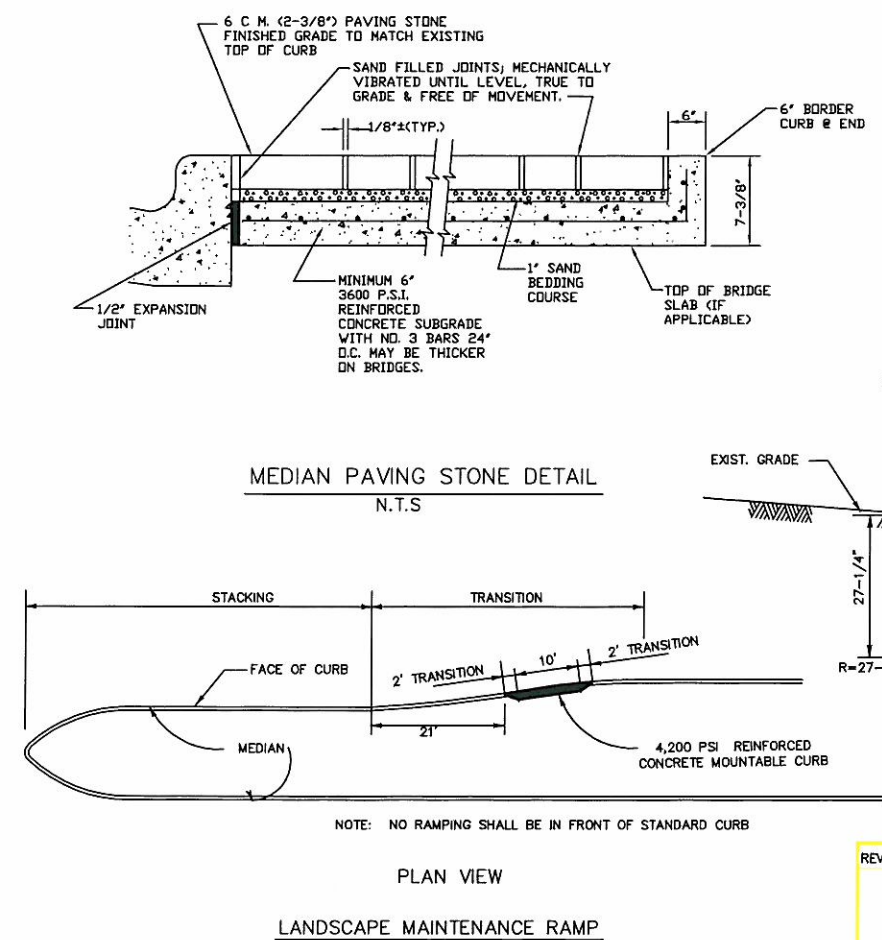

- NOTES**
1. CONTRACTOR TO USE CITY OF ROCKWALL STANDARDS OF DESIGN AND NCTCOG 3RD EDITION STANDARD SPECIFICATIONS
  2. CONTRACTOR TO SALVAGE ALL EXISTING MEDIAN NOSE PAVERS TO USE IN THE PROPOSED MEDIAN NOSE. PAVERS NOT USED IN THE PROPOSED MEDIAN SHALL BE TAKEN TO THE SERVICE CENTER (1600 AIRPORT RD).
  3. CONTRACTOR TO VERIFY ALL EXISTING UTILITIES PRIOR TO CONSTRUCTION
  4. NO CONSTRUCTION CHANGES ARE ALLOWED WITHOUT PERMISSION FROM THE DESIGN ENGINEER AND THE CITY OF ROCKWALL.
  5. CONTRACTOR RESPONSIBLE FOR FURNISHING A TRAFFIC CONTROL PLAN PRIOR TO START OF CONSTRUCTION

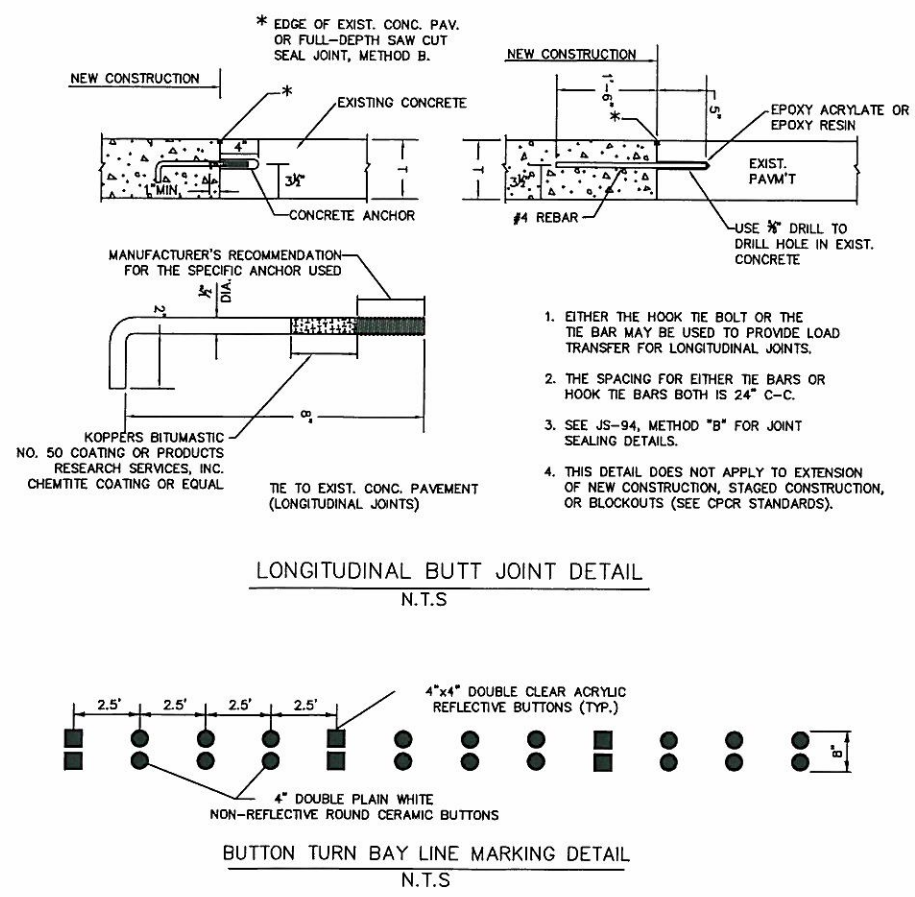
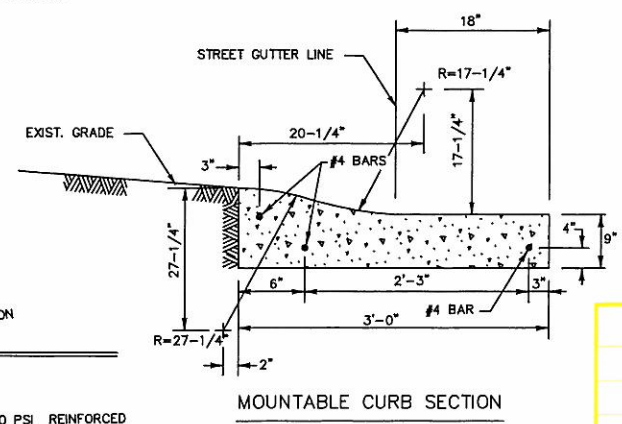

SCALE: 1"=10'

REVISION NO.	REMARKS	DATE

RECORD DRAWING  
3-14-2011

RALPH HALL TURN LANE  
PROPOSED LEFT TURN LANE  
ROCKWALL, TEXAS  
CITY OF ROCKWALL  
"THE NEW HORIZON"

DESIGNED: A.J.W.  
DRAWN: ACAD  
JOB NO. RALPH HALL TURN LANE  
DATE: 10-1-10  
SHEET NO.

THE SEAL APPEARING ON THIS DOCUMENT WAS AUTHORIZED BY AMY J WILLIAMS TEXAS P.E. NO. 99406 ON 99406



*Williams*  
3-14-11