

Revision	Date	Description



Owner:
CITY OF ROCKWALL

Developer:
Sterling One Construction L.L.C.
#2 Horizon Court • Heath, Texas 75032 • 469-772-9400

Harbor District Infrastructure
Rockwall, Texas

~ Civil Engineer ~
F.C. CUNY CORPORATION
#2 Horizon Court • Heath, Texas 75032 • (469) 402-7700
Texas Registered Engineering Firm F-7449

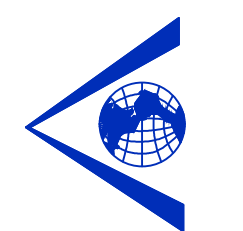

THE SEAL APPEARING ON THIS DOCUMENT WAS AUTHORIZED BY CHRISTOPHER R. CUNY, P.E. 65642

STATE OF TEXAS
CHRISTOPHER R. CUNY
65642
PROFESSIONAL ENGINEER
ONAL EXPIRES
4-30-2014

Drawn By: F.C. CUNY	Checked By: F.C. CUNY
Date: 08/11	Project No.:
Sheet Title: ONCOR Duct Bank Line "A"	
Scale: H: 1"=40' V: 1"=4'	Sheet No.:

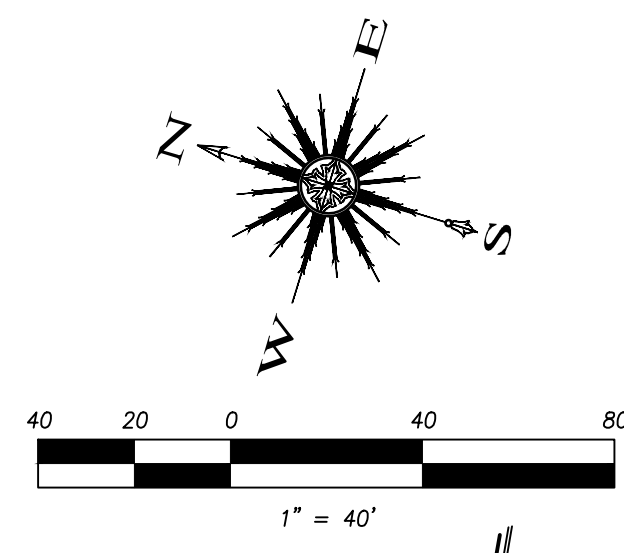

CAUTION EXISTING UTILITIES !!!
EXISTING UTILITIES AND UNDERGROUND FACILITIES INDICATED ON THESE PLANS HAVE BEEN LOCATED FROM REFERENCE INFORMATION. IT SHALL BE THE RESPONSIBILITY OF THE CONTRACTOR TO VERIFY BOTH HORIZONTALLY AND VERTICALLY THE LOCATION OF ALL EXISTING UTILITIES AND UNDERGROUND FACILITIES PRIOR TO CONSTRUCTION. TO TAKE THE NECESSARY PRECAUTIONS IN ORDER TO PROTECT ALL FACILITIES ENCOUNTERED, THE CONTRACTOR SHALL PRESERVE AND PROTECT ALL EXISTING UTILITIES FROM DAMAGE DURING CONSTRUCTION.

CONTRACTOR NOTE
CONTRACTOR TO ADJUST ELECTRICAL DUCT AS NEEDED TO PROVIDE ADEQUATE CLEARANCE AT WATER, SANITARY SEWER AND STORM SEWER CROSSINGS.

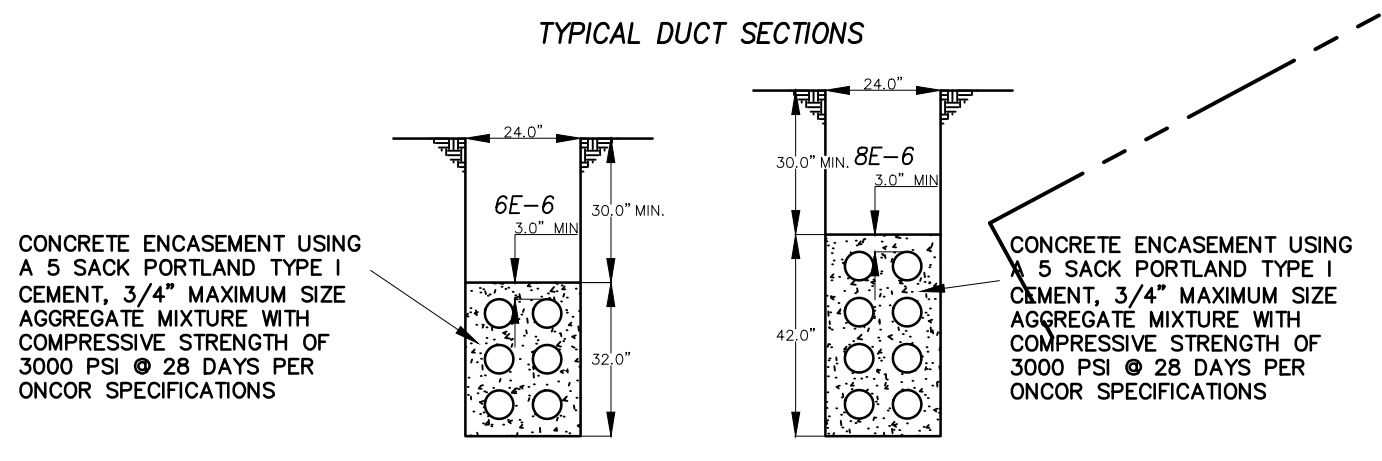
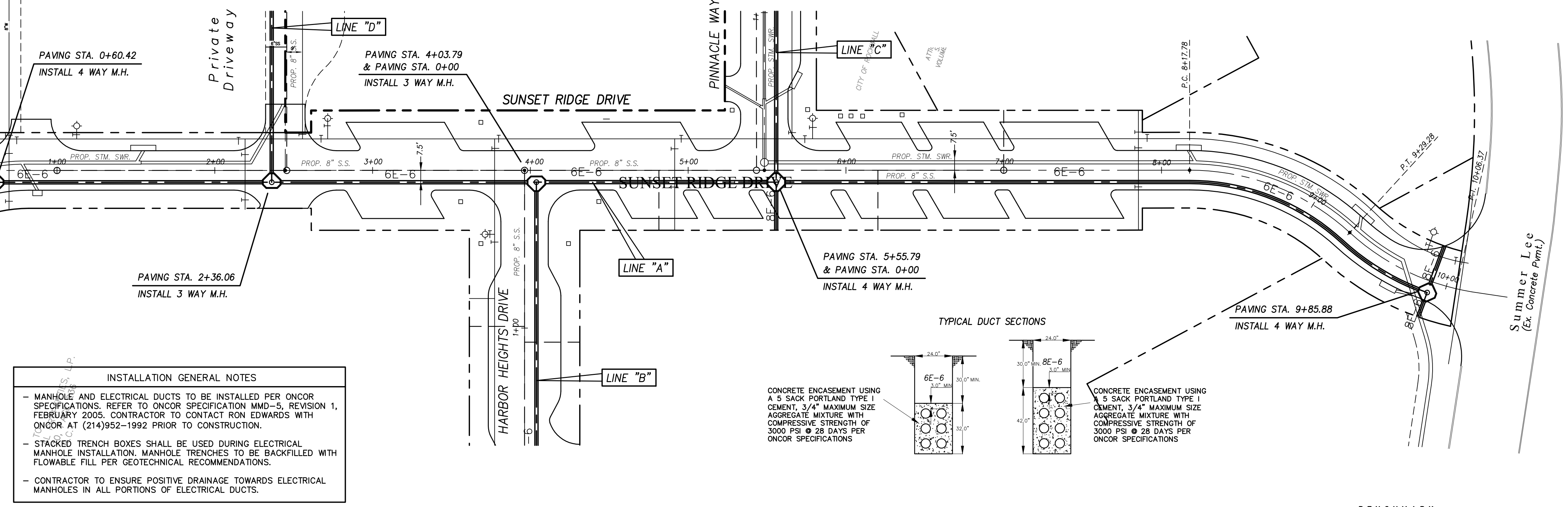

INSTALLATION GENERAL NOTES

- MANHOLE AND ELECTRICAL DUCTS TO BE INSTALLED PER ONCOR SPECIFICATIONS. REFER TO ONCOR SPECIFICATION MMD-5, REVISION 1, FEBRUARY 2005. CONTRACTOR TO CONTACT RON EDWARDS WITH ONCOR AT (214)952-1992 PRIOR TO CONSTRUCTION.
- STACKED TRENCH BOXES SHALL BE USED DURING ELECTRICAL MANHOLE INSTALLATION. MANHOLE TRENCHES TO BE BACKFILLED WITH FLOWABLE FILL PER GEOTECHNICAL RECOMMENDATIONS.
- CONTRACTOR TO ENSURE POSITIVE DRAINAGE TOWARDS ELECTRICAL MANHOLES IN ALL PORTIONS OF ELECTRICAL DUCTS.

BENCHMARK:
CITY OF ROCKWALL MONUMENT, N.W. CORNER OF INLET ON LAKEVIEW TRAIL AT SUMMER LEE.
N 7013358.3381
E 2588850.5919
ELEV. 469.06

DUCT BANK LINE "A"

