

CURVE DATA						
CURVE	RADIUS	DELTA	TANGENT	LENGTH	CHORD	BEARING
C-1	70.00'	48°39'30"	31.65'	59.45'	57.68'	N 48°24'22" E
						P.C. 110+60.05
						P.T. 111+19.50

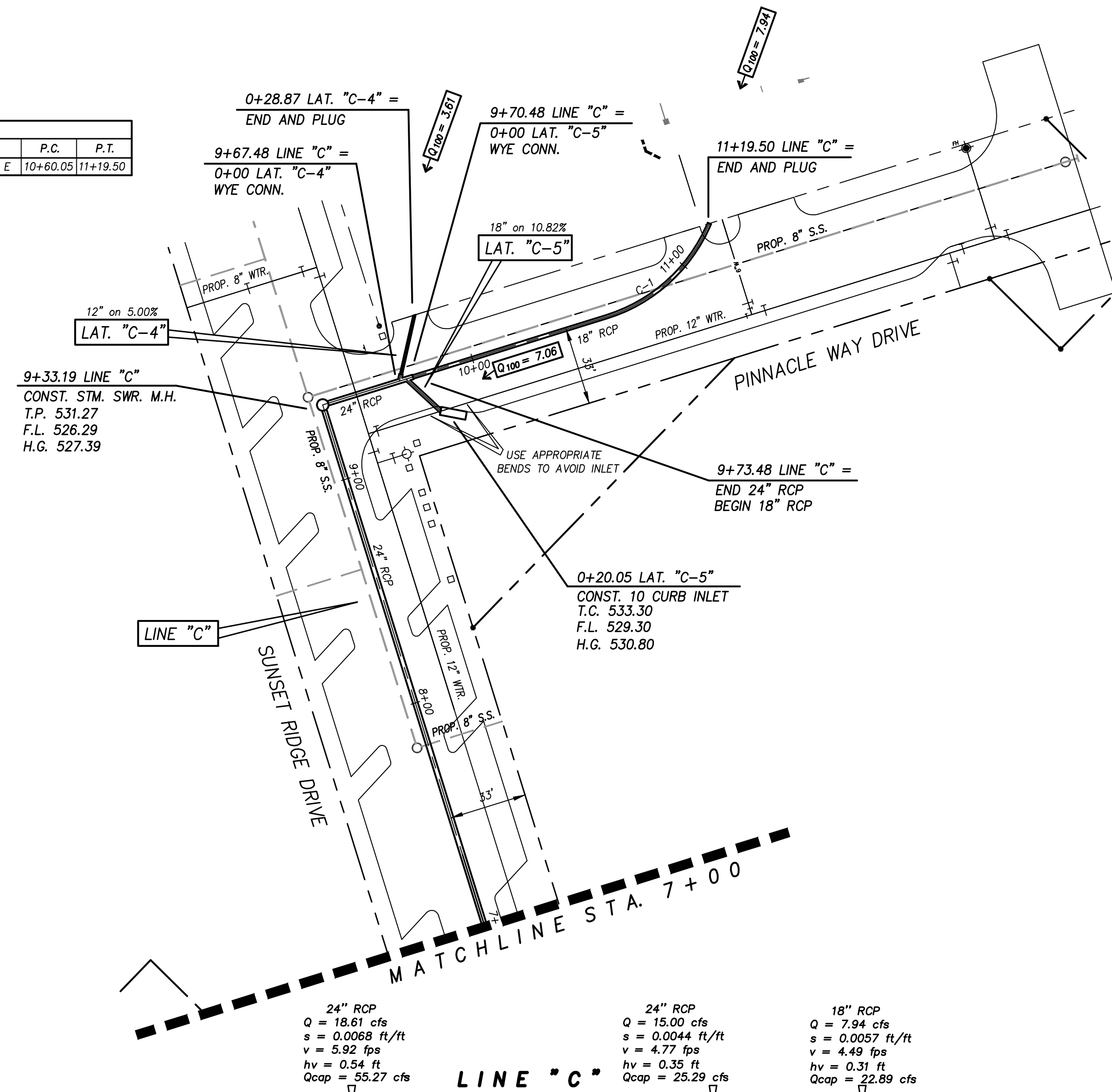

Station	24" RCP	24" RCP	18" RCP
7+00	Q = 18.61 cfs	Q = 15.00 cfs	Q = 7.94 cfs
8+40	s = 0.0068 ft/ft	s = 0.0044 ft/ft	s = 0.0057 ft/ft
9+33.19	v = 5.92 fps	v = 4.77 fps	v = 4.49 fps
10+00	hv = 0.54 ft	hv = 0.35 ft	hv = 0.31 ft
11+19.50	Qcap = 55.27 cfs	Qcap = 25.29 cfs	Qcap = 22.89 cfs

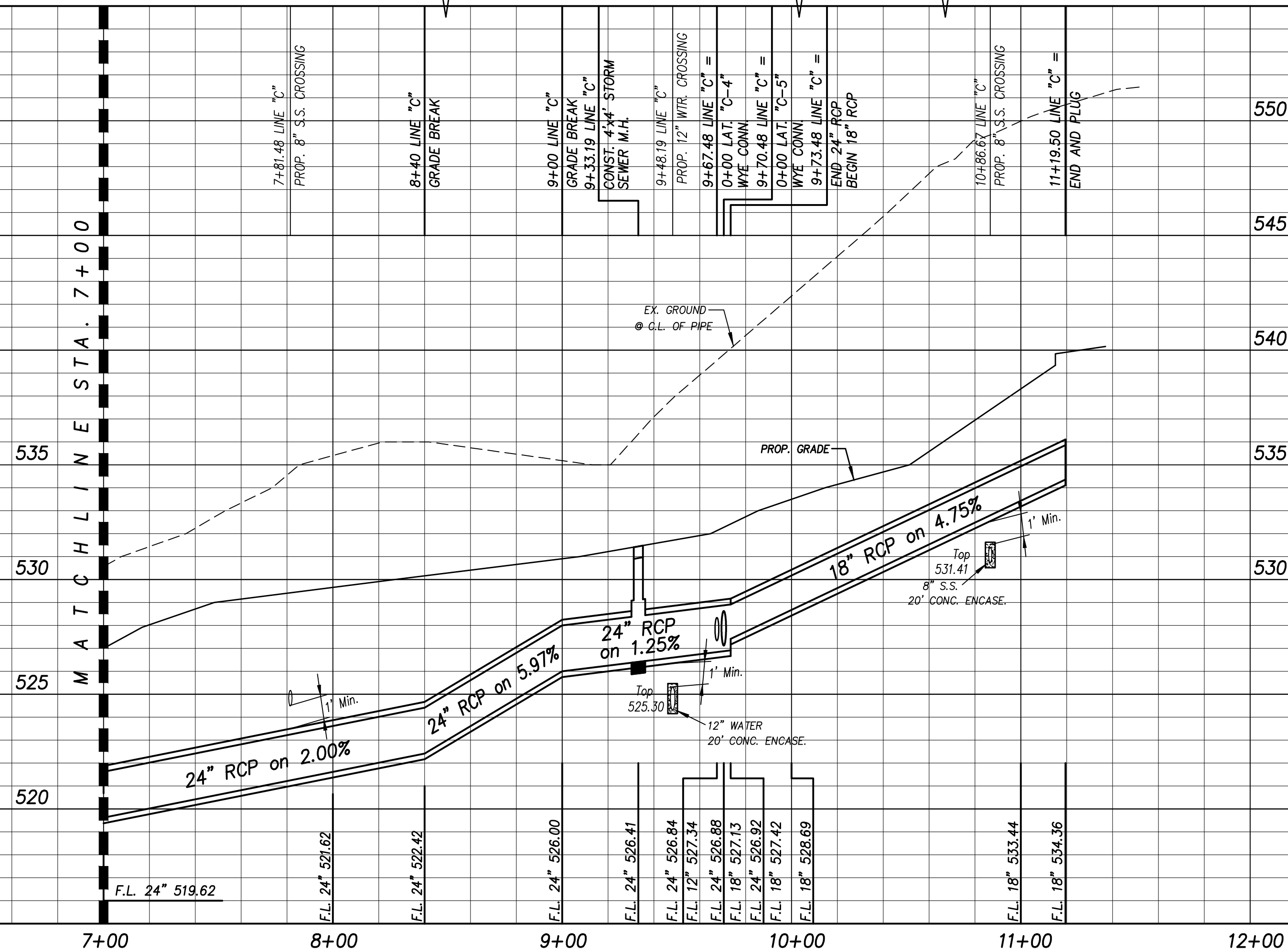

This drawing is proprietary and may not be copied or used in any way without the written permission of FC Cury Corporation - © Copyright - FC Cury Corporation

RECORD DRAWING

Revision	Date	Description

Owner:
CITY OF ROCKWALL

Developer:
Sterling One Construction L.L.C.
#2 Horizon Court • Heath, Texas 75032 • 469-772-9400

Harbor District Infrastructure
Rockwall, Texas

~ Civil Engineer ~
F.C. CUNY CORPORATION
#2 Horizon Court • Heath, Texas 75032 • (469) 402-7700
Texas Registered Engineering Firm F-7449

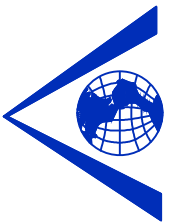

THE SEAL APPEARING ON THIS DOCUMENT WAS AUTHORIZED BY CHRISTOPHER R. CUNY, P.E. 65642



Drawn By: F.C. CUNY	Checked By: F.C. CUNY
Date: 08/11	Project No.:
Sheet Title: Storm Sewer Plan & Profile - Line "C" Sta. 7+00 to End	
Scale:	Sheet No.:
H:1" = 40' V:1" = 4'	14 of 21