

**CAUTION EXISTING UTILITIES !!!**

EXISTING UTILITIES AND UNDERGROUND FACILITIES INDICATED ON THESE PLANS HAVE BEEN LOCATED FROM REFERENCE INFORMATION. IT SHALL BE THE RESPONSIBILITY OF THE CONTRACTOR TO VERIFY BOTH HORIZONTALLY AND VERTICALLY THE LOCATION OF ALL EXISTING UTILITIES AND UNDERGROUND FACILITIES PRIOR TO CONSTRUCTION, TO TAKE THE NECESSARY PRECAUTIONS IN ORDER TO PROTECT ALL FACILITIES ENCOUNTERED. THE CONTRACTOR SHALL PRESERVE AND PROTECT ALL EXISTING UTILITIES FROM DAMAGE DURING CONSTRUCTION.

- ① 9"-3600 PSI Class "C" concrete pavement with No. 3 bars 24" on centers both ways.
  - ② 6"-3600 PSI Class "C" concrete pavement with No. 3 bars 24" on centers both ways.
  - ③ Subgrade shall be 8" thick and compacted to a density not less than 96% at 0%-3% of optimum moisture content.
- Notes:  
1. All construction joints & rebar to be in conformance with the City of Rockwall Specifications and Standards.

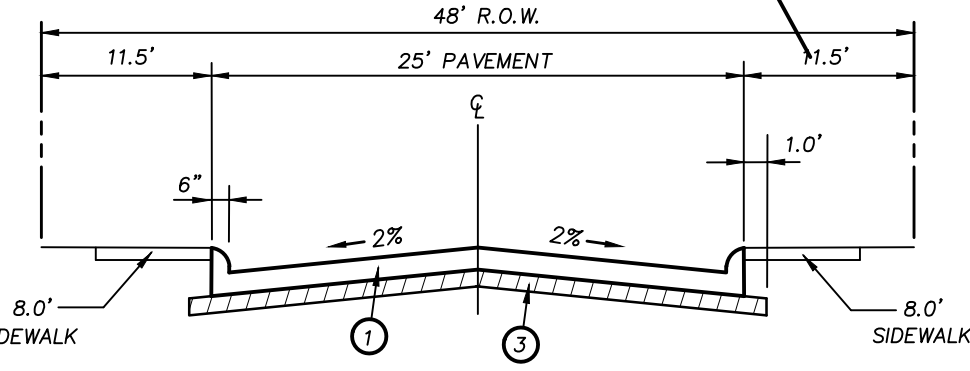

TYPICAL PAVING SECTION B-B

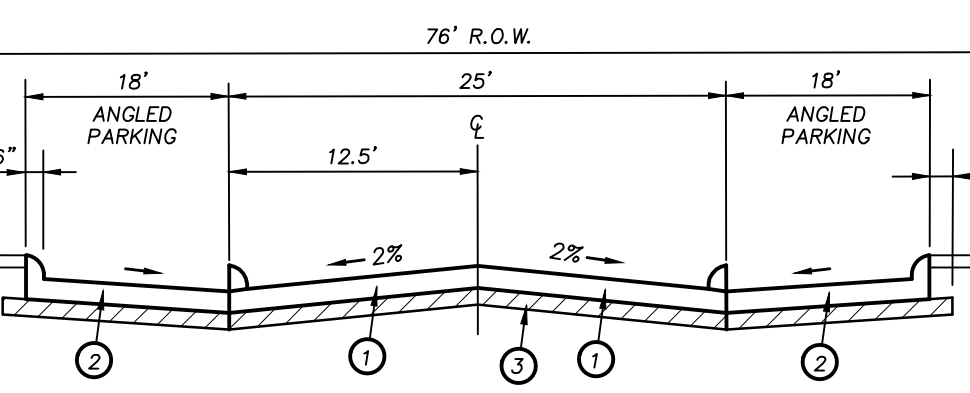

TYPICAL PAVING SECTION E-E

C.L. CURVE TABLE							
CURVE	RADIUS	DELTA	TANGENT	LENGTH	CHORD	BEARING	P.C. P.T.
C-1	150.00'	42°35'25"	58.47'	111.50'	108.95'	S 04°01'50" W	8+17.78 9+29.28
C-2	150.00'	29°26'47"	39.42'	77.09'	76.24'	N 10°36'09" E	9+29.28 10+06.37

**BENCHMARK:**  
CITY OF ROCKWALL MONUMENT, N.W. CORNER OF INLET ON LAKEVIEW TRAIL AT SUMMER LEE.  
N 701.3358.3381  
E 2588850.5919  
ELEV. 469.06

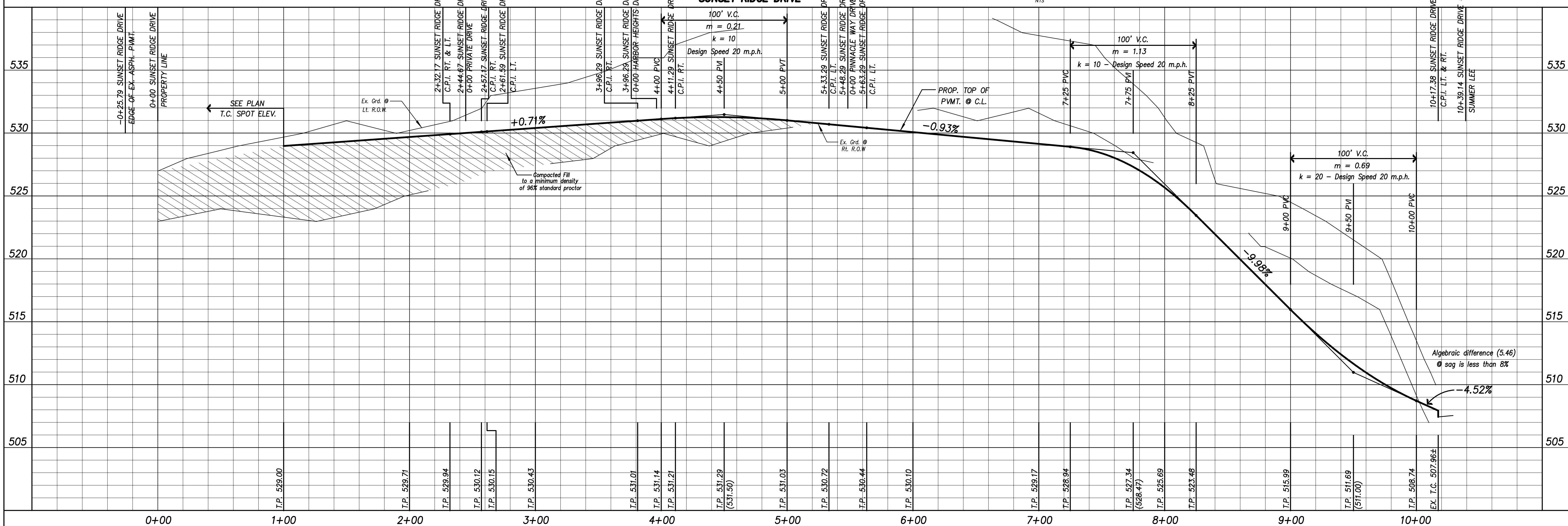

Algebraic difference (5.46)  
sag is less than 8%

Revision	Date	Description



**CITY OF ROCKWALL**

Developer:  
**Sterling One Construction L.L.C.**  
#2 Horizon Court • Heath, Texas 75032 • 469-772-9400

**Harbor District Infrastructure**  
Rockwall, Texas

~ Civil Engineer ~  
**F.C. CUNY CORPORATION**  
#2 Horizon Court • Heath, Texas 75032 • (469) 402-7700  
Texas Registered Engineering Firm F-7449

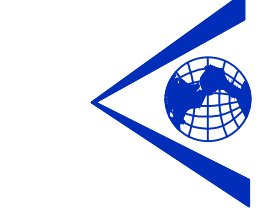

Drawn By: F.C. CUNY	Checked By: F.C. CUNY
Date: 08/11	Project No.:
Sheet Title: <b>Paving Plan &amp; Profile</b> <b>Sunset Ridge Drive</b>	
Scale:	Sheet No.:

This drawing is proprietary and may not be copied or used in any way without the written permission of FC Cuny Corporation. © Copyright - FC Cuny Corporation

RECORD DRAWING

H: 1"=40'  
V: 1"=4'  
2 of 21