

no ref logical, *no ref name*, *no ref levels*
 no ref logical, *no ref name*, *no ref levels*
 no ref logical, *no ref name*, *no ref levels*
 no ref logical, *no ref name*, *no ref levels*
 no ref logical, *no ref name*, *no ref levels*
 no ref logical, *no ref name*, *no ref levels*

CROW, 335401CROW1.DGN, 1-47, 49-63
 CSTR PLAN, 335401CSTR1.DGN, 1-16, 18-28, 31-41, 43-63
 CHALIGN, 335401CHARR1.DGN, 1-63
 CHALIGN, 335401CHARR1.DGN, 1-7, 9-57, 59-63
 BORDER, 335401BDR1.DGN, 1-4, 6, 7, 20-31, 35-58
 CSECT, 335401CSE1.DGN, 1-17, 19-62

tharses=20.000000
 SCALE=20.000000
 PRF ROTATION=90.000000
 f:\h\h\ZFULL.TBL

h:\pre\01335401\dgn\335401CXS03.DGN
 DATE: 1/17/2006
 TIME: 08:48:21

SQUABBLE CREEK - AUGUST 20, 2004
 EARTHWORK VOLUMES (INCLUDES 15% SHRINKAGE)

STATION	EXCAVATION AREA (SF)	EMBANKMENT AREA (SF)	EXCAVATION VOLUME (CY)	EMBANKMENT VOLUME (CY)	15% SHRINK VOLUME (CY)	TOTAL EMBANK. VOLUME (CY)	NET VOLUME (CY)	MASS VOLUME (CY)	STATION
9,005.00	0.00	0.00	0	0	0	0	0	0	9,005.00
9,050.00	139.62	0.00	116	0	0	116	116	116	9,050.00
9,121.58	391.06	39.76	703	53	8	61	643	759	9,121.58
9,212.54	66.98	2.10	772	71	11	81	690	1,450	9,212.54
9,332.50	0.00	0.00	149	5	1	5	143	1,593	9,332.50
TOTALS			1,740	128	19	147	1,593	1,593	TOTALS

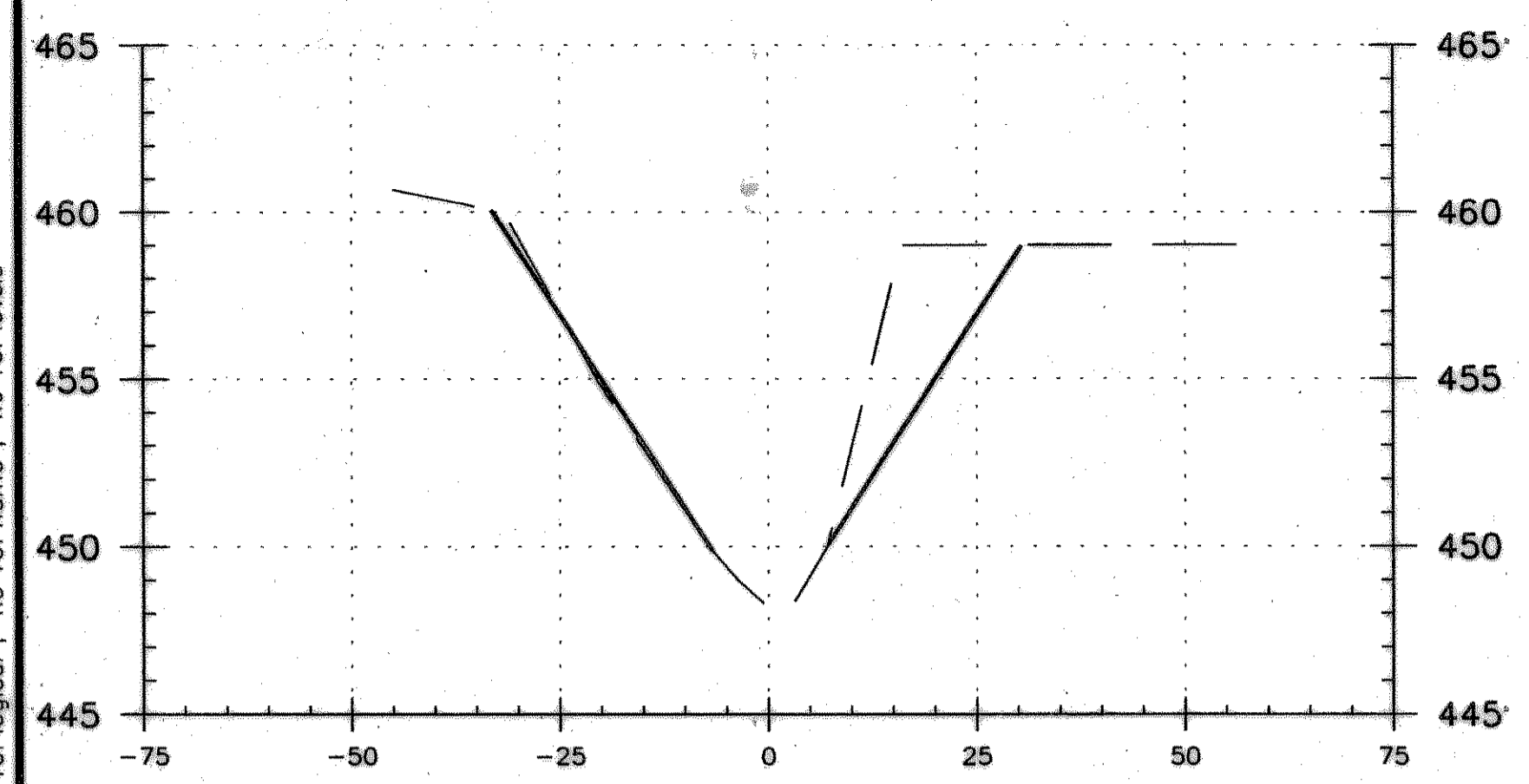

92+12.54

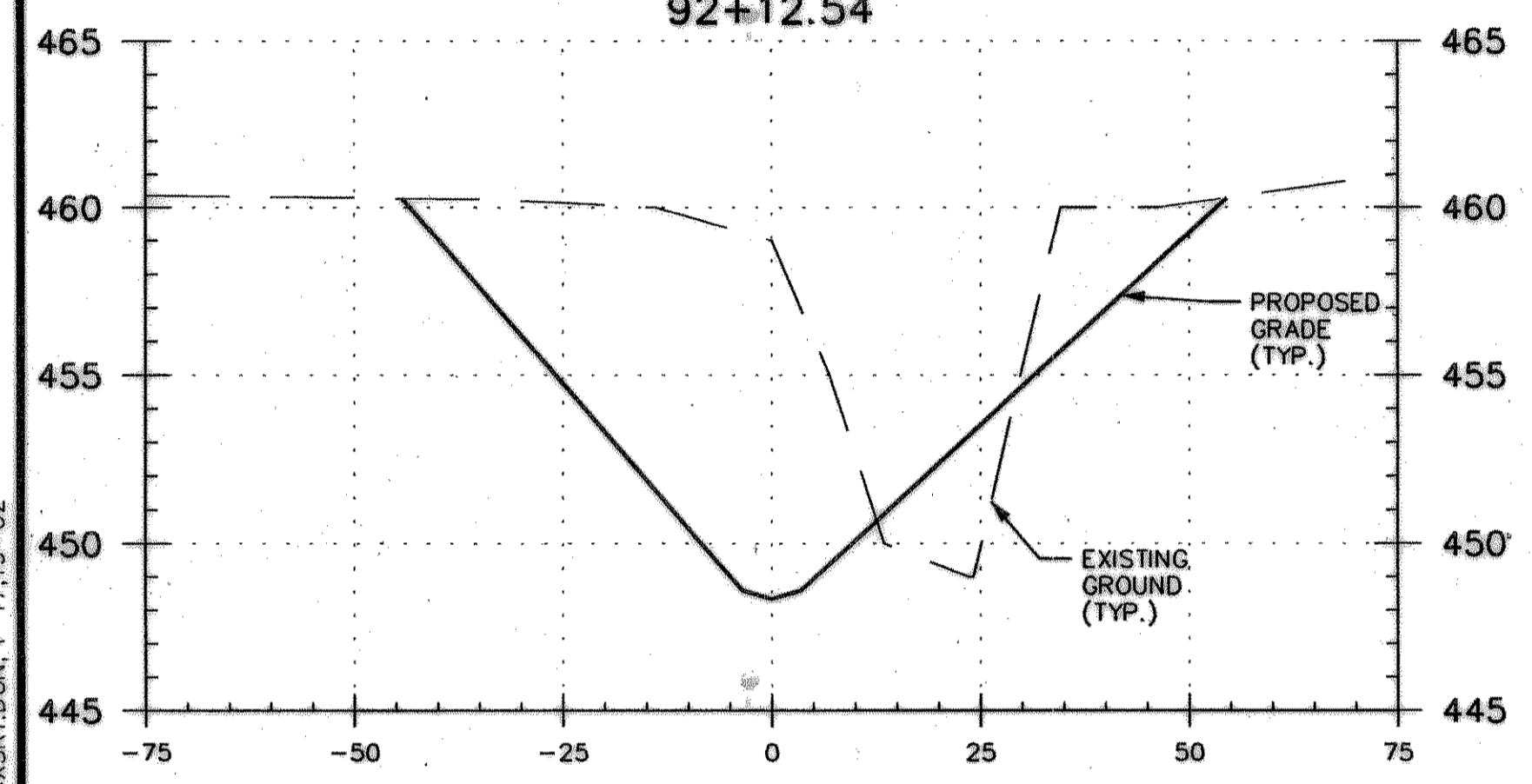

91+21.58

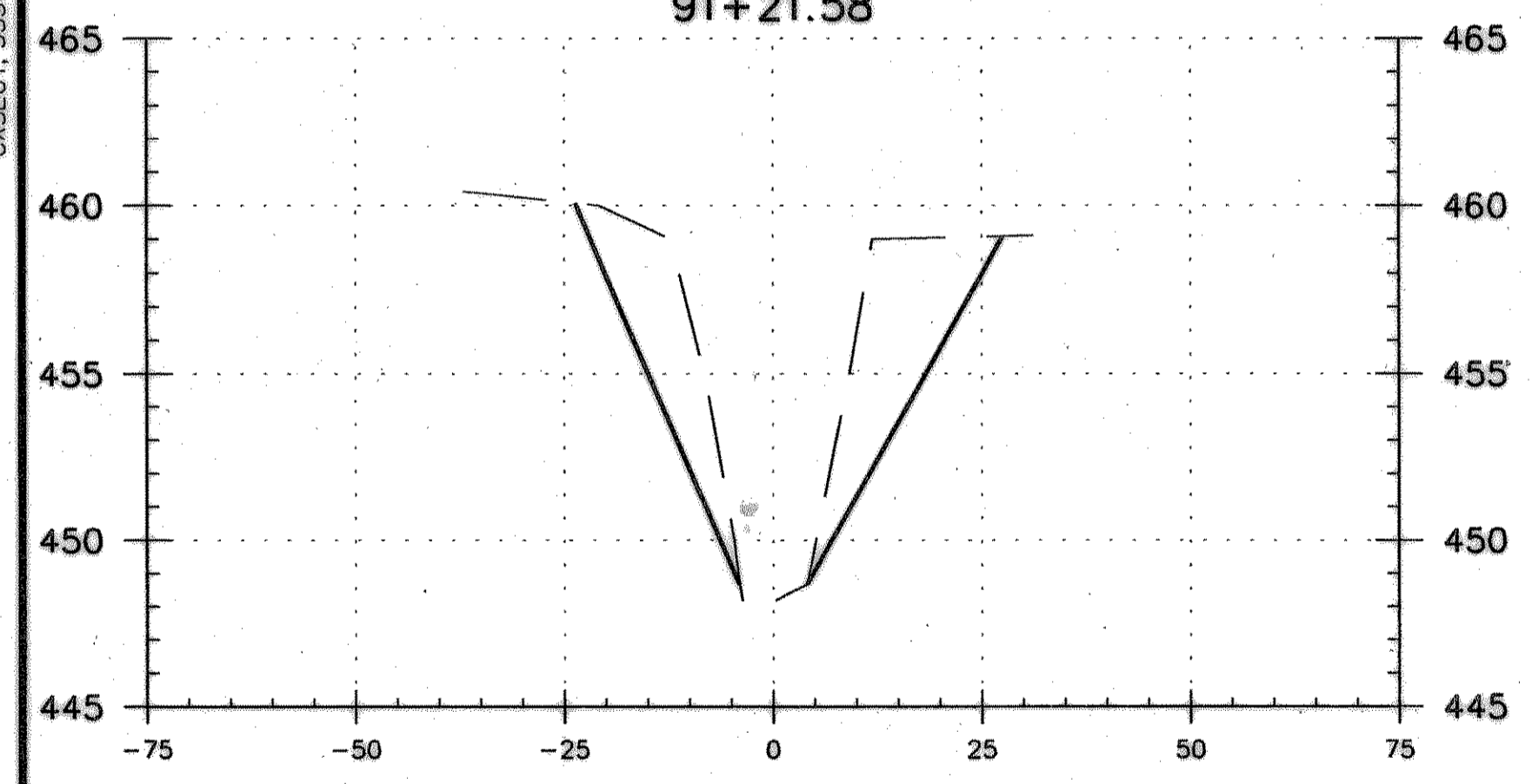

90+50

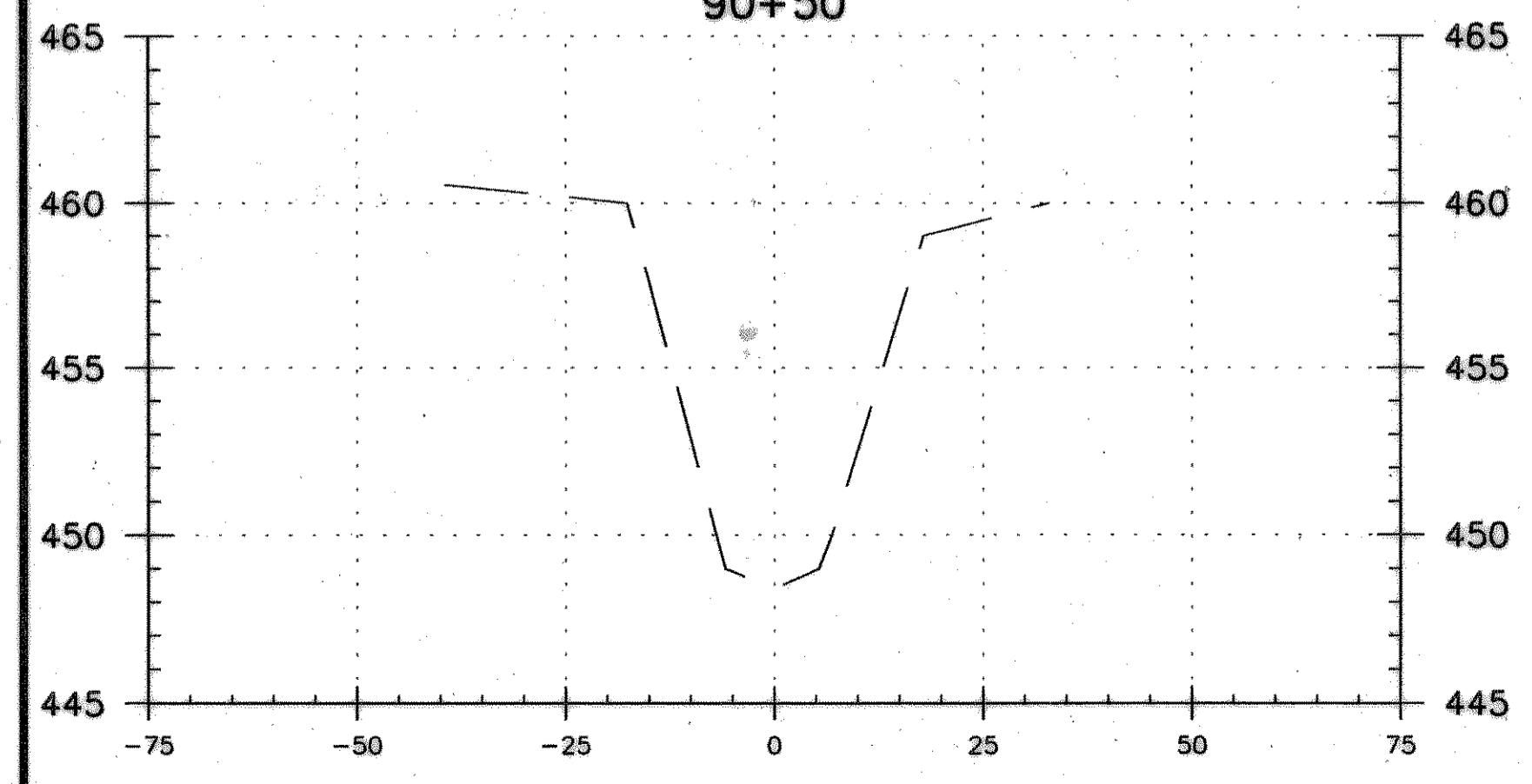

90+05
 BEGIN CHANNEL GRADING

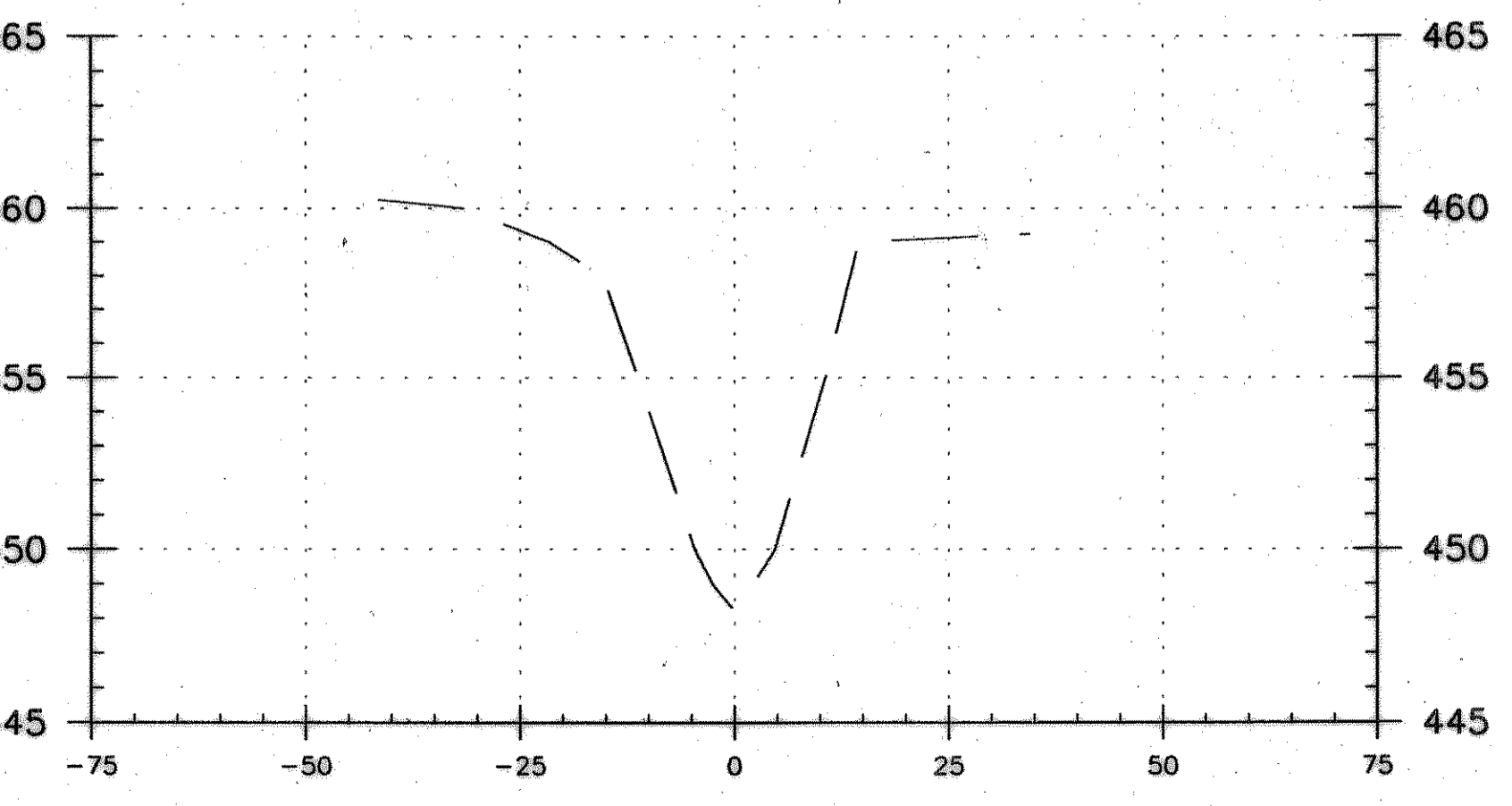

93+32.5
 END CHANNEL GRADING

RECORD DRAWINGS JANUARY 12, 2006
 THIS RECORD DOCUMENT HAS BEEN PREPARED BASED ON INFORMATION PROVIDED BY OTHERS. THE CONSULTANT HAS NOT VERIFIED THE ACCURACY AND/OR COMPLETENESS OF THIS INFORMATION AND SHALL NOT BE RESPONSIBLE FOR ANY ERRORS OR OMISSIONS THAT MAY BE INCORPORATED AS A RESULT OF ERRONEOUS INFORMATION PROVIDED BY OTHERS.

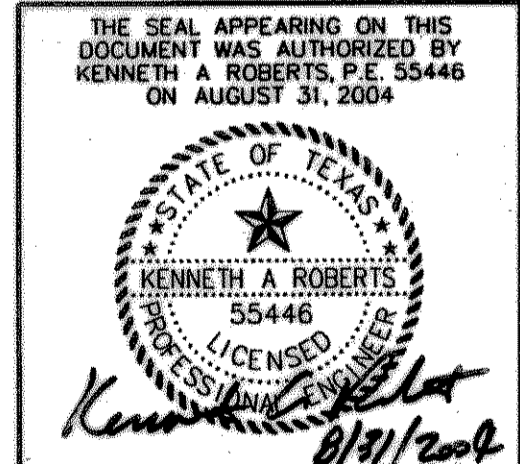

NO.	DATE	REVISIONS	APPROVED
CHANNEL CROSS SECTIONS			
SQUABBLE CREEK			
NORTH LAKESHORE DRIVE			
NAPA DRIVE TO S.H. 205			
HUITT-ZOLIARS			
<small>Huitt-Zoliars, Inc. 981 McKinney Avenue, Suite 600 Dallas, Texas 75204-2489 Phone (214) 871-3311 Fax (214) 871-0757</small>			
CITY OF ROCKWALL, TEXAS			
DESIGN	DRAWN	APPR.	SCALE
HZI	HZI	KAR	H: 1"=20' V: 1"=5'
DATE	PROJECT NO.	NO.	
AUGUST 2004	01-3354-01	ST-7	