

TRIDGE, 335401TBR1.DGN, 2-63  
 CRAD, REGRADING.DGN, 1-40, 42-63  
 S5570PO, 9852EX1.DGN, 1-63  
 USYPLAN, 335401USDR1.DGN, 1, 2, 4-63  
 UWYPLAN, 335401UWDR1.DGN, 1-63  
 O3, 335401O3SD3.DGN, 1-62

CROW, 335401CWR1.DGN, 1-63  
 SURF, 335401SUR1.DGN, 1-35, 9-11-35, 37-42, 44-46, 48, 50-56, 60-62  
 SUTPLAN, 335401SUTR1.DGN, 1-63  
 CSTRPLAN, 335401CSTR1.DGN, 1-28, 31-41, 43-62  
 BORDER, 335401BDR1.DGN, 1-46, 7, 20-31, 33-59, 61, 62  
 CHALIGN, 335401CHAL1.DGN, 1-3

thesesso  
 SCALE=20.000000  
 PRF ROTATION=30.000000  
 F:\WY\REFULL.TBL

h:\proj\01335401\gen\335401CPG01.DGN  
 DATE: 1/9/2006  
 TIME: 15:06:51

ARKOMA COMPANIES

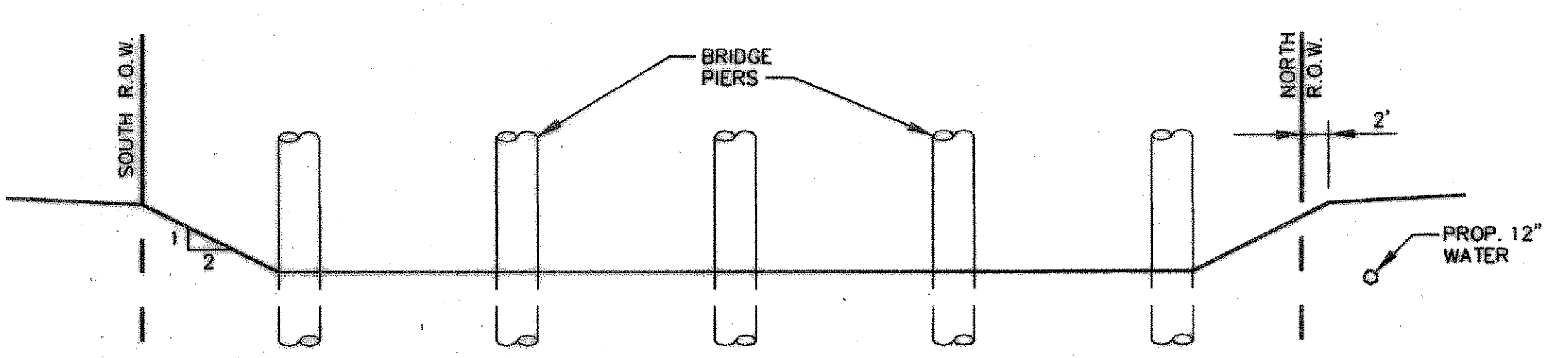
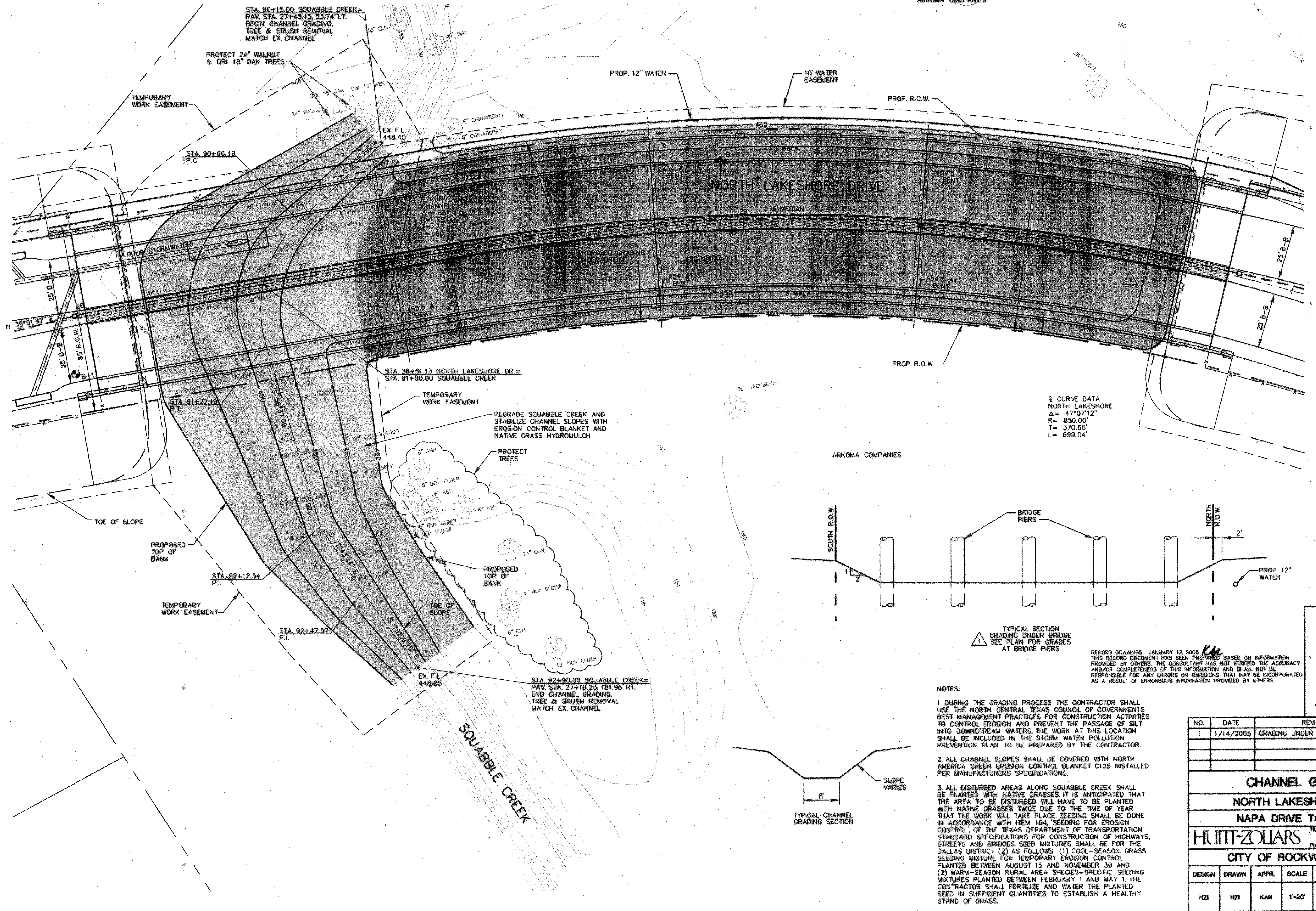
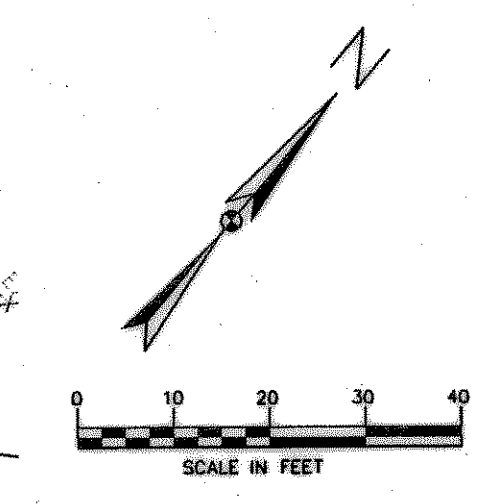

1  
 TYPICAL SECTION GRADING UNDER BRIDGE AT BRIDGE PIERS  
 SEE PLAN FOR GRADES

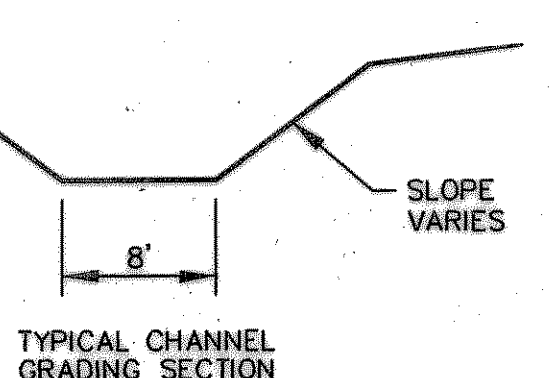

NOTES:

- DURING THE GRADING PROCESS THE CONTRACTOR SHALL USE THE NORTH CENTRAL TEXAS COUNCIL OF GOVERNMENTS BEST MANAGEMENT PRACTICES FOR CONSTRUCTION ACTIVITIES TO CONTROL EROSION AND PREVENT THE PASSAGE OF SILT INTO DOWNSTREAM WATERS. THE WORK AT THIS LOCATION SHALL BE INCLUDED IN THE STORM WATER POLLUTION PREVENTION PLAN TO BE PREPARED BY THE CONTRACTOR.
- ALL CHANNEL SLOPES SHALL BE COVERED WITH NORTH AMERICA GREEN EROSION CONTROL BLANKET C125 INSTALLED PER MANUFACTURERS SPECIFICATIONS.
- ALL DISTURBED AREAS ALONG SQUABBLE CREEK SHALL BE PLANTED WITH NATIVE GRASSES. IT IS ANTICIPATED THAT THE AREA TO BE DISTURBED WILL HAVE TO BE PLANTED WITH NATIVE GRASSES TWICE DUE TO THE TIME OF YEAR THAT THE WORK WILL TAKE PLACE. SEEDING SHALL BE DONE IN ACCORDANCE WITH ITEM 164, "SEEDING FOR EROSION CONTROL", OF THE TEXAS DEPARTMENT OF TRANSPORTATION STANDARD SPECIFICATIONS FOR CONSTRUCTION OF HIGHWAYS, STREETS AND BRIDGES. SEED MIXTURES SHALL BE FOR THE DALLAS DISTRICT (2) AS FOLLOWS: (1) COOL-SEASON GRASS SEEDING MIXTURE FOR TEMPORARY EROSION CONTROL PLANTED BETWEEN AUGUST 15 AND NOVEMBER 30 AND (2) WARM-SEASON RURAL AREA SPECIES-SPECIFIC SEEDING MIXTURES PLANTED BETWEEN FEBRUARY 1 AND MAY 1. THE CONTRACTOR SHALL FERTILIZE AND WATER THE PLANTED SEED IN SUFFICIENT QUANTITIES TO ESTABLISH A HEALTHY STAND OF GRASS.

RECORD DRAWINGS JANUARY 12, 2006  
 THIS RECORD DOCUMENT HAS BEEN PREPARED BASED ON INFORMATION PROVIDED BY OTHERS. THE CONSULTANT HAS NOT VERIFIED THE ACCURACY AND/OR COMPLETENESS OF THIS INFORMATION AND SHALL NOT BE RESPONSIBLE FOR ANY ERRORS OR OMISSIONS THAT MAY BE INCORPORATED AS A RESULT OF ERRONEOUS INFORMATION PROVIDED BY OTHERS.

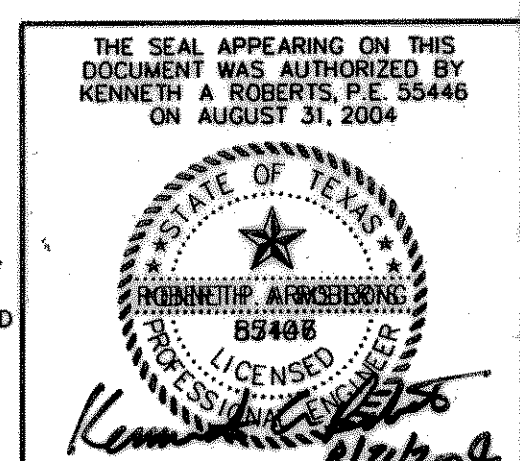

NO.	DATE	REVISIONS	APPROVED
1	1/14/2005	GRADING UNDER THE BRIDGE	<i>KAR</i>
<b>CHANNEL GRADING</b>			
<b>NORTH LAKESHORE DRIVE</b>			
<b>NAPA DRIVE TO S.H. 205</b>			
<b>HUITT-ZOLIARS</b>		Huitt-Zoliars, Inc. Dallas 381 McKinney Avenue, Suite 600 Dallas, Texas 75204-2489 Phone (214) 871-3311 Fax (214) 871-0757	
<b>CITY OF ROCKWALL, TEXAS</b>			
DESIGN	DRAWN	APPR.	SCALE
HZI	HZI	KAR	1"=20'
DATE	PROJECT NO.	NO.	
AUGUST 2004	01-3354-01	ST-6	