

"THE NEW HORIZON"

CITY OF ROCKWALL

ENGINEERING DEPARTMENT

ALAMO ROAD PARKING LOTS

SHEET INDEX

Sheet No.	Description
1	Cover Sheet
C1	Dimension Control \ Grading Plan
C2	Drainage Area Map \ Erosion Control
C3	Details

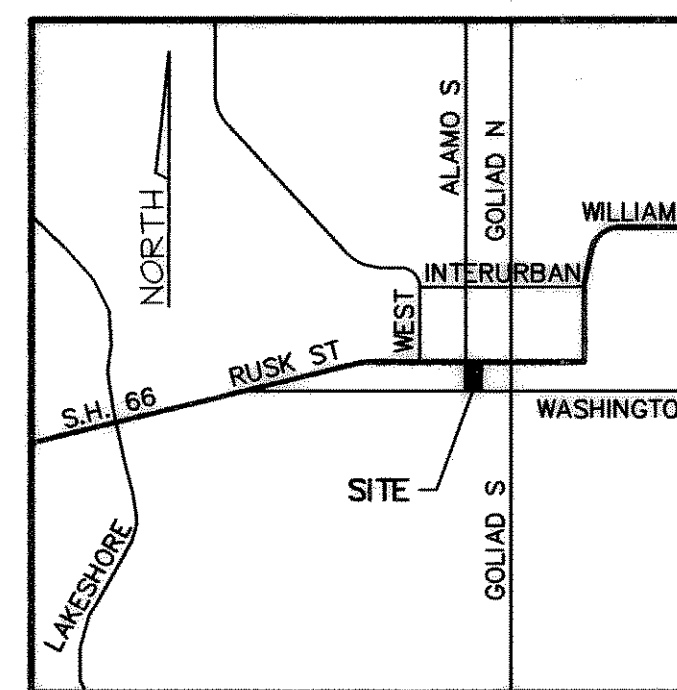

LOCATION MAP

BENTLEY ENGINEERING, INC

CIVIL ENGINEERING • PLANNING • CONSTRUCTION MANAGEMENT

702 GATEWOOD DRIVE
GARLAND, TEXAS 75043
PH: (972) 240-4821
FAX: (972) 240-0922

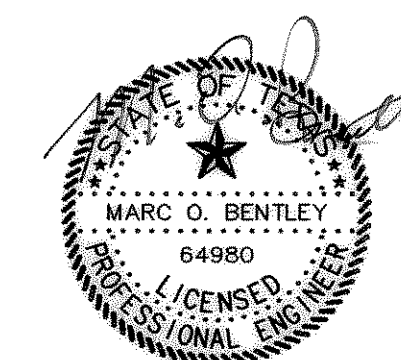

THE SEAL APPEARING ON THIS DOCUMENT WAS AUTHORIZED BY MARC O. BENTLEY, P.E. NO. 64980 ON 4/20/01

APRIL 2001

GENERAL NOTES

- All work shall be in accordance with the City of Rockwall construction specifications and standard detail sheets.
- Utilities shown on the plans were taken from field surveys and information provided by the utility companies. The completeness and the accuracy of this data is not guaranteed.
- The contractor is responsible for verifying the location of all underground utilities and structures and protecting them from damage during construction.
- All excavation on the project is unclassified. Unclassified excavation pay item shall include removal and disposal of existing asphalt pavement.
- Temporary erosion control shall be used to minimize the spread of silt and mud from the project on to existing streets, alleys, drainageways and public and private property. Temporary erosion controls may include straw bales, berms, dikes, swales, strips of undisturbed vegetation, check dams and other methods as required by the City Engineer.
- Finished slopes on public rights-of-way and easements shall not be steeper than 4:1. All slopes steeper than 6:1 shall be hydromulched and maintained by the contractor until grass covers all parts of the slope. Grass must be lush, green, vigorous and growing. No bare spots over one square foot will be allowed. All ruts from "washing" must be filled in and grassed.
- Contractor shall protect all trees during the construction or thru the project. Contractor shall be responsible for replacement of any damage to trees not indicated to be removed.
- Contractor shall fully remove any trees indicated on the plans to be removed.
- See detail sheets for additional notes and construction details.
- Sawcutting of existing pavement shall be subsidiary to associated pavement removal item.
- Any required work not covered by a pay item shall be considered subsidiary to all other items.

RECORD DRAWING

IMPROVEMENTS INDICATED ON THIS PLAN WHERE MADE IN ACCORDANCE WITH THE PROJECT PLANS & SPECIFICATIONS. THE DESIGN ENGINEER IS NOT AWARE OF ANY CHANGES TO THESE PLANS OTHER THAN THOSE SHOWN.
DATE: MARCH 20, 2002