

T.B.M.
TOP OF SANITARY SEWER
MANHOLE IN NORTHWEST EDGE
OF ALLEY AT STA. 1+05±
ELEV. 110.08

T.B.M.
PK NAIL AT INTERSECTION OF
LAKEVIEW AND ALLEY
ELEV. 100.00

SEE SHEET 14
FOR ALLEY
TYPICAL SECTION

REMOVE AND REPLACE 3,000 P.S.I.
6" THICK REINFC. CONCRETE ALLEY
W/ #3 BARS @ 24" O.C. E.W. 6"

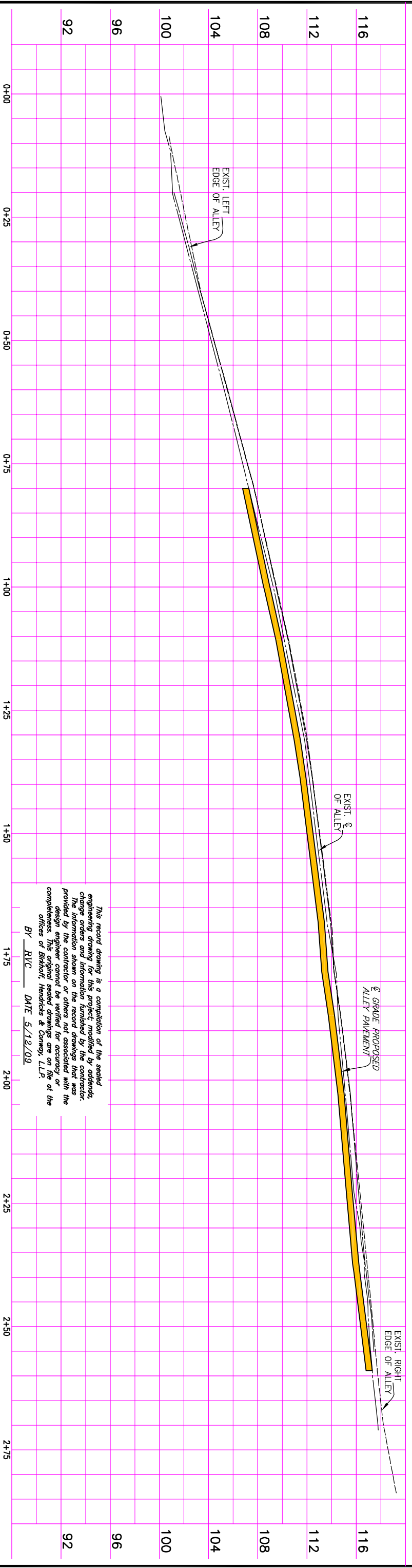

This record drawing is a completion of the sealed engineering drawing for this project, modified by addenda, change orders, or amendments furnished by the contractor. The contractor is responsible for the accuracy of the data provided by the contractor or others not associated with the design engineer cannot be verified for accuracy or completeness. This original sealed drawings are on file at the offices of Birkhoff, Hendricks & Conway, L.L.P.

BY RVC DATE 5/12/09

FIELD CHANGE NO. 5	AUGUST 14, 2007	5
--------------------	-----------------	---

BIRKHOFF, HENDRICKS & CONWAY, L.L.P.
CONSULTING ENGINEERS
7502 Greenville Ave., Suite 220
Dallas, Texas
(214) 361-7900



Ronald Conway
8/13/07

CITY OF ROCKWALL, TEXAS
NEIGHBORHOOD DRAINAGE IMPROVEMENTS
DRAINAGE SITE 21 IMPROVEMENTS
ALLEY EAST OF LAKEVIEW & NORTH OF LAKE DALE

BHC
PROJECT NO.
2006-182

JANUARY, 2007

SHEET NO.
24