

ELEC
BOX TBX

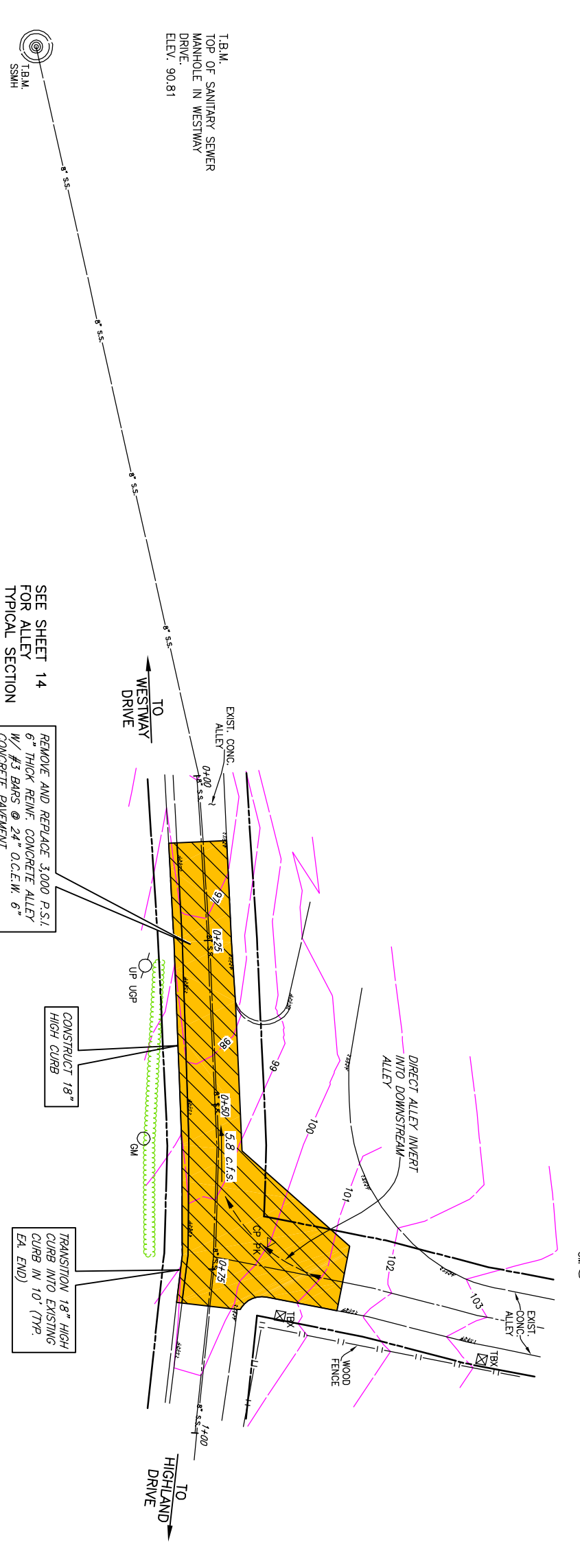
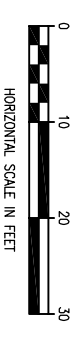

SEE SHEET 14
FOR ALLEY
TYPICAL SECTION

REMOVE AND REPLACE 3,000 P.S.I.
6" THICK REIN. CONCRETE ALLEY
W/ #3 BARS @ 24" O.C.E.W. 6"
CONCRETE PAVEMENT

TRANSITION 18" HIGH
CURB INTO EXISTING
CURB IN 10' (TYP.
EA. END)

CONSTRUCT 18"
HIGH CURB

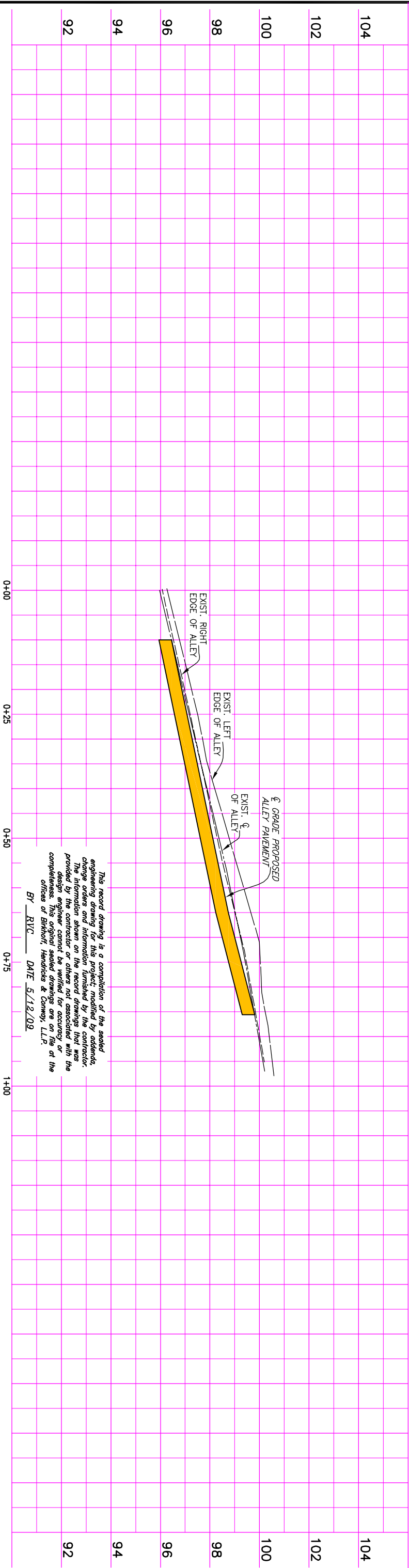

This record drawing is a compilation of the sealed engineering drawing for this project, modified by addenda, change orders and information furnished by the contractor. The information shown on the record drawings that was provided by the contractor or others not associated with the design engineer cannot be verified for accuracy or completeness. This original sealed drawings are on file at the offices of Birkhoff, Hendricks & Conway, L.L.P.
BY RVC DATE 5/12/09

BIRKHOFF, HENDRICKS & CONWAY, L.L.P.
CONSULTING ENGINEERS
7502 Greenville Ave., Suite 220
Dallas, Texas
(214) 361-7900



CITY OF ROCKWALL, TEXAS
NEIGHBORHOOD DRAINAGE IMPROVEMENTS
DRAINAGE SITE 18 IMPROVEMENTS
ALLEY WEST OF VALLEY DRIVE AT WESTWAY DRIVE

BHC
PROJECT NO.
2006-182
JANUARY, 2007
SHEET NO.
21