

SHEET NO.	SHEET DESCRIPTION
1	TITLE SHEET
2	LOCATION MAP & SHEET INDEX
3	DRAINAGE AREA MAP - DRAINAGE SITES 1, 2 & 3
4	DRAINAGE AREA MAP - DRAINAGE SITE 4
5	DRAINAGE SITE 1 IMPROVEMENTS - ALLEY NORTH OF BOYDSTUN DR. AT RIDGEVIEW DR.
6	DRAINAGE SITE 2 IMPROVEMENTS - ALLEY BETWEEN ALEXANDER DR. AND ROBIN RD.
7	DRAINAGE SITE 3 IMPROVEMENTS - ALLEY BETWEEN STONEBRIDGE DR. AND LAKESHORE DR.
8	DRAINAGE SITE 4 IMPROVEMENTS - SPRING CREEK DR. NORTH OF STONECREST DR.

**SHEET INDEX**

**SHEET DESCRIPTION**

**LEGEND**

DRAINAGE IMPROVEMENT SITE

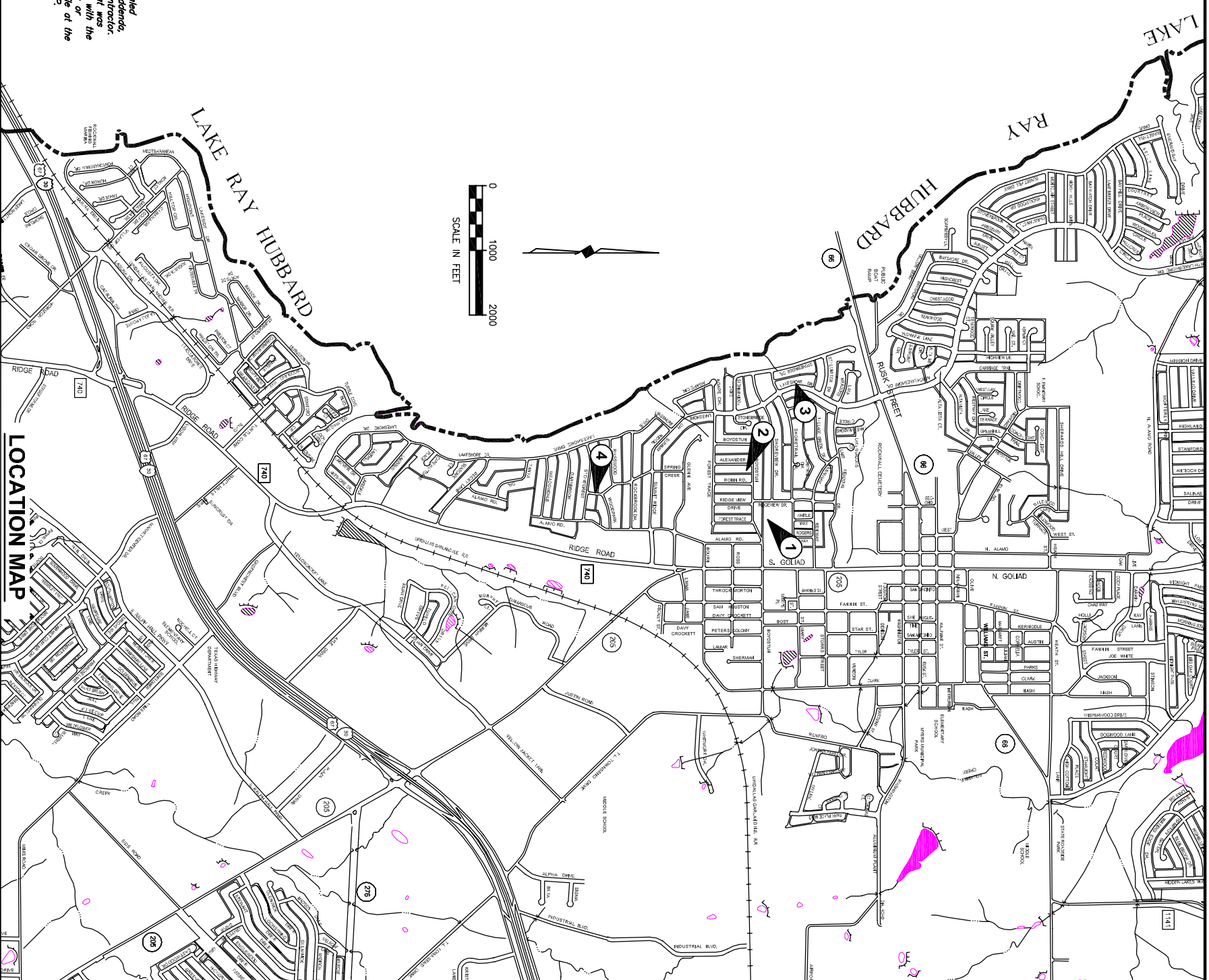

*This record drawing is a completion of the sealed engineering drawing for this project, modified by addenda, change orders and information furnished by the contractor. The information shown on the record drawings that was provided by the contractor or others not associated with the design engineer cannot be verified for accuracy or completeness. This signed standard drawing is on file at the offices of Birkhoff, Hendricks & Conway, L.L.P.*

BY RVC DATE 5/12/09

**BIRKHOFF, HENDRICKS & CONWAY, L.L.P.**  
 CONSULTING ENGINEERS  
 7502 Greenville Ave., Suite 220  
 Dallas, Texas  
 (214) 361-7900



*Ronald V. Conway*  
 9/13/08

**CITY OF ROCKWALL, TEXAS**  
 NEIGHBORHOOD DRAINAGE IMPROVEMENTS - PHASE 2  
 LOCATION MAP & SHEET INDEX

BHC  
 PROJECT NO.  
 2006-182  
 SHEET NO.  
**2**  
 SEPTEMBER 2008