

NOTES:

- 1) 120 VOLT CIRCUITS SHALL BE PROTECTED BY 30mA EQUIPMENT GROUND FAULT PROTECTION.
- 2) GROUNDING CONNECTION SHALL NOT EXCEED 1 OHM.
- 3) ENGINE GENERATOR AND MOTOR CONTROL CENTER SHALL BE INSTALLED ABOVE ELEVATION 514.00

LIFT STATION ELECTRICAL SITE PLAN
SCALE: 3/4"=1'-0"

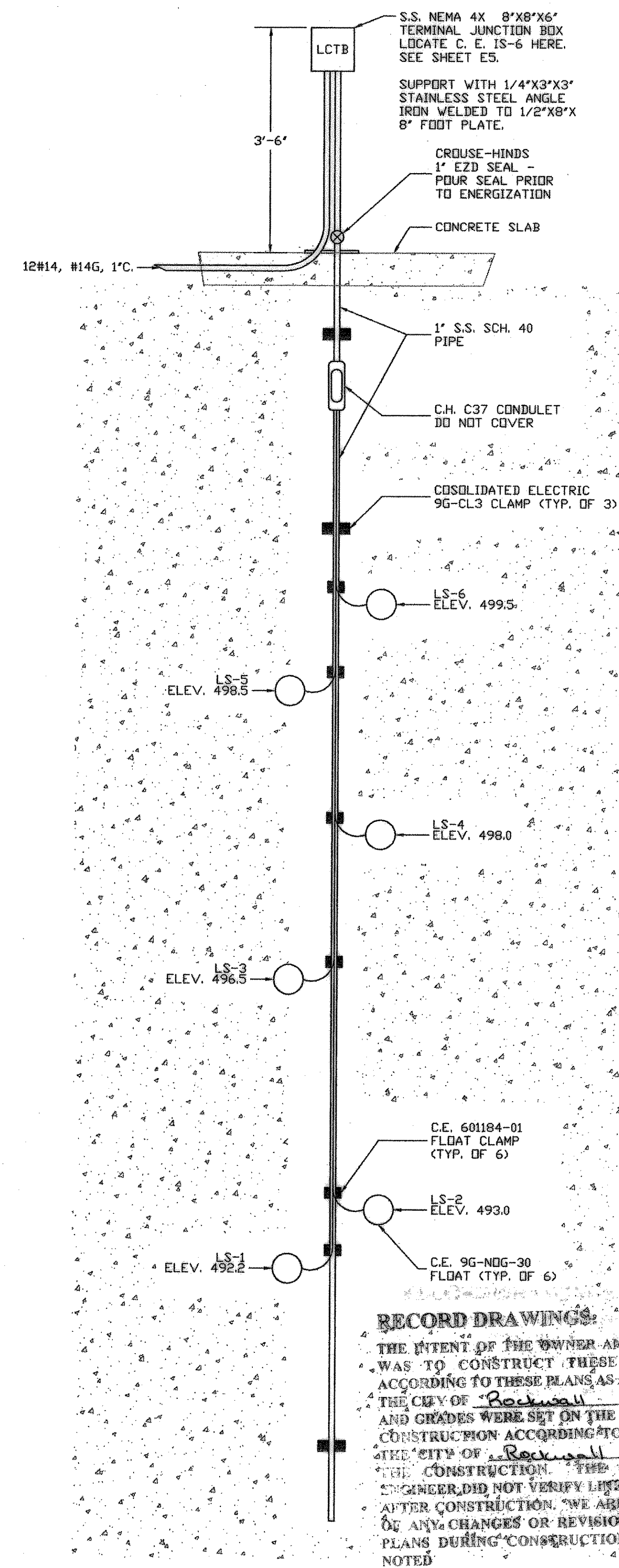

RECORD DRAWINGS

THE INTENT OF THE OWNER AND ENGINEER WAS TO CONSTRUCT THESE FACILITIES ACCORDING TO THESE PLANS AS APPROVED BY THE CITY OF Rockwall. THE LINES AND GRADES WERE SET ON THE GROUND FOR CONSTRUCTION ACCORDING TO SAID PLANS. THE CITY OF Rockwall INSPECTED THE CONSTRUCTION. THE OWNER NOR ENGINEER DID NOT VERIFY LINES OR GRADES AFTER CONSTRUCTION. WE ARE NOT AWARE OF ANY CHANGES OR REVISIONS TO THESE PLANS DURING CONSTRUCTION, EXCEPT AS NOTED

LEVEL CONTROL ELEVATION
NOT TO SCALE

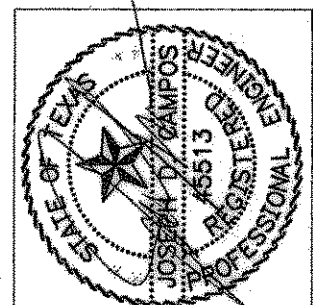

THE SEAL APPEARING ON THIS DOCUMENT WAS AUTHORIZED BY JOSEPH D. CAMPOS TEXAS P.E. NO. 45513 ON 1-17-00

DOUPHRATE & ASSOCIATES, INC.
ENGINEERING • PROJECT MANAGEMENT • SURVEYING
2231 RIDGE RD., # 200 ROCKWALL, TEXAS 75087
PHONE: (972)771-9004 FAX: (972)771-9005

LOCAL ELECTRICAL SITE PLAN AND LEVEL CONTROL ELEVATION

REVISION	
CHECKED	WLD
DRAWN	KEB
DATE	1/28/98
PROJECT	972MA