

CURVE TABLE					
CURVE	LENGTH	RADIUS	TANGENT	DELTA	CHORD
C1	17.89	200.00	8.95	5°07'35"	17.89
C2	67.26	200.00	33.95	19°16'08"	66.94
C3	72.50	200.00	36.65	20°46'08"	72.10
C4	14.14	200.00	7.07	4°03'07"	14.14
C5	66.95	200.00	33.79	19°10'47"	66.64

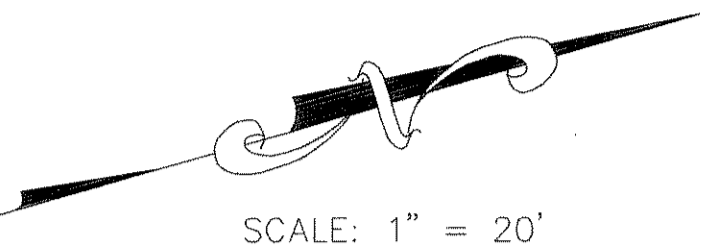
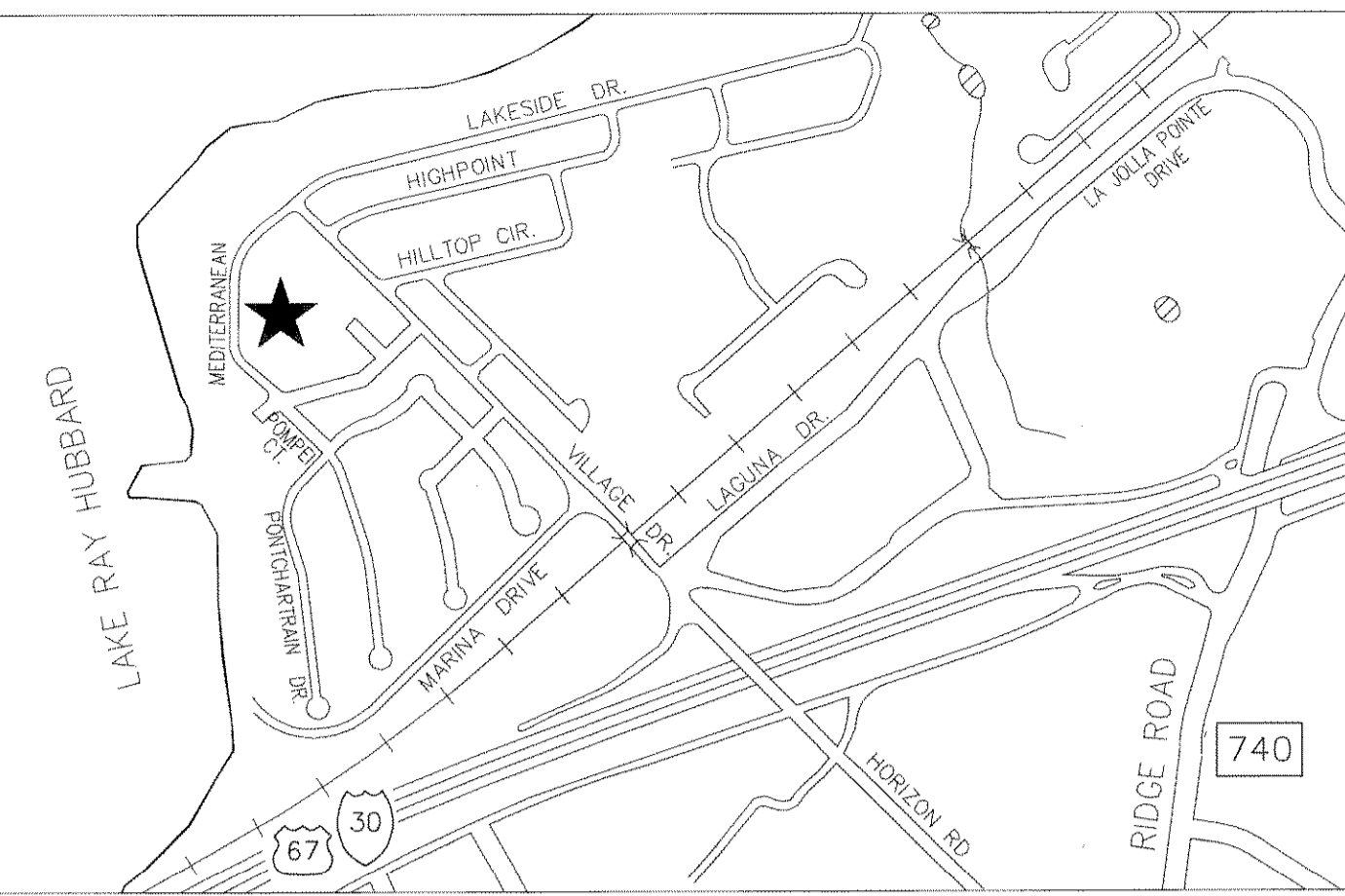

CUT IN SECTION OF 6" PVC. ALL CONNECTIONS TO BE MEGA-LUGGED. STAINLESS STEEL REPAIR CLAMPS ON EACH END.

CUT, PLUG AND ABANDON EXIST. 6" AFTER NEW LINE IS IN SERVICE

5 LF CURB REPAIR

1" SERVICE LINE SEE NOTE #6 (TYP U.N.O.)

- NOTES**
- ALL WATER LINES TO BE MIN. CLASS 200, DR 14.
 - INSTALL BLUE EMS DISKS ON THE WATER LINE AT EVERY CHANGE IN DIRECTION, VALVE, SERVICE, AND EVERY 200' (IN STRAIGHT LINES).
 - CONTRACTOR IS RESPONSIBLE FOR LOCATION OF ALL EXISTING UTILITIES AND FOR ANY RELOCATIONS, DAMAGES, OR REPAIRS OF SAID EXISTING UTILITIES. EXISTING UTILITIES ON PLANS ARE APPROXIMATE.
 - USE CITY OF ROCKWALL STANDARD DETAILS AND NCTCOG 3RD EDITION DETAILS, AS MODIFIED BY CITY.
 - METER BOXES & LIDS LOCATED IN PAVEMENT TO BE TRAFFIC RATED, REFER TO SPECS FOR DETAILS.
 - HOUSE SERVICE: FROM NEW METER TO EXISTING METER INCLUDES: 1" POLY; BACKFILL; COMPACTION; CONNECTION TO EXISTING SERVICE ON HOUSE SIDE OF METER; REMOVAL OF EXISTING METER AND INSERT 8.5" TAIL PIECE; BORE FROM NEW METER BOX, UNDER RETAINING WALL TO EXISTING SERVICE; PAVEMENT REPAIR; ALL FITTINGS.
 - ASPHALT PAVEMENT REPAIR EXTENDS FROM STA 0+15 TO STA 9+34. CONCRETE PAVEMENT REPAIR EXTENDS FROM STA 9+34 TO STA 10+52.
 - CONTRACTOR TO PROVIDE ACCESS TO RESIDENTS DURING CONSTRUCTION.
 - CONTRACTOR TO SECURE CONSTRUCTION AREA AT NIGHT AND WHEN NOT WORKING.
 - CONTRACTOR TO REPLACE DISTURBED FLOWER BEDS, CONCRETE WALK, LANDSCAPING, ETC AT BUILDING (LUMP SUM).
 - CONTRACTOR TO FURNISH TRAFFIC CONTROL INCLUDING PROPER BARRICADES AND FLAGMEN (IF APPROPRIATE).
 - RE-ESTABLISH GRASS IN DISTURBED GRASS AREAS.

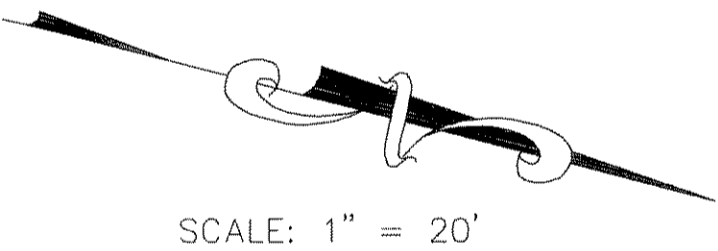

4022 - DENOTES METER ADDRESS

* - EXISTING METER (TO BE REMOVED)

**8" WTR LINE REPLACEMENT
LAKESIDE VILLAGE
ROCKWALL, TEXAS**

CITY OF ROCKWALL
"THE NEW HORIZON"

REVISION NO.	REMARKS	DATE

DESIGNED: KRL	
DRAWN: ACAD	
JOB NO.	

DATE: FEB 2009	SHEET NO. 1 OF 2
----------------	------------------

SCALE: NTS

ADDITIONAL IN-LINE VALVES

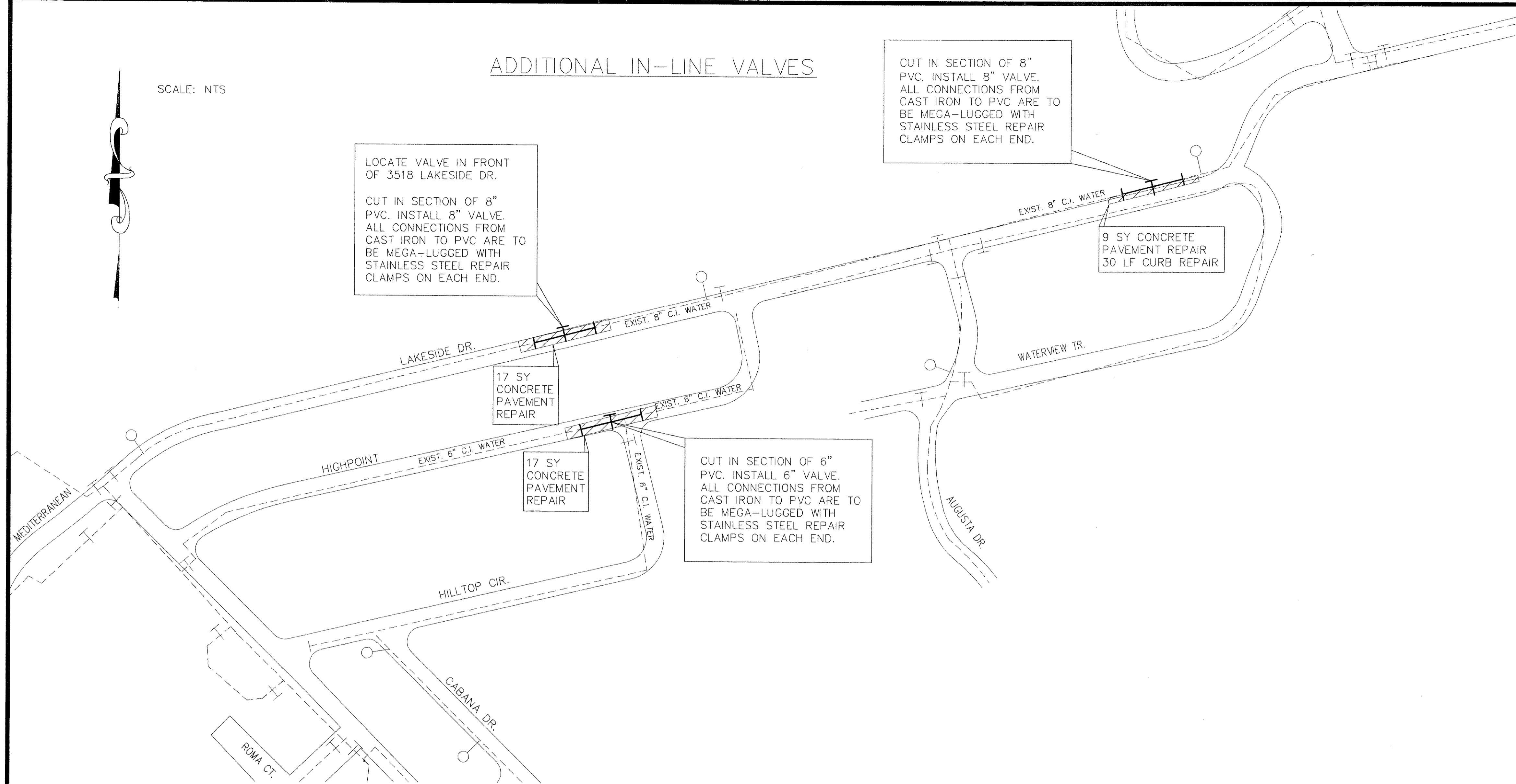

LOCATE VALVE IN FRONT OF 3518 LAKESIDE DR.
CUT IN SECTION OF 8" PVC. INSTALL 8" VALVE. ALL CONNECTIONS FROM CAST IRON TO PVC ARE TO BE MEGA-LUGGED WITH STAINLESS STEEL REPAIR CLAMPS ON EACH END.

CUT IN SECTION OF 8" PVC. INSTALL 8" VALVE. ALL CONNECTIONS FROM CAST IRON TO PVC ARE TO BE MEGA-LUGGED WITH STAINLESS STEEL REPAIR CLAMPS ON EACH END.

17 SY CONCRETE PAVEMENT REPAIR

CUT IN SECTION OF 6" PVC. INSTALL 6" VALVE. ALL CONNECTIONS FROM CAST IRON TO PVC ARE TO BE MEGA-LUGGED WITH STAINLESS STEEL REPAIR CLAMPS ON EACH END.

9 SY CONCRETE PAVEMENT REPAIR
30 LF CURB REPAIR

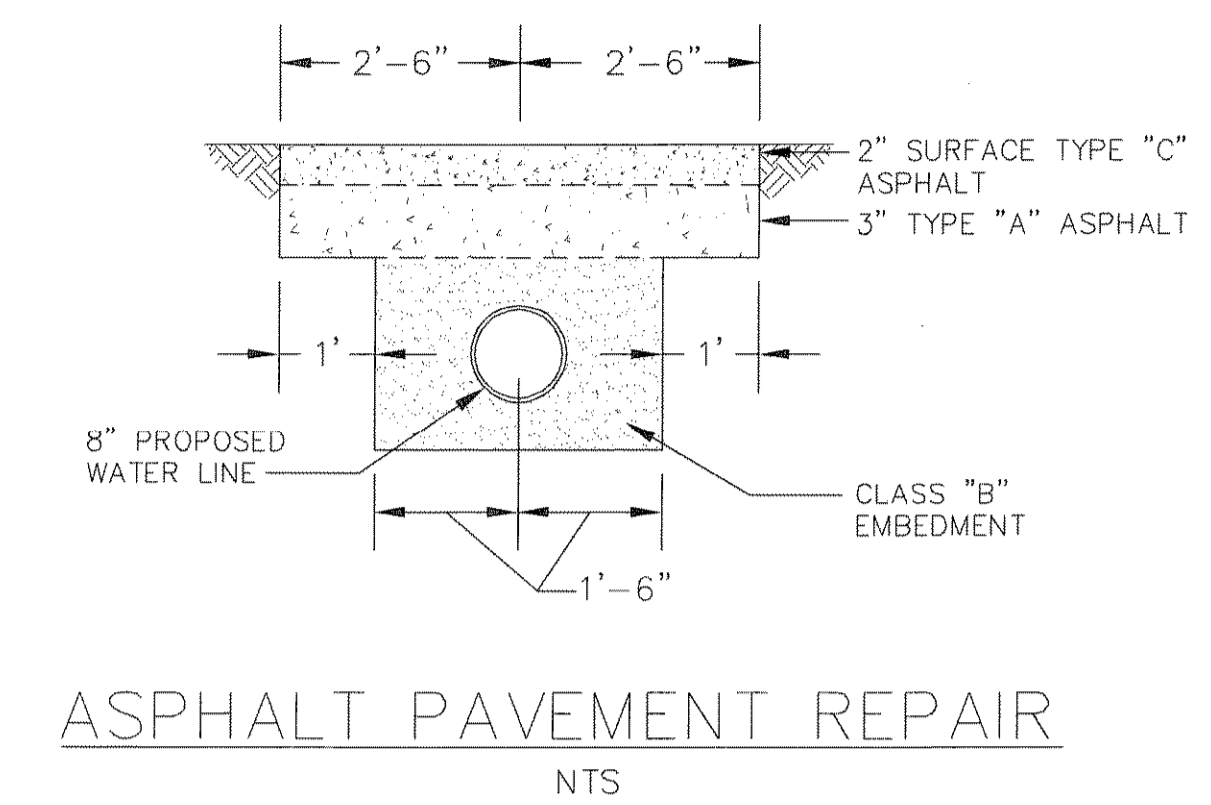

ASPHALT PAVEMENT REPAIR
NTS

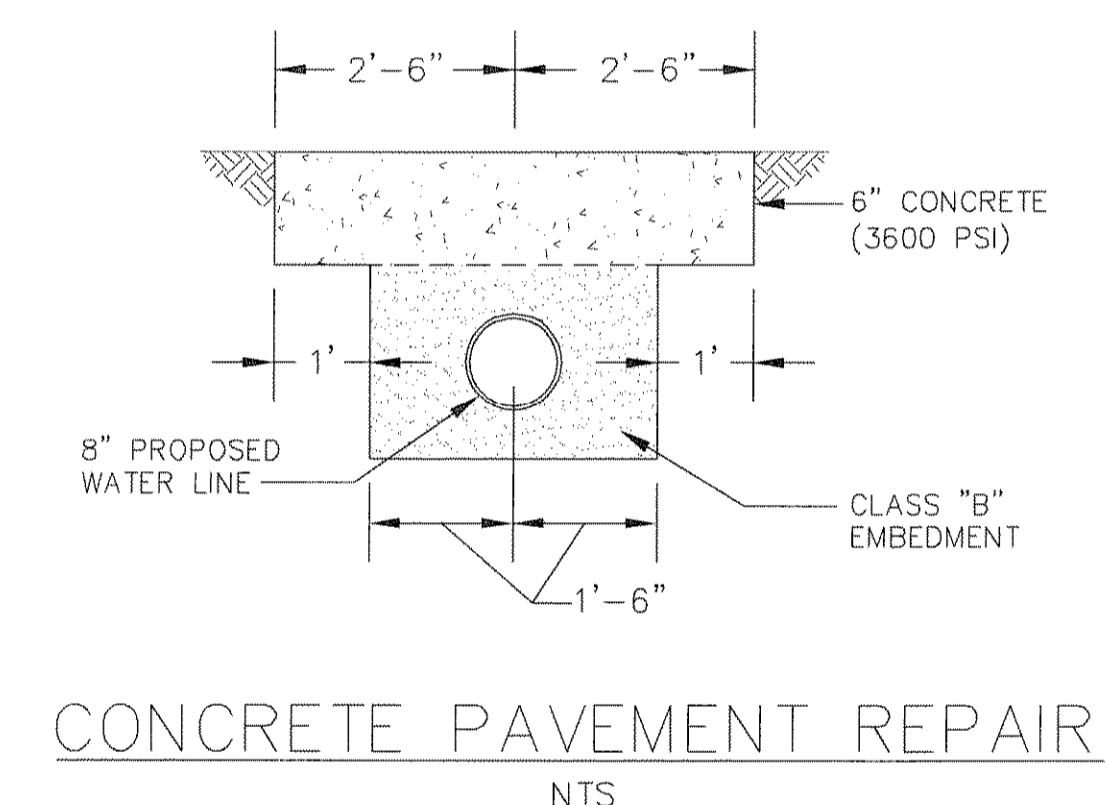

CONCRETE PAVEMENT REPAIR
NTS

NOTES

1. ALL WATER LINES TO BE MIN. CLASS 200, DR 14.
2. INSTALL BLUE EMS DISKS ON THE WATER LINE AT EVERY CHANGE IN DIRECTION, VALVE, SERVICE, AND EVERY 200' (IN STRAIGHT LINES).
3. CONTRACTOR IS RESPONSIBLE FOR LOCATION OF ALL EXISTING UTILITIES AND FOR ANY RELOCATIONS, DAMAGES, OR REPAIRS OF SAID EXISTING UTILITIES. EXISTING UTILITIES ON PLANS ARE APPROXIMATE.
4. USE CITY OF ROCKWALL STANDARD DETAILS AND NCTCOG 3RD EDITION DETAILS, AS MODIFIED BY CITY.

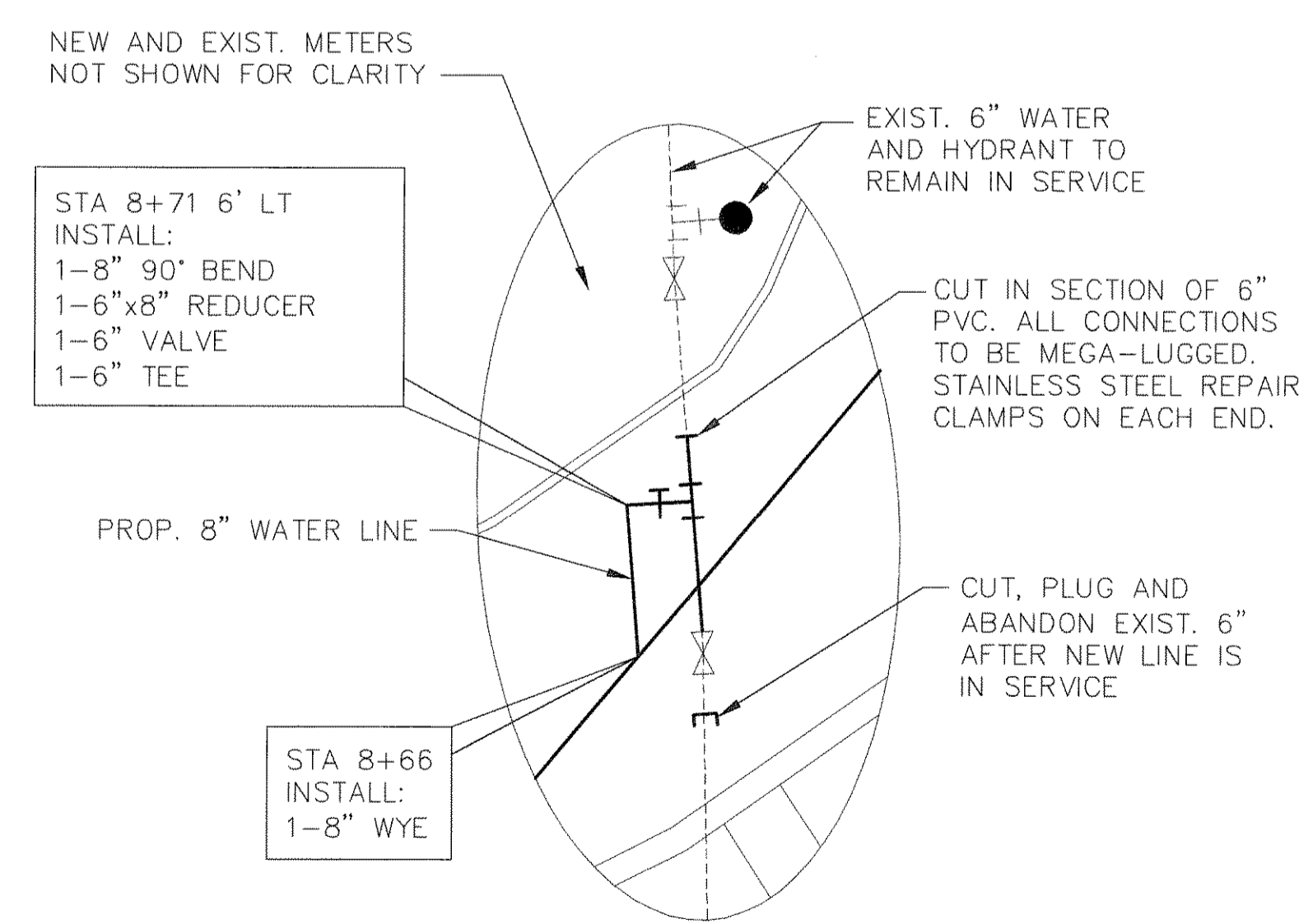

DETAIL "A"
NTS

IN-LINE VALVES & DETAILS	
LAKESIDE VILLAGE	
ROCKWALL, TEXAS	
CITY OF ROCKWALL "THE NEW HORIZON"	
DESIGNED: KRL	
DRAWN: ACAD	
JOB NO.	
DATE: FEB 2009	SHEET NO. 2 OF 2

REVISION NO.	REMARKS	DATE