

CIVIL CONSTRUCTION PLANS

LAKEFRONT TRAIL STORM SEWER

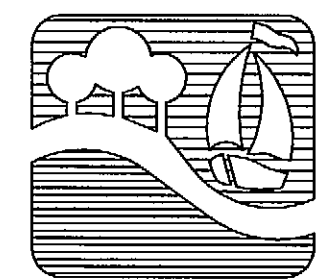

CITY OF ROCKWALL

"THE NEW HORIZON"

GENERAL NOTES
(APPLICABLE TO ALL SHEETS)

1. Excess excavated material shall be placed or removed as directed by the Owner.
2. Construction shall meet the requirements of the latest revision of the Standards of Design and Standard Details for the City of Rockwall. Contractor to be responsible to obtain a copy of NCTCOG specifications.
3. All fill areas to be density controlled and compacted to 95% density at optimum moisture content.
4. It shall be the responsibility of the Contractor to locate and verify all existing utilities prior to the beginning of construction to insure no conflicts between all utility lines.

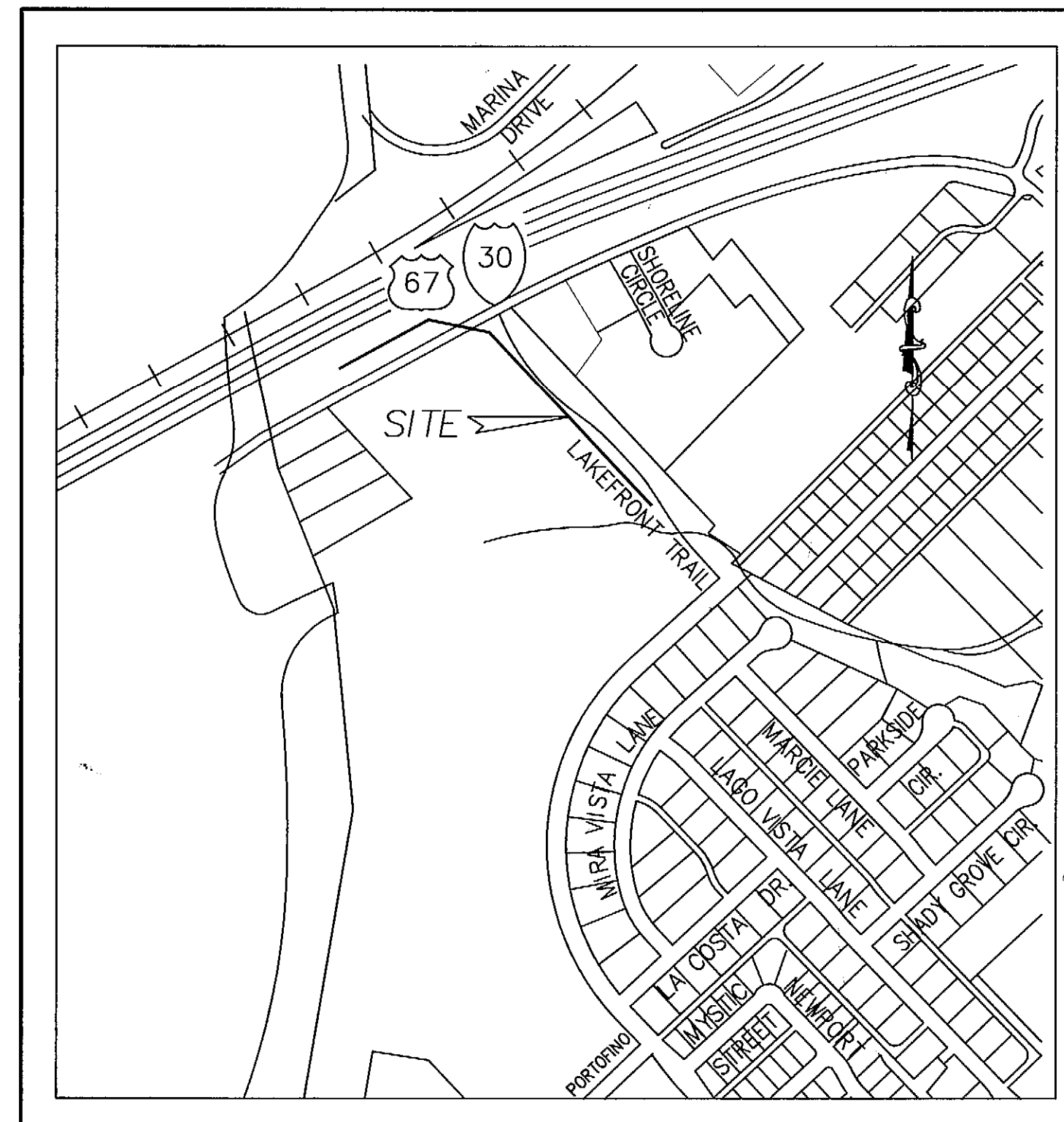

VICINITY MAP

SHEET INDEX

1. DRAINAGE AREA MAP
2. STORM SEWER PLAN
3. STORM SEWER PROFILES
4. DETAILS
5. DETAILS

OWNER
CITY OF ROCKWALL
385 SOUTH GOLIAD STREET
ROCKWALL, TEXAS 75087
(972) 771-7746

NOTE:
CONTRACTOR TO VERIFY IN THE FIELD THE LOCATION OF ALL EXISTING UTILITIES PRIOR TO CONSTRUCTION. INFORMATION PROVIDED WITHIN THESE PLANS DOES NOT RELIEVE THE CONTRACTOR OF THE FULL AND TOTAL RESPONSIBILITY FOR THE PROTECTION OF EXISTING UTILITIES NOR ANY DAMAGES CAUSED BY SAID CONTRACTOR DURING CONSTRUCTION.

DECEMBER 2004

LAKEFRONT TRAIL STORM SEWER