

# CITY OF ROCKWALL

"THE NEW HORIZON"

# RIDGE VIEW / KENWAY / WHITTLE WAY SHORETRAIL / SHOREVIEW

PAVING, STORMWATER, WATER & WASTEWATER IMPROVEMENTS

MAYOR

Ken Jones

CITY COUNCIL

Terry Raulston

Bill Cecil

Nell Welborn

John King

Billy Morris

Bob Cotti

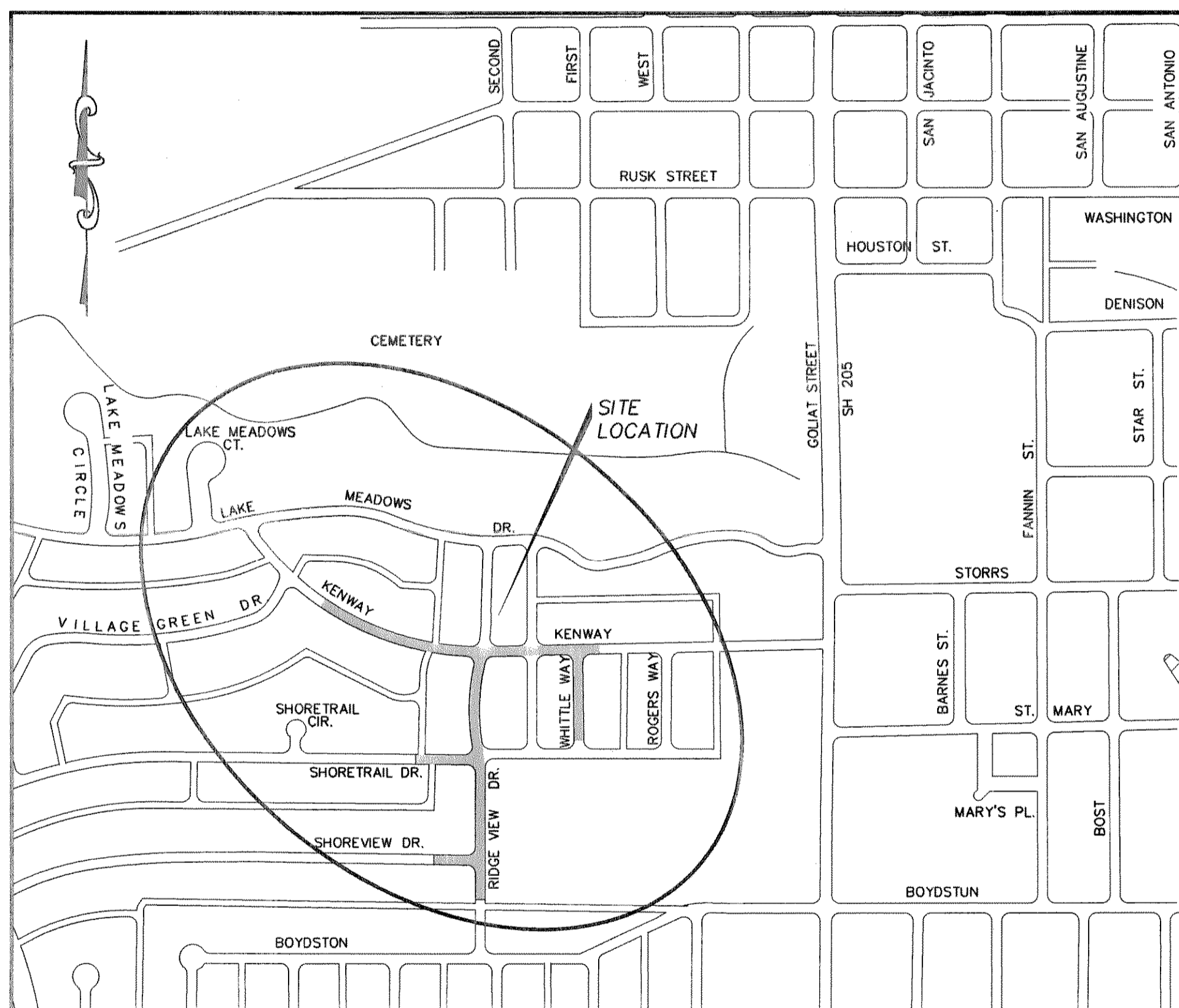

CONTRACTOR SHALL OBTAIN COPIES OF THE LATEST CITY OF ROCKWALL STANDARD DETAILS AND NORTH CENTRAL TEXAS COUNCIL OF GOVERNMENT STANDARD SPECIFICATIONS FOR PUBLIC WORKS CONSTRUCTION WITH ROCKWALL AMENDMENTS. CONTRACTOR SHALL HAVE ONE COPY ON THE PROJECT AT ALL TIMES.

INDEX OF DRAWINGS

SHEET NO.	TITLE
C-1	COVER SHEET
Q-1	QUANTITY SHEET
PH-1	CONSTRUCTION PHASING
P-1 TO P-10	PAVING PLANS & PROFILES
X-1	CROSS SECTIONS
ST-1	DRAINAGE AREA MAP
ST-2	DRAINAGE CALCULATIONS
ST-3 TO ST-9	STORMWATER PLANS & PROFILES
U-1	WASTEWATER PLAN
U-2 TO U-3	WASTEWATER PROFILES
U-4	WATER PLAN
D-1	DETAILS

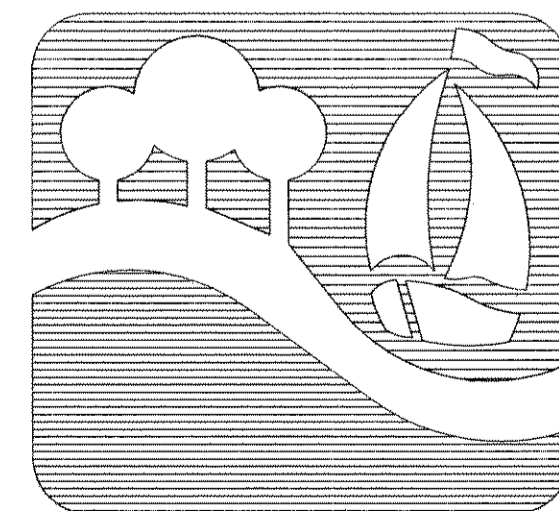

ROCKWALL, TEXAS

NOTE: INFORMATION ON UNDERGROUND FRANCHISED UTILITIES, BOTH EXISTING & PROPOSED, WAS NOT RECEIVED PRIOR TO ISSUING THESE PLANS FOR BID. CONTRACTOR TO VERIFY IN THE FIELD THE LOCATION OF ALL EXISTING UTILITIES PRIOR TO CONSTRUCTION. INFORMATION PROVIDED WITHIN THESE PLANS DOES NOT RELIEVE THE CONTRACTOR OF THE FULL AND TOTAL RESPONSIBILITY FOR THE PROTECTION OF EXISTING UTILITIES NOR ANY DAMAGES CAUSED BY SAID CONTRACTOR DURING CONSTRUCTION.

OWNER:

CITY OF ROCKWALL  
ENGINEERING DEPARTMENT  
205 WEST RUSK  
ROCKWALL, TEXAS 75087  
(972) 771-7700

ENGINEER:

HUITT-ZOLLARS  
HUITT-ZOLLARS, INC.  
3131 MCKINNEY AVE., SUITE 600  
DALLAS, TEXAS 75204  
(214) 871-3311

RECORD DRAWINGS JULY 25, 2003  
THIS RECORD DOCUMENT HAS BEEN PREPARED BASED ON INFORMATION PROVIDED BY OTHERS. THE CONSULTANT HAS NOT VERIFIED THE ACCURACY AND/OR COMPLETENESS OF THIS INFORMATION AND SHALL NOT BE RESPONSIBLE FOR ANY ERRORS OR OMISSIONS THAT MAY BE INCORPORATED AS A RESULT OF ERRONEOUS INFORMATION PROVIDED BY OTHERS.

THE SEAL APPEARING ON THIS DOCUMENT WAS AUTHORIZED BY KENNETH A. ROBERTS, P.E. 55446 ON AUGUST 8, 2002

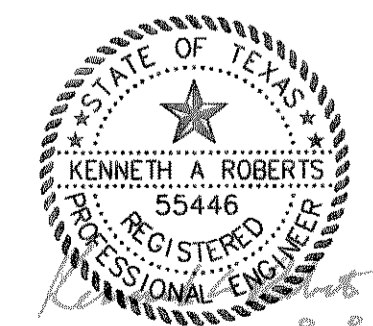

\*no ref logical\*, \*no ref name\*, \*no ref levels\*  
\*no ref logical\*, \*no ref name\*, \*no ref levels\*  
\*no ref logical\*, \*no ref name\*, \*no ref levels\*  
\*no ref logical\*, \*no ref name\*, \*no ref levels\*  
\*no ref logical\*, \*no ref name\*, \*no ref levels\*  
\*no ref logical\*, \*no ref name\*, \*no ref levels\*

\*no ref logical\*, \*no ref name\*, \*no ref levels\*  
\*no ref logical\*, \*no ref name\*, \*no ref levels\*  
\*no ref logical\*, \*no ref name\*, \*no ref levels\*  
\*no ref logical\*, \*no ref name\*, \*no ref levels\*  
\*no ref logical\*, \*no ref name\*, \*no ref levels\*  
\*no ref logical\*, \*no ref name\*, \*no ref levels\*

theresso  
SCALE=0.999800  
PRF\_ROTATION=270.000000  
F:\b\HZ\FULL.TBL

h:\proj\01301801\dgn\301801GC001.DGN  
DATE: 7/29/03  
TIME: 07:57:48