

- NOTES:
1. ALL CONDUIT FOR ILLUMINATION ASSEMBLIES SHALL BE PLACED 3-FT FROM 205 BYPASS CENTERLINE.
 2. CONDUIT INSTALLATION WILL BE PHASED IN FOLLOWING SUBGRADE OPERATIONS AND FOLLOWING UTILITY CONSTRUCTION, BUT PRIOR TO ROADWAY PAVEMENT CONSTRUCTION. IF CONSTRUCTION ACTIVITIES REQUIRE CONDUIT PLACEMENT AFTER STREET PAVEMENT CONSTRUCTION, THEN CONDUIT WILL NEED TO BE BORED FOR PLACEMENT. OPEN CUT METHOD OF CONDUIT PLACEMENT WILL NOT BE PERMITTED ON NEW PAVEMENT.
 3. CONDUIT LENGTHS SHOWN REPRESENT ENTIRE RUN (GROUND BOX-TO-GROUND BOX).
 4. IRRIGATION SLEEVES SHALL BE INSTALLED 2-FT FROM ELECTRICAL BOXES SHOWN ON PLANS, AND NOT CONNECTED TO BOXES.

LEGEND

■ EB	PROPOSED ELEC. GROUND BOX
—	PROPOSED 2" CONDUIT
- - -	PROPOSED 4" IRRIGATION SLEEVE
■ VB	PROPOSED IRRIG. VALVE BOX
○ PB	PROPOSED ILLUMINATION POLE BASE FOUNDATION FOR 30' POLE.

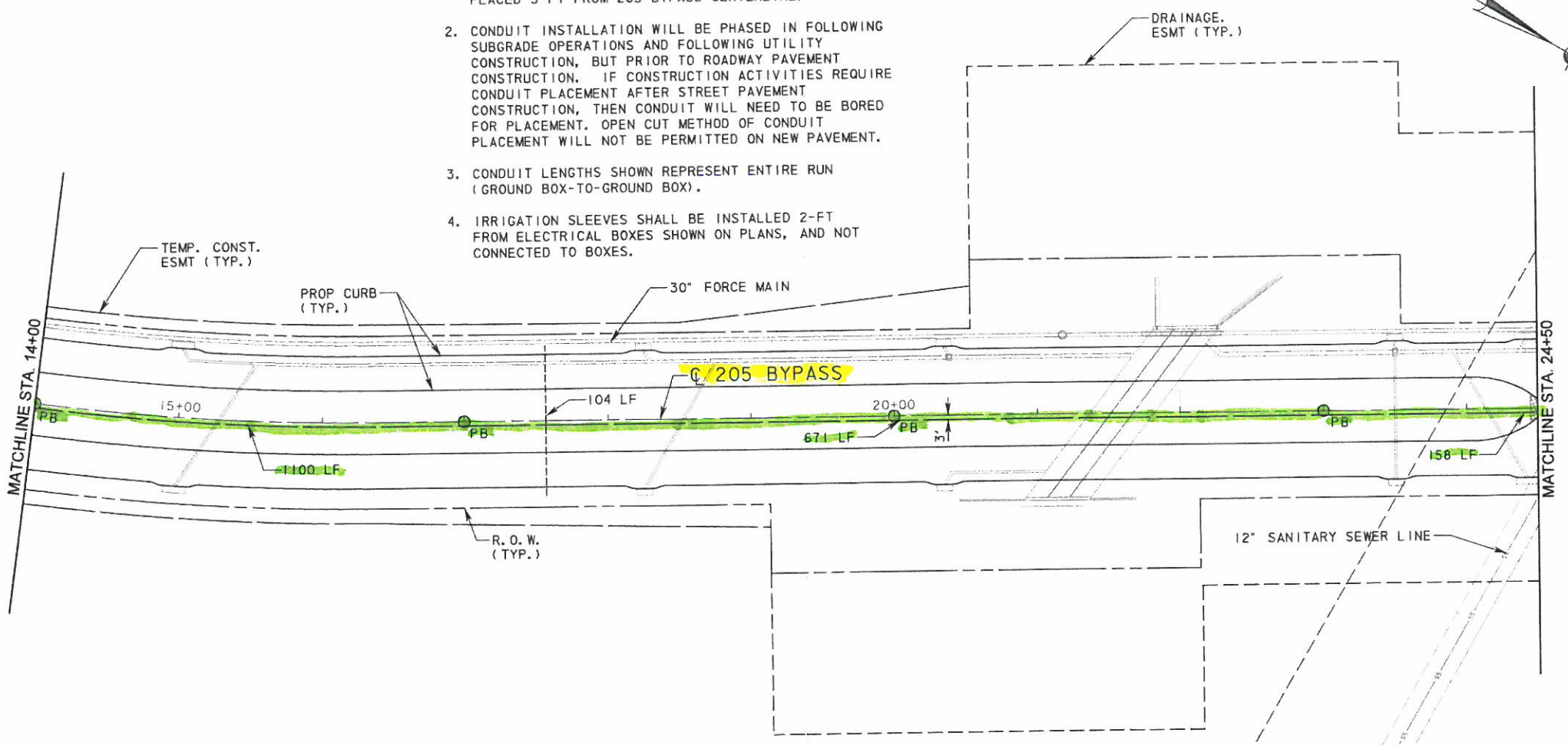

RECORD DRAWING

This drawing is a completion of the original sealed engineering drawing and modifications by addenda, change orders and information furnished by the contractor. Information shown that was provided by the contractor and others not associated with the design engineer cannot be verified for accuracy or completeness. Original sealed drawing is on file at the office of AECOM USA Group, Inc., TBPE REG. NO. F-3082

ORIGINAL DRAWING SEALED & SIGNED BY
 T.H. Gaertner, P.E.
 TX NO. 37124

NO.				REVISION				BY				DATE			
 City of Rockwall, Texas 205 BYPASS PHASE 3 ILLUMINATION & IRRIGATION PLAN STA. 4+50 TO STA. 24+50															
TCB				AECOM				TCB INC.				WWW.TCB.AECOM.COM			
								17000 DALLAS PARKWAY, SUITE 1010				DALLAS TEXAS 75248			
Unit	PW-DAL-FW			Scale	AS SHOWN			Date	11/16/2009						
Designed	THG			Checked	TCB			Project No.	60004153						
Drawn	FC			Approved	TCB			Sheet	110 of 215						

\\wdd11f001\PMW\328\60004153-205Bypass\CADD\Sheet3\Phase 3 - 1 30 to Station SH 66\Record Drawing 10.7.09\110 Irrig-illum-01.dwg
 11/16/2009

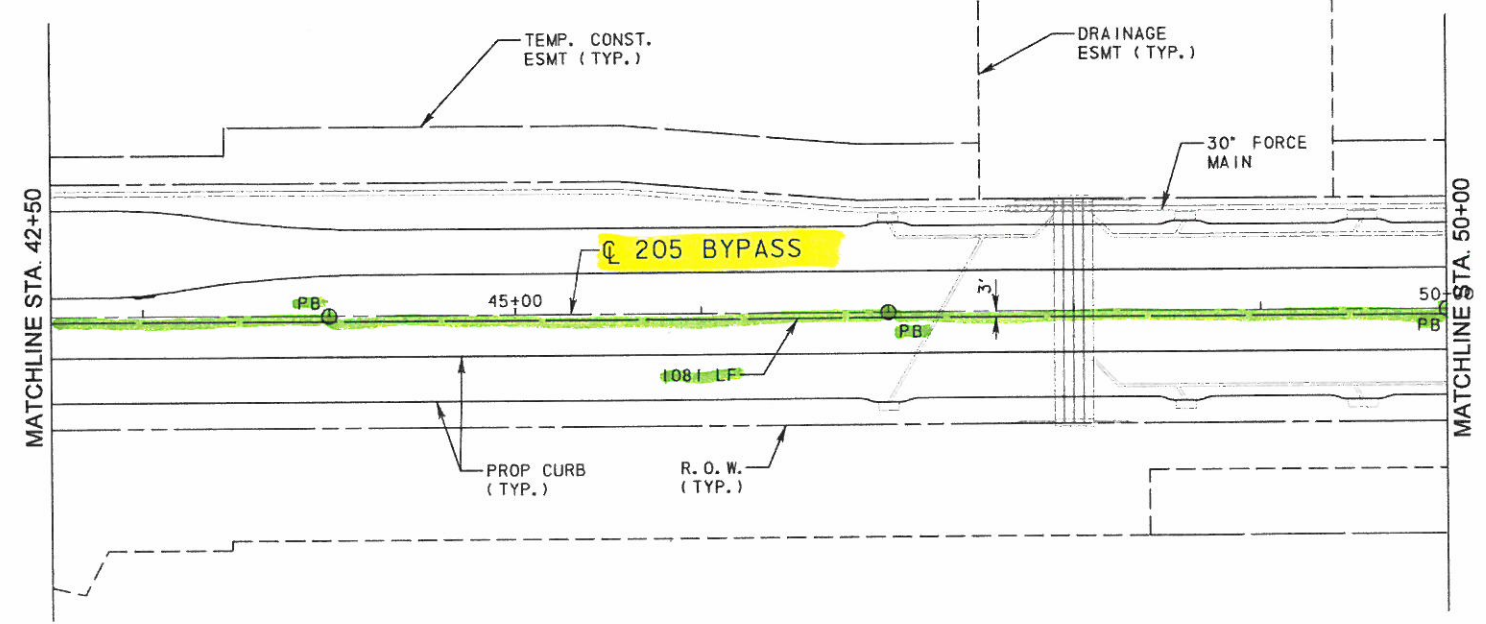
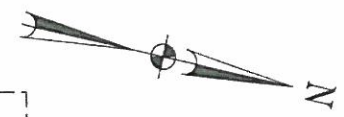
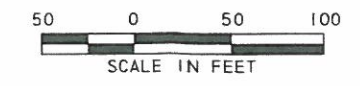

- NOTES:
1. ALL CONDUIT FOR ILLUMINATION ASSEMBLIES SHALL BE PLACED 3-FT FROM 205 BYPASS CENTERLINE.
 2. CONDUIT INSTALLATION WILL BE PHASED IN FOLLOWING SUBGRADE OPERATIONS AND FOLLOWING UTILITY CONSTRUCTION, BUT PRIOR TO ROADWAY PAVEMENT CONSTRUCTION. IF CONSTRUCTION ACTIVITIES REQUIRE CONDUIT PLACEMENT AFTER STREET PAVEMENT CONSTRUCTION, THEN CONDUIT WILL NEED TO BE BORED FOR PLACEMENT. OPEN CUT METHOD OF CONDUIT PLACEMENT WILL NOT BE PERMITTED ON NEW PAVEMENT.
 3. CONDUIT LENGTHS SHOWN REPRESENT ENTIRE RUN (GROUND BOX-TO-GROUND BOX).
 4. IRRIGATION SLEEVES SHALL BE INSTALLED 2-FT AWAY FROM ELECTRIC GROUND BOXES SHOWN ON PLANS, AND NOT CONNECT TO BOXES.

LEGEND

- EB PROPOSED ELEC. GROUND BOX
- PROPOSED 2" CONDUIT
- - - PROPOSED 4" IRRIGATION SLEEVE
- VB PROPOSED IRRIG. VALVE BOX
- PB PROPOSED ILLUMINATION POLE
BASE FOUNDATION FOR 30' POLE.

RECORD DRAWING
 This drawing is a compilation of the original sealed engineering drawing and modifications by addenda, change orders and information furnished by the contractor. Information shown that was provided by the contractor and others not associated with the design engineer cannot be verified for accuracy or completeness. Original sealed drawing is on file at the office of AECOM USA Group, Inc., TBPE REG. NO. F-3082.

ORIGINAL DRAWING
 SEALED & SIGNED BY
 T.H. Gaertner, P.E.
 TX NO. 37124

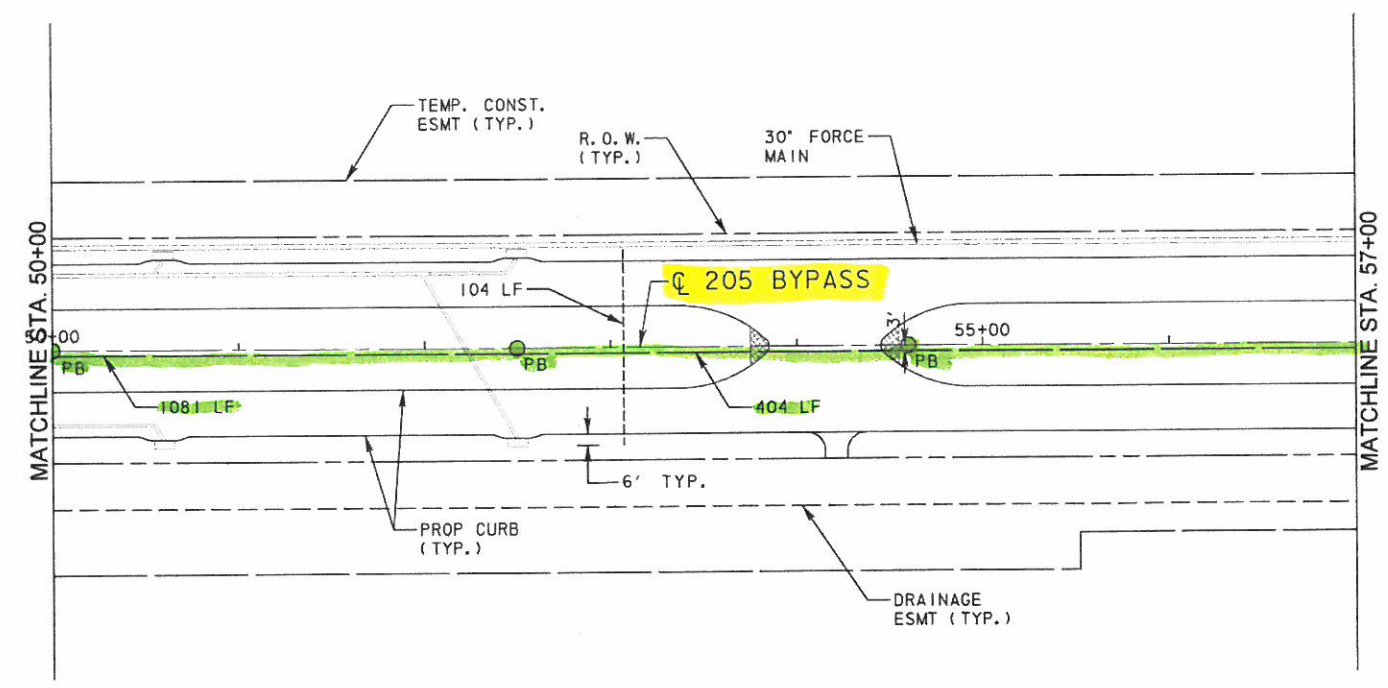
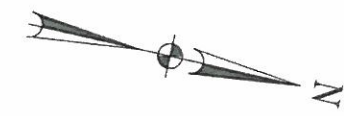

\\usd011f000\pww\4328\60004153-205bypass\CAED\Sheets\Phase 3 - 1 30 to Station 57\66\Record Drawing 10_7_09\112.rvt 11/16/2009 11/16/2009

NO.				REVISION				BY		DATE	
City of Rockwall, Texas 205 BYPASS PHASE 3											
ILLUMINATION & IRRIGATION PLAN STA. 42+50 TO STA. 57+00											
TCB				AECOM				TCB INC WWW.TCB.AECOM.COM 17300 DALLAS PARKWAY SUITE 1010 DALLAS, TEXAS 75248			
Unit	PW-DAL-FW	Scale	Horz: AS SHOWN	Vert: AS SHOWN	Date	11/16/2009					
Designed	THG	Checked	TCB		Project No.	60004153					
Drawn	FG	Approved	TCB		Sheet	112 of 215					



SEE NOTE 5

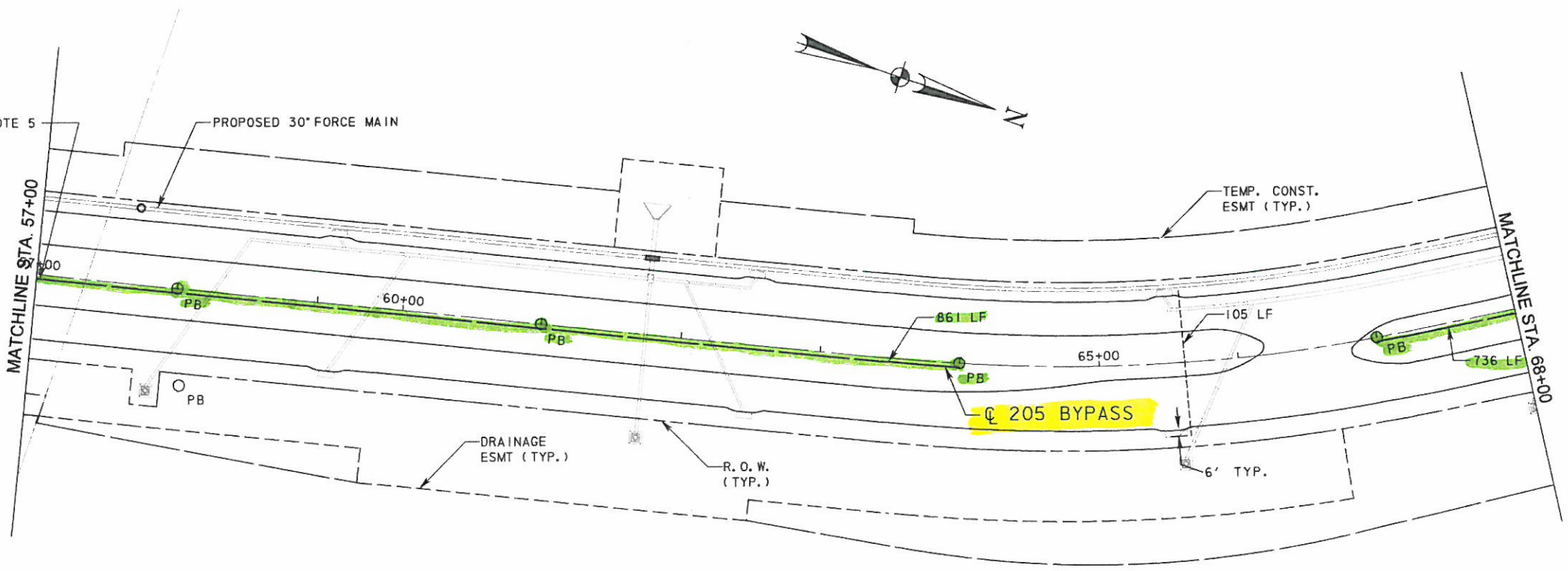

- NOTES:
1. ALL CONDUIT FOR ILLUMINATION ASSEMBLIES SHALL BE PLACED 3-FT FROM 205 BYPASS CENTERLINE.
 2. CONDUIT INSTALLATION WILL BE PHASED IN FOLLOWING SUBGRADE OPERATIONS AND FOLLOWING UTILITY CONSTRUCTION, BUT PRIOR TO ROADWAY PAVEMENT CONSTRUCTION. IF CONSTRUCTION ACTIVITIES REQUIRE CONDUIT PLACEMENT AFTER STREET PAVEMENT CONSTRUCTION, THEN CONDUIT WILL NEED TO BE BORED FOR PLACEMENT. OPEN CUT METHOD OF CONDUIT PLACEMENT WILL NOT BE PERMITTED ON NEW PAVEMENT.
 3. CONDUIT LENGTHS SHOWN REPRESENT ENTIRE RUN (GROUND BOX-TO-GROUND BOX).
 4. IRRIGATION SLEEVES SHALL BE INSTALLED 2-FT AWAY FROM ELECTRIC GROUND BOXES SHOWN ON PLANS, AND NOT CONNECT TO BOXES.

LEGEND

- EB PROPOSED ELEC. GROUND BOX
- PROPOSED 2' CONDUIT
- - - PROPOSED 4' IRRIGATION SLEEVE
- VB PROPOSED IRRIG. VALVE BOX
- PB PROPOSED ILLUMINATION POLE BASE FOUNDATION FOR 30' POLE

RECORD DRAWING
 This drawing is a compilation of the original sealed engineering drawing and modifications by addenda, change orders and information furnished by the contractor. Information shown that was provided by the contractor and others not associated with the design engineer cannot be verified for accuracy or completeness. Original sealed drawing is on file at the office of AECOM USA Group, Inc., TBPE REG. NO. F-3082

ORIGINAL DRAWING SEALED & SIGNED BY
 T.H. Gaertner, P.E.
 TX NO 37124

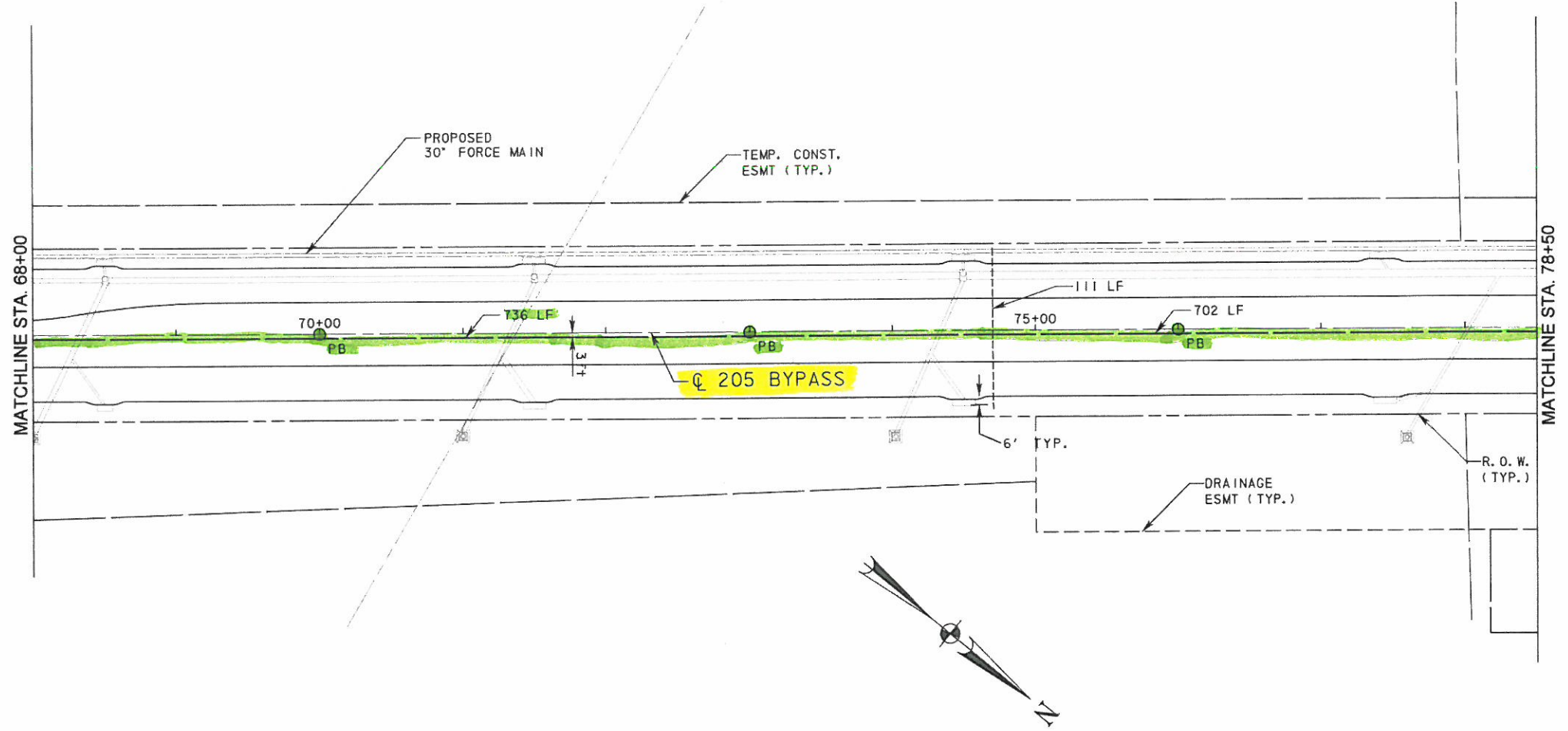

NO.	REVISION	BY	DATE

City of Rockwall, Texas

205 BYPASS
 PHASE 3

ILLUMINATION & IRRIGATION PLAN
 STA. 57+00 TO STA. 78+50

TCB AECOM
 TCB INC.
 WWW.TCB.AECOM.COM
 17300 DALLAS PARKWAY, SUITE 1010
 DALLAS, TEXAS 75248

Unit	PW-DAL-FW	Scale	Horz AS SHOWN	Vert AS SHOWN	Date
Designed	THG	Checked	TCB	Project No.	60004153
Drawn	FG	Approved	TCB	Sheet	113 of 215

\\nsd011\prod\NPRM\428\60004153-205Bypass\CADD\Sheets\Phase 3 - I 30 to Station SH 6A\Record Drawing - I 30 to Station SH 6A\Record Drawing - I 30 to Station SH 6A.dgn
 11/16/2009



NOTES:

1. ALL CONDUIT FOR ILLUMINATION ASSEMBLIES SHALL BE PLACED 3-FT FROM 205 BYPASS CENTERLINE.
2. CONDUIT INSTALLATION WILL BE PHASED IN FOLLOWING SUBGRADE OPERATIONS AND FOLLOWING UTILITY CONSTRUCTION, BUT PRIOR TO ROADWAY PAVEMENT CONSTRUCTION. IF CONSTRUCTION ACTIVITIES REQUIRE CONDUIT PLACEMENT AFTER STREET PAVEMENT CONSTRUCTION, THEN CONDUIT WILL NEED TO BE BORED FOR PLACEMENT. OPEN CUT METHOD OF CONDUIT PLACEMENT WILL NOT BE PERMITTED ON NEW PAVEMENT.
3. CONDUIT LENGTHS SHOWN REPRESENT ENTIRE RUN (GROUND BOX-TO-GROUND BOX).
4. IRRIGATION SLEEVES SHALL BE INSTALLED 2-FT AWAY FROM ELECTRIC GROUND BOXES SHOWN ON PLANS, AND NOT CONNECT TO BOXES.

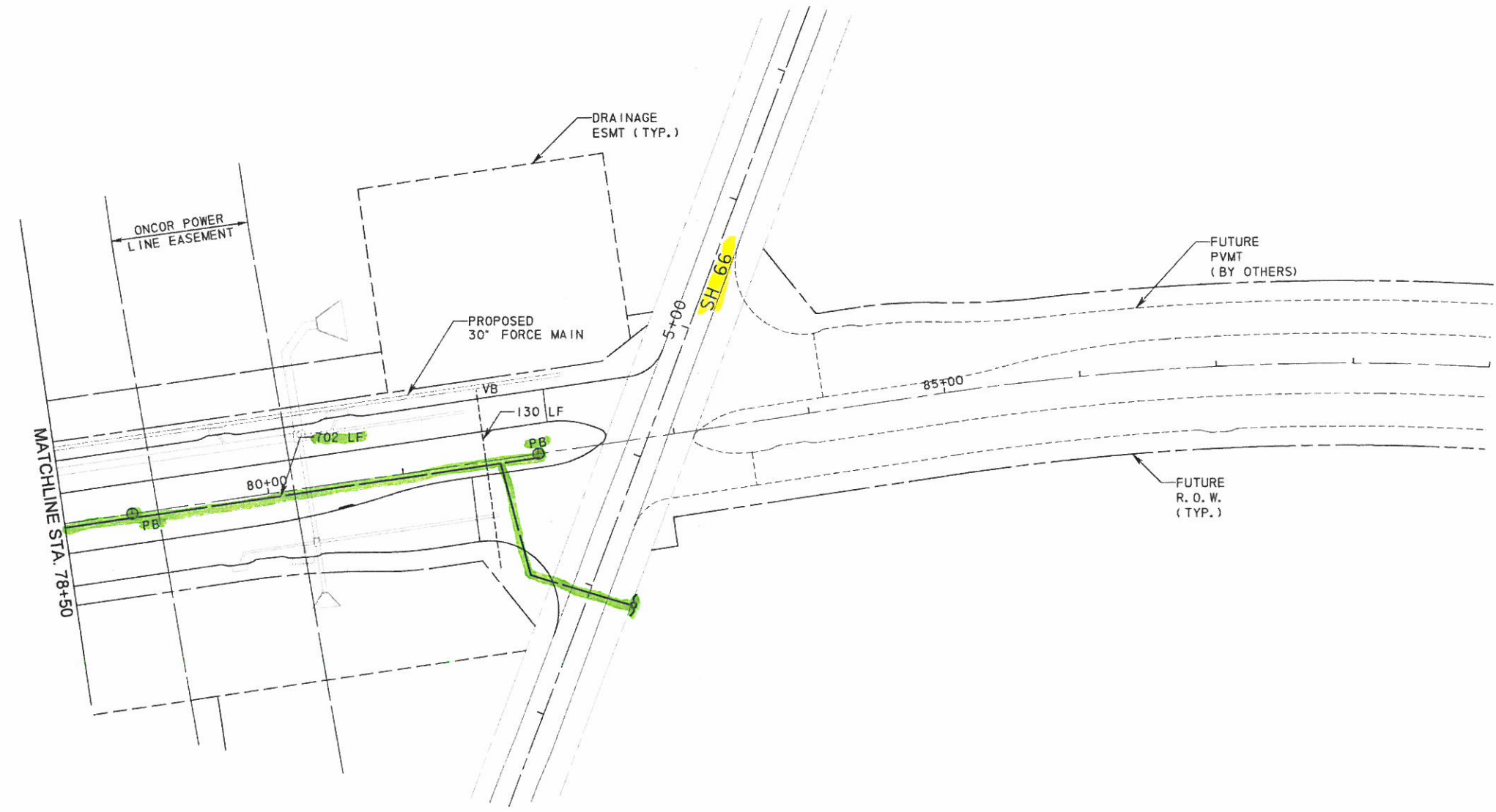

LEGEND

- EB PROPOSED ELEC. GROUND BOX
- PROPOSED 2" CONDUIT
- - - PROPOSED 4" IRRIGATION SLEEVE
- VB PROPOSED IRRIG. VALVE BOX
- PB PROPOSED ILLUMINATION POLE BASE FOUNDATION FOR 30" POLE

RECORD DRAWING
 This drawing is a compilation of the original sealed engineering drawing and modifications by addenda, change orders and information furnished by the contractor. Information shown that was provided by the contractor and others not associated with the design engineer cannot be verified for accuracy or completeness. Original sealed drawing is on file at the office of AECOM USA Group, Inc., TBPE REG. NO. F-3082.

ORIGINAL DRAWING SEALED & SIGNED BY
 T.H. Gaertner, P.E.
 TX NO 37124

\\usdall1p001\pww\4328\60004\53-2055\pss\CA00\Sheets\Phase 3 - 1 30 To Station SH 66\Record Drawing 10.7.09\114rrr-11.tum-05.dgn
 11/16/2009

NO.	REVISION	BY	DATE
City of Rockwall, Texas 205 BYPASS PHASE 3 ILLUMINATION & IRRIGATION PLAN STA. 78+50 TO STA. 83+00			
TCB AECOM <small>TCB INC. WWW.TCB.AECOM.COM 17300 DALLAS PARKWAY, SUITE 1010 DALLAS, TEXAS 75248</small>		<small>Unit: PW-DAL-FW Scale: Horiz: AS SHOWN Date: 11/16/2009 Vert: AS SHOWN</small>	
<small>Designed: THG</small>	<small>Checked: TCB</small>	<small>Project No.: 60004153</small>	
<small>Drawn: FG</small>	<small>Approved: TCB</small>	<small>Sheet: 114 of 215</small>	