

P:\4228\60004\153-205bypass\cadd\sheet\phase 6 - fms52 to 205\record.drawing 10_1_09\0180.dwg - 02.dgn
11/24/2009

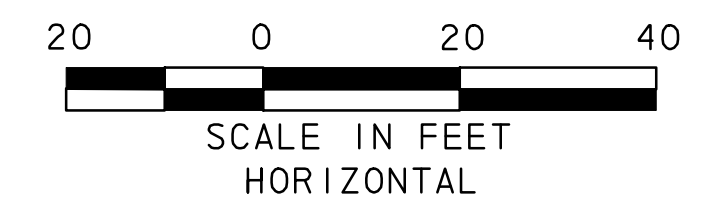
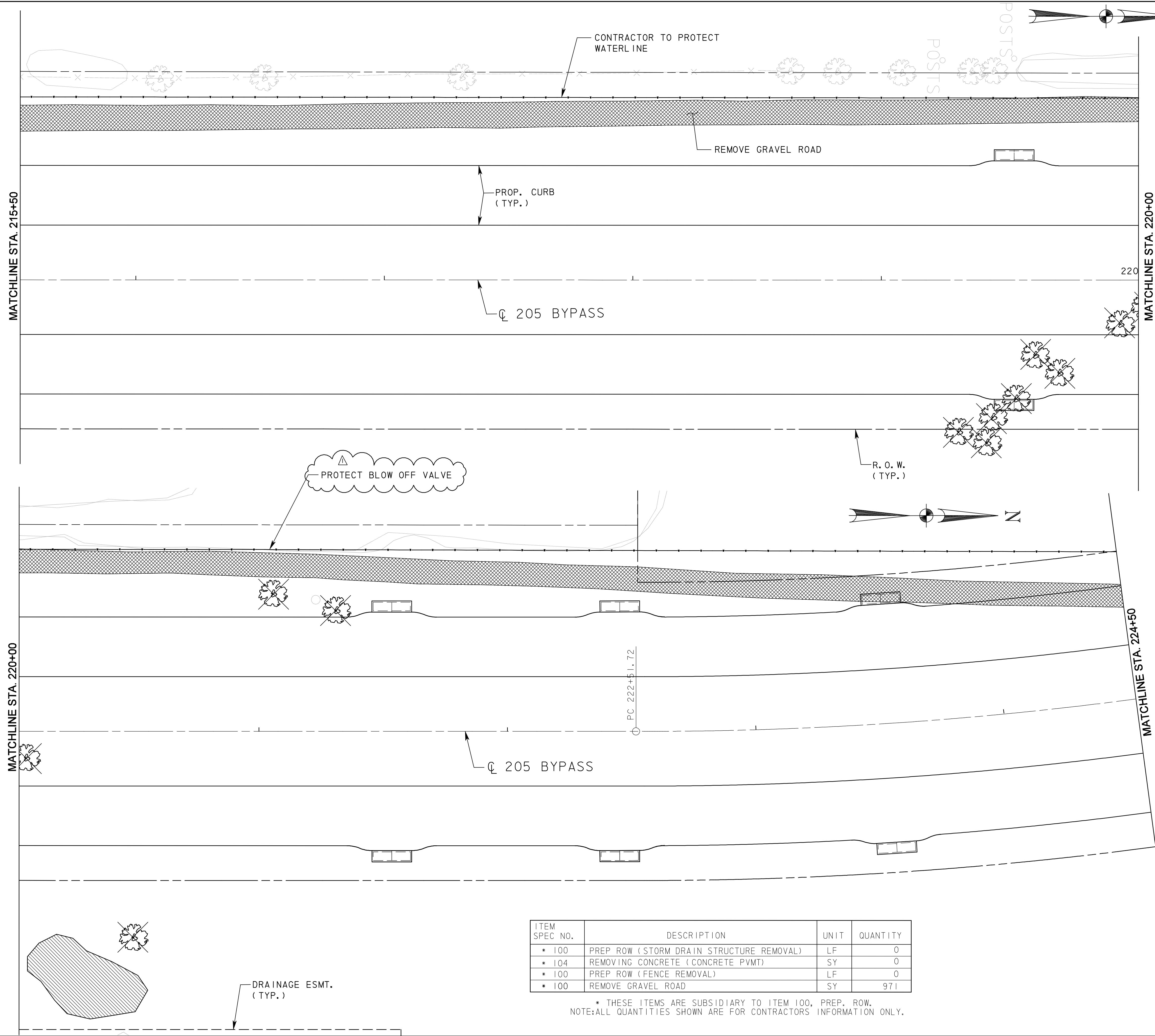

LEGEND

- EXIST. TREE TO REMAIN
- EXIST. TREE TO BE REMOVED
- EXIST. FENCE TO REMAIN
- EXIST. FENCE TO BE REMOVED
- EXIST. BRUSH & SMALL DIAMETER TREES TO BE REMOVED

NOTES:

1. CONTRACTOR SHALL PAY FOR REMOVALS IN ACCORDANCE WITH PREPARING ROW, ITEM NO. 100. REMOVALS FOR ITEM 105 SHALL BE MEASURED & PAID FOR SEPARATLY.
2. QUANTITIES SHOWN ARE FOR CONTRACTOR'S INFORMATION ONLY.
3. FOR UTILITY ADJUSTMENTS, SEE THE UTILITY LAYOUT SHEETS.

RECORD DRAWING
This drawing is a compilation of the original sealed engineering drawing and modifications by addenda, change orders and information furnished by the contractor. Information shown that was provided by the contractor and others not associated with the design engineer cannot be verified for accuracy or completeness. Original sealed drawing is on file at the office of AECOM USA Group, Inc., TBPE REG. NO. F-3082

ORIGINAL DRAWING SEALED & SIGNED BY
Matthew L. Abbe, P.E.
TX NO. 92715

ADDED NOTE		M. L. A.	10/23/07
NO.	REVISION	BY	DATE
205 BYPASS PHASE 6			
DEMOLITION PLAN STA. 215+50 TO STA. 224+50			
2 OF 15			
		<small>TCB INC. WWW.TCB.AECOM.COM 17300 DALLAS PARKWAY, SUITE 1010 DALLAS, TEXAS 75248</small>	
Unit	PW-DAL-FW	Scales	Horz: AS SHOWN Vert: AS SHOWN
Designed	SKW/MLA	Checked	TCB
Drawn	TCB	Approved	TCB
Date	11/24/2009		Project No.
Sheet	18	of	216

ITEM SPEC NO.	DESCRIPTION	UNIT	QUANTITY
* 100	PREP ROW (STORM DRAIN STRUCTURE REMOVAL)	LF	0
* 104	REMOVING CONCRETE (CONCRETE PVMT)	SY	0
* 100	PREP ROW (FENCE REMOVAL)	LF	0
* 100	REMOVE GRAVEL ROAD	SY	971

* THESE ITEMS ARE SUBSIDIARY TO ITEM 100, PREP. ROW.
NOTE: ALL QUANTITIES SHOWN ARE FOR CONTRACTORS INFORMATION ONLY.

