

NOTES:

1. REFERENCE GRADING PLAN AT STA 263+02 FOR GRADING DETAILS.
2. 38.4° IS CULVERT SKEW "V" USED TO CALCULATE HEADWALL DIMENSIONS AS SHOWN ON TXDOT STANDARD PW.

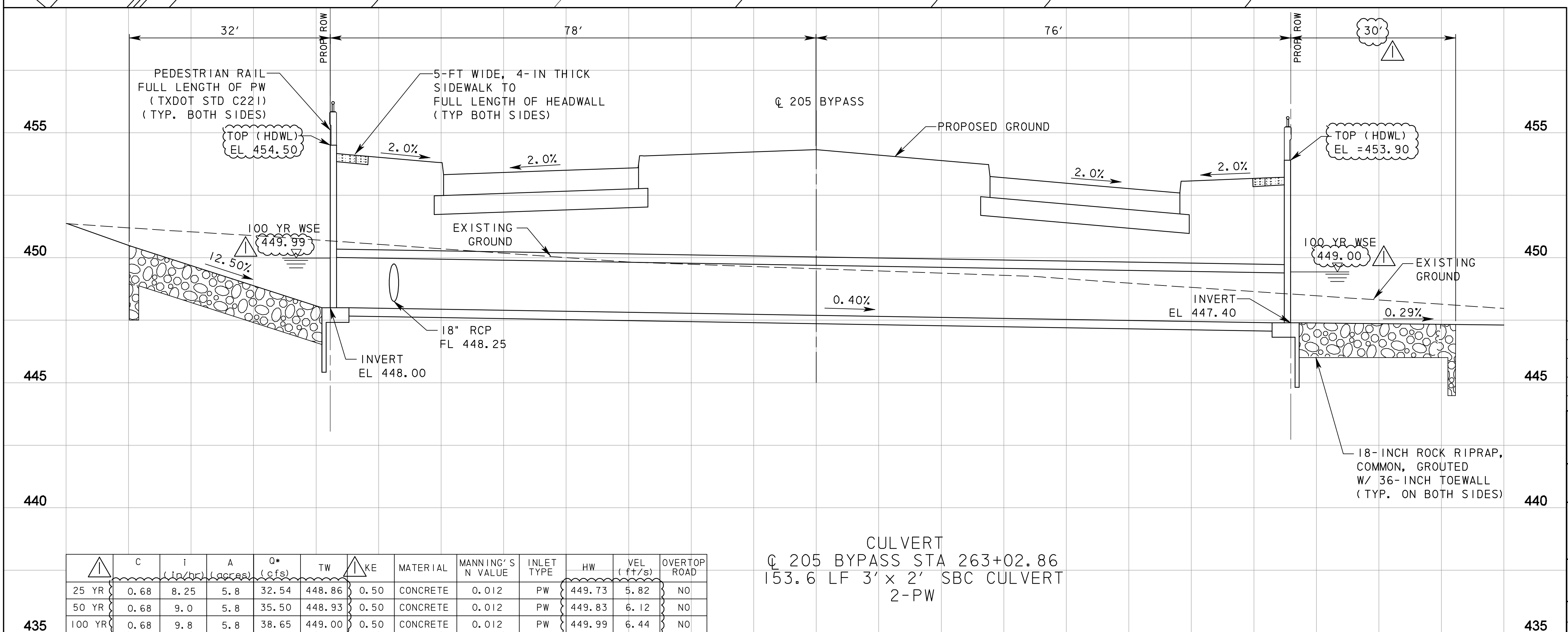
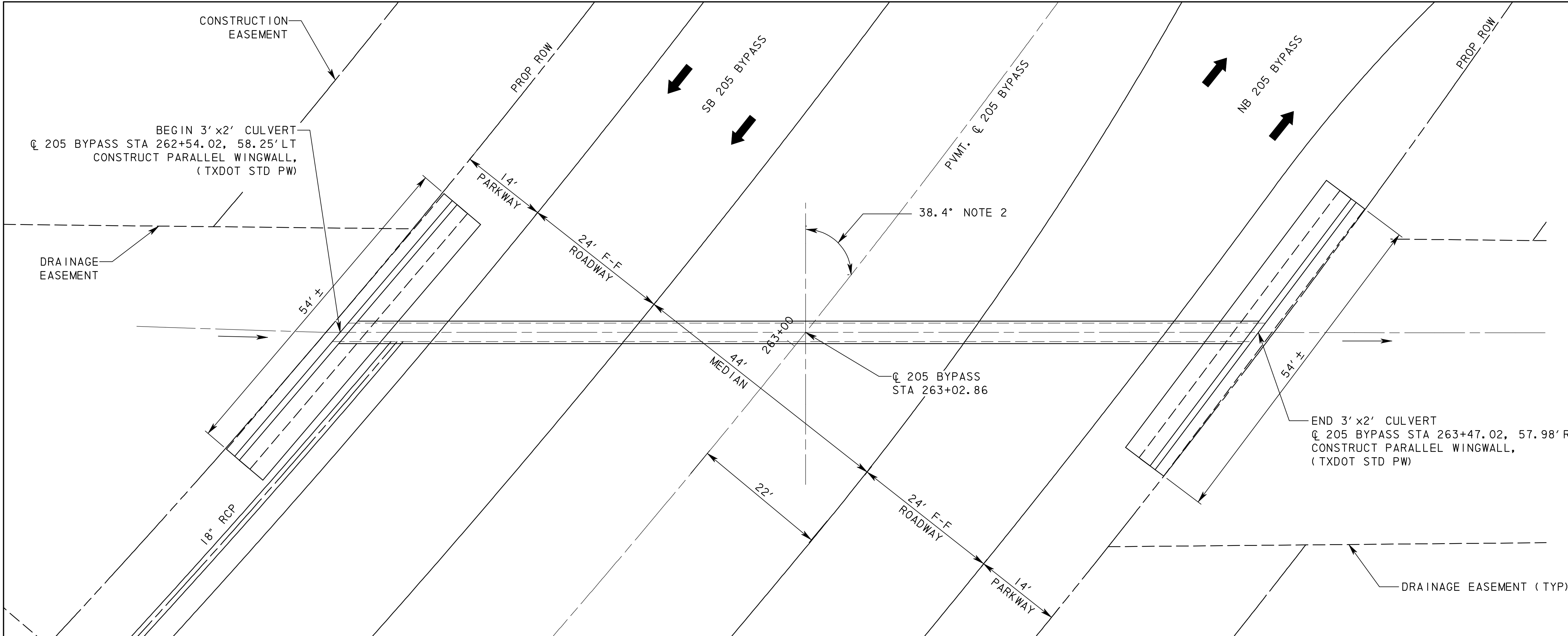

**RECORD DRAWING**  
This drawing is a compilation of the original sealed engineering drawing and modifications by addenda, change orders and information furnished by the contractor. Information shown that was provided by the contractor and others not associated with the design engineer cannot be verified for accuracy or completeness. Original sealed drawing is on file at the office of AECOM USA Group, Inc., TBPE REG. NO. F-3082

ORIGINAL DRAWING SEALED & SIGNED BY  
T.H. Gaertner, P.E.  
TX NO. 37124

NO.	REVISION	THG	DATE
I	MISC. REVISIONS	THG	10/22/07

**City of Rockwall, Texas**  
**205 BYPASS PHASE 6**  
**CULVERT PLAN & PROFILE AT STA 263+02.86**

Unit	PW-DAL-FW	Scale	Horz: AS SHOWN Vert: AS SHOWN	Date	11/24/2009
Designed	R1/US	Checked	TCB	Project No.	60004153
Drawn	FG	Approved	TCB	Sheet	86 of 216

	C	i	A	Q*	TW	KE	MATERIAL	MANNING'S N VALUE	INLET TYPE	HW	VEL (ft/s)	OVERTOP ROAD
	(ft)	(ft/hr)	(acres)	(cfs)	(ft)					(ft)		
25 YR	0.68	8.25	5.8	32.54	448.86	0.50	CONCRETE	0.012	PW	449.73	5.82	NO
50 YR	0.68	9.0	5.8	35.50	448.93	0.50	CONCRETE	0.012	PW	449.83	6.12	NO
100 YR	0.68	9.8	5.8	38.65	449.00	0.50	CONCRETE	0.012	PW	449.99	6.44	NO

CULVERT  
 C 205 BYPASS STA 263+02.86  
 153.6 LF 3' x 2' SBC CULVERT  
 2-PW

\* DISCHARGES BASED ON CITY OF ROCKWALL CRITERIA.

P:\328\60004153-205bypass\cadd\sheet6\phase 6 - fm52 to 205\record drawing 10\_7\_09\086culvert-sta 263+00.dgn  
 11/24/2009