

205 BYPASS - TYPICAL SECTION
STA. 206+58.93 TO STA. 281+25

* BETWEEN STATIONS 254+13.37 TO 256+12.67 & 273+69.91 TO 274+73.30 THE DISTANCE FROM THE FACE OF CURB TO THE ROW IS GREATER THAN 14'. WITHIN THESE LIMITS, EXTEND PARKWAY TO 14' @ 2%, THEN SLOPE TO NATURAL GROUND AT 4:1 (3:1 MAX).

NOTE: BETWEEN STATIONS 273+00 TO 281+00 THE SLOPE TO NATURAL GROUND IS AT 3:1

** BETWEEN STATIONS 251+52.98 TO 254+37.55 & 273+69.91 TO 274+67.30. THE DISTANCE FROM THE FACE OF CURB TO THE ROW IS GREATER THAN 14'. WITHIN THESE LIMITS, EXTEND PARKWAY TO 14' @ 2%, THEN SLOPE TO NATURAL GROUND AT 4:1 (3:1 MAX).

NOTE: BETWEEN STATIONS 271+00 TO 275+00 THE SLOPE TO NATURAL GROUND IS AT 3:1

*** SEE PARTIAL SECTION FOR TYPICAL RIGHT TURN AND ROW.

- (A) 9" CONTINUOUSLY REINFORCED CONCRETE PAVEMENT (5000 PSI) (STD. CRCP-03)
- (C) 8" LIME TREATED SUBGRADE
- (D) EMBANKMENT (TYPE B, DENSITY CONTROLLED)
- (E) 4" COMPOST MANUFACTURED TOPSOIL (BOS) AND CELLULOSE FIBER MULCH SEEDING
- (F) 6" TYPE II MONO-CURB (CCCG-01)

- NOTES:
1. 2% CROSS-SLOPE IS USUAL, UNLESS OTHERWISE SHOWN ON PLANS.
 2. AT HEADWALLS, CONTRACTOR TO INSTALL RAIL AND 5' SIDEWALK. SEE HEADWALL LAYOUT SHEETS FOR SIDEWALK DETAILS.
 3. CONTRACTOR TO PLACE 3' HIGH BERM IN MEDIAN, EXCEPT FOR TURN LANES. FILL FOR BERM SHALL BE IMPORTED TOP SOIL APPROVED BY ROCKWALL PARKS DEPT. AND SHALL BE MEASURED AND PAID FOR AS AN ALTERNATE BID ITEM.

RECORD DRAWING

This drawing is a compilation of the original sealed engineering drawing and modifications by addenda, change orders and information furnished by the contractor. Information shown that was provided by the contractor and others not associated with the design engineer cannot be verified for accuracy or completeness. Original sealed drawing is on file at the office of AECOM USA Group, Inc., TBPE REG. NO. F-3082

ORIGINAL DRAWING SEALED & SIGNED BY
T.H. Gaertner, P.E.
TX NO. 37124

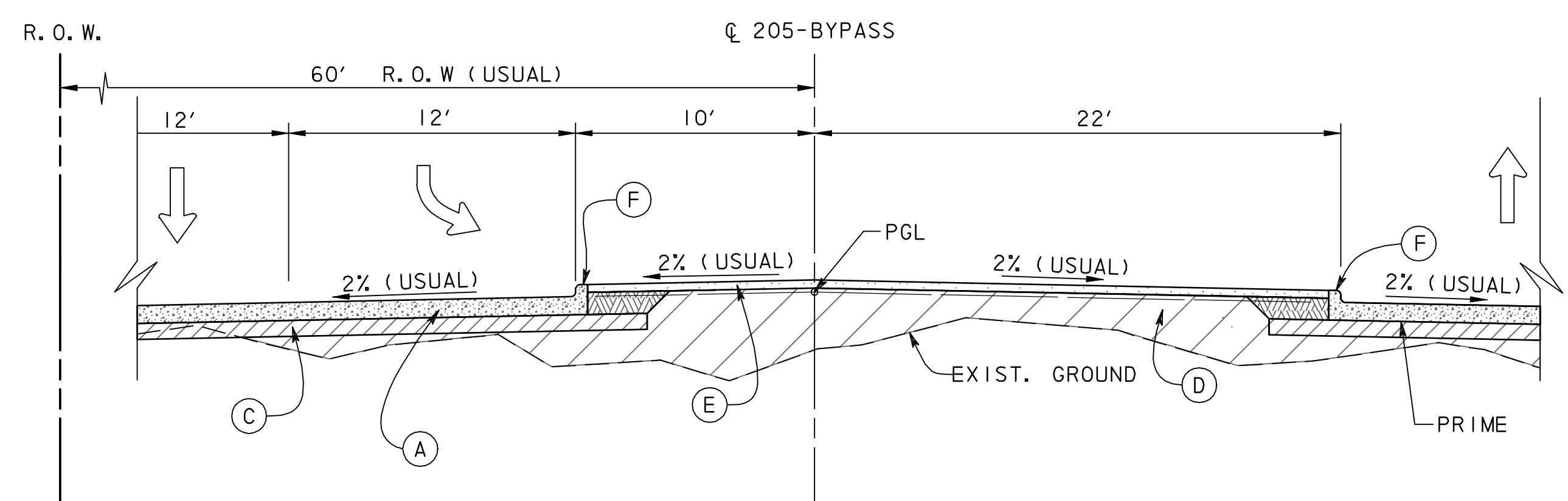

205 BYPASS - PARTIAL SECTION TYPICAL LEFT TURN
SB STA. 206+75.00 TO STA. 209+21.48
NB STA. 278+19.68 TO STA. 280+65.00

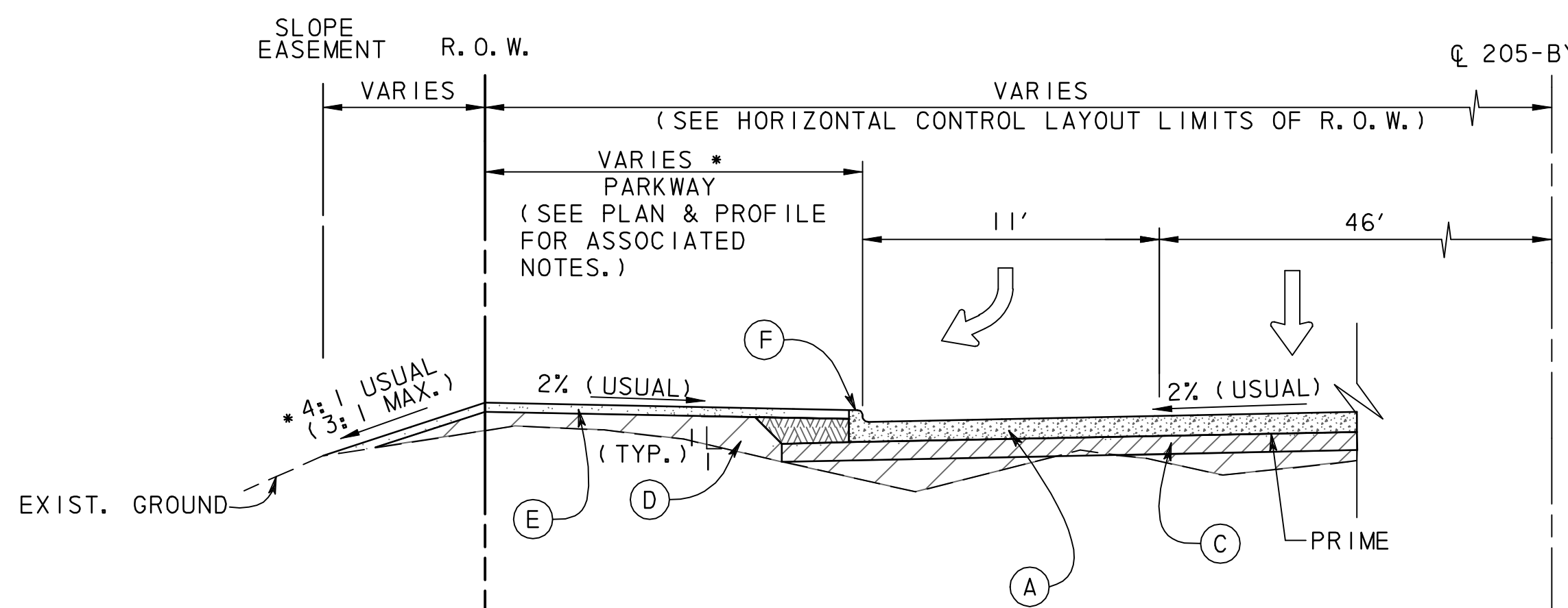

205 BYPASS - PARTIAL SECTION TYPICAL RIGHT TURN
SB STA. 206+77.20 TO STA. 209+17.48

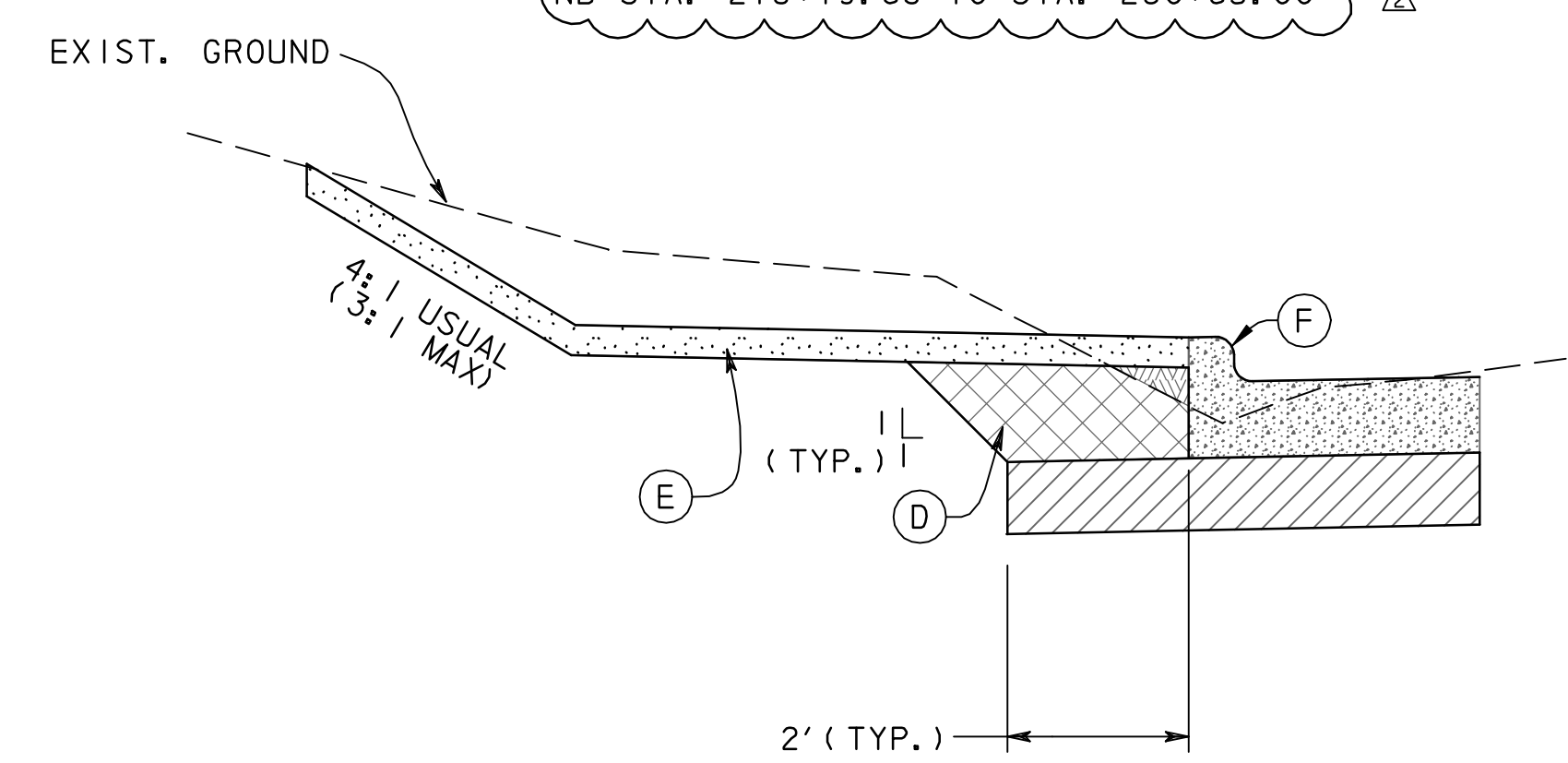

205 BYPASS - CUT TIE IN SECTION N.T.S.

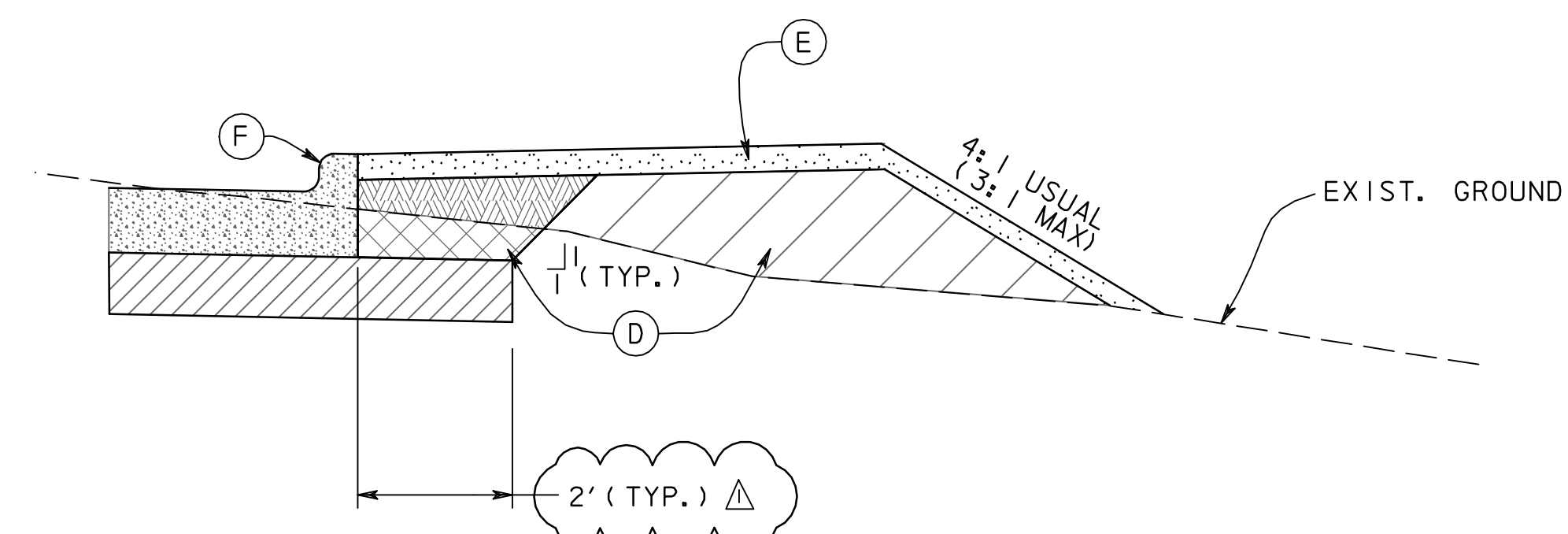

205 BYPASS - FILL TIE IN SECTION N.T.S.

| | | | |
|------------------------------------|------------|---|----------------------------------|
| MISC. REVISED | | THG | 2/11/08 |
| REVISED NOTES AND DIMENSIONS | | M. L. A. | 10/23/07 |
| NO. | REVISION | BY | DATE |
| | | | |
| 205 BYPASS PHASE 0 | | | |
| TYPICAL SECTIONS 205 BYPASS | | | |
| 1 OF 3 | | | |
| TCB AECOM | | TCB INC. WWW.TCB.AECOM.COM 17300 DALLAS PARKWAY, SUITE 1010 DALLAS, TEXAS 75248 | |
| Unit | PW-DAL-FW | Scale | Horz: AS SHOWN Vert: AS SHOWN |
| Designed | TCB | Checked | TCB |
| Drawn | TCB | Approved | TCB |
| Date | 11/24/2009 | Project No. | 60004153 |
| Sheet | 5A | of | 216 |

P:\328\60004153-205bypass\cadd\sheet\phase 6 - fms2 to 205\record drawing 10_7_09\005A\TypicalSections-ByPass-1.dgn
 11/24/2009