

NOTE:
STATION OFFSETS SHOWN ARE REFERENCED FROM QUAIL RUN ROAD CONTROL LINE, UNLESS OTHERWISE SHOWN.

LEGEND

- CONCRETE PAVEMENT
- HMAC PAVEMENT
- CURB INLET
- RECESSED CURB INLET

CURVE DATA

NO.	Δ	D	R	T	L
QRUNW-1	10° 04' 15" (LT)	7° 26' 27.6"	770'	67.85'	135.34'

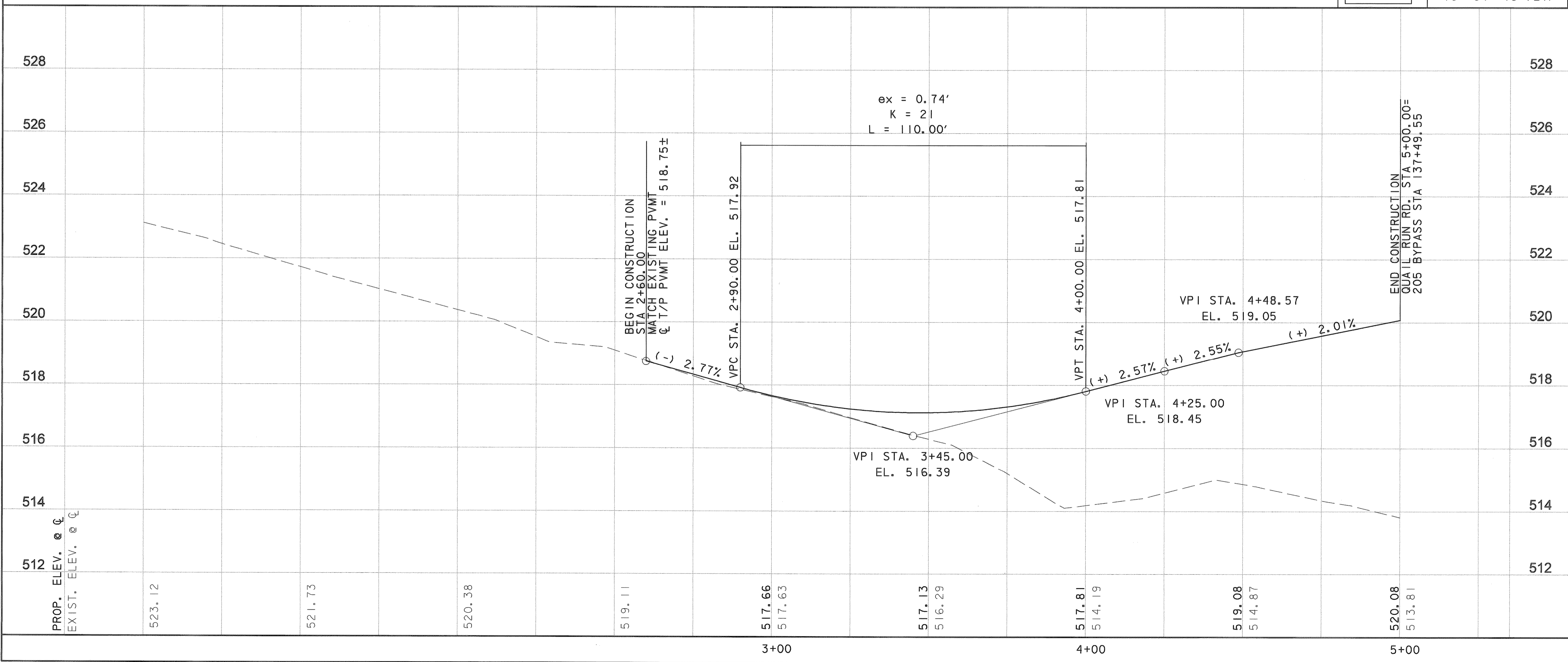

RECORD DRAWING
This drawing is a compilation of the original sealed engineering drawing and modifications by addenda, change orders and information furnished by the contractor. Information shown that was provided by the contractor and others not associated with the design engineer cannot be verified for accuracy or completeness. Original sealed drawing is on file at the office of AECOM USA Group, Inc., TBPE REG. NO. F-3082

ORIGINAL DRAWING
SEALED & SIGNED BY
T.H. Gaertner, P.E.
TX NO. 37124

NO.	REVISION	BY	DATE

City of Rockwall, Texas

**205 BYPASS
PHASE 4**

**PLAN & PROFILE
QUAIL RUN RD (WEST)**

TCB | AECOM
TCB INC.
WWW.TCB.AECOM.COM
17300 DALLAS PARKWAY, SUITE 1010
DALLAS, TEXAS 75248

Unit	PW-DAL-FW	Scale:	Horz: AS SHOWN Vert: AS SHOWN	Date	11/11/2009
Designed	THG	Checked	TCB	Project No.	60004153
Drawn	FG	Approved	TCB	Sheet	15 of 146

F:\1328\60004153-205Bypass\CADD\Sheets\Phase 4-120+00 to 141+00\Record Drawing 10-7-09\015PP-Quail Run Rd West-01.dgn 11/11/2009