

HORIZONTAL CURVE DATA

[205_S2A-5]	[205_S2A-6]
Q 205 BYPASS	Q 205 BYPASS
PI STA. 131+25.90	PI STA. 136+41.05
$\Delta = 17^{\circ}02'45.09''$ (LT)	$\Delta = 25^{\circ}14'50.15''$ (RT)
D = 5°12'31.35"	D = 3°38'16.18"
T = 164.85'	T = 352.74'
L = 327.26'	L = 694.02'
R = 1,100.00'	R = 1,575.00'
PC STA. 129+61.06	PC STA. 132+88.31
PRC STA. 132+88.31	PT STA. 139+82.33

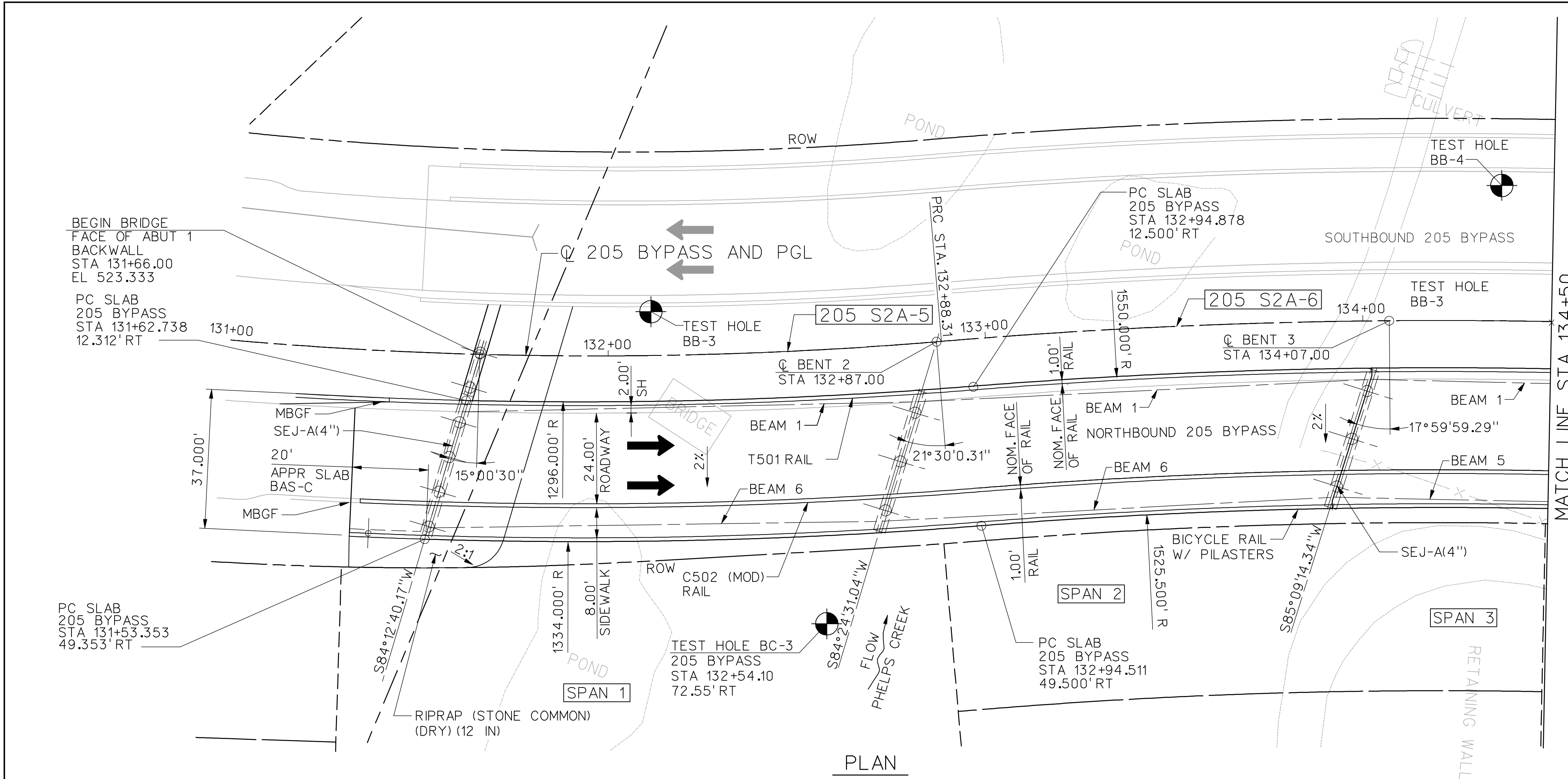

- NOTES:
- DESIGN SPEED: 45 MPH
 - FUNCTIONAL CLASS: RURAL HIGHWAY
 - CONTRACTOR SHALL VERIFY LOCATION & STATUS OF EACH UTILITY PRIOR TO CONSTRUCTION.
 - DESIGNED ACCORDING TO AASHTO LRFD DESIGN SPECIFICATIONS & CURRENT INTERIMS. HL 93 LOADING.
 - DESIGN LOADS INCLUDE PROVISIONS FOR 2" FUTURE OVERLAY.
 - WHERE C502 RAIL IS SPECIFIED, USE C502 (MOD) RAIL.
 - NBI#: NEW LOCATION

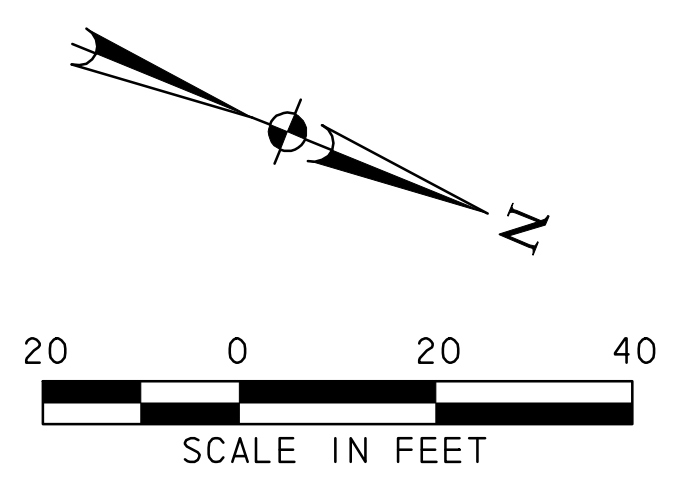
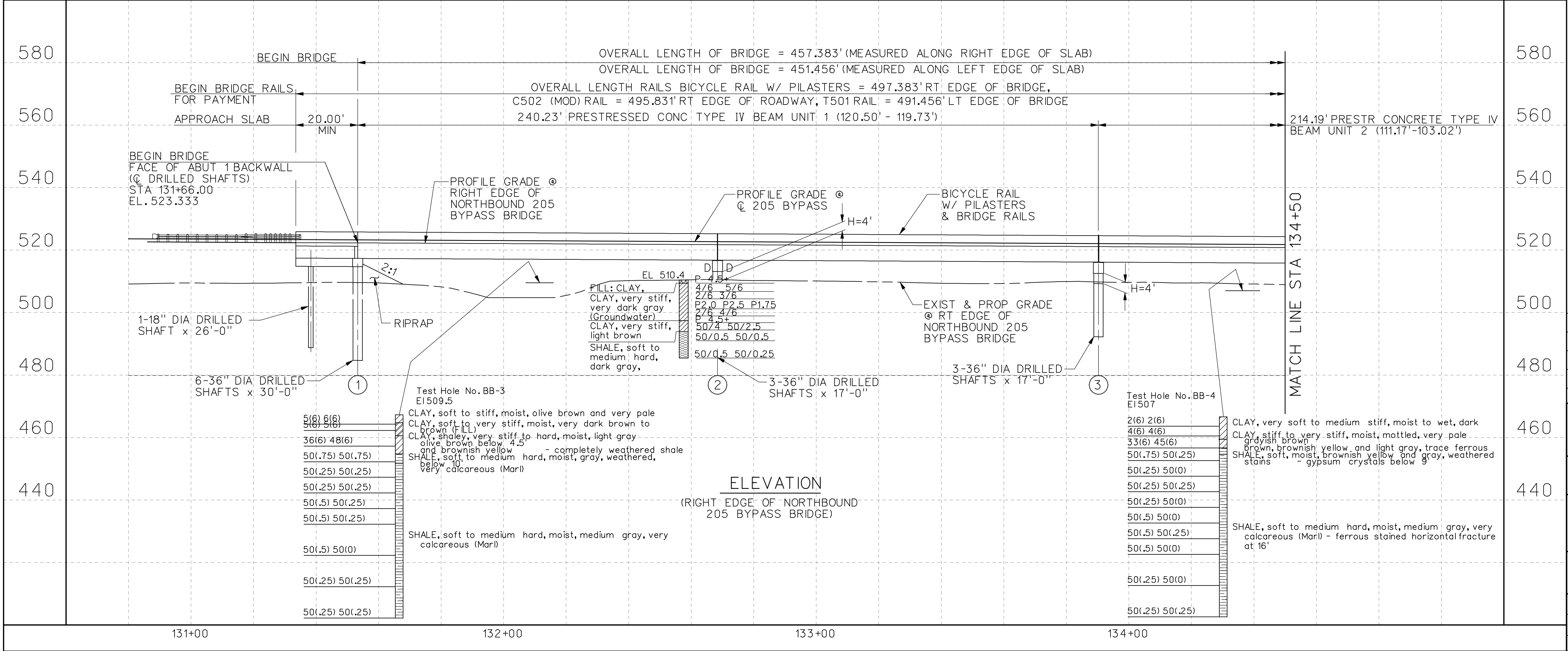

RECORD DRAWING

This drawing is a compilation of the original sealed engineering drawing and modifications by addenda, change orders and information furnished by the contractor. Information shown that was provided by the contractor and others not associated with the design engineer cannot be verified for accuracy or completeness. Original sealed drawing is on file at the office of AECOM USA Group, Inc., TBPE REG. NO. F-3082

ORIGINAL DRAWING SEALED & SIGNED BY
 Wally R. Burns, P.E.
 TX NO. 44162

NO.	REVISION	BY	DATE
<p>City of Rockwall, Texas</p> <p>205 BYPASS PHASE 4</p> <p>NORTHBOUND 205 BYPASS BRIDGE OVER PHELPS CREEK BRIDGE LAYOUT</p> <p style="text-align: right;">1 OF 2</p>			
<p>TCB AECOM</p> <p>TCB INC. WWW.TCB.AECOM.COM 17300 DALLAS PARKWAY, SUITE 1010 DALLAS, TEXAS 75248</p>			
Unit	PW-DAL-FW	Scale	Horz: AS SHOWN Vert: AS SHOWN
Designed	SDH	Checked	Date 11/23/2009
Drawn	Approved	Project No.	60004153
		Sheet	89 of 146

P:\328\60004153-205bypass\cadd\sheets\phase 4-120-00 to 141+00\record drawing 10_7_09\089_205BP-BR-NB-BL01.dgn
 11/23/2009