

LEGEND

- RIGHT-OF-WAY
- DRAINAGE EASEMENT
- TEMP. CONSTRUCTION EASEMENT
- 205 BYPASS PAVING

UNDERGROUND UTILITIES

THE LOCATION OF EXISTING UTILITIES SHOWN ON THESE PLANS ARE APPROXIMATE AND BASED ON DATA FURNISHED BY THE CITY OF ROCKWALL. IT IS THE RESPONSIBILITY OF THE CONTRACTOR TO LOCATE AND VERIFY ON-SITE THE UTILITIES THAT MAY CONFLICT WITH THE CONSTRUCTION.

NOTES:

1. AN ATMOS REPRESENTATIVE MUST BE PRESENT WHEN CROSSING THE GAS LINE. CONTACT ATMOS REPRESENTATIVE, KIP BROCKAWAY OR KORUIN VARTEVAN, PRIOR TO ANY EXCAVATION AT (469) 261-2323 OR (214) 206-2720.

RECORD DRAWING

This drawing is a compilation of the original sealed engineering drawing and modifications by addenda, change orders and information furnished by the contractor. Information shown that was provided by the contractor and others not associated with the design engineer cannot be verified for accuracy or completeness. Original sealed drawing is on file at the office of AECOM USA Group, Inc., TBPE REG. NO. F-3082

ORIGINAL DRAWING
SEALED & SIGNED BY
Nicholas R. Batker, P.E.
TX NO. 92749

1	REVISED GAS LINE DATA	NRB	08/01/08
NO.	REVISION	BY	DATE

City of Rockwall, Texas

**205 BYPASS
PHASE 4**

**30" FORCE MAIN
PLAN & PROFILE**

STA 13+50 TO 18+00

4 OF 5

TCB AECOM		TCB INC. WWW.TCB.AECOM.COM 17300 DALLAS PARKWAY, SUITE 1010 DALLAS, TEXAS 75248	
Unit PW-DAL-FW	Scale Horiz: 1:40 Vert: 1:10	Date 11/23/2009	
Designed JLT/SDB	Checked NRB	Project No. 60023784	
Drawn TCB	Approved NRB	Sheet 48 of 146	

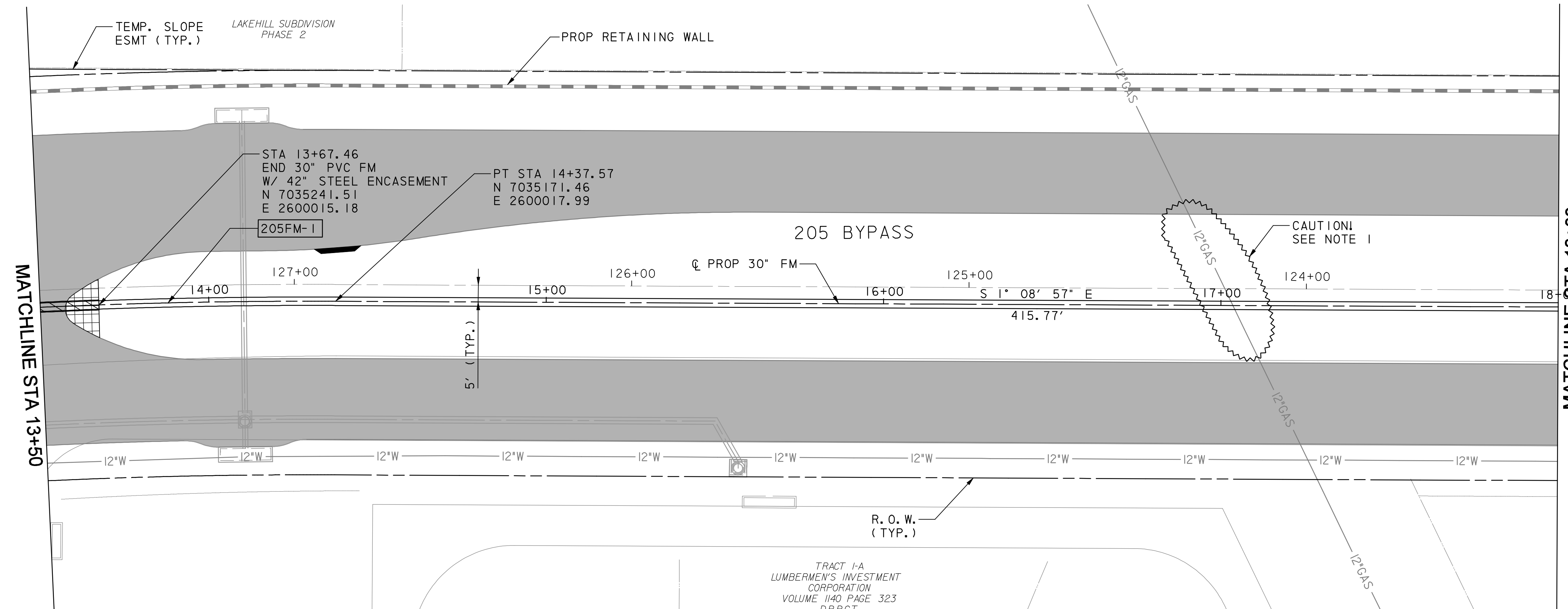

CURVE DATA

NO.	Δ	D	R	T	L
205FM-1	08° 29' 58.70" (RT)	03° 17' 24.09"	1,741.50'	129.41'	258.35'

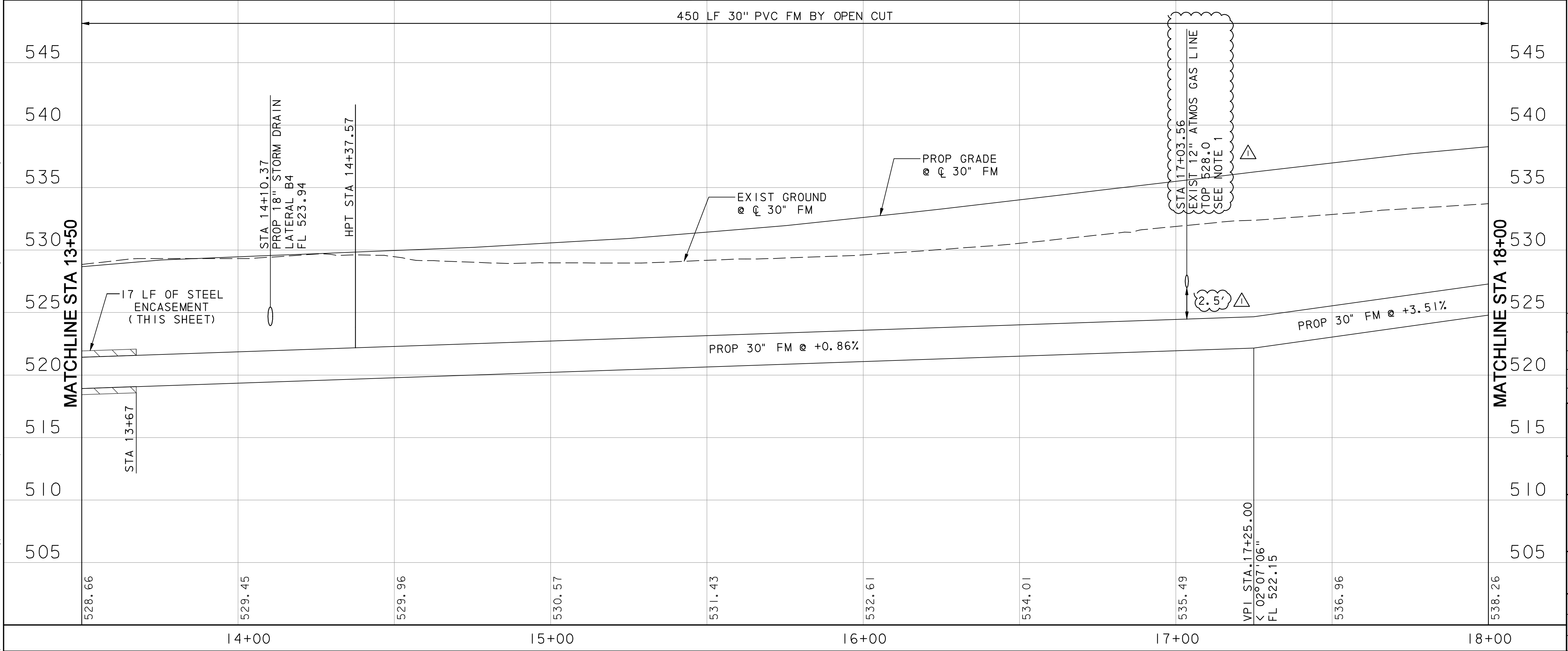

11/23/2009 4:26:52 PM
P:\4328\60004153-205bypass\cadd\sheet\phase 4-120+00 To 141+00\record draw\ng 10-7-09\04R\04.dgn