

STREET HEADER FOR FUTURE PAVEMENT
 N. T. S

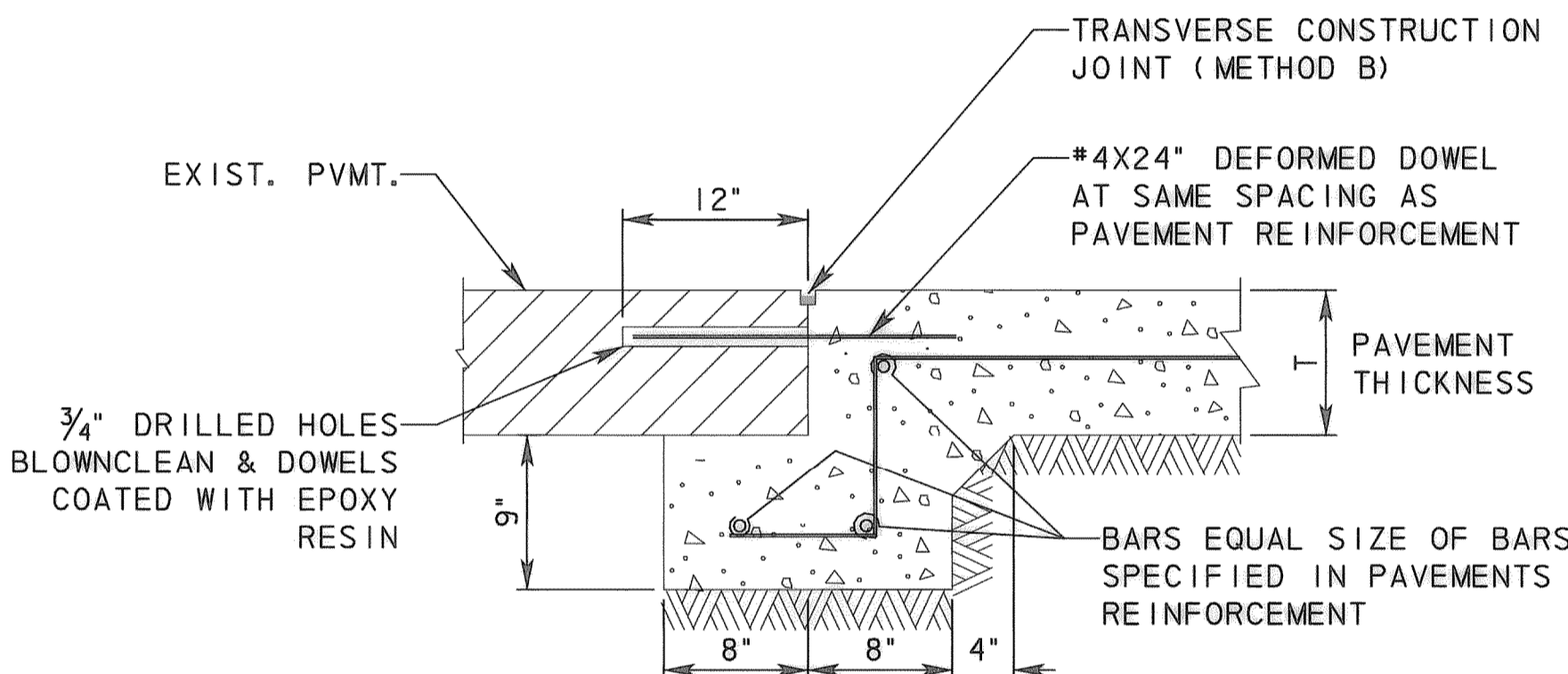

STREET HEADER AT EXISTING PAVEMENT TIE-IN
 N. T. S

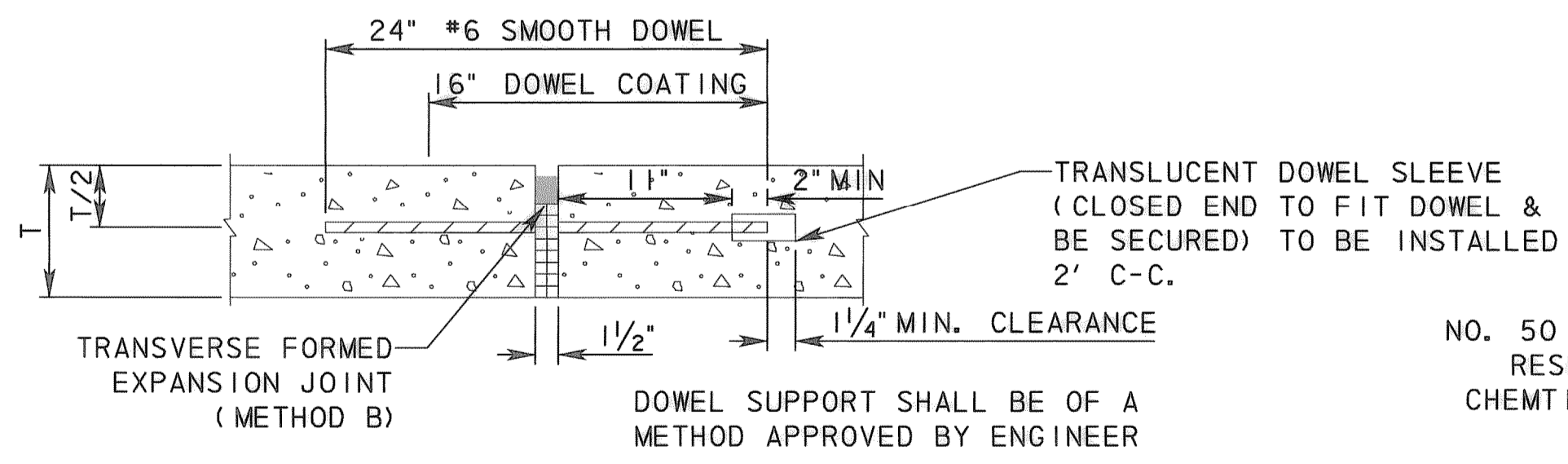

EXPANSION JOINT
 N. T. S

NOTE:
 SEE DETAIL SHEET JS-94 FOR JOINT SEAL DETAIL

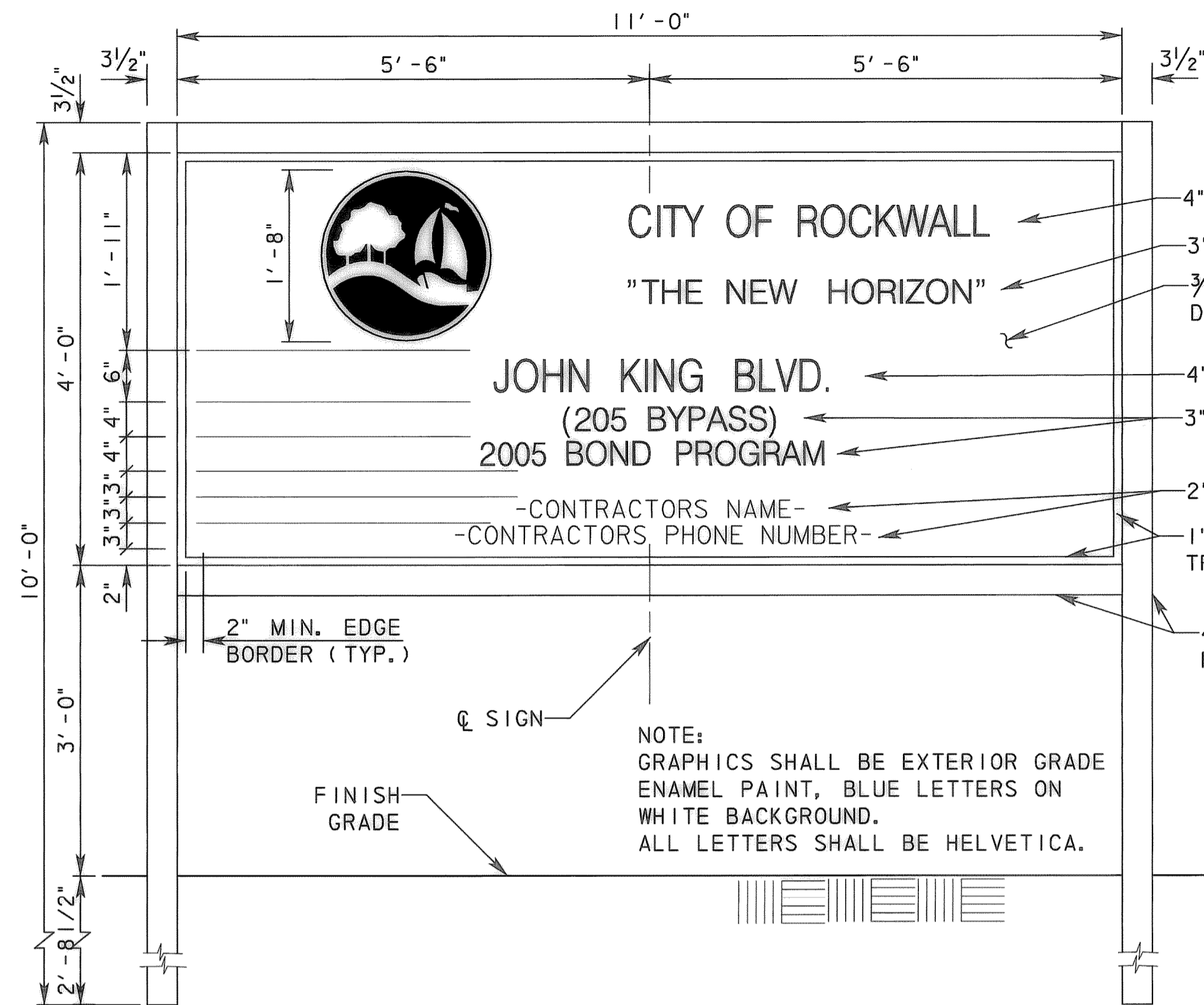

FRONT ELEVATION

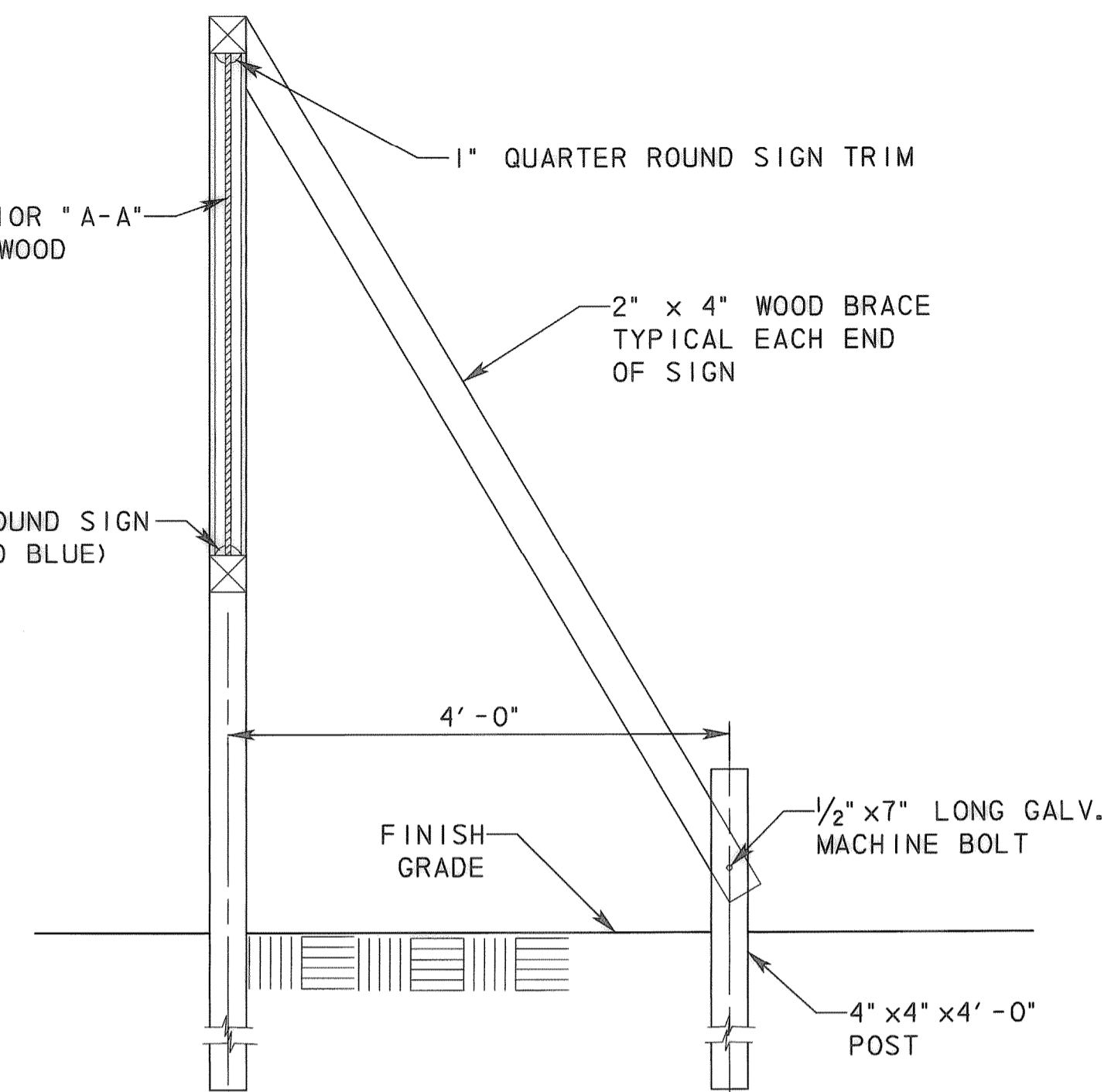

SIDE ELEVATION

PROJECT SIGN DETAILS
 N. T. S

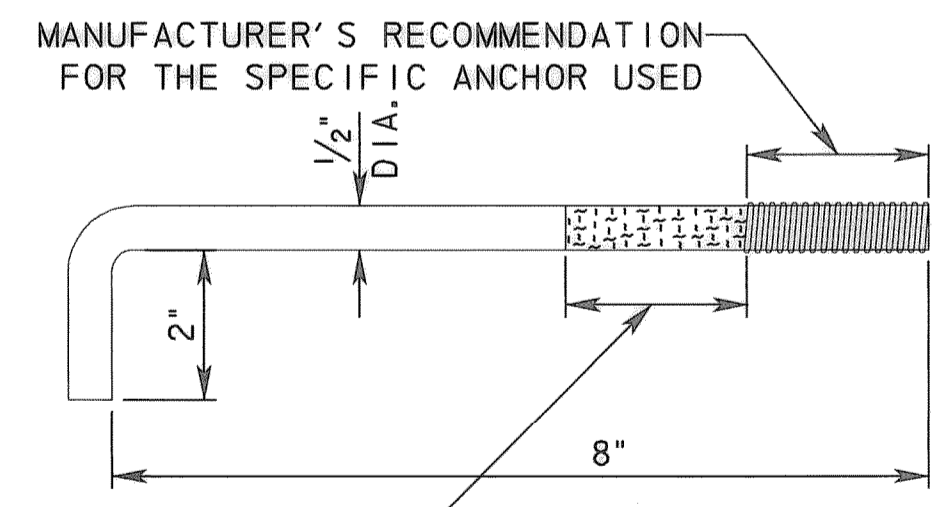
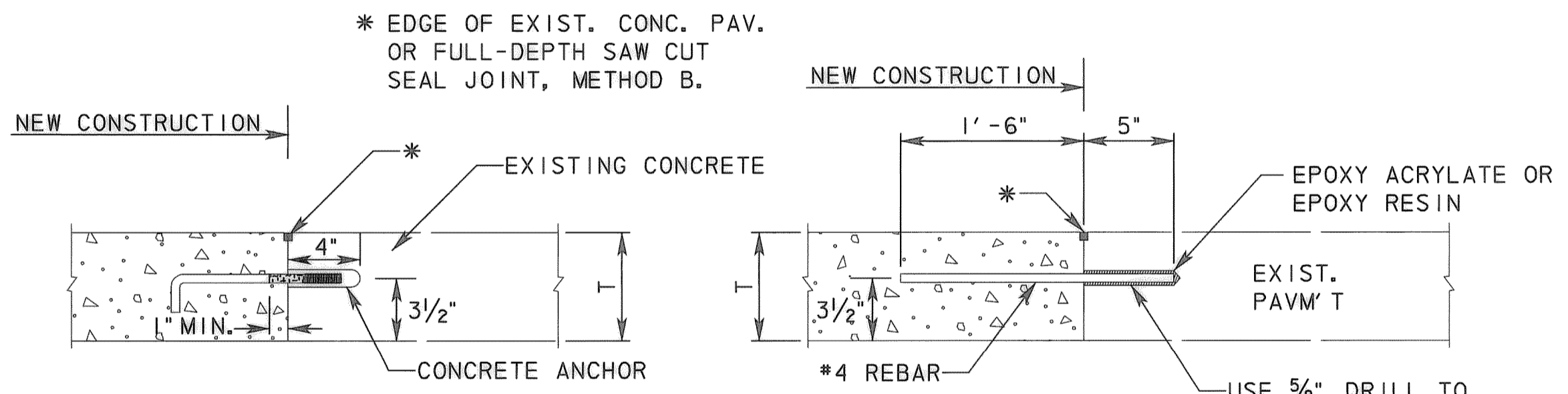

HOOK TIE BOLT

TIE TO EXIST. CONC. PAVEMENT (LONGITUDINAL JOINTS)
 KOPPERS BITUMASTIC NO. 50 COATING OR PRODUCTS RESEARCH SERVICES, INC. CHEMTITE COATING OR EQUAL

LONGITUDINAL JOINT DETAILS AT EXISTING PAVEMENT TIE-IN

TIE BAR

1. EITHER THE HOOK TIE BOLT OR THE TIE BAR MAY BE USED TO PROVIDE LOAD TRANSFER FOR LONGITUDINAL JOINTS.
2. THE SPACING FOR EITHER TIE BARS OR HOOK TIE BARS BOTH IS 24' C-C.
3. SEE JS-94, METHOD "B" FOR JOINT SEALING DETAILS.
4. THIS DETAIL DOES NOT APPLY TO EXTENSION OF NEW CONSTRUCTION, STAGED CONSTRUCTION, OR BLOCKOUTS (SEE CPR STANDARDS).

RECORD DRAWING
 This drawing is a compilation of the original sealed engineering drawing and modifications by addenda, change orders and information furnished by the contractor. Information shown that was provided by the contractor and others not associated with the design engineer cannot be verified for accuracy or completeness. Original sealed drawing is on file at the office of AECOM USA Group, Inc., TBPE REG. NO. F-3082

ORIGINAL DRAWING SEALED & SIGNED BY
 T.H. Gaertner, P.E.
 TX NO. 37124

NO.	REVISION	BY	DATE
205 BYPASS PHASE 4			
MISC. ROADWAY DETAILS			
1 OF 2			
		TCB INC. WWW.TCB.AECOM.COM 17300 DALLAS PARKWAY, SUITE 1010 DALLAS, TEXAS 75248	
Unit	PW-DAL-FW	Scale	Horz: AS SHOWN Vert: AS SHOWN
Designed	THG	Checked	TCB
Drawn	FG	Approved	TCB
Date	11/11/2009	Project No.	60004153
Sheet	21	of	146

P:\4328\60004153-205Bypass\CADD\Sheets\Phase 4-120\00 to 141-00\Record Drawing 10-7-09\02.rvt.dwg
 MISC-Roadway\Detail\1501.dgn
 11/11/2009