

BENCHMARKS		MONUMENT DATA (GRID, COORDINATES)			
ID#	TYPE	ELEV	N	E	DESCRIPTION
RO01	CITY OF ROCKWALL	567.704	7011544.25	2590135.16	MONUMENT IS LOCATED WEST OF THE SUMMER LEE AND FM 740 INTERSECTION. IN BETWEEN SUMMER LEE ROAD AND THE NORTH WEST CORNER OF THE BANK PARKING LOT.
RO02	CITY OF ROCKWALL	609.394	7024007.53	2607194.15	MONUMENT IS LOCATED IN THE NORTH WESTERN CORNER OF FM 549 AND IH 30, 6.2 FEET WEST OF GUARD POST AND 8.4 FEET S 40° W OF GUARD POST.
RO03	CITY OF ROCKWALL	529.226	7029731.09	2598589.35	MONUMENT IS LOCATED IN J. W. WILLIAMS MIDDLE SCHOOL PARKING LOT ISLAND, 53.5 FEET S 70° W OF POWER POLE AND 4.20 FEET N 10° W OF METAL SIGN POLE. MONUMENT IS SET IN LINE WITH SIGN POLES.
RO16	CITY OF ROCKWALL	558.719	7025942.54	2601204.03	MONUMENT IS LOCATED 97 FEET SOUTH OF THE APPROX CENTERLINE OF AIRPORT ROAD AND 42 FEET EAST OF WEST PARKING LOT CURB AND 68 FEET SOUTHWEST OF SIGN.
DI990011	TXDOT	558.981	7014471.49	2589892.73	MONUMENT IS LOCATED AT THE SOUTHWEST QUADRANT OF HORIZON ROAD AND IH 30.
DI990021	TXDOT	582.61	7028775.54	2618438.53	MONUMENT IS LOCATED AT THE SOUTHWEST QUADRANT OF FM 551 AND IH 30.

NOTE:
REFER TO HORIZONTAL LAYOUT PLANS FOR ADDITIONAL INFORMATION.

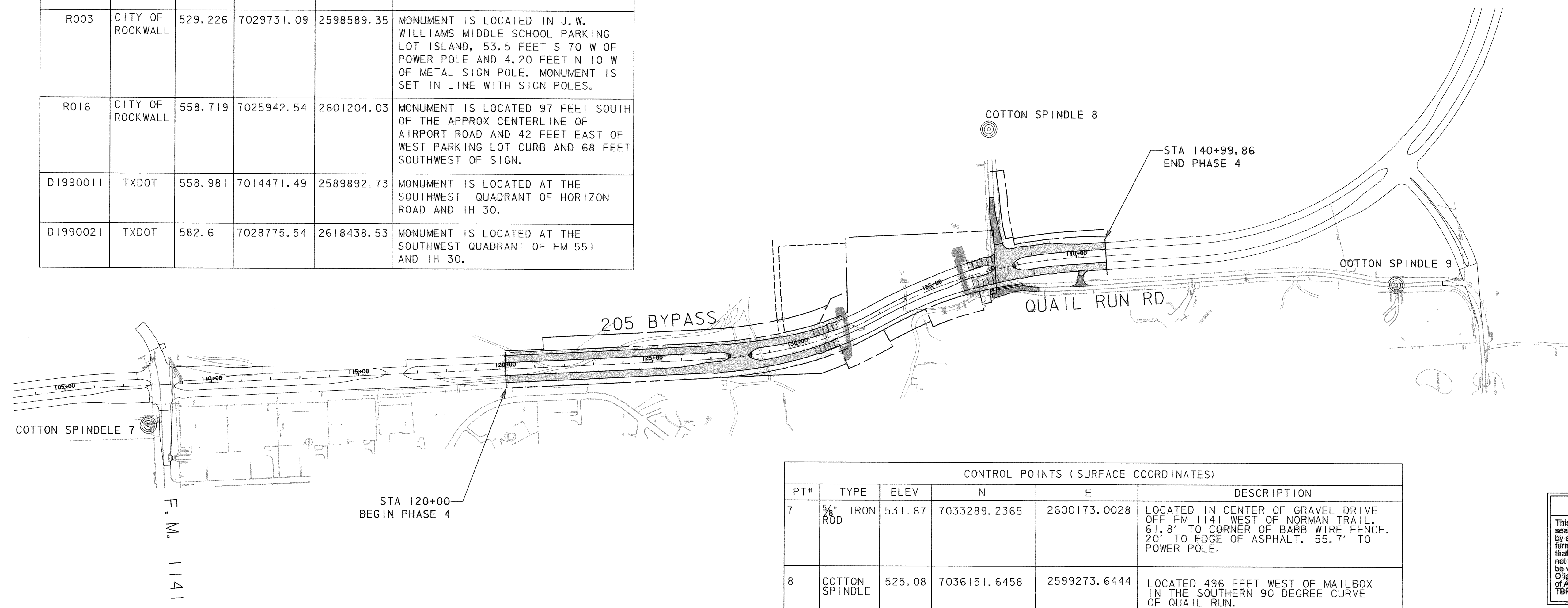

CONTROL POINTS (SURFACE COORDINATES)					
PT#	TYPE	ELEV	N	E	DESCRIPTION
7	5/8" IRON ROD	531.67	7033289.2365	2600173.0028	LOCATED IN CENTER OF GRAVEL DRIVE OFF FM 1141 WEST OF NORMAN TRAIL, 61.8' TO CORNER OF BARB WIRE FENCE, 20' TO EDGE OF ASPHALT, 55.7' TO POWER POLE.
8	COTTON SPINDLE	525.08	7036151.6458	2599273.6444	LOCATED 496 FEET WEST OF MAILBOX IN THE SOUTHERN 90 DEGREE CURVE OF QUAIL RUN.
9	COTTON SPINDLE	535.15	7037519.7167	2599846.1660	LOCATED AT THE NORTHERN 90 DEGREE CURVE OF QUAIL RUN ROAD. SPINDLE IS IN THE INTERSECTION OF QUAIL RUN ROAD AND GRAVEL DRIVEWAY.

RECORD DRAWING
This drawing is a compilation of the original sealed engineering drawing and modifications by addenda, change orders and information furnished by the contractor. Information shown that was provided by the contractor and others not associated with the design engineer cannot be verified for accuracy or completeness. Original sealed drawing is on file at the office of AECOM USA Group, Inc., TBPE REG. NO. F-3082

ORIGINAL DRAWING SEALED & SIGNED BY
T.H. Gaertner, P.E.
TX NO. 37124

NO.	REVISION	BY	DATE

City of Rockwall, Texas

205 BYPASS
PHASE 4

PROJECT LAYOUT & CONTROL POINTS

TCB | AECOM
TCB INC
WWW.TCB.AECOM.COM
17300 DALLAS PARKWAY, SUITE 1010
DALLAS, TEXAS 75248

Unit	PW-DAL-FW	Scale	Horz: AS SHOWN Vert: AS SHOWN	Date	11/11/2009
Designed	THG	Checked	TCB	Project No.	60004153
Drawn	FG	Approved	TCB	Sheet	3 of 146

P:\3328\60004153-205Bypass\CADD\Sheets\Phase 4-1\20-00 to 141+00\Record Drawing 10-7-09\03Control-Points.dgn 11/11/2009