

**LEGEND**

- RIGHT-OF-WAY
- DRAINAGE EASEMENT
- TEMP. CONSTRUCTION EASEMENT
- 205 BYPASS PAVING

**UNDERGROUND UTILITIES**

THE LOCATION OF EXISTING UTILITIES SHOWN ON THESE PLANS ARE APPROXIMATE AND BASED ON DATA FURNISHED BY THE CITY OF ROCKWALL. IT IS THE RESPONSIBILITY OF THE CONTRACTOR TO LOCATE AND VERIFY ON-SITE THE UTILITIES THAT MAY CONFLICT WITH THE CONSTRUCTION.

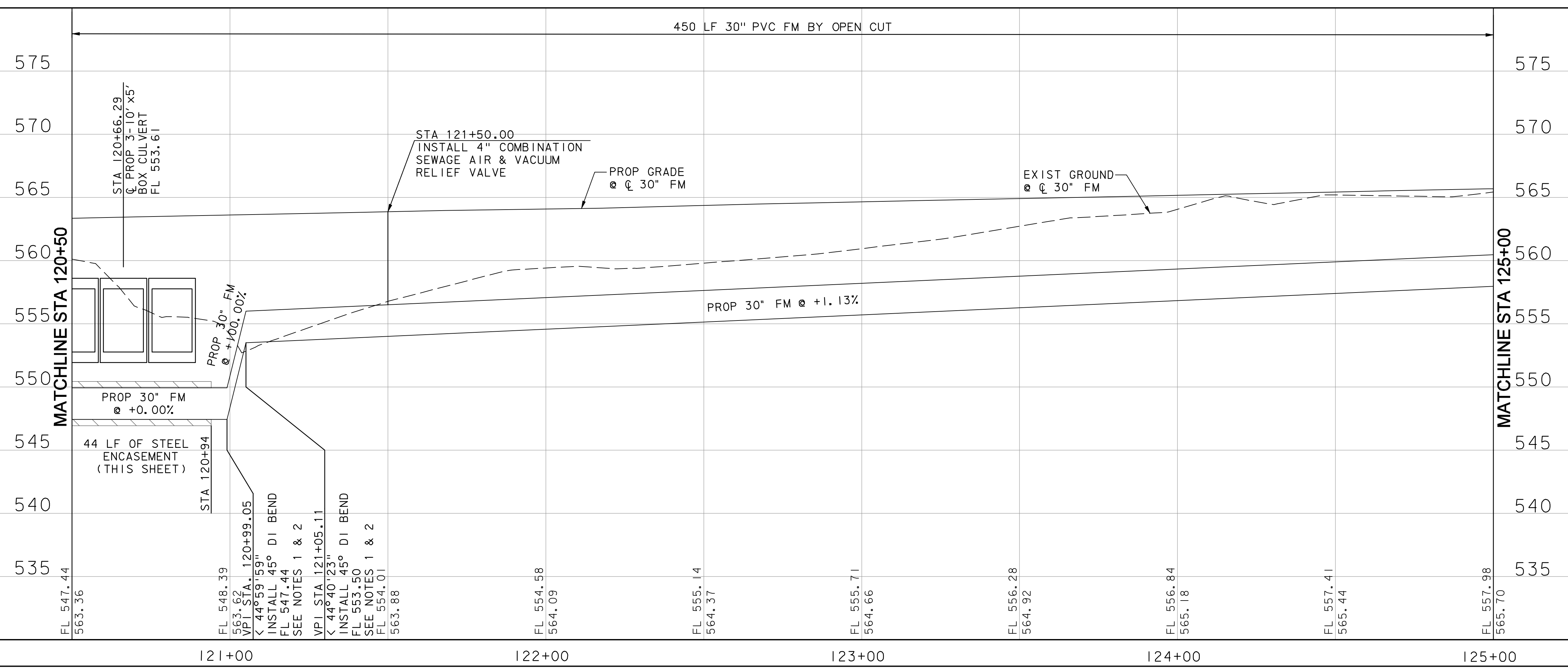
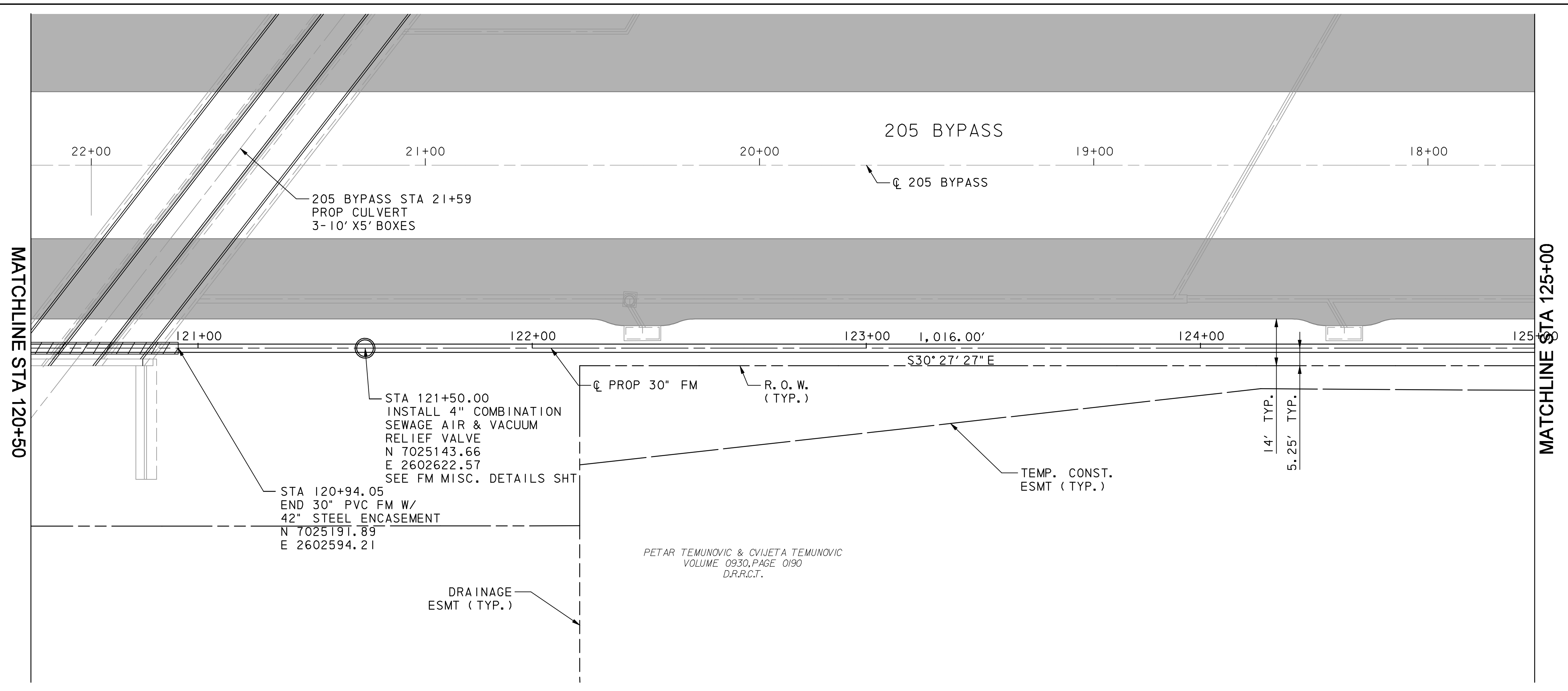

- NOTES:**
- INSTALL HORIZONTAL AND VERTICAL THRUST BLOCKING AND MECHANICAL JOINT RESTRAINT AT ALL DUCTILE IRON FITTINGS.
  - INSTALL POLYETHYLENE WRAP AROUND BURIED DUCTILE IRON FITTINGS.

**RECORD DRAWING**

This drawing is a compilation of the original sealed engineering drawing and modifications by addenda, change orders and information furnished by the contractor. Information shown that was provided by the contractor and others not associated with the design engineer cannot be verified for accuracy or completeness. Original sealed drawing is on file at the office of AECOM USA Group, Inc., TBPE REG. NO. F-3082

**ORIGINAL DRAWING SEALED & SIGNED BY**

Nicholas R. Batker, P.E.  
TX NO. 92749

NO.	REVISION	BY	DATE

**City of Rockwall, Texas**

**205 BYPASS  
PHASE 3**

**30" FORCE MAIN  
PLAN & PROFILE  
STA 120+50 TO 125+00** 15 OF 18

**TCB | AECOM**

TCB INC. WWW.TCB.AECOM.COM  
17300 DALLAS PARKWAY, SUITE 1010  
DALLAS, TEXAS 75248

Unit: PW-DAL-FW	Scale: Horiz: 1:40 Vert: 1:10	Date: 11/23/2009
Designed: JLT/SDB	Checked: NRB	Project No: 60023784
Drawn: TCB	Approved: NRB	Sheet: 143 of 215

11/23/2009 3:30:56 PM \\usdell1p001\pww\4328\60004153-205Bypass\CAD\Drawings\Phase 3 - 1 30 to Station SH 66\Record Drawing 10-7-09\143P&P15.dgn