

LEGEND

- PROPOSED ROW
- ==== PROPOSED STORM DRAIN
- - - - DRAINAGE EASEMENT
- - - - TEMP. CONST. EASEMENT

RECORD DRAWING

This drawing is a compilation of the original sealed engineering drawing and modifications by addenda, change orders and information furnished by the contractor. Information shown that was provided by the contractor and others not associated with the design engineer cannot be verified for accuracy or completeness. Original sealed drawing is on file at the office of AECOM USA Group, Inc., TBPE REG. NO. F-3082

ORIGINAL DRAWING SEALED & SIGNED BY
T.H. Gaertner, P.E.
TX NO. 37124

NO.	REVISION	BY	DATE
2	GRADING DETAIL	THG	10/22/08
1	MISCELLANEOUS	THG	5/20/08



205 BYPASS PHASE 3

STORM PLAN STA. 80+00 TO STA. 83+00

TCB AECOM
TCB INC. WWW.TCB.AECOM.COM
17300 DALLAS PARKWAY, SUITE 1010
DALLAS, TEXAS 75248

Unit	PW-DAL-FW	Scale	Horz: AS SHOWN Vert: AS SHOWN	Date	11/23/2009
Designed	SDB	Checked	TCB	Project No.	60004153
Drawn	FG	Approved	TCB	Sheet	89 of 215

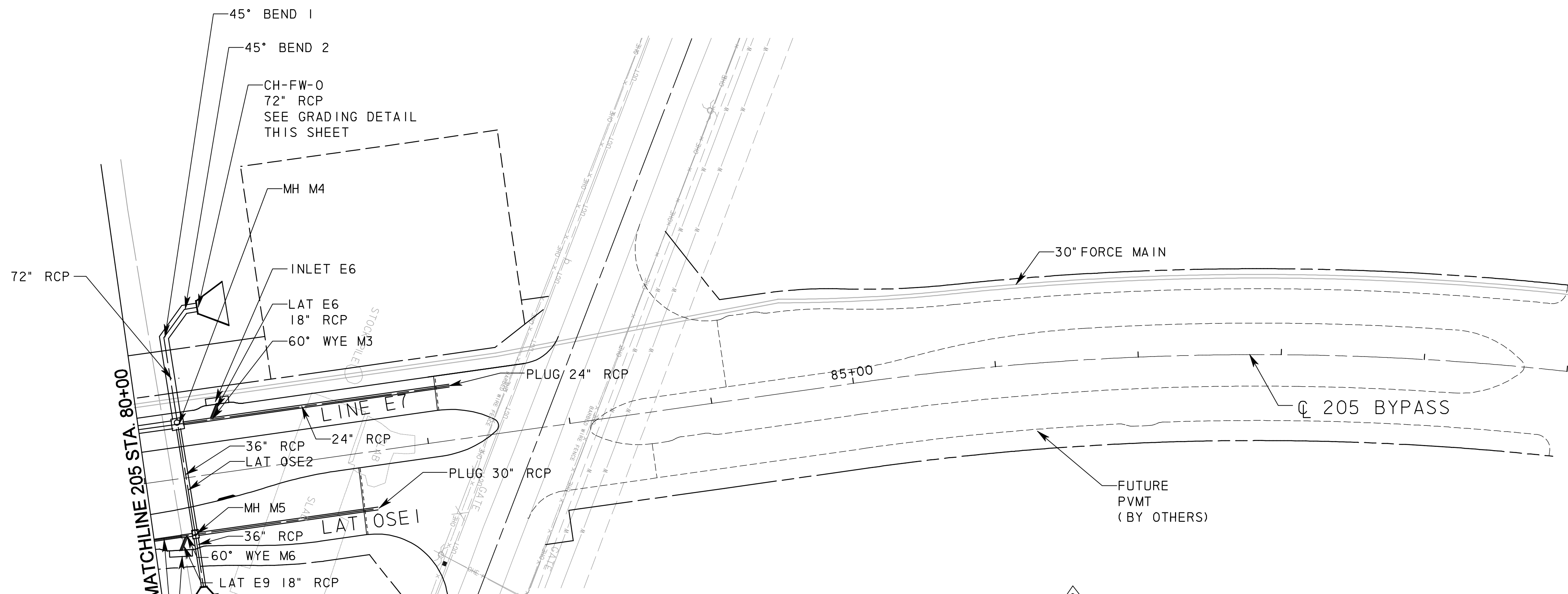

GRADING DETAIL

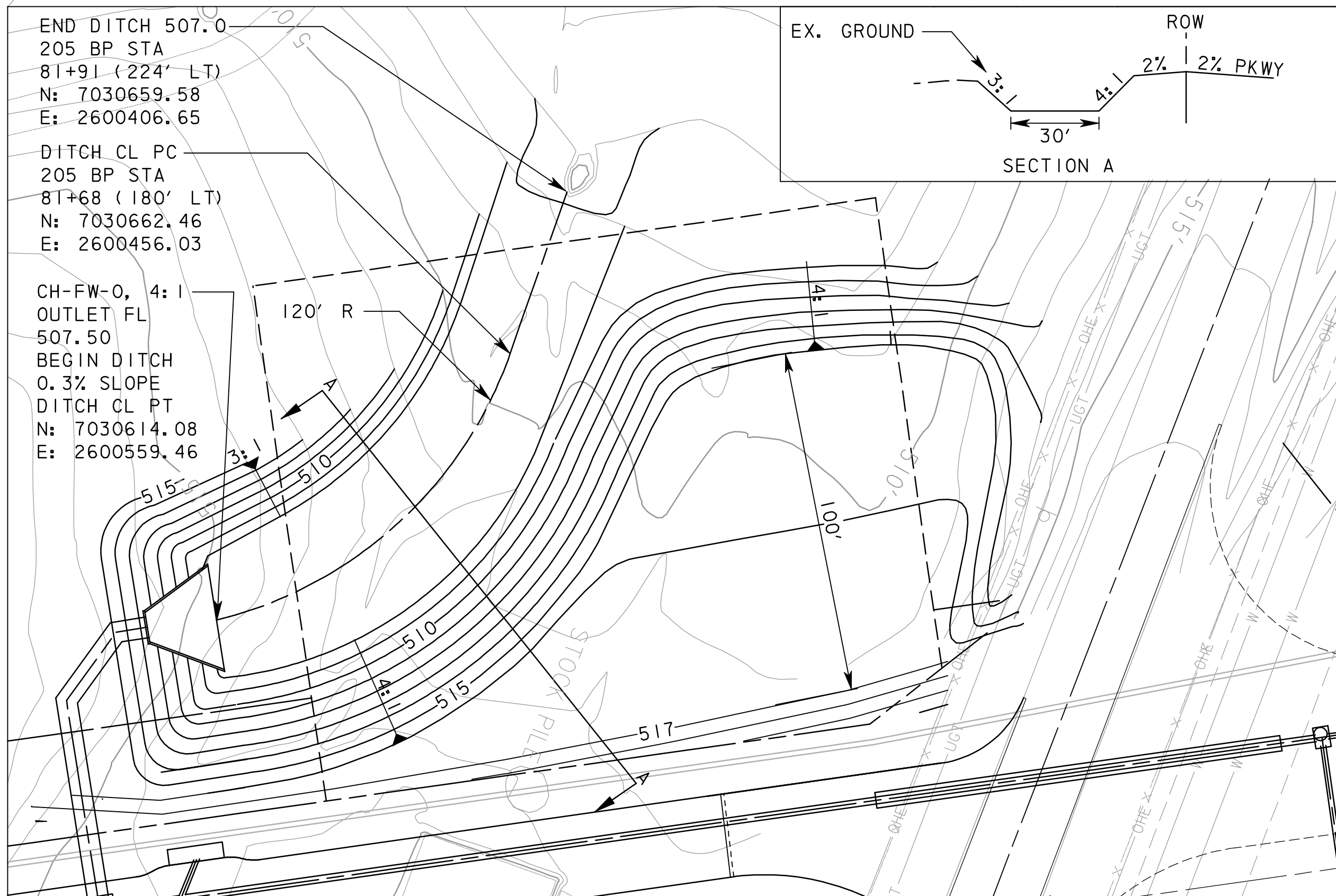

\\usdell1\p001\pww\4328\60004153-205bypass\cadd\sheet\phase 3 - 1 30 to start\on sh 66\record drawing 10_7_09\0895storm.p lan-09.dgn
 11/23/2009