

LEGEND

- PROPOSED ROW
- PROPOSED DITCH LINE
- - - - - DRAINAGE EASEMENT
- - - - - TEMP SLOPE EASEMENT

NOTES:

1. SEE PREVIOUS DITCH LAYOUT SHEET FOR DITCH RSEI HYDRAULIC DATA TABLES.
2. USE IMPORTED TOP SOIL WITHIN THE ROW AND ON EARTHEN CHANNEL SLOPES. USE TOP SOIL FROM THE PROJECT SITE FOR ALL OTHER AREAS OUTSIDE OF ROW. THE IMPORTED TOP SOIL SHALL MEET THE REQUIREMENTS OF C. O. G. SPEC 3.8.1 AND BE A CLAY SILT OR SILTY CLAY TYPE SOIL MEETING THE APPROVAL OF THE CITY FOR USE ON THIS PROJECT.

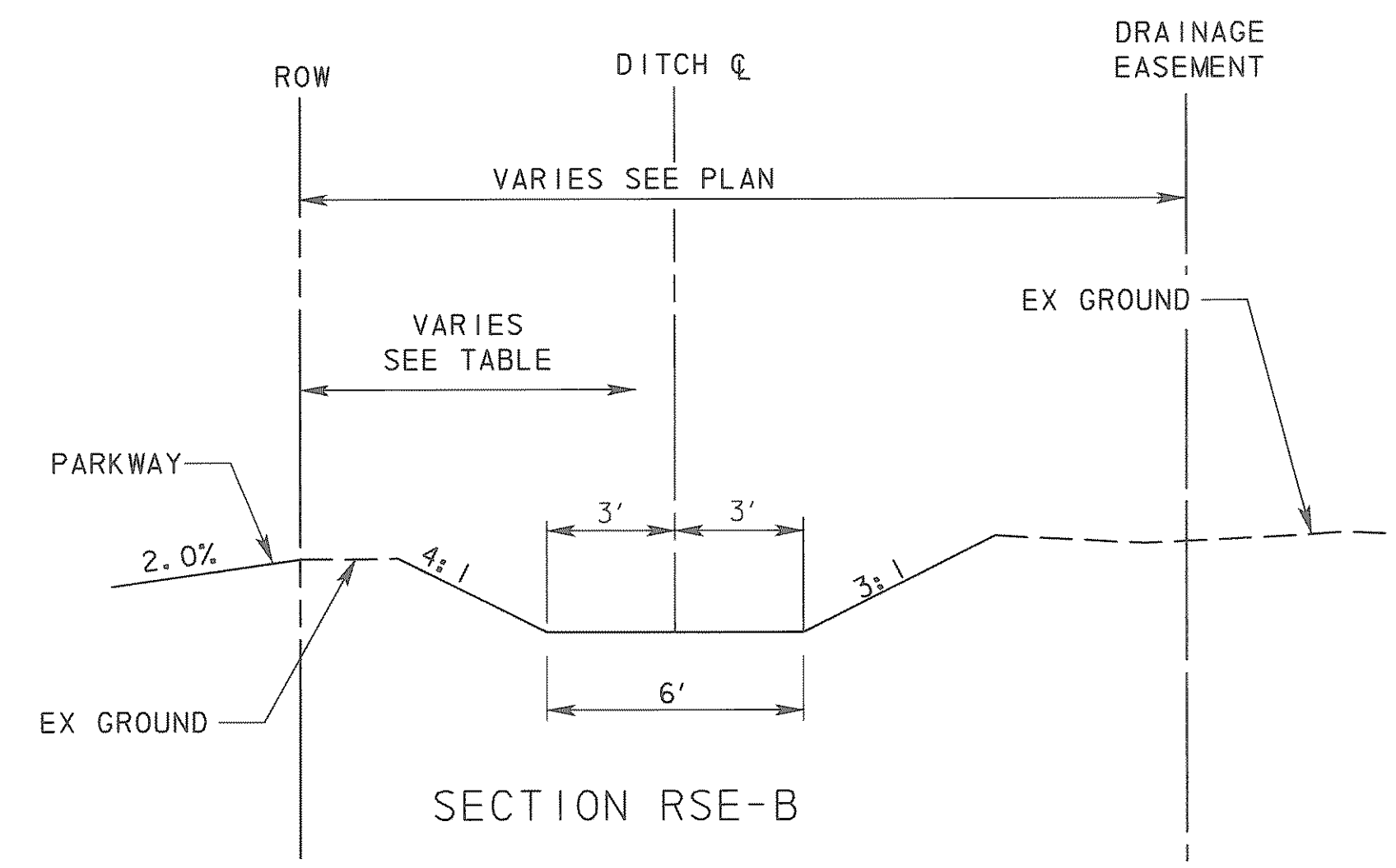
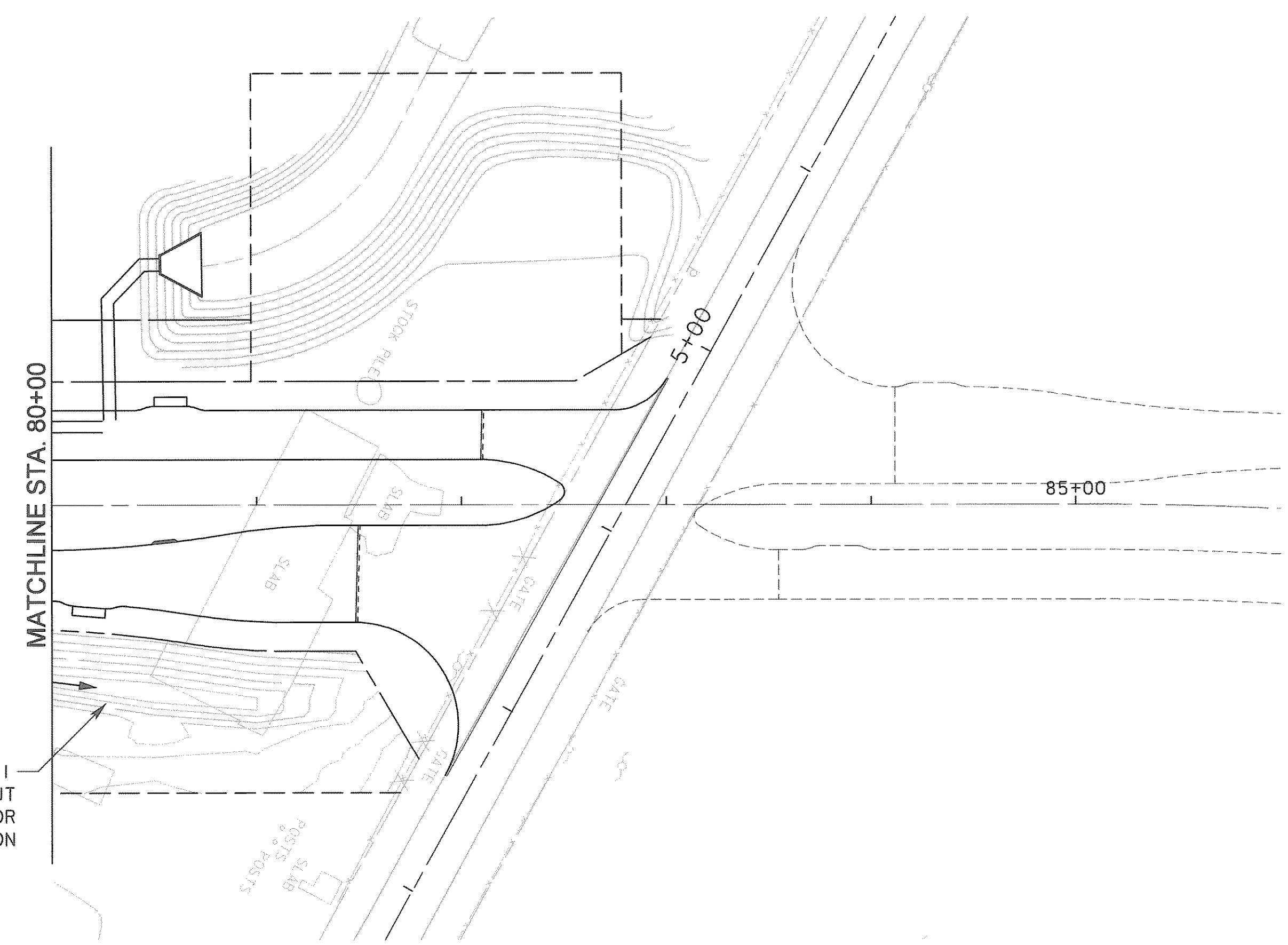
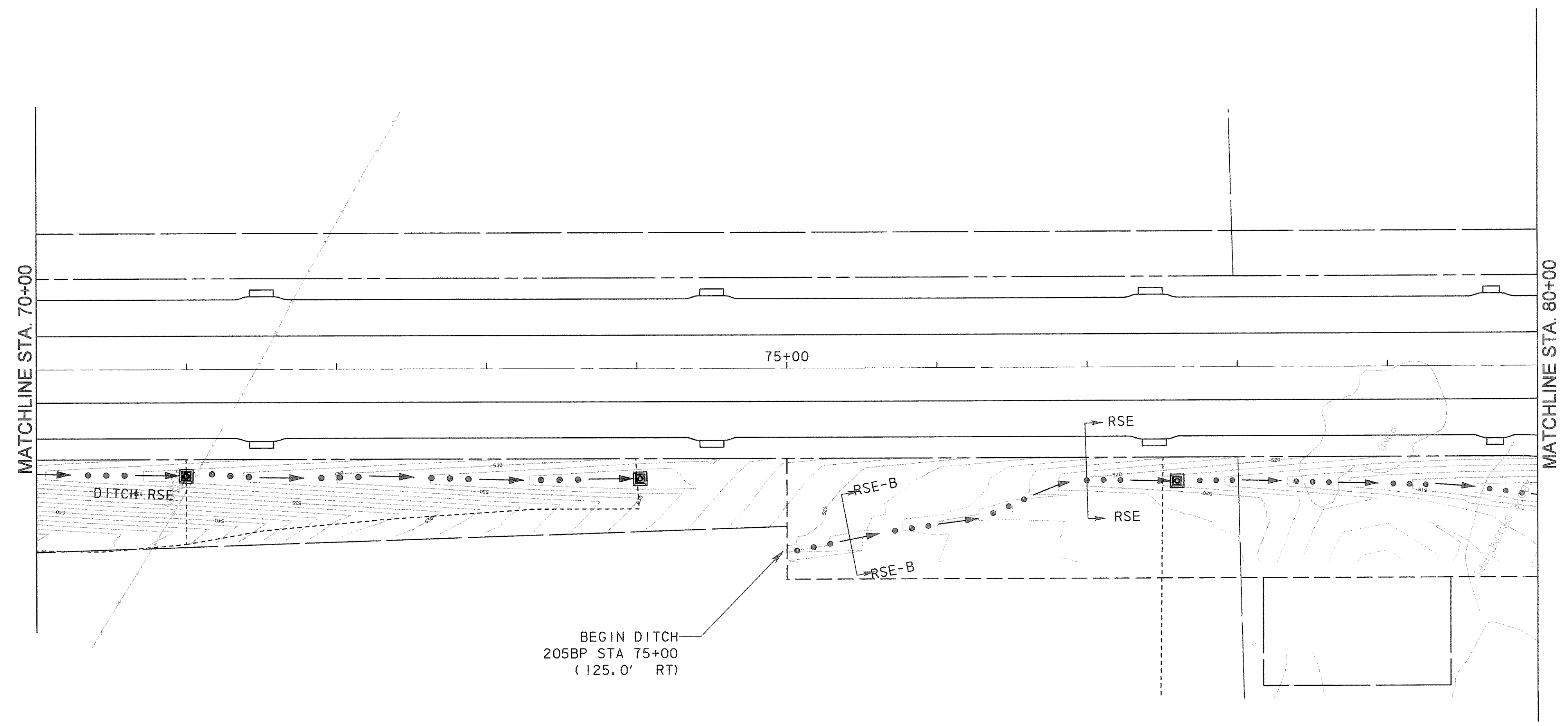

RECORD DRAWING
 This drawing is a compilation of the original sealed engineering drawing and modifications by addenda, change orders and information furnished by the contractor. Information shown that was provided by the contractor and others not associated with the design engineer cannot be verified for accuracy or completeness. Original sealed drawing is on file at the office of AECOM USA Group, Inc., TBPE REG. NO. F-3082

ORIGINAL DRAWING
 SEALED & SIGNED BY
 T.H. Gaertner, P.E.
 TX NO. 37124

NO.	REVISION	BY	DATE
205 BYPASS PHASE 3			
DITCH LAYOUT STA. 70+00 TO STA. 82+00			
TCB AECOM		<small>TCB INC. WWW.TCB.AECOM.COM 17300 DALLAS PARKWAY, SUITE 1010 DALLAS, TEXAS 75248</small>	
Unit	PW-DAL-FW	Scale:	Horz: AS SHOWN Vert: AS SHOWN
Designed	SB	Checked	TCB
Drawn	FG	Approved	TCB
Date	11/16/2009	Project No.	60004153
Sheet	54	of	215

\\usdal1\p001\PM\4328\60004153-205Bypass\CADD\Sheets\Phase 3 - 1 - 30 to Station SH 66\Record Draw\mg 10_7_09\05401rth P1an07.dgn
 11/16/2009