

- NOTE:
- COORDINATES GIVEN ARE SURFACE COORDINATES.
- SERVICE LINE NOTES:
- SEE NCTCOG DRAWING 4130. MODIFY AS FOLLOWS:
- TAPPING SADDLES SHALL BE CLOW-6350 OR APPROVED EQUAL.
  - CORPORATION STOP SHALL BE 1" MUELLER CORPORATION STOP NO. H-15008 OR HAYS EQUAL.
  - 1" ANGLE METER STOP (METER NUT X COMPRESSION) SHALL BE MUELLER NO. H-14253 WITH MUELLER H-10889 OR HAYS EQUAL.
  - METER BOX SHALL BE 18-INCH DIAMETER BY 14-INCH DEEP CORRUGATED GALVANIZED SLOTTED METER BOX WITH A COMPOSITE LID. USE STANDARD CITY LID.
  - NO C.F. CORPORATION STOPS.

**RECORD DRAWING**

This drawing is a compilation of the original sealed engineering drawing and modifications by addenda, change orders and information furnished by the contractor. Information shown that was provided by the contractor and others not associated with the design engineer cannot be verified for accuracy or completeness. Original sealed drawing is on file at the office of AECOM USA Group, Inc., TBPE REG. NO. F-3082

ORIGINAL DRAWING SEALED & SIGNED BY  
 T.H. Gaertner, P.E.  
 TX NO. 37124

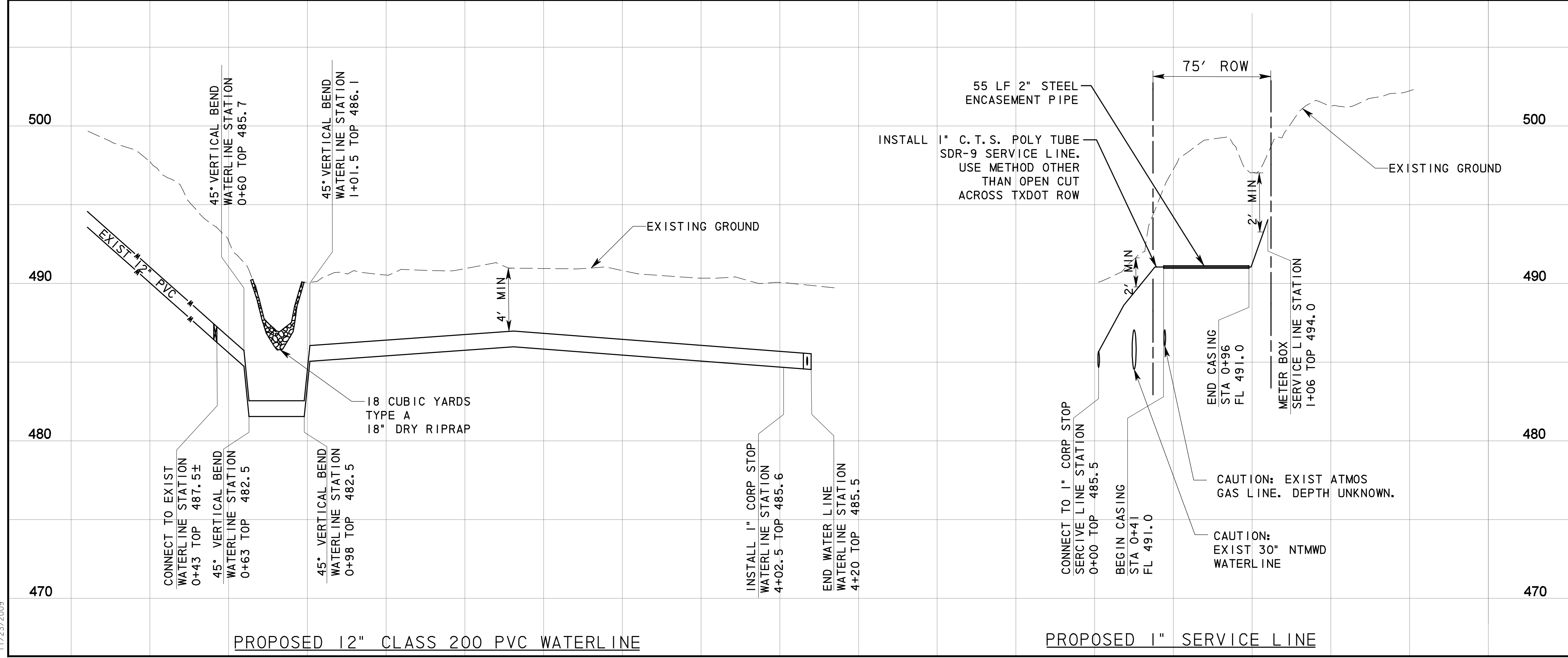

NO.	REVISION	BY	DATE
1	ADDED ENCASEMENT PIPE	THG	10/08/08



**205 BYPASS PHASE 2**

**WATER LINE AT F.M. 1141**

**TCB AECOM**  
 TCB INC.  
 WWW.TCB.AECOM.COM  
 17300 DALLAS PARKWAY, SUITE 1010  
 DALLAS, TEXAS 75248

Unit	PW-DAL-FW	Scale	Horz: AS SHOWN Vert: AS SHOWN	Date	11/23/2009
Designed	THG	Checked	TCB	Project No.	60004153
Drawn	FG	Approved	TCB	Sheet	82B of 142

P:\4328\60004153\205Bypass\CADD\Sheets\Phase 2 - SH 66 To 120+00\Record Drawing 10-7-09\082BWaterLine 1141.dgn  
 11/23/2009