

LEGEND

- RIGHT-OF-WAY -----
- DRAINAGE EASEMENT -----
- TEMP. CONSTRUCTION EASEMENT -----
- 205 BYPASS PAVING [Shaded Area]

UNDERGROUND UTILITIES

THE LOCATION OF EXISTING UTILITIES SHOWN ON THESE PLANS ARE APPROXIMATE AND BASED ON DATA FURNISHED BY THE CITY OF ROCKWALL. IT IS THE RESPONSIBILITY OF THE CONTRACTOR TO LOCATE AND VERIFY ON-SITE THE UTILITIES THAT MAY CONFLICT WITH THE CONSTRUCTION.

NOTES:

1. INSTALL HORIZONTAL AND VERTICAL THRUST BLOCKING AND MECHANICAL JOINT RESTRAINT AT ALL DUCTILE IRON FITTINGS.
2. INSTALL POLYETHYLENE WRAP AROUND BURIED DUCTILE IRON FITTINGS.

RECORD DRAWING

This drawing is a compilation of the original sealed engineering drawing and modifications by addenda, change orders and information furnished by the contractor. Information shown that was provided by the contractor and others not associated with the design engineer cannot be verified for accuracy or completeness. Original sealed drawing is on file at the office of AECOM USA Group, Inc., TBPE REG. NO. F-3082

ORIGINAL DRAWING SEALED & SIGNED BY

Nicholas R. Batker, P.E.
TX NO. 92749

| NO. | REVISION | BY | DATE |
|-----|----------|----|------|
| | | | |
| | | | |



City of Rockwall, Texas

**205 BYPASS
PHASE 2**

**30" FORCE MAIN
PLAN & PROFILE
STA 33+00 TO 37+50**

4 OF 9

TCB AECOM
TCB INC.
WWW.TCB.AECOM.COM
17300 DALLAS PARKWAY, SUITE 1010
DALLAS, TEXAS 75248

| | | | | | |
|----------|-----------|----------|------------------------------|-------------|------------|
| Unit | PW-DAL-FW | Scale | Horz: 1"=40' Vert: 1"=10' | Date | 11/23/2009 |
| Designed | JLT/SDB | Checked | NRB | Project No. | 60023784 |
| Drawn | TCB | Approved | NRB | Sheet | 76 of 142 |

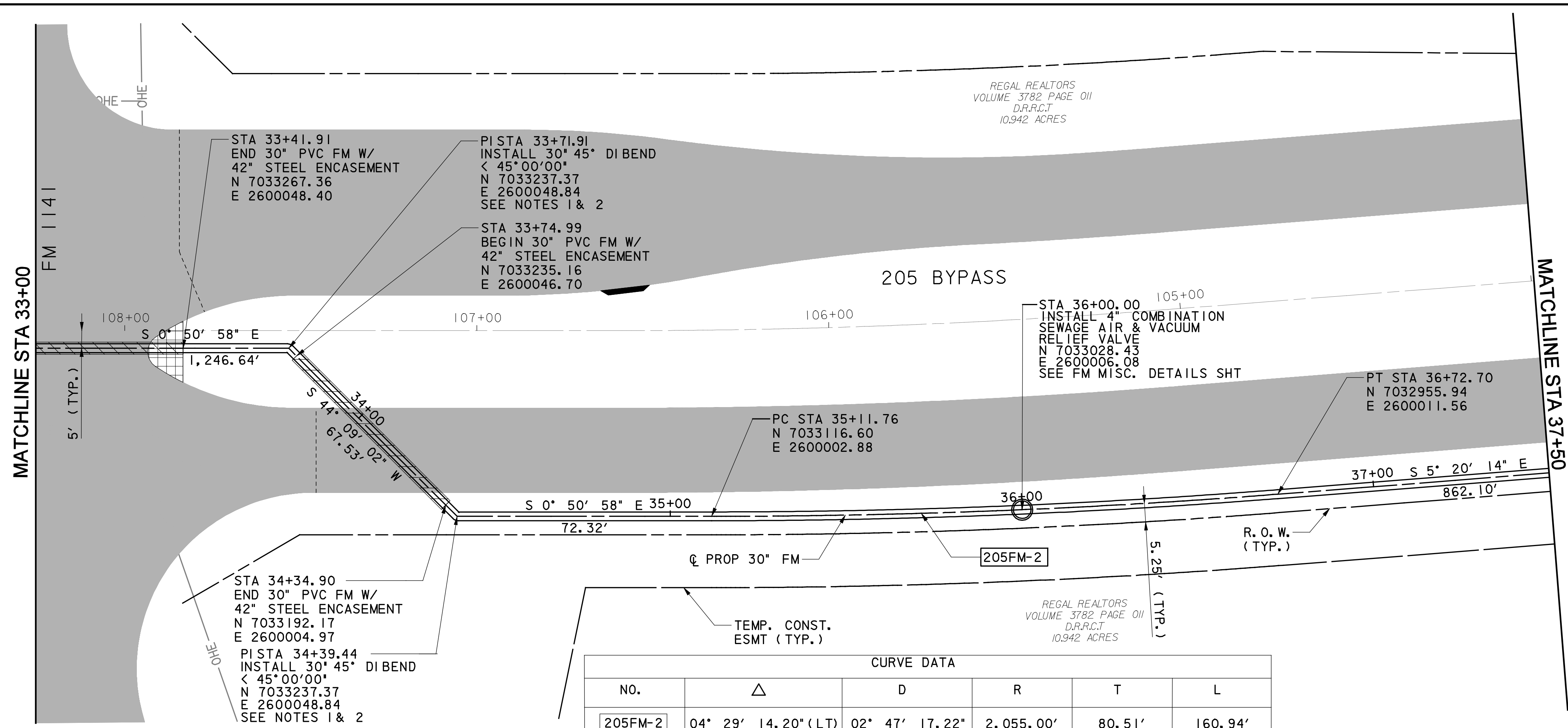

CURVE DATA

| NO. | Δ | D | R | T | L |
|---------|---------|-------------|----------------|-----------|----------------|
| 205FM-2 | 04° 29' | 14.20° (LT) | 02° 47' 17.22" | 2,055.00' | 80.51' 160.94' |

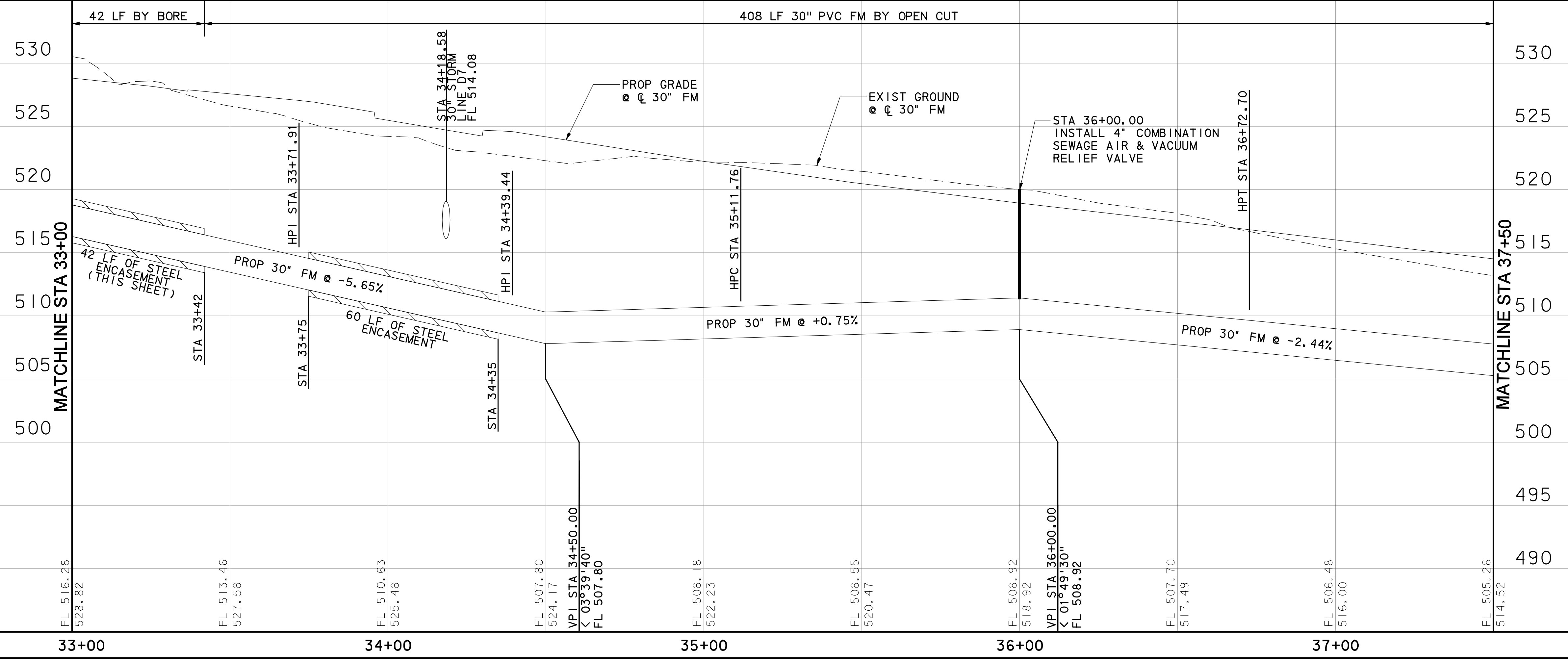

11/23/2009 8:21:41 AM
 P:\3328\60004153-205Bypass\CADD\Sheets\Phase 2 - SH 66 To I20+00\Record Drawing 10_7_09\076p&04.dgn