

DESCRIPTION	UNIT	QUANTITY
STORM DRAIN STRUCTURE REMOVAL	LF	0
BASE AND ASPHALT REMOVAL	SY	0
CONCRETE PAVEMENT REMOVAL	SY	0
FENCE REMOVAL	LF	55

THESE ITEMS ARE SUBSIDIARY TO ITEM 3.1 PREPARING RIGHT-OF-WAY AND SHOWN FOR CONTRACTORS INFORMATION ONLY.

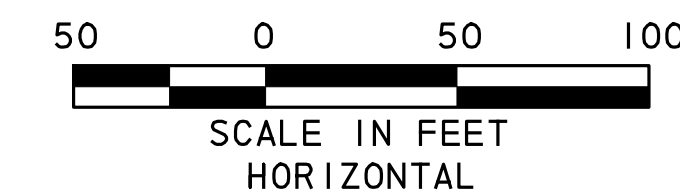
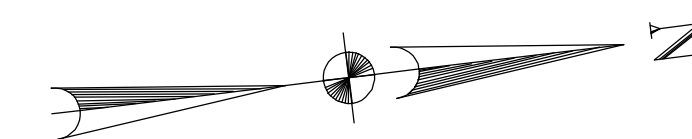

LEGEND

- EXIST. TREE TO REMAIN
- EXIST. FENCE TO REMAIN
- EXIST. TREE TO BE REMOVED (SEE NOTE 3)
- EXIST. FENCE TO BE REMOVED
- EXIST. BRUSH & SMALL DIAMETER TREES TO BE REMOVED
- EXIST. ASPHALT PAVEMENT TO BE REMOVED
- EXIST. CONCRETE TO BE REMOVED
- PROP FENCE CORNER/PULL POST (MATCH EXIST FENCE TYPE PER TXDOT DETAIL WF(1)-94 OR WF(2)-96)
- PROPOSED RIGHT-OF-WAY
- DRAINAGE EASEMENT
- TEMP. CONSTRUCTION EASEMENT

NOTES:

1. CONTRACTOR SHALL BE PAID FOR REMOVALS IN ACCORDANCE WITH SPEC. ITEM 3.1, PREPARING RIGHT-OF-WAY.
2. QUANTITIES SHOWN ARE FOR CONTRACTOR'S INFORMATION ONLY.
3. REMOVE ONLY THOSE TREES NECESSARY TO ALLOW CONSTRUCTION TO BE COMPLETED. SEE SPECIAL CONDITIONS IN THE CONTRACT DOCUMENTS.

RECORD DRAWING

This drawing is a compilation of the original sealed engineering drawing and modifications by addenda, change orders and information furnished by the contractor. Information shown that was provided by the contractor and others not associated with the design engineer cannot be verified for accuracy or completeness. Original sealed drawing is on file at the office of AECOM USA Group, Inc., TBPE REG. NO. F-3082

ORIGINAL DRAWING SEALED & SIGNED BY

T.H. Gaertner, P.E.
TX NO. 37124

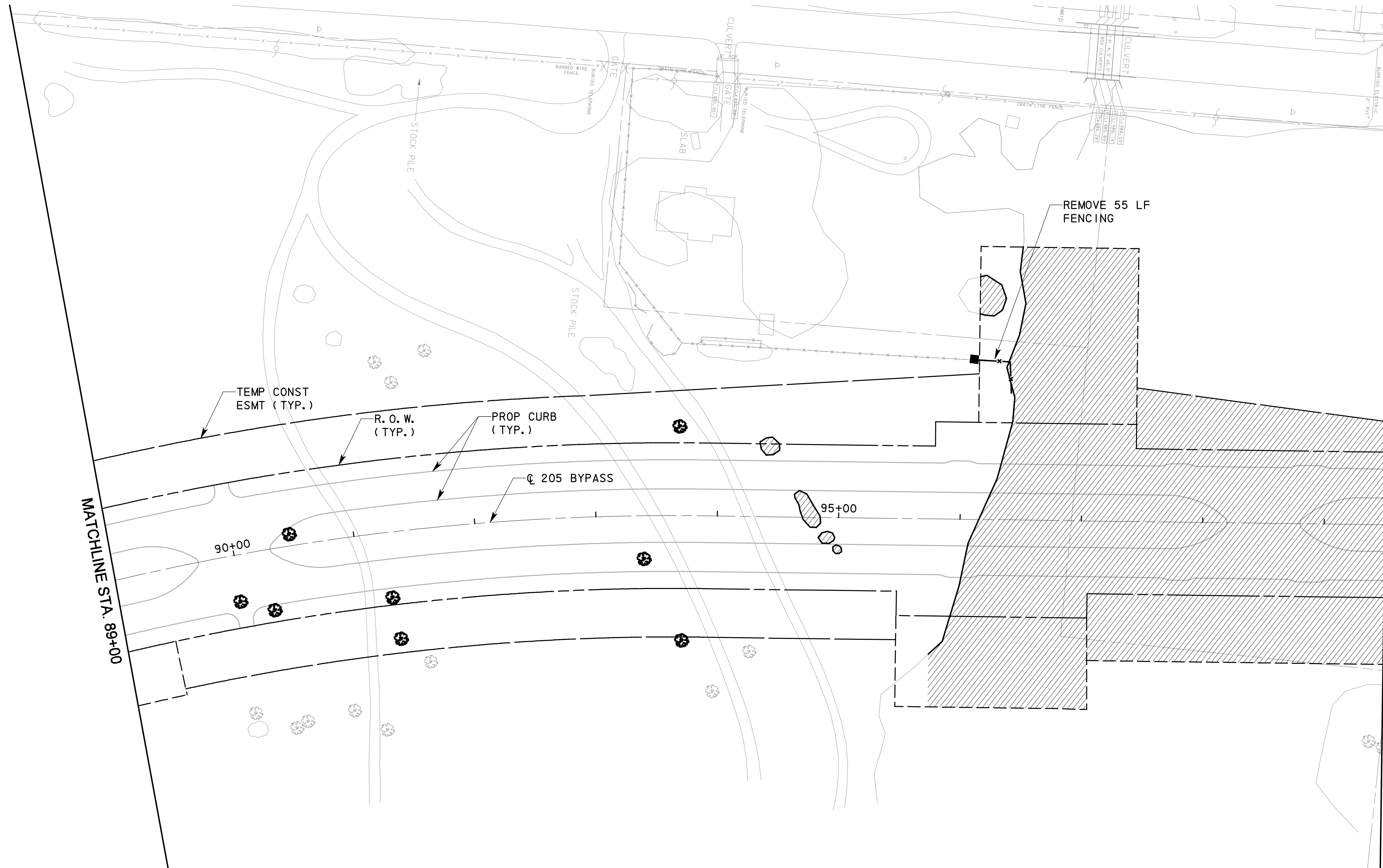

P:\4328\60004153\205Bypass\CADD\Sheets\Phase 2 - SH 66 To 120+00\Record Drawing 10_7_09\017Dem-02.dgn
11/23/2009

NO.	REVISION	BY	DATE



City of Rockwall, Texas

**205 BYPASS
PHASE 2**

**DEMOLITION PLAN
STA. 89+00 TO STA. 99+50**

TCB | AECOM
TCB INC.
WWW.TCB.AECOM.COM
17300 DALLAS PARKWAY, SUITE 1010
DALLAS, TEXAS 75248

Unit	PW-DAL-FW	Scale	As Shown	Date	11/23/2009
Designed	THG	Checked	TCB	Project No.	60004153
Drawn	FG	Approved	TCB	Sheet	17 of 142