

\* NOTE  
MEDIAN NOSE CURB HEIGHT  
TO TRANSITION FROM 6" TO  
2" AT RAIL HEADER

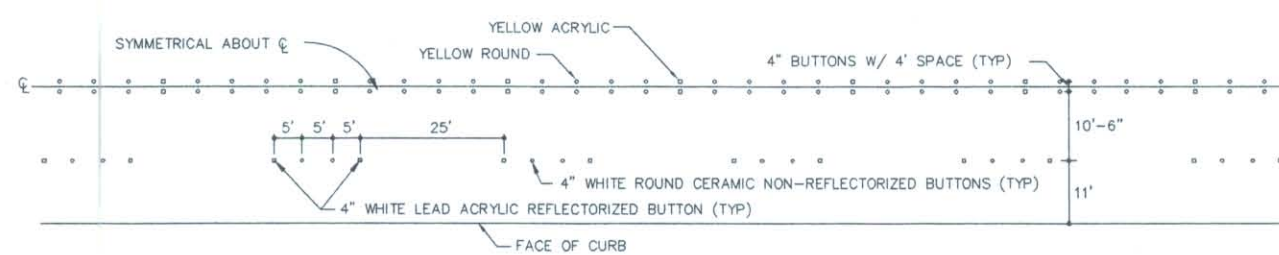

TYPICAL PAVEMENT MARKINGS  
NTS

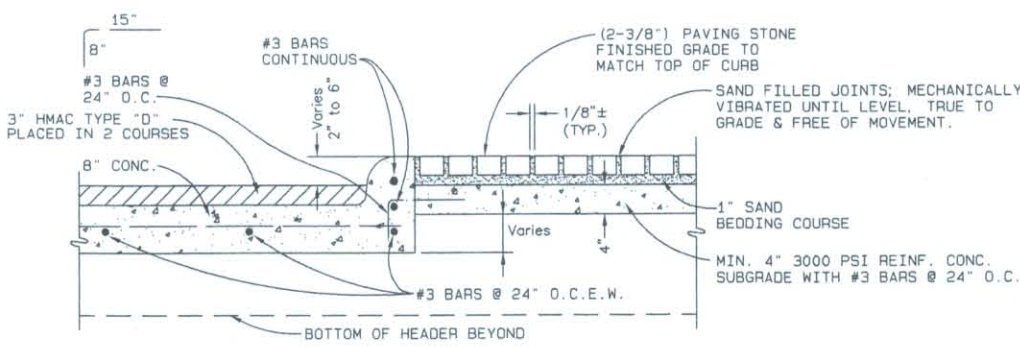

NOTE: INSTALL PAVERS AFTER SIGNAL CONSTRUCTION.  
DO NOT INSTALL CONC. SUBGRADE UNTIL SIGNAL  
WORK IS COMPLETE. STUB-OUT #3 BARS 12" ON  
18" CENTERS FROM CONC. SUBGRADE. THE EARTH  
SUBGRADE SHALL BE COMPACTED PRIOR TO  
PLACEMENT OF CONC. SUBGRADE.

SECTION A-A  
NTS

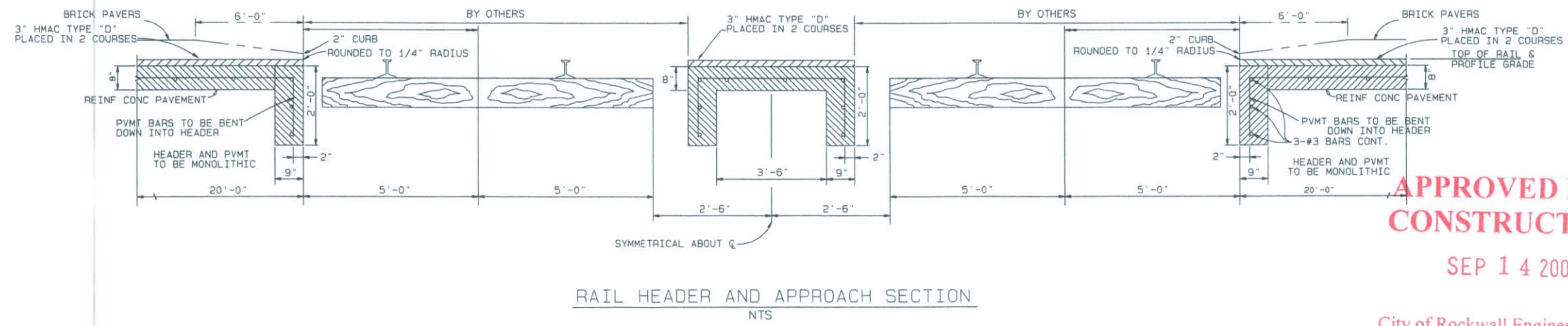

RAIL HEADER AND APPROACH SECTION  
NTS

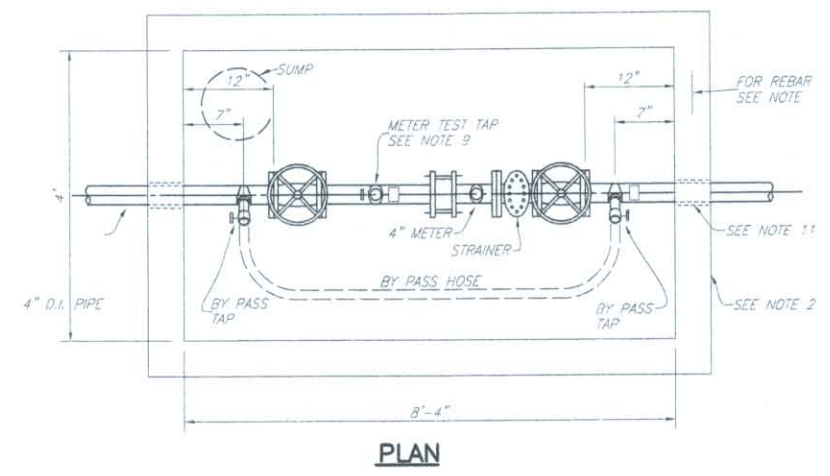

PLAN

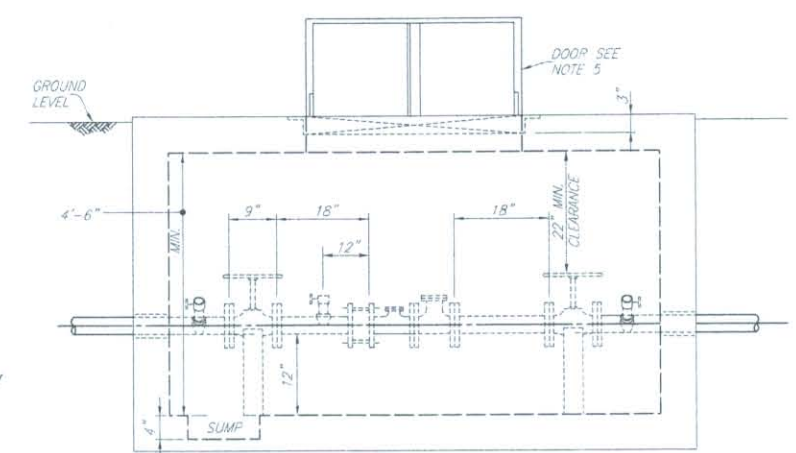

ELEVATION  
METER VAULT

METER VAULT & BY-PASS NOTES

1. NOTIFY THE UTILITY OPERATIONS DEPARTMENT PRIOR TO CONSTRUCTION OF METER VAULT OR BY-PASS ASSEMBLY.
2. THE METER VAULT CAN BE EITHER POURED IN PLACE OR PRE-FABRICATED. ALL WALLS, EITHER POURED IN PLACE OR PRE-FABRICATED, SHALL BE MONOLITHIC POUR. NO SEAMS OR EXTENSIONS WILL BE ALLOWED. CONCRETE SHALL BE 6" THICK-3,000 P.S.I., REINFORCED WITH #4 STEEL BARS ON 12" CENTERS EACH WAY, ON POURED IN PLACE VAULTS. PRE-FABRICATED VAULTS SHALL BE 4" THICK-4,500 P.S.I. CONCRETE, REINFORCED WITH #4 STEEL BARS ON 10" CENTERS BOTH WAYS. THESE ARE MINIMUM SPECIFICATIONS.
3. THE BOTTOM OF THE VAULT SHALL BE 6" THICK-3,000 P.S.I. CONCRETE, REINFORCED WITH #4 STEEL BARS ON 12" CENTERS BOTH WAYS. A 4" DEEP x 12" DIAMETER SUMP SHALL BE INSTALLED TO ONE SIDE AND IN EITHER CORNER OF THE BOTTOM OF THE SLAB. A 4" CUSHION OF SAND SHALL BE INSTALLED UNDER THE SLAB. IF A PRE-FABRICATED VAULT IS TO BE USED, A LAYER OF RAM-NEX SHALL BE INSTALLED BETWEEN THE WALLS AND BOTTOM SLAB.
4. ALL PIPING INSIDE THE VAULT AND THE VAULT ITSELF MUST BE INSPECTED AND APPROVED BY THE UTILITY OPERATIONS DEPARTMENT.
5. THE VAULT LID SHALL BE BILCO TYPE Q-4 LEAF DESIGN LID. ANGLE FRAME IS 1/4" STEEL WITH STRAP ANCHORS BOLTED TO THE EXTERIOR. THE LEAF IS 1/4" STEEL DIAMOND PATTERN PLATE, PIVOTING ON TORSION BARS FOR EASY OPERATIONS. THE MINIMUM LINE LOAD CAPACITY IS 150 LBS. PER SQUARE FOOT. THE LID SIZE SHALL BE 3'x3'. THE LID SHALL BE PAINTED WITH 43-38 TRNEMEC DIFFUSED ALUMINUM PAINT OR APPROVED EQUAL.
6. ALL PIPING INSIDE THE VAULT SHALL BE DUCTILE IRON PIPE WITH FLANGED FITTINGS. THE OUTSIDE DIMENSION OF THE PIPING SHALL BE WITHIN THE FOLLOWING RANGES: 3" PIPE - 3.74" TO 3.86"; 4" PIPE - 4.74" TO 4.90"; 6" PIPE - 6.81" TO 6.96"; 8" PIPE - 8.98" TO 9.20"; 10" PIPE - 11.04" TO 11.61". VARIATION FROM THESE DIMENSIONS WILL RESULT IN THE VAULT BEING REJECTED.
7. THE STRAINER, METER AND FLANGED ADAPTER COUPLING WILL BE PROVIDED AND INSTALLED BY THE CITY AT THE CONTRACTORS EXPENSE.
8. THE STRAINER, METER AND FLANGED ADAPTER COUPLING WILL NOT BE INSTALLED UNTIL THE METER VAULT AND TAPS ARE ACCEPTED BY THE CITY UTILITY OPERATIONS DEPARTMENT. ALL UTILITIES MUST ALSO HAVE BEEN ACCEPTED AND RELEASED BY THE CITY ENGINEERING OFFICE PRIOR TO METER INSTALLATION.
9. THE CONTRACTOR SHALL MAKE THE BY-PASS AND METER TEST TAP INSIDE THE VAULT. TAP A MUST BE AT LEAST THREE PIPE DIAMETERS DOWN-STREAM OF THE METER. TAPS B & C MUST BE MADE AT AN APPROXIMATE 45% ANGLE ON EACH END OF THE PIPE AND CENTERED 7 INCHES AWAY FROM THE WALL. ALL TAPS SHALL BE 2" AND THE CONTRACTOR SHALL INSTALL APPROVED SERVICE SADDLES WITH BRASS NIPPLES AND NO. 7550 OHIO BRASS OR APPROVED EQUAL GATE VALVES.
10. THE MAIN LINE GATE VALVES SHALL BE RESILIENT WEDGE DESIGN, NON-RISING STEM VALVES, WHICH HAVE RECEIVED FORMAL APPROVAL FROM THE CITY. ALL VALVES SHALL BE FLANGED BOTH ENDS AND HAVE HAND WHEELS.
11. CONTRACTOR SHALL HAVE A CHOICE OF EITHER HAVING A LINK SEAL WALL SLEEVE MODEL WS-B-32-S-B FOR 4" PIPE CAST IN THE WALL VAULT USING LINK SEAL 5-#LS400-C OR THE CONTRACTOR MAY HAVE THE VAULT WALL CORED BEFORE INSTALLATION OF VAULT AND PIPING. IF THE WALL IS CORED FOR 4" PIPE, CORE SIZE SHALL BE 8" AND USE 5-#LS400-C LINK SEALS. BREAKING OF THE WALL WITH A JACKHAMMER OR USING PRE-CAST KNOCKOUT PANELS IS NOT PERMITTED.

**APPROVED FOR  
CONSTRUCTION**  
SEP 14 2006

City of Rockwall Engineering Dept.  
City Engineer: \_\_\_\_\_

NO.	REVISION	BY	DATE

DESIGNED BY: PBSJ  
DRAWN BY: PBSJ  
CHECKED BY: PBSJ  
SCALE: AS SHOWN  
DATE: JUNE 12, 2006



**PBSJ**  
18383 PRESTON ROAD ~ SUITE 500  
DALLAS, TEXAS 75252  
PH. (972) 818-7275 FAX (972) 380-2609

DETAILS  
INDUSTRIAL BOULEVARD IMPROVEMENTS  
RAILROAD TO AIRPORT ROAD  
CITY OF ROCKWALL  
JUNE 2006

SHEET NO. 8  
OF 8 SHEETS  
FILE NO. 520392.00