

NOTE:  
STREET CONSTRUCTION - 8" 3000 PSI  
CONCRETE W/ #4 BARS 24" O.C EACH  
WAY ON 6" STABILIZED LIME SUBGRADE  
W/ 1/2 MIN. OF 7% LIME

NO ALTERNATE

NOTE:  
ALL DRIVES SHALL HAVE A 10' RADIUS  
CONSTRUCTION WILL BE 8" 3000 PSI,  
CONCRETE REINFORCED W/ #4 BARS  
24" O.C. BOTHWAYS.

NOTE:  
ALL UNDERGROUND UTILITIES TO  
BE RELOCATED OR ADJUSTED TO NEW  
PAVEMENT OR PARKWAY GRADE PRIOR  
TO ANY PAVEMENT CONSTRUCTION.

NOTE:  
SEE STORM SEWER DESIGN PLANS  
FOR DETAILS OF REMOVAL, REPLACING OR  
IMPROVING OF EXISTING DRAINAGE  
SYSTEMS

NOTE:  
POWER POLES & TELEPHONE  
BOXES TO BE RELOCATED BY OTHERS  
PRIOR TO CONSTRUCTION

NOTE:  
ALL CONSTRUCTION SHALL MEET  
CITY OF ROCKWALL SPECIFICATIONS

NOTE:  
CONTRACTOR SHALL HAVE  
ONE LANE REMAINED OPEN FOR  
TRAFFIC AT ALL TIMES

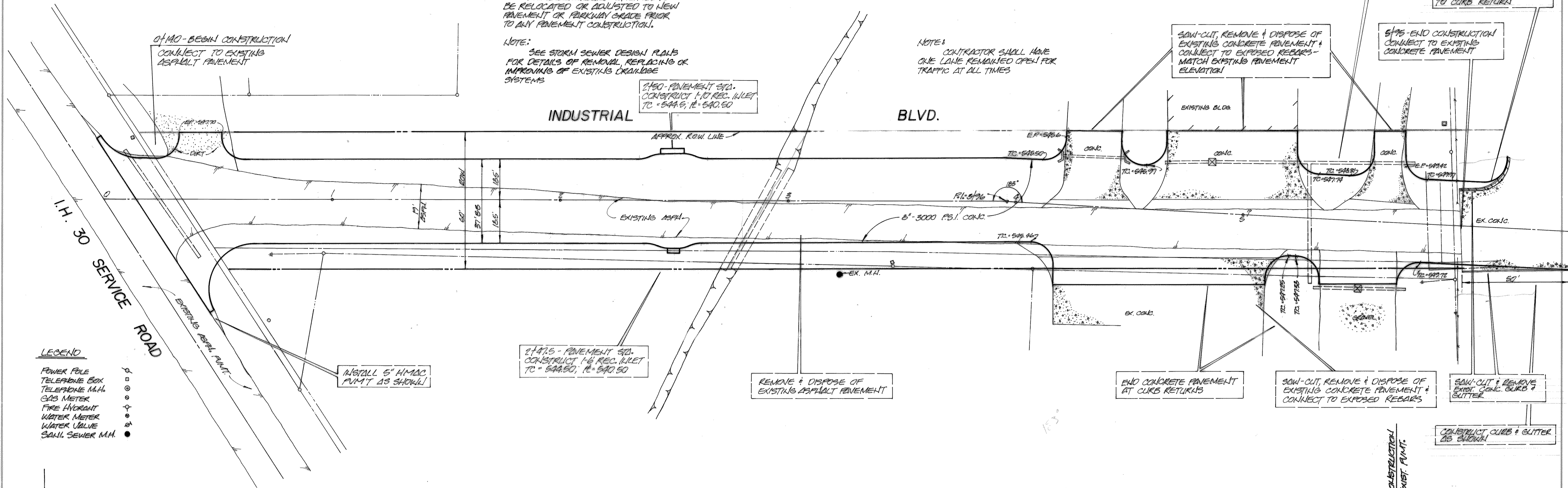
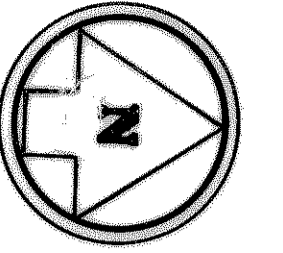

LEGEND

- POWER POLE
- TELEPHONE BOX
- TELEPHONE M.H.
- GAS METER
- FIRE HYDRANT
- WATER METER
- WATER VALVE
- SEWER M.H.

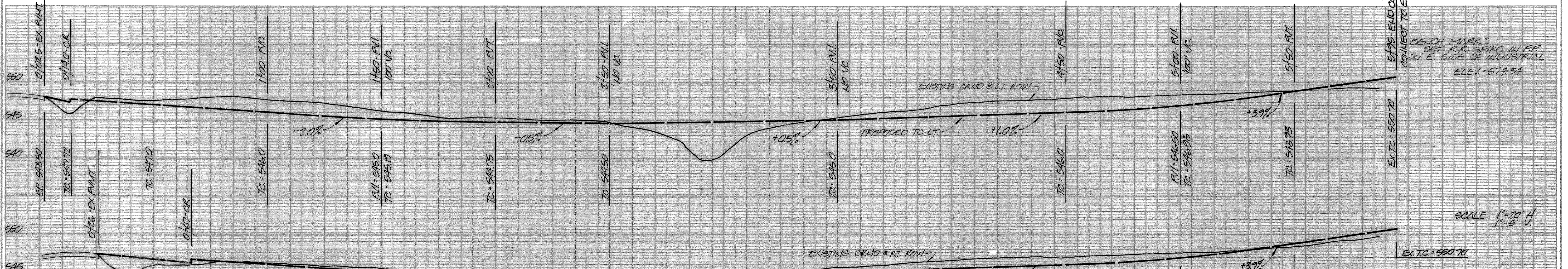

SCALE: 1" = 20' H  
1" = 5' V

REVISION NO.	REMARKS	DATE
<b>PAVING IMPROVEMENTS</b>		
<b>INDUSTRIAL BLVD.</b>		
CITY OF ROCKWALL, TEXAS 205 W. RUSK STREET 214-722-1111		
DESIGNED: W.L.D.	SCALE: NOTE	
DRAWN: W.L.D.	APPROVED: <i>W.L. Doupprate II</i>	
JOB NO. 87003	DATE: 3-87	SHEET NO. 32

