

CONST. 4" REINFORCED 3000 PSI CONC. LINED CHANNEL w/ NO. 3 BARS @ 18" CTRS. EACHWAY 257 SQ. YDS.

BENCHMARK NO. 1
R.R. SPIKE SET IN POWER POLE AT SOUTH SIDE OF I.H. 30 SERVICE ROAD, 180' EAST OF ROCKWALL CLASSIC CARS & BODY SHOP, ACROSS FROM I.H. 30 ENTRANCE RAMP. ELEV. 546.80

BENCHMARK NO. 2
R.R. SPIKE SET IN TELE. POLE ON NORTH R.O.W. OF UNION PACIFIC RAILROAD, 50' EAST OF S.W. CHAINLINK FENCE CORNER OF LEON TUTTLE BALLFIELD COMPLEX. ELEV. 577.24

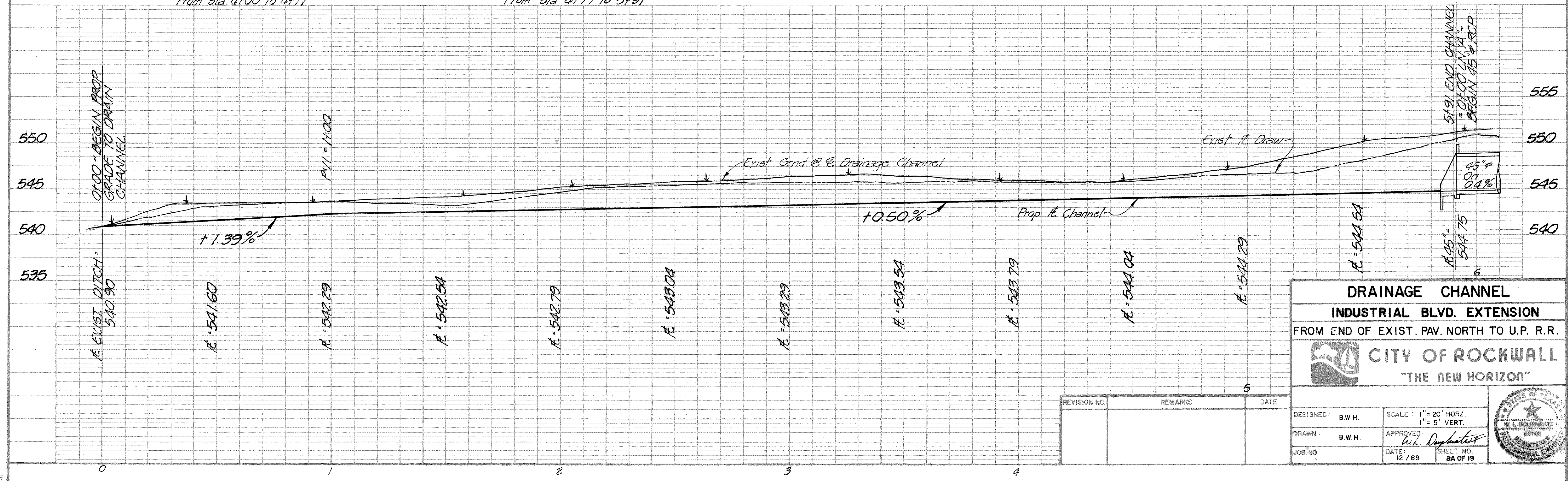

DRAINAGE CHANNEL		
INDUSTRIAL BLVD. EXTENSION		
FROM END OF EXIST. PAV. NORTH TO U.P. R.R.		
CITY OF ROCKWALL "THE NEW HORIZON"		
REVISION NO. REMARKS DATE	5	