

BENCHMARK NO. 1
 R.R. SPIKE SET IN POWER POLE AT SOUTH SIDE OF I.H. 30 SERVICE ROAD, 180' EAST OF ROCKWALL CLASSIC CARS & BODY SHOP, ACROSS FROM I.H. 30 ENTRANCE RAMP. ELEV. 546.80

BENCHMARK NO. 2
 R.R. SPIKE SET IN TELE. POLE ON NORTH R.O.W. OF UNION PACIFIC RAILROAD, 50' EAST OF S.W. CHAINLINK FENCE CORNER OF LEON TUTTLE BALLFIELD COMPLEX. ELEV. 577.24

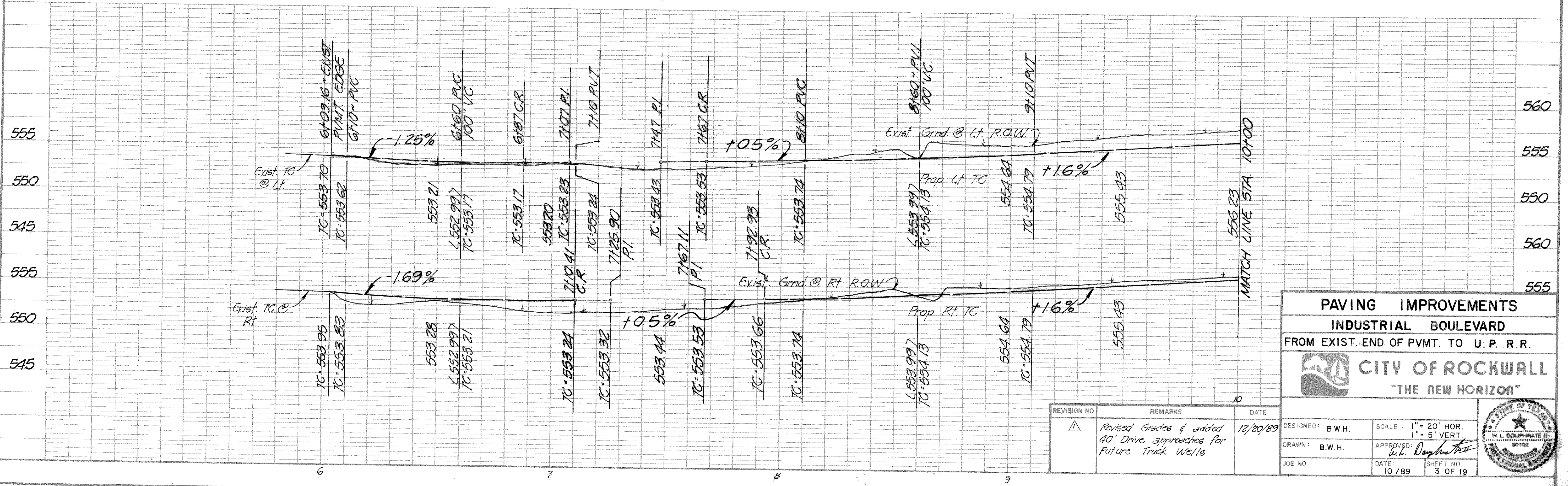

REVISION NO.	REMARKS	DATE
1	Revised Grades & added 40' Drive approaches for Future Truck Wells	12/20/89

