

MATCH LINE STA. 126+00

ROCKWALL TIRE & BATTERY  
CONCRETE PARKING LOT

- STA. 127+00.00 - L<sup>+</sup>  
 FURNISH & INSTALL  
 1 - 12" X 12" TEE  
 2 - 12" 90° BENDS  
 1 - 12" FLG X 8" MJ TEE  
 1 - 12" FLG X MJ GATE VALVE  
 1 - 8" GATE VALVE  
 1 - 8" X 8" TAPPING SLEEVE & VALVE  
 1 - 12" PLUG  
 144 L.F. - 12" PVC WL  
 10 L.F. - 8" PVC WL  
 CONNECT TO EXIST 8" WL

BORE & ENCASE PROPOSED 12" WATER LINE UNDER FM-549  
SEE DETAIL SHEET 23.

STA 128+60  
FURNISH & INSTALL  
1 - FIRE HYDRANT

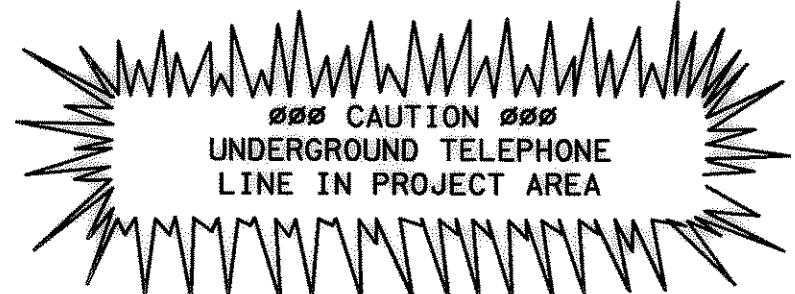

ABANDON EXIST. 6" WL IN PLACE

- STA. 136+44.21  
FURNISH & INSTALL  
1 - 6" X 6" TAPPING SLEEVE & VALVE  
1 - 12" X 6" MJ REDUCER  
CONNECT PROP. 12" WL TO EXIST. 6" WL  
N. = 7019512.0700  
E. = 2607836.9647

- STA. 136+10  
FURNISH & INSTALL  
1 - 12" X 12" TEE  
1 - 12" 90° BEND  
1 - 12" GATE VALVE  
1 - 12" PLUG  
60 L.F. - 12" PVC WL

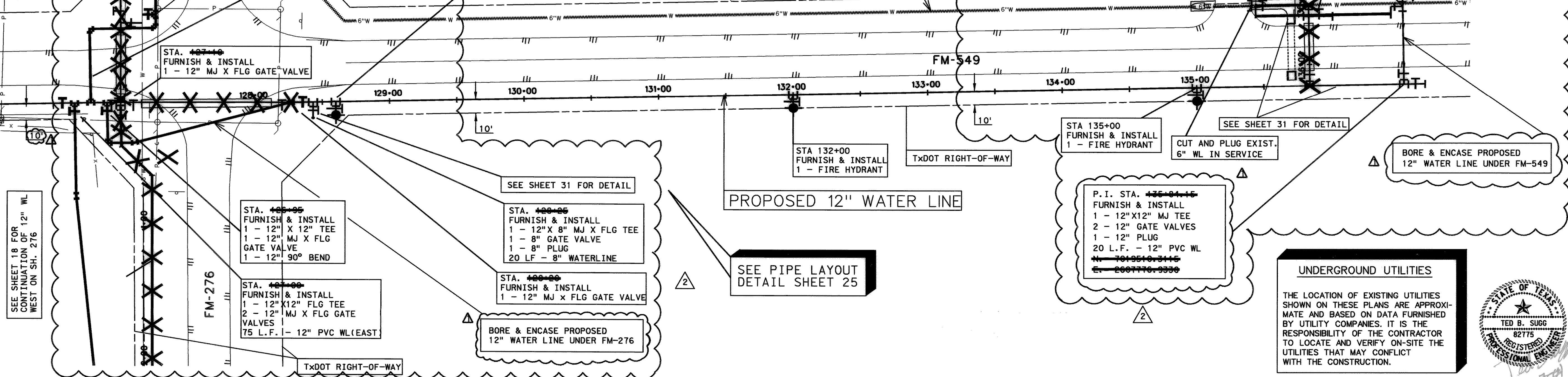
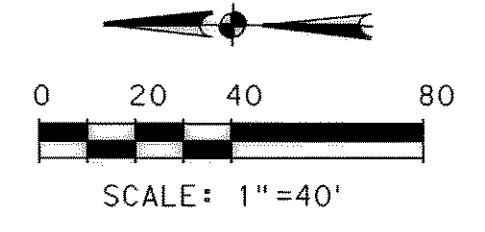

SEE SHEET 18 FOR CONTINUATION OF 12" WL WEST ON SH. 276

STA. 127+10  
FURNISH & INSTALL  
1 - 12" MJ X FLG GATE VALVE

STA. 128+95  
FURNISH & INSTALL  
1 - 12" X 12" TEE  
1 - 12" MJ X FLG GATE VALVE  
1 - 12" 90° BEND

STA. 128+00  
FURNISH & INSTALL  
1 - 12" X 12" FLG TEE  
2 - 12" MJ X FLG GATE VALVES  
75 L.F. - 12" PVC WL (EAST)

SEE SHEET 31 FOR DETAIL

STA. 129+05  
FURNISH & INSTALL  
1 - 12" X 8" MJ X FLG TEE  
1 - 8" GATE VALVE  
1 - 8" PLUG  
20 LF - 8" WATERLINE

STA. 129+00  
FURNISH & INSTALL  
1 - 12" MJ X FLG GATE VALVE

BORE & ENCASE PROPOSED 12" WATER LINE UNDER FM-276

STA 132+00  
FURNISH & INSTALL  
1 - FIRE HYDRANT

PROPOSED 12" WATER LINE

SEE PIPE LAYOUT DETAIL SHEET 25

STA 135+00  
FURNISH & INSTALL  
1 - FIRE HYDRANT

CUT AND PLUG EXIST. 6" WL IN SERVICE

P. I. STA. 135+01.16  
FURNISH & INSTALL  
1 - 12" X 12" MJ TEE  
2 - 12" GATE VALVES  
1 - 12" PLUG  
20 L.F. - 12" PVC WL  
N. = 7019510.3115  
E. = 2607776.9930

UNDERGROUND UTILITIES

THE LOCATION OF EXISTING UTILITIES SHOWN ON THESE PLANS ARE APPROXIMATE AND BASED ON DATA FURNISHED BY UTILITY COMPANIES. IT IS THE RESPONSIBILITY OF THE CONTRACTOR TO LOCATE AND VERIFY ON-SITE THE UTILITIES THAT MAY CONFLICT WITH THE CONSTRUCTION.

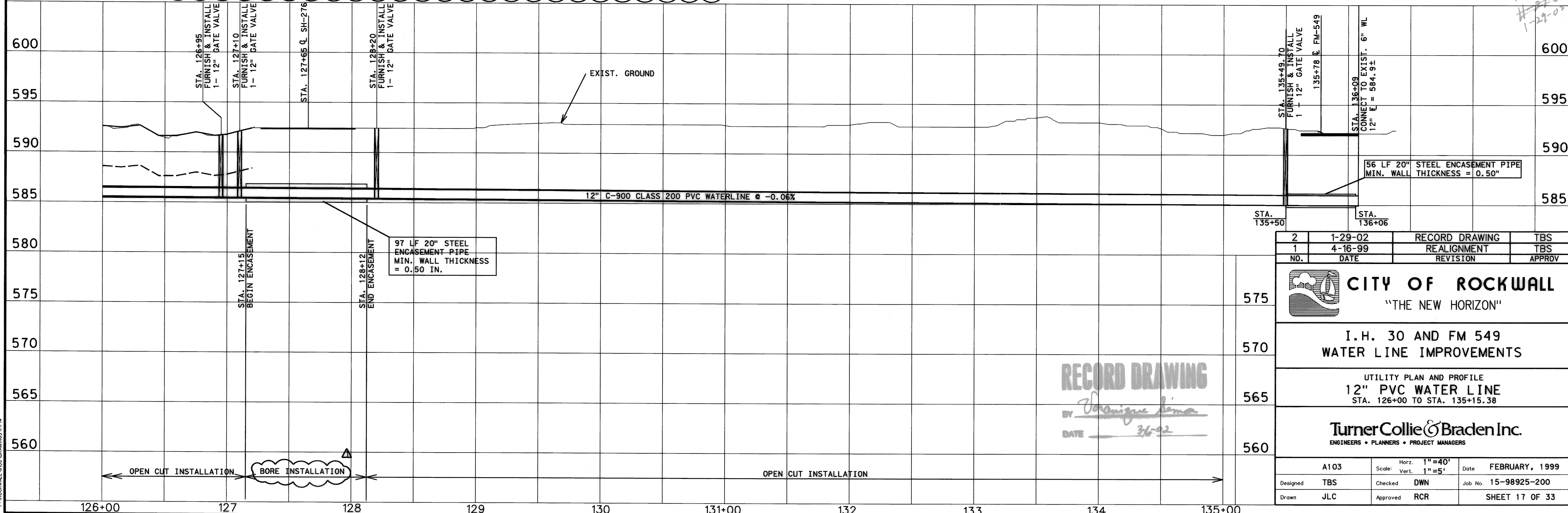
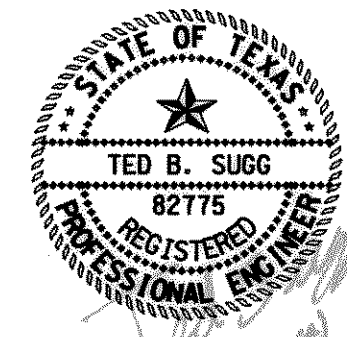

OPEN CUT INSTALLATION      BORE INSTALLATION

OPEN CUT INSTALLATION

STA. 126+95 FURNISH & INSTALL 1 - 12" GATE VALVE	STA. 127+10 FURNISH & INSTALL 1 - 12" GATE VALVE	STA. 127+65 Q. SH-276	STA. 128+20 FURNISH & INSTALL 1 - 12" GATE VALVE	EXIST. GROUND	12" C-900 CLASS 200 PVC WATERLINE @ -0.06%	STA. 135+49 TO FURNISH & INSTALL 1 - 12" GATE VALVE	STA. 135+78 Q. FM-549	STA. 136+09 CONNECT TO EXIST. 6" WL 12" E = 584.91	56 LF 20" STEEL ENCASEMENT PIPE MIN. WALL THICKNESS = 0.50"	97 LF 20" STEEL ENCASEMENT PIPE MIN. WALL THICKNESS = 0.50 IN.
--	--	-----------------------	--	---------------	--	---	-----------------------	--	--	---

2	1-29-02	RECORD DRAWING	TBS
1	4-16-99	REALIGNMENT	TBS
NO.	DATE	REVISION	APPROV

**CITY OF ROCKWALL**  
"THE NEW HORIZON"

I.H. 30 AND FM 549  
WATER LINE IMPROVEMENTS

UTILITY PLAN AND PROFILE  
12" PVC WATER LINE  
STA. 126+00 TO STA. 135+15.38

**Turner Collie & Braden Inc.**  
ENGINEERS • PLANNERS • PROJECT MANAGERS

A103	Scale: Horz. 1"=40' Vert. 1"=5'	Date	FEBRUARY, 1999
Designed	TBS	Checked	DWN
Drawn	JLC	Approved	RCR
		Job No.	15-98925-200
		SHEET 17 OF 33	

RECORD DRAWING  
DATE 3-6-92

P:\ROCKWALL\1999\DRAWINGS\DP14