

Drawing: P:\PROJECTS\RM\18219\18219\CAD\Sheets\PHASE 1 - NORTH\52 PAVING DETAILS 9 OF 9.dwg at Sep 27, 2019 10:44am by jhollie
 Layout: 52 PAVING DETAILS 9 OF 9
 Xrefs: xref-Paving.dwg

PEDESTRIAN ACCESSIBILITY (WITHIN PUBLIC R.O.W.)

All newly constructed sidewalks, curb ramps and crosswalks installed within City of Rockwall public rights-of-way shall be considered a pedestrian access route and shall conform to the most current Guidelines for Public Rights-of-Way created by the United States Access Board.

CURB RAMPS

- All slopes shown are **MAXIMUM ALLOWABLE**. Lesser slopes that will still drain properly should be used. Adjust curb ramp length or grade of approach sidewalks as directed.
- Landings shall be 5' x 5' minimum with a maximum 2% slope in the transverse and longitudinal directions.
- Clear space at the bottom of curb ramps shall be a minimum of 5' x 5' wholly contained within the crosswalk and wholly outside the parallel vehicular travel path.
- Maximum allowable cross slope on sidewalk and curb ramp surfaces is 2%.
- Additional information on curb ramp location, design, light reflective value and texture may be found in the most current edition of the Texas Accessibility Standards (TAS) and 16 TAC 68.102. Federal guidelines shall supersede any conflicts.
- Crosswalk dimensions, crosswalk markings and stop bar locations shall be as shown elsewhere in the plans. At intersections where crosswalk markings are not required, curb ramps and accessible routes shall align with theoretical crosswalks unless otherwise directed.
- Handrails are not required on curb ramps.
- Provide a flush transition where the curb ramps connect to the street.
- Accessible routes are considered "ramps" when longitudinal slopes are between 5% and 8.3% (maximum allowable). Sidewalks under 5% longitudinal slope are deemed accessible routes and must follow all applicable guidelines.

DETECTABLE WARNING DEVICE

- Curb ramps must contain a detectable warning surface that consists of raised truncated domes complying with Section 705 of the TAS. The surface must contrast visually with adjoining surfaces. Furnish and install an approved cast-in-place dark red detectable warning surface material adjacent to uncolored concrete, unless specified elsewhere in the plans.
- Detectable Warning Materials shall be truncated dome plates in the color approved by the City. Install products in accordance with manufacturer's specifications.
- Detectable warning surfaces must be slip resistant and not allow water to accumulate.
- Detectable warning surfaces shall be a minimum of 24" in depth in the direction of pedestrian travel, and extend the full width of the curb ramp or landing where the pedestrian access route enters the street.
- Detectable warning surfaces shall be located so that the edge nearest the curb line is at the back of curb. When placed on the ramp, align the rows of domes to be perpendicular to the grade break between the ramp run and the street. Where detectable warning surfaces are provided on a surface with a slope that is less than 5 percent, dome orientation is less critical. Detectable warning surfaces may be curved along the corner radius.

SIDEWALKS

- Provide clear ground space at operable parts, including pedestrian push buttons. Operable parts shall be placed within one or more reach ranges specified in TAS 308.
- Place traffic signal or illumination poles, ground boxes, controller boxes, signs, drainage facilities and other items so as not to obstruct the pedestrian access route or clear ground space.
- Street grades and cross slopes shall be as shown elsewhere in the plans.
- Changes in level greater than 1/4 inch are not permitted (1/2 inch with bevel).
- The least possible grade should be used to maximize accessibility. The running slope of sidewalks and crosswalks within the public right of way may follow the grade of the parallel roadway. Where a continuous grade greater than 5% must be provided, handrails may be desirable to improve accessibility. Handrails may also be needed to protect pedestrians from potentially hazardous conditions. If provided, handrails shall comply with TAS 505.
- Handrail extensions shall not protrude into the usable landing area or into intersecting pedestrian routes.

DIRECTIONAL CURB RAMP

CITY OF ROCKWALL



DATE: MAR. '17
DRAWING NO.: R-21250

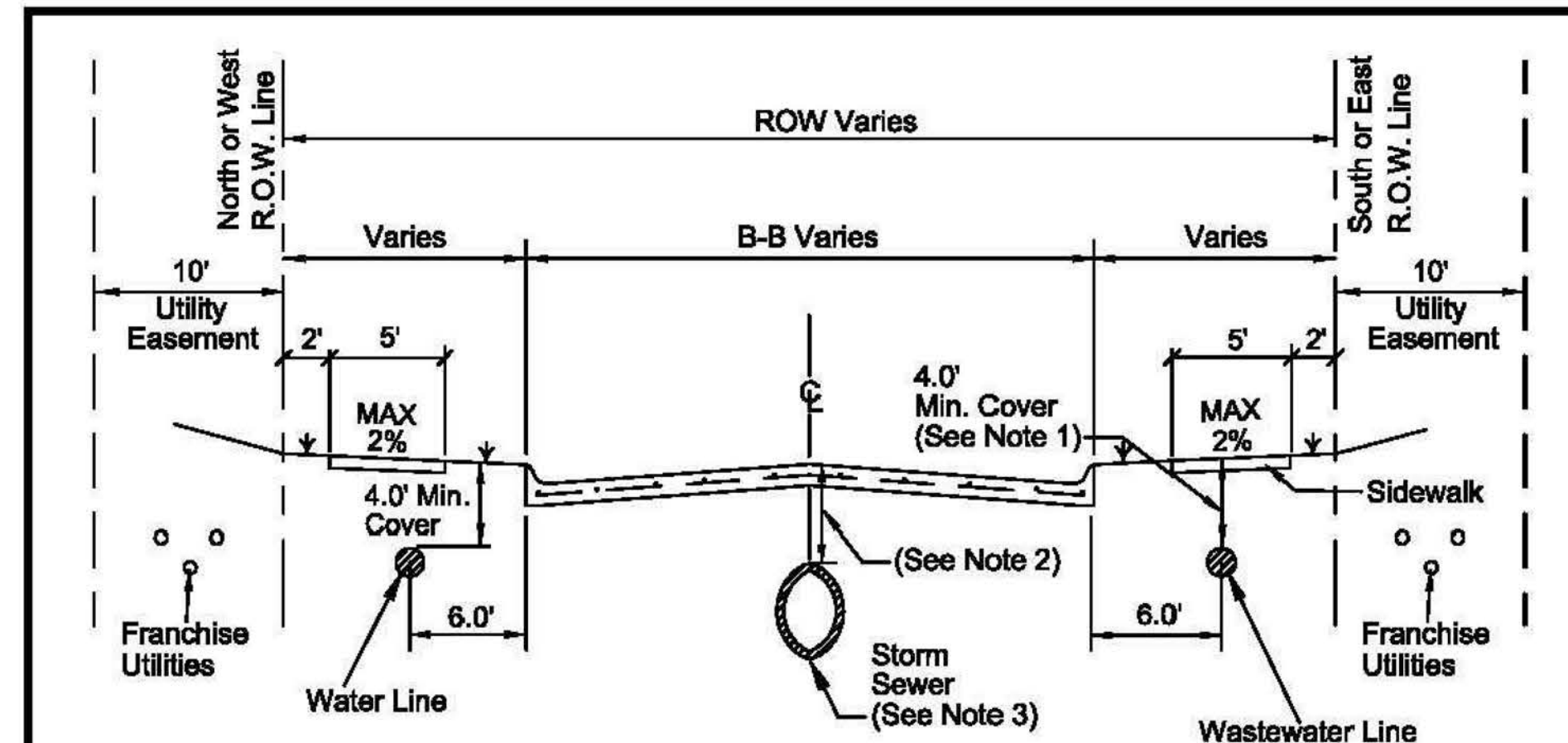

NOTE:

- If wastewater line has a cover greater than ten feet (10') than pipe shall be minimum SDR 26 and no services allowed.
- If cover is two (2) feet or less than Class IV RCP is required.
- Horizontal location of storm sewer for divided roads to be determined by design engineer. Not to be placed in the parkway.

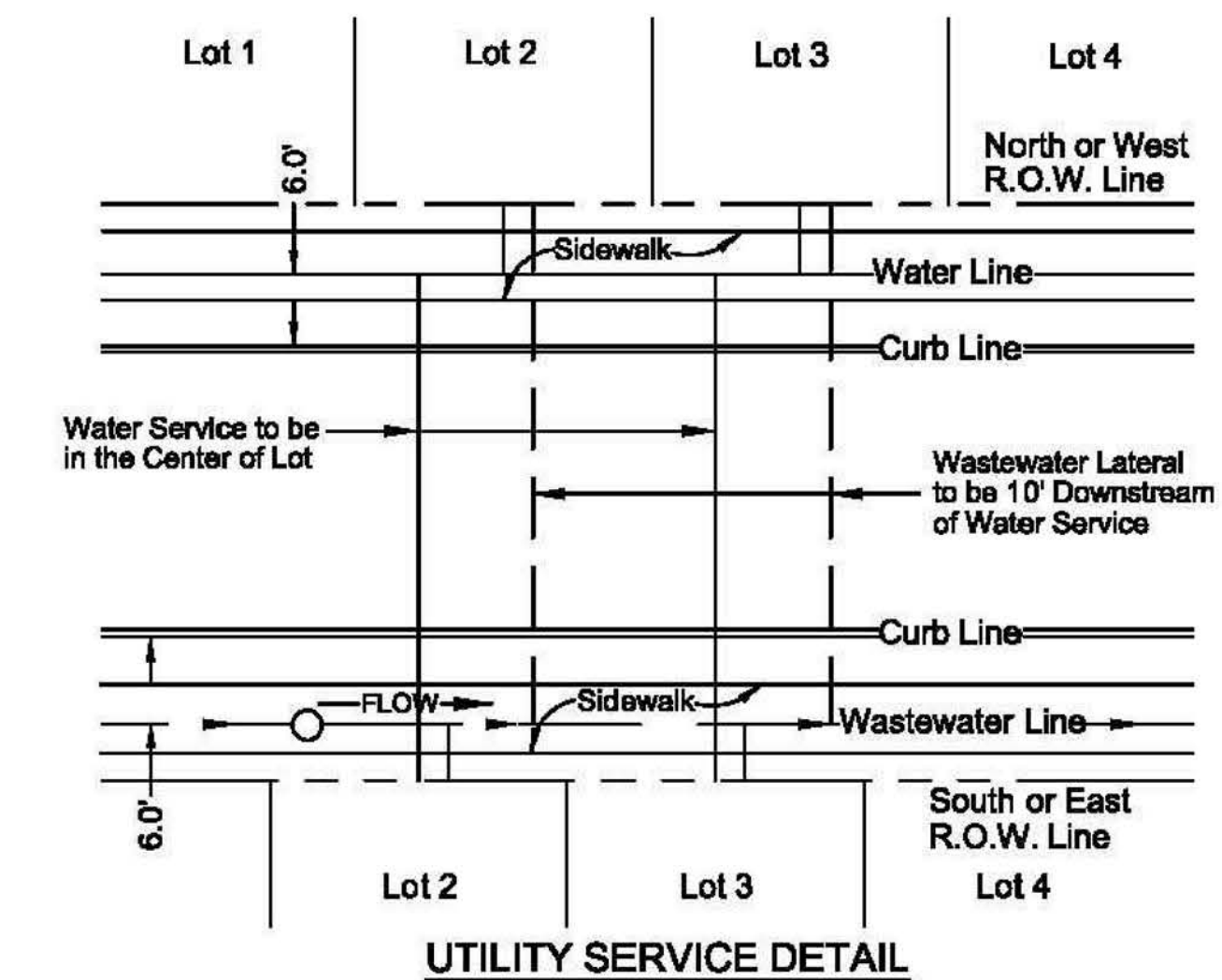

GENERAL UNDERGROUND CONDUIT

CITY OF ROCKWALL



DATE: OCT. '17
DRAWING NO.: R-3000

UTILITIES LOCATION DETAIL

no.	revision	by	date

teague nall and perkins, inc
 825 Watters Creek Blvd., Suite M300
 Allen, Texas 75013
 214.461.9867 ph 214.461.9864 fx
 www.tnpsc.com
 TBPE: F-230; TBPLS: 10011600, 10011601, 10194381

scale
when bar is
1 inch long
horiz N/A
vert N/A
SEP 2019

RECORD DOCUMENTS
 THESE PLANS ARE FOR THE OWNER'S USE AS RECORD SET OF THE CONSTRUCTED PROJECT, AND REFLECT REVISIONS AND CONSTRUCTION RELATED CHANGES AS RECORDED BY THE CONTRACTOR. CHANGES MADE FROM THE ORIGINAL CONSTRUCTION DOCUMENTS DO NOT DEPICT ENGINEERING AND ARE NOT THE RESPONSIBILITY OF TEAGUE NALL & PERKINS, INC. OR THE ENGINEER OF RECORD ON THE ORIGINAL DOCUMENTS. ORIGINAL PLANS RELEASED FOR CONSTRUCTION WERE SEALED BY GYANENDRA POKHREL, P.E. NO. 118159 ON 09/28/2018.

CITY OF ROCKWALL, TEXAS
HIGHLAND DRIVE RECONSTRUCTION, PHASE I
 (DRIFTWOOD STREET TO BEDFORD FALLS LANE)
PAVING DETAILS 9 OF 9

tnp project
 RWL18219
 sheet
50