

**PHASE IA SEQUENCE**

1. CLOSE NB TRAFFIC FOR HIGHLAND DRIVE (FROM COACH LIGHT TRAIL TO BEDFORD FALLS). INSTALL CHANNELIZING DEVICES, AND SHIFT TRAFFIC TO SB LANE - ONE WAY ONLY.
2. MAINTAIN ACCESS TO SHEPARD'S HILL DRIVE AND AN ALLEY AS SHOWN ON THE PLAN.
3. REMOVE EXISTING HIGHLAND DRIVE NB LANE PAVEMENT, SIDEWALK AND DRIVEWAYS, AND PERFORM SUBGRADE STABILIZATION WORK.
4. CONSTRUCT/ADJUST UTILITIES AND CONSTRUCT PAVEMENT IN NB HIGHLAND DRIVE.
5. REF. SHEET 2 NOTES FOR OVERALL SEQUENCE OF CONSTRUCTION.

**LEGEND**

- CONSTRUCTION ZONE/AREA PHASE IA
- CONSTRUCTION ZONE/AREA PHASE IB
- NEW CONCRETE P.V.M.T. (PREVIOUS STAGE)
- CHANNELIZING DEVICES (CONE OR BARREL OR PANEL)
- CONSTRUCTION WARNING SIGN
- TEMP. CONSTRUCTION SIGN
- DIRECTION OF TRAFFIC DURING CONSTRUCTION

**NOTES:**

1. REFERENCE GENERAL TRAFFIC CONTROL NOTES ON SHEET 01
2. A SUGGESTED TRAFFIC CONTROL SEQUENCE PLAN, AND TRAFFIC CONTROL PLANS HAS BEEN PROVIDED IN THE PLAN SET. AT A MINIMUM THE CONTRACTOR WILL BE REQUIRED TO USE THESE PLANS. IF THE CONTRACTOR CHOSE TO CHANGE THESE PLANS, THE CONTRACTOR WILL HAVE TO BE PROVIDED NEW PLANS FOR REVIEW AND APPROVAL BY THE CITY.
3. ALL NEW DETOURING OR TRAFFIC CONTROL PLANS SUBMITTED BY THE CONTRACTOR SHALL BE SIGNED AND SEALED BY A REGISTERED PROFESSIONAL ENGINEER IN THE STATE OF TEXAS.
4. NEW DETOUR OR TRAFFIC CONTROL PLANS SHALL BE SUBMITTED TO THE CITY FOR REVIEW AND APPROVAL A MINIMUM OF 21 CALENDAR DAYS PRIOR TO PLANNED DAY OF IMPLEMENTATION.
5. CONTRACTOR SHALL NOTIFY THE CITY 14 CALENDAR DAYS PRIOR TO CHANGING DETOURING AND TRAFFIC CONTROL FOR EACH PHASE AND SEGMENT. THIS IS TO GIVE TIME FOR CONTRACTOR TO PLACE MESSAGE BOARDS FOR WARNING OF DETOUR CHANGE AND FOR CITY NOTIFICATION TO OTHER DEPARTMENTS, EMERGENCY SERVICES, MAIL DELIVERY, SCHOOL DISTRICT, AND TRASH SERVICES.
6. TRAFFIC SHALL MAINTAIN A MINIMUM OF A ONE WAY, AT ALL TIMES OF THE DAY FOR ALL STREETS.
7. TWO WEEKS PRIOR TO ONE WAY TRAFFIC ON HIGHLAND DRIVE, TWO MESSAGE BOARDS SHALL BE PLACED ON EITHER END OF THE PROJECT WARNING OF CLOSURES AND TO SEEK ALTERNATE ROUTES.
8. TRAFFIC CONTROL PLANS PHASES AND SEGMENTS SHALL CONFORM TO THE FOLLOWING REQUIREMENTS:
  - A. CONSTRUCTION/WORK CANNOT TAKE PLACE ON BOTH SIDE OF A PROPERTY AT THE SAME TIME. EITHER THE ALLEY MUST BE COMPLETE BEFORE WORK STARTS ON THE STREET OR STREET COMPLETE BEFORE ALLEY STARTS.
  - B. LOCAL/SIDE STREETS TO HIGHLAND DR. SHALL NOT BE CLOSED COMPLETELY. ONE SIDE SHALL BE CONSTRUCTED AT A TIME AND TRAFFIC ON THE ONE SIDE TO REMAIN OPEN SHALL BE TWO-WAY WITH SIGNAGE FOR TRAFFIC TO YIELD TO ON-COMING TRAFFIC. CONTRACTOR SHALL USE FLAGGERS DURING OPERATION OF HEAVY EQUIPMENTS NEAR BY THE INTERSECTION.
  - C. EACH PHASE AND SEGMENT SHALL BE SUBSTANTIALLY COMPLETE BEFORE THE CONTRACTOR CAN PROCEED TO THE NEXT PHASE AND SEGMENT.
  - D. CONTRACTOR SHALL MAINTAIN ACCESS TO ALL PROPERTY'S AT ALL TIMES.
  - E. CONTRACTOR SHALL COORDINATE WITH CITY FOR ALLEY CLOSURES. THE ALLEY CLOSURE IS ONLY ALLOWED IN NO TRASH PICK UP DAY.
9. CONTRACTOR SHALL COVER ALL EXISTING TRAFFIC SIGNS IN CONFLICT WITH THE PROPOSED TRAFFIC CONTROL PLAN.
10. ALL WORK INCLUDING SIGN SPACING SHALL BE IN ACCORDANCE WITH THE TEXAS MANUAL ON UNIFORM TRAFFIC CONTROL DEVICES, PART 6, LATEST EDITION & CITY OF ROCKWALL CONSTRUCTION STANDARDS.

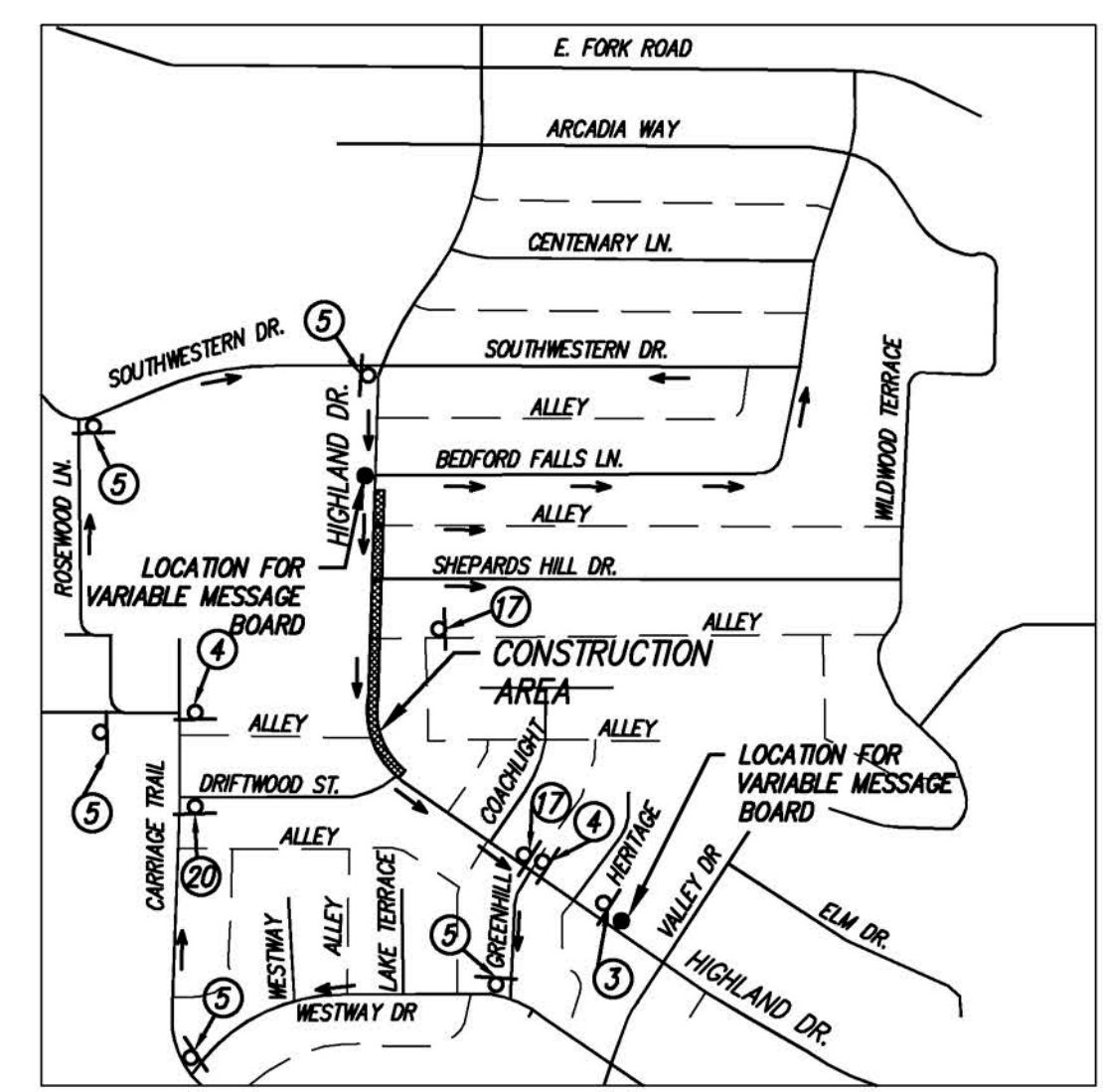

**CONCEPT DETOUR PLAN (N.T.S.)**

**TRAFFIC CONTROL SIGN LIST**

- W20-1 48"x48" (1)
- W20-2 (3)
- M4-9R (5)
- R3-1 (7)
- G20-2 (2)
- M4-9L (4)
- M4-8a (6)
- R3-2 (8)
- W20-4 36"x36" CW20ST-3C (9)
- R1-1 (11)
- R6-2L (15)
- R5-1a (18)
- CW20ST-1D (10)
- R5-1 (12)
- R6-2R (14)
- R11-4 (17)
- R9-9 (19)
- R11-2 48"x30" (13)
- R11-2 W-6L (16)
- R11-2 W-6R (18)
- M4-9S (20)
- R11-2 48"x30" (21)
- R11-2 W-6L (22)
- R11-2 W-6R (23)

**GRAPHIC SCALE**  
30 0 15 30 60  
GRAPHIC SCALE: 1" = 30'

Drawing: P:\PROJECTS\RWL18219\CAD\Shepard's Hill.dwg at Sep 27, 2019 - 10:34am by behalle  
 Layout: 10 - TRAFFIC CONTROL - PHASE 1 - Area: xref-borders.dwg - XBP-PANNING.dwg - XBP-SCALE.dwg - XBP-BASE.dwg

| no. | revision | by | date |
|-----|----------|----|------|
|     |          |    |      |
|     |          |    |      |

**teague nall and perkins, inc**  
 825 Watters Creek Blvd., Suite M300  
 Allen, Texas 75013  
 214.461.9867 ph 214.461.9864 fx  
 www.tnpsc.com  
 TBPE: F-230; TBPLS: 10011600, 10011601, 10194381

**City of Rockwall**  
*The New Horizon*

scale  
 when bar is  
 1 inch long  
 horiz  
 1" = 30'  
 vert  
 N/A  
 SEP 2019

**tnp**

**RECORD DOCUMENTS**  
 THESE PLANS ARE FOR THE OWNER'S USE AS RECORD SET OF THE CONSTRUCTED PROJECT, AND REFLECT REVISIONS AND CONSTRUCTION RELATED CHANGES AS RECORDED BY THE CONTRACTOR. CHANGES MADE FROM THE ORIGINAL CONSTRUCTION DOCUMENTS DO NOT DEPICT ENGINEERING AND ARE NOT THE RESPONSIBILITY OF TEAGUE NALL & PERKINS, INC. OR THE ENGINEER OF RECORD ON THE ORIGINAL DOCUMENTS. ORIGINAL PLANS RELEASED FOR CONSTRUCTION WERE SEALED BY GYANENDRA POKHREL, P.E. NO. 118159 ON 09/28/2018.

**CITY OF ROCKWALL, TEXAS**  
**HIGHLAND DRIVE RECONSTRUCTION, PHASE I**  
 (DRIFTWOOD STREET TO BEDFORD FALLS LANE)  
**SUGGESTED TRAFFIC CONTROL AND SEQUENCING - PHASE I**

tnp project  
**RWL18219**  
 sheet  
**13**